

05-409632

3-13-00
10-00
3/15/00
10-00
CP

PERMIT

SEWAGE DISPOSAL SYSTEM

DEPARTMENT OF HEALTH AND MENTAL HYGIENE

INDEXED

P 513282

A 37269

DISTRICT _____

DATE 2/24/2000

HOWARD COUNTY HEALTH DEPARTMENT

BUREAU OF ENVIRONMENTAL HEALTH

461-9933

DATE SYSTEM APPROVED 3/15/00

INSPECTOR DKS

The Greentree Companies IS PERMITTED TO INSTALL ALTER _____

ADDRESS 7979 Old Georgetown Road, #800, Bethesda, MD 20814 PHONE 301-654-7041

SUBDIVISION Fulton Estates LOT 1 ROAD 12105 Fulton Estates Court

PROPERTY OWNER Chase Residential Development Corp.

ADDRESS _____

SEPTIC TANK CAPACITY 1500 GALLONS

NUMBER OF BEDROOMS 5

210 SQUARE FEET PER BEDROOM

LINEAR FEET OF TRENCH REQUIRED 350

TRENCHES - Trench to be 3 feet wide. Inlet 4.0 feet below original grade. Bottom maximum depth 6.0 feet below original grade. Effective area begins at 4.0 feet below original grade. 2.0 feet of stone below distribution pipe.

LOCATION - Beginning from the right rear (525.03'/410.00') lot corner, place the distribution box 120 feet down the rear (410.00') lot line and 60 feet off the rear line as seen when facing property from Fulton Estates Court. Run trenches along contour towards the rear/right lot corner.

NOTES - No trench to exceed 100 feet in length. Provide 6" - 8" diameter cleanout and cap to grade or above on septic tank. 11/22/99 OK ALL

PLANS APPROVED BY Bert Nixon/Amy McMillen DATE 11-03-99

COVER NO WORK UNTIL INSPECTED AND APPROVED

NEITHER THE HOWARD COUNTY COUNCIL NOR THE HEALTH DEPARTMENT IS RESPONSIBLE FOR THE SUCCESSFUL OPERATION OF ANY SYSTEM

NOTE: CLEANOUT REQUIRED EVERY 70 FEET OF SEWER LINE AND/OR AT 90° SWEEPS IN LINES FROM HOUSE TO DRAIN FIELDS, 90° ELBOWS NOT ACCEPTABLE.

NOTE: ALL PARTS OF SEPTIC SYSTEMS (I.E. TANK, DISTRIBUTION BOX TRENCHES) TO BE 100 FEET FROM WELL (UNLESS OTHERWISE SPECIFICALLY AUTHORIZED)

NOTE: IF DEEP TRENCH(ES) ARE USED CALL FOR INSPECTION BEFORE AND AFTER PLACING GRAVEL IN TRENCH(ES)

NOTE: NO DRY WELL SHALL EXCEED 15 FOOT IN DIAMETER NO ABSORPTION TRENCH TO EXCEED 100 FEET IN LENGTH

NOTE: ALL PIPE FROM HOUSE TO SEPTIC TANK MUST BE CAST IRON OR SCHEDULE 35/40 PVC OR ABS

PERMIT VOID AFTER TWO YEARS

NOTE: INSTALL STAND PIPE ON SEPTIC TANK AND DRY WELL STAND PIPES MUST BE 6 INCHES IN DIAMETER CAST IRON. CONCRETE OR TERRA COTTA OR PVA OR ABS ACCEPTED. IF TOP OF SEPTIC TANK IS DEEPER THAN 3 FEET. MANHOLE TO GRADE REQUIRED.

NOTE: DISTRIBUTION BOXES MUST HAVE BAFFLES

***INSTALLER IS RESPONSIBLE FOR OBTAINING FINAL APPROVAL ON THIS PERMIT**

***CALL 461-9933 FOR INSPECTION OF SEPTIC SYSTEM.**

A 37269

APPLICATION

PERCOLATION TESTING

HOWARD COUNTY HEALTH DEPARTMENT
BUREAU OF ENVIRONMENTAL HEALTH
P.O. BOX 476 ELLICOTT CITY, MARYLAND 21043
TELEPHONE: 461-9933

A 37269
P 9
SOLID PERSONS

DISTRICT 0

DATE 4/25/86

MALLOY

D

TO: THE COUNTY HEALTH OFFICER
ELLICOTT CITY, MARYLAND

I, HEREBY, APPLY FOR THE NECESSARY TEST IN ORDER TO CONSTRUCT (OR RECONSTRUCT) A SEWAGE DISPOSAL SYSTEM.

PROPERTY OWNER Robert E. Bessler, et al

ADDRESS 6389 Ten Oaks Rd., Clarksville, Maryland PHONE 596-9300

PROSPECTIVE BUYER Potomac Building & Development Corporation

ADDRESS 3517 Spencerville Rd., Burtonsville, Md. PHONE 421-4030

PROPERTY LOCATION:

SUBDIVISION Fulton Estates LOT NO. 1

ROAD AND DESCRIPTION Route 216 - south side of Route 216 approximately 1000 feet west of Pindell School Road

TAX MAP 41 PARCEL # 69 & 203

ETAO

SIZE OF LOT 3 Acre TYPE BLDG. Single Family
(SINGLE FAMILY DWELLING OR COMMERCIAL)

THE SYSTEM INSTALLED UNDER THIS APPLICATION IS ACCEPTABLE ONLY UNTIL PUBLIC FACILITIES BECOME AVAILABLE. I FULLY UNDERSTAND THE FEE CONNECTED WITH THE FILING OF THIS PERC TEST APPLICATION IS NON-REFUNDABLE UNDER ANY CIRCUMSTANCES. I ALSO AGREE TO COMPLY WITH ALL M.O.S.H.A. REQUIREMENTS IN TESTING THIS LOT.

[Signature]
(SIGNATURE OF APPLICANT)

APPROVED BY _____ FOR _____ DATE _____

REJECTED BY _____ FOR _____ DATE _____

HOLD PENDING FURTHER TESTS _____ DATE _____

REASONS FOR REJECTION OR HOLDING _____

THIS IS NOT A PERMIT

8215-1018

lot # 1

5

SOIL PROFILE

hard chunky yellow/brown clay loam
4' changing to fine powdery purple/tan silty micaceous loam
≈ 5% small frag ssp

14" D

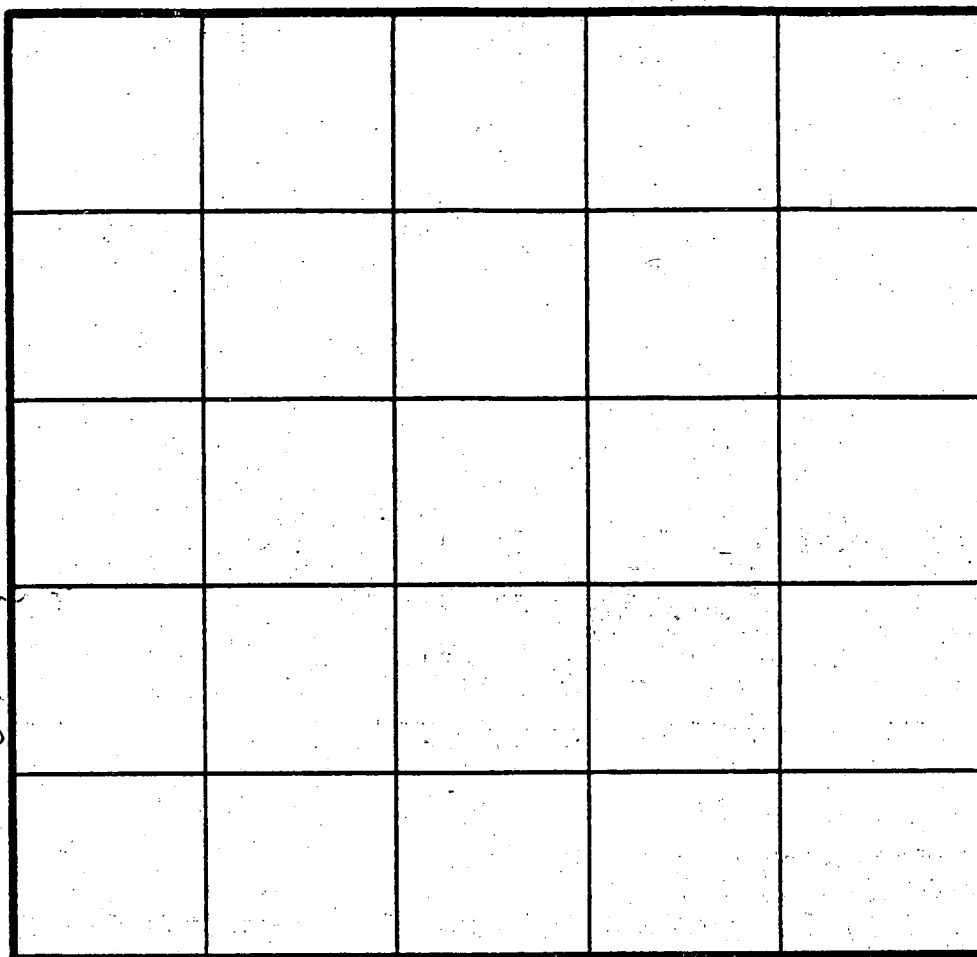

$\bar{X} = 8^+ \text{ MIN}$
INLET 3 1/2'
MAX 8 1/4'
180° / BD

6

hard chunky red/brown clay-clay loam
↓ purple powdery silty/mica to orange brown micaceous loam

12 1/2" D

INDICATE NORTH - NAME ADJOINING ROADWAY AS BASE LINE:

| DATE | TEST NO. | DEPTH | PRE-WET | | TEST - 1" DROP | | TIME | |
|---------|----------|--------------|--------------------|------|----------------|------|--------|--|
| | | | START | STOP | START | STOP | | |
| 7/29/86 | 5 | 3 1/2 S | 1038 | 1040 | 1040 | 1043 | 3 MIN | |
| | | 8' M | 1038 | 1041 | 1041 | 1046 | 5 MIN | |
| | | 14' D | bottom see profile | | | | | |
| | 6 | 3' S 4' S | 1048 1206 | 1212 | 1212 | 1225 | 13 MIN | |
| | | 7 1/2 M | 1049 | 1052 | 1052 | 1057 | 5 MIN | |
| | | 12 1/2 D | bottom see profile | | | | | |
| | | | | | | | | |
| | | | | | | | | |
| | | | | | | | | |
| | | | | | | | | |

REMARKS

perc field readjusted due to H₂O, lot OK on higher side

TYPE OF SOIL

hard chunky clay loams to 4-5 ft below soft silty micaceous loams

TESTED BY

B. Nyon

ALSO PRESENT

Allen R. Davis

APPLICATION

July 28
July 29
July 30
July 31

PERCOLATION TESTING

HOWARD COUNTY HEALTH DEPARTMENT
BUREAU OF ENVIRONMENTAL HEALTH
P.O. BOX 476 ELLICOTT CITY, MARYLAND 21043
TELEPHONE: 461-9933

A 37269
P _____
3.11FOR J.102

7/29/86
perc - OK'd
pending plat
(B)

DISTRICT _____
DATE 6/25/86

TO: THE COUNTY HEALTH OFFICER
ELLICOTT CITY, MARYLAND

CHASE Residential Devel. Corp.
ASSOCIATED Companies
N.V. Homes - 320-2269

I, HEREBY, APPLY FOR THE NECESSARY TEST IN ORDER TO CONSTRUCT (OR RECONSTRUCT) A SEWAGE DISPOSAL SYSTEM.

PROPERTY OWNER Robert E. Bessler, et al

ADDRESS 6389 Ten Oaks Rd., Clarksville, Maryland PHONE 596-9300

POTOMAC BUILDING & DEVELOPMENT CORPORATION
PROSPECTIVE BUYER LARRY ANDREWS

ADDRESS 3517 Spencerville Rd., Burtonsville, Md. PHONE 421-4030

PROPERTY LOCATION:

SUBDIVISION Fulton Estates LOT NO. 1

ROAD AND DESCRIPTION Route 216 - south side of Route 216 approximately 1000 feet west of Pindell School Road (12105 Fulton Estates Court)

TAX MAP 41 PARCEL # 69 & 203

BLDG. PERMIT SIGNED
AND RETURNED 11-3-79
Serial # B/M 120873

SIZE OF LOT 3 Acre TYPE BLDG. Single Family - 5 Bed
(SINGLE FAMILY DWELLING OR COMMERCIAL)

THE SYSTEM INSTALLED UNDER THIS APPLICATION IS ACCEPTABLE ONLY UNTIL PUBLIC FACILITIES BECOME AVAILABLE. I FULLY UNDERSTAND THE FEE CONNECTED WITH THE FILING OF THIS PERC TEST APPLICATION IS NON-REFUNDABLE UNDER ANY CIRCUMSTANCES. I ALSO AGREE TO COMPLY WITH ALL M.O.S.H.A. REQUIREMENTS IN TESTING THIS LOT.

Larry D Andrews VP
(SIGNATURE OF APPLICANT)

APPROVED BY _____ FOR _____ DATE _____

REJECTED BY _____ FOR _____ DATE _____

HOLD PENDING FURTHER TESTS _____ DATE _____

REASONS FOR REJECTION OR HOLDING certified plat with all holes filled
located

BLDG. PERMIT SIGNED
AND RETURNED 3/12/90
Serial # 31593 - Submittal
BLDG. PERMIT SIGNED
AND RETURNED 9/7/89
Serial # 28796 - 5 FD - 4 Bu

THIS IS NOT A PERMIT

DATE
 9-22-99
 9-28-99

LEGEND
 CONTOUR INTERVAL 2 FT.
 EXISTING CONTOUR 302
 PROPOSED CONTOUR 302
 DIRECTION OF DRAINAGE
 WALK OUT BASEMENT
 SPOT ELEVATION +78±
 LIMIT OF DISTURBANCE L.O.D.

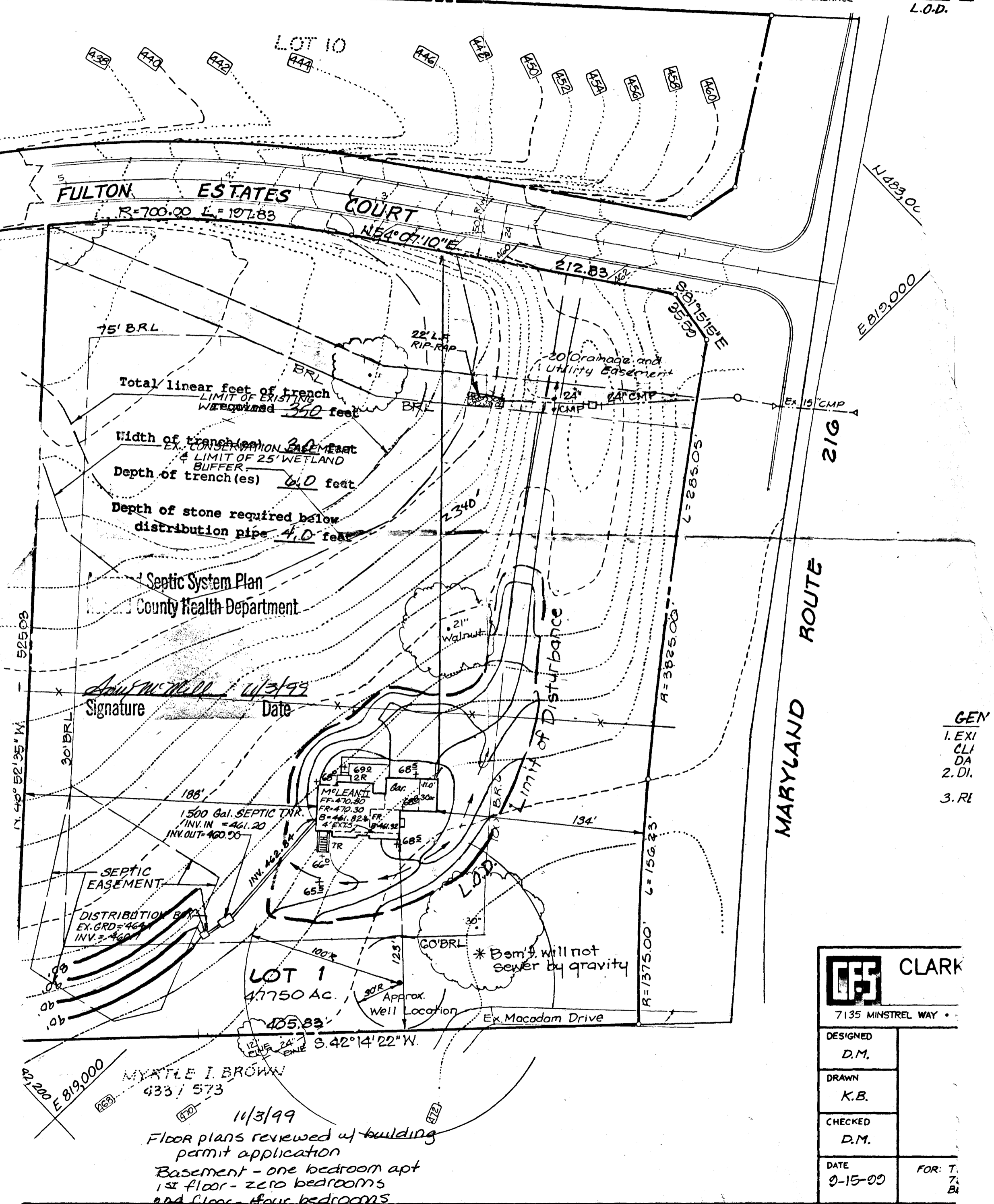

Ann M. Hill 11/3/99
 Signature Date

GEN
 1. EXI
 CL
 DA
 2. DI.
 3. RE

| | |
|-------------------|---------|
| CLARK | |
| 7135 MINSTREL WAY | |
| DESIGNED | D.M. |
| DRAWN | K.B. |
| CHECKED | D.M. |
| DATE | 9-15-99 |
| FOR: T. | 7. |
| | 8. |

MYRTLE I. BROWN
 433 / 573
 11/3/99
 Floor plans reviewed w/ building permit application
 Basement - one bedroom apt
 1st floor - zero bedrooms
 2nd floor - four bedrooms

Total = 5 bedrooms
 Ann Hill

C1 2487

SEQUENCE NO. (DENV USE ONLY)

STATE OF MARYLAND WELL COMPLETION REPORT

THIS REPORT MUST BE SUBMITTED WITHIN 45 DAYS AFTER WELL IS COMPLETED.

(THIS NUMBER IS TO BE PUNCHED IN COLS. 3-6 ON ALL CARDS)

COUNTY NUMBER A32269

DATE Received

DATE WELL COMPLETED 062789

Depth of Well 500 (TO NEAREST FOOT)

PERMIT NO. FROM "PERMIT TO DRILL WELL" 40-88-1649

OWNER N.V. Harms last name Estate - Pt first name TOWN Fulton SUBDIVISION FULTON ESTATES SECTION LOT 1

WELL LOG table with columns: DESCRIPTION (Use additional sheets if needed), FEET (FROM, TO), Check if water bearing. Includes handwritten entries: OB, Sandstone, shale, 0-25, 25-500, 140, 122.

GROUTING RECORD. WELL HAS BEEN GROUTED (Y). TYPE OF GROUTING MATERIAL: CEMENT (CM), BENTONITE CLAY (BC). NO. OF BAGS: 20. NO. OF POUNDS: 2000. GALLONS OF WATER: 120. DEPTH OF GROUT SEAL: 0-120 ft.

CASING RECORD. casing types: ST (STEEL), CO (CONCRETE). MAIN CASING TYPE: ST. Nominal diameter: 6 inch. Total depth of main casing: 122 feet.

OTHER CASING (if used) section with diameter and depth fields.

SCREEN RECORD. screen type: ST (STEEL). BR (BRASS), HO (OPEN HOLE), PL (PLASTIC), OT (OTHER).

DEPTH (nearest ft.) table with rows for casing and screen depths. Includes handwritten values: 40, 120, 500.

A CIRCLE APPROPRIATE LETTER A WELL WAS ABANDONED AND SEALED WHEN THIS WELL WAS COMPLETED. E ELECTRIC LOG OBTAINED. P TEST WELL CONVERTED TO PRODUCTION WELL.

I HEREBY CERTIFY THAT THIS WELL HAS BEEN CONSTRUCTED IN ACCORDANCE WITH COMAR 10.17.13 "WELL CONSTRUCTION" AND IN CONFORMANCE WITH ALL CONDITIONS STATED IN THE ABOVE CAPTIONED PERMIT, AND THAT THE INFORMATION PRESENTED HEREIN IS ACCURATE AND COMPLETE TO THE BEST OF MY KNOWLEDGE.

DRILLERS IDENT. NO. 144. DRILLERS SIGNATURE Austin Harms. SITE SUPERVISOR responsible for sitework if different from permittee.

GRAVEL PACK IF WELL DRILLED WAS FLOWING WELL INSERT F IN BOX 68.

OEP USE ONLY (NOT TO BE FILLED IN BY DRILLER). T TELESCOPE CASING, LOG INDICATOR, WQ OTHER DATA.

PUMPING TEST. HOURS PUMPED: 2. PUMPING RATE: 2 gal. per min. to nearest gal. METHOD USED TO MEASURE PUMPING RATE: Pump test. WATER LEVEL: 25 ft. BEFORE PUMPING, 100 ft. WHEN PUMPING. TYPE OF PUMP USED: S (submersible).

PUMP INSTALLED. DRILLER WILL INSTALL PUMP YES (NO). TYPE OF PUMP INSTALLED: S. CAPACITY: 2 gallons per minute. PUMP HORSE POWER: 37. PUMP COLUMN LENGTH: 43 feet. CASING HEIGHT: 2 feet above land surface.

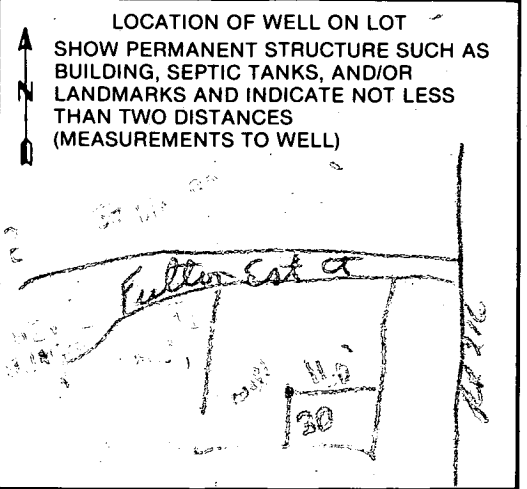

B 1 5612 SEQUENCE NO. (DP USE ONLY)
1 2 3 4 5 6
(THIS NUMBER IS TO BE PUNCHED IN COLS. 3-6 ON ALL CARDS)

STATE OF MARYLAND
PERMIT TO DRILL WELL
please print or type

STATE PERMIT NUMBER
H0-88-0649
70 fill in this form completely. 79

OWNER INFORMATION
Date Received (APA) 050289
VV HOMES MD CENTRAL Div.
15 Last Name Owner First Name 34
102 NEW HAMPSHIRE AVE
36 Street or RFD 55
SILVER SPRING MD 20902
57 Town 70 State 72 Zip 76

LOCATION OF WELL R-44140
1 2 HOWARD 5/4/89
8 COUNTY 21 40.10
FULTON EST
23 SUBDIVISION 42
SECTION 44 46 LOT 1 48 50 #12105
FULTON
52 NEAREST TOWN 71
MILES FROM TOWN (enter 0 if in town) 73 76 77 78

DRILLER INFORMATION
Driller's Name Austin Haver
77 License No. 80 144
Firm Name Haver Haver
Address 19125 Bethel rd Fred
Signature Austin Haver Date 4-27-89

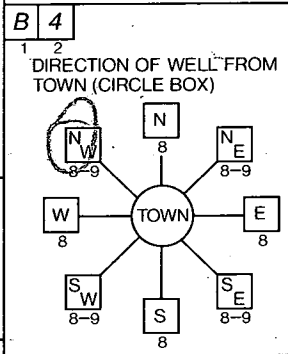

11 216 30
NEAR WHAT ROAD
ON WHICH SIDE OF ROAD (CIRCLE APPROPRIATE BOX)
NORTH N
WEST W 32 EAST E
SOUTH S
34 100 37
DISTANCE FROM ROAD
ENTER FT or MI FT 38 39

WELL INFORMATION
APPROX. PUMPING RATE (GAL. PER MIN.) 2 8 12
AVERAGE DAILY QUANTITY NEEDED (GAL. PER DAY) 300 14 20

USE FOR WATER (CIRCLE APPROPRIATE BOX)
 HOME (SINGLE OR DOUBLE HOUSEHOLD UNIT ONLY)
 FARMING (LIVESTOCK WATERING & AGRICULTURAL IRRIGATION)
 INDUSTRIAL, COMMERCIAL, STATE AND FEDERAL GOV. OTHER (REQUIRES APPROPRIATION PERMIT)
 PUBLIC OR PRIVATE WATER COMPANY (REQUIRES APPROPRIATION PERMIT AND STATE HEALTH DEPARTMENT APPROVAL)
 TEST, OBSERVATION, MONITORING (MAY REQUIRE APPROPRIATION PERMIT)

NOT TO BE FILLED IN BY DRILLER HEALTH DEPARTMENT APPROVAL
Howard A37269
COUNTY NAME COUNTY NO.
STATE SIGNATURE DATE ISSUED INSERT S
053189 Mark E. Reffkin 11/30/89
43 48 CO SIGNATURE EXP. DATE
NORTH GRID 482000 EAST GRID 0819000
50 55 57 63

APPROXIMATE DEPTH OF WELL 400 24 28 FEET

APPROXIMATE DIAMETER OF WELL 6 INCH NEAREST

METHOD OF DRILLING (circle one)
BORED (or Augered) JETTED Jetted & DRIVEN
30 AIR-ROTARY AIR-PERCussion ROTARY (Hydraulic Rotary)
37 CABLE REVERSE-ROTARY Drive-POINT
other

SHOW MAJOR FEATURES OF BOX & LOCATE WELL WITH AN X
SOURCES OF DRILLING WATER
1. well
2.
3.
WRITE THE BOX NUMBER FROM THE MAP HERE
E 819
N 482
000 000
6/27/89 11:00 G PROD NOT
20 BAGS OBS'D
50' OPEN
122' CASING
2' CASING A.G. HR
WRONG TAG
WILL 6/27/89
TAG CORRECT

REPLACEMENT OR DEEPEMED WELLS (CIRCLE APPROPRIATE BOX)
 THIS WELL WILL NOT REPLACE AN EXISTING WELL
 THIS WELL WILL REPLACE A WELL THAT WILL BE ABANDONED AND SEALED
39 THIS WELL WILL REPLACE A WELL THAT WILL BE USED AS A STANDBY
 THIS WELL WILL DEEPEEN AN EXISTING WELL
PERMIT NUMBER OF WELL TO BE REPLACED OR DEEPEMED (IF AVAILABLE) 41 J B OSWIG 52

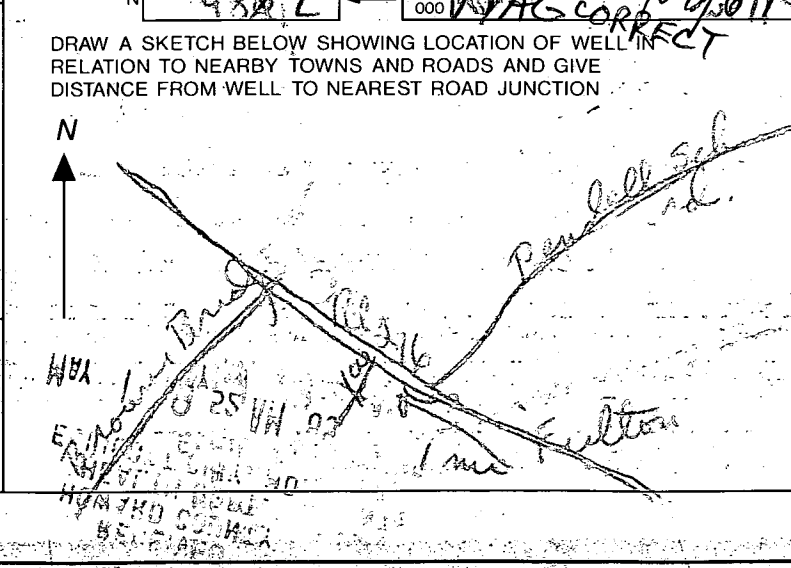

Not to be filled in by driller (OEP USE ONLY)
APPROX. PERMIT NUMBER 54 GAP 63
FORCE MR WRITE INITIALS IN BOX PERMIT No. H0-88-0649
67 68 70 71 72 73 74 75 76 77 78 79

SPECIAL CONDITIONS

WPI 3/15/00
10 am

Bryan

HOWARD COUNTY HEALTH DEPARTMENT
Bureau of Environmental Health
3525-H Ellicott Mills Drive
Ellicott City, MD 21043

~~461-9933~~

410-313-2640

APPLICATION FOR PITLESS ADAPTER, WELL PUMP AND PRESSURE TANK INSTALLATION

New Installation
Replacement

Receipt # _____
Date 3-13-00

Name of Installer Lester C Simmons Jr.

Telephone _____

License Number JWD 611

Certified Well Pump Installer Well Driller Registered Plumber

Name of Property Owner Chase Communities

Telephone _____

Subdivision _____ Lot # _____

Well Tag # HO-88-0649

Site Address 12105 Fulton East Ct

Pump

- 1. Type
 - a. Deep well jet _____
 - b. Shallow well jet _____
 - c. Submersible

Motor

- 1. Horsepower _____
- 2. RPM 3450
- 3. Voltage _____
 - a. 110 _____
 - b. 220

Pitless Adapter

- 1. Make Mattinson
- 2. Model # B-10K
- 3. Depth 3 1/2

2. Make Goulds

3. Model # 5GS104A2

4. Capacity 5 GPM

5. Pump exceeds well capacity Yes _____ No

6. If Yes, is low pressure cutoff switch installed? Yes _____ No _____

7. What methods are used to protect the pump and electrical wiring from vibrations? Torque arrestors _____ Cable guards Other _____

Tank

- 1. Capacity 82
- 2. Pressure relief valve? yes

Piping

- 1. Type PE
- 2. Size 1"
- 3. NSF and/or BOCA Code approved yes
- 4. Depth of supply line 3 1/2

Well data

- 1. Depth 500 ft.
- 2. Yield 5 GPM
- 3. Static water level _____ ft.
- 4. Will water supply be disinfected by installer? yes

well line P.A. 3.5' b.g.
well casing 1.5' a.g.
PVC conduit or
2 pc cap or drain cover

I understand that it is my responsibility to notify the Howard County Health Department when the installation is ready for inspection (otherwise this permit is null and void).

All information given above is true to the best of my knowledge.

Signature of Applicant: Lester C Simmons Jr.

Date: 3-13-00

Note: A sticker indicating approval/status of the installation will be placed on the well casing at the time of the inspection.

FOOD 122c 2 gpm 20 Bags Cement
 T 10:00 & 11:00

Page 1 of 1
 Date 6-27-89

Review ok 7/11/89 CW

FIELD DATA SHEET
HOWARD COUNTY WELL YIELD TEST

Well Permit No. HO - 88-0649
 Location of property (road) Estates Ct
 Subdivision Fulton Estates Lot 1 Block Plat Sec.
 Well Driller Austin Garver Owner NV Homes

Depth of well 500'
 Distance of measuring point (M.P.) above ground 22ft
 Static water level (S.W.L.) below M.P. 25ft

I. High rate pumping -- reservoir drawdown

Time pump started 10:00 Pumping rate 12.5 gpm
 Total time 15 min to reach pumping water level 100 ft. below M.P.
15

II. Recovery pump test data - observations to be recorded every 15 minutes

| TIME (in 15 minute intervals) | WATER LEVEL below M.P. | PUMPING RATE time to fill 1 gallon bucket | FLOW METER READING (if used) | CALCULATED FLOW (gallons per minute) |
|-------------------------------|------------------------|---|------------------------------|--------------------------------------|
| 10:00 | 25 ft | 5 sec. | | 12 gpm |
| 10:15 | 100 ft | 30 sec | | 2 gpm |
| 10:30 | 100 ft | 30 sec | | 2 gpm |
| 10:45 | 100 ft | 30 sec | | 2 gpm |
| 11:00 | 100 ft | 30 sec | | 2 gpm |
| 11:15 | 100 ft | 30 sec | | 2 gpm |
| 11:30 | 100 ft | 30 sec | | 2 gpm |
| 11:45 | 100 ft | 30 sec | | 2 gpm |
| 12:00 | 100 ft | 30 sec | | 2 gpm |
| 12:15 | 100 ft | 30 sec | | 2 gpm |
| 12:30 | 100 ft | 30 sec | | 2 gpm |
| 12:45 | 100 ft | 30 sec. | | 2 gpm |
| 1:00 | 100 ft | 30 sec. | | 2 gpm |
| 1:15 | 100 ft | 30 sec. | | 2 gpm. |
| 1:30 | 100 ft | 30 sec | | 2 gpm |
| 1:45 | 100 ft | 30 sec | | 2 gpm |
| 2:00 | 100 ft | 30 sec | | 2 gpm |
| 2:15 | 100 ft | 30 sec | | 2 gpm |
| 2:30 | 100 ft | 30 sec | | 2 gpm |
| 2:45 | 100 ft | 30 sec | | 2 gpm |
| 3:00 | 100 ft | 30 sec | | 2 gpm |
| 3:15 | 100 ft | 30 sec | | 2 gpm |
| 3:30 | 100 ft | 30 sec | | 2 gpm |
| 3:45 | 100 ft | 30 sec | | 2 gpm |
| HD-224 4:00 | 100 ft | 30 sec | | 2 gpm |