

C1 06718 SEQUENCE NO. (MDE USE ONLY)

STATE OF MARYLAND WELL COMPLETION REPORT FILL IN THIS FORM COMPLETELY PLEASE PRINT OR TYPE

THIS REPORT MUST BE SUBMITTED WITHIN 45 DAYS AFTER WELL IS COMPLETED.

COUNTY NUMBER 511427C

ST/CO USE ONLY DATE RECEIVED MM DD YY

DATE WELL COMPLETED MM DD YY 5 12 99 Depth of Well 22 200 26 (TO NEAREST FOOT)

PERMIT NO. FROM "PERMIT TO DRILL WELL" HO-94-2221

OWNER Zielshi Warren STREET OR RFD Cedar Lane TOWN Near Columbia SUBDIVISION Bray Property SECTION LOT 3

WELL LOG Not required for driven wells. STATE THE KIND OF FORMATIONS PENETRATED, THEIR COLOR, DEPTH, THICKNESS AND IF WATER BEARING. DESCRIPTION (Use additional sheets if needed) FEET FROM TO check if water bearing. Sand 0 57. Gray mica Rock 57 200.

GROUTING RECORD WELL HAS BEEN GROUTED (Y) (N) TYPE OF GROUTING MATERIAL (Circle one) CEMENT (CM) BENTONITE CLAY (BC) NO. OF BAGS 16 NO. OF POUNDS 1504 GALLONS OF WATER 96 DEPTH OF GROUT SEAL (to nearest foot) from 0 ft. to 42 ft.

CASING RECORD casing types insert appropriate code below. MAIN CASING TYPE ST Nominal diameter top (main) casing (nearest inch)! 6 Total depth of main casing (nearest foot) 60

OTHER CASING (if used) diameter inch depth (feet) from to

SCREEN RECORD screen type or open hole (insert appropriate code below) ST BR HO PL OT

NUMBER OF UNSUCCESSFUL WELLS: 0 WELL HYDROFRACTURED YES (Y) NO (N)

CIRCLE APPROPRIATE LETTER A A WELL WAS ABANDONED AND SEALED WHEN THIS WELL WAS COMPLETED E ELECTRIC LOG OBTAINED P TEST WELL CONVERTED TO PRODUCTION WELL

I HEREBY CERTIFY THAT THIS WELL HAS BEEN CONSTRUCTED IN ACCORDANCE WITH COMAR 26.04.04 "WELL CONSTRUCTION" AND IN CONFORMANCE WITH ALL CONDITIONS STATED IN THE ABOVE CAPTIONED PERMIT, AND THAT THE INFORMATION PRESENTED HEREIN IS ACCURATE AND COMPLETE TO THE BEST OF MY KNOWLEDGE.

DRILLERS LIC. NO. 1 M SDO 27 DRILLERS SIGNATURE Joseph L. Mayne LIC. NO. 1 M SDO 27

SITE SUPERVISOR (sign. of driller or journeyman responsible for sitework if different from permittee)

DEPTH (nearest ft.) 1 2 3 4 5 6 7 8 9 10 11 12 13 14 15 16 17 18 19 20 21 22 23 24 25 26 27 28 29 30 31 32 33 34 35 36 37 38 39 40 41 42 43 44 45 46 47 48 49 50 51 52 53 54 55 56 57 58 59 60 61 62 63 64 65 66 67 68 69 70 71 72 73 74 75 76

GRAVEL PACK IF WELL DRILLED WAS FLOWING WELL INSERT F IN BOX 68 MDE USE ONLY (NOT TO BE FILLED IN BY DRILLER) T (E.R.O.S.) W Q LOG INDICATOR OTHER DATA

PUMPING TEST HOURS PUMPED (nearest hour) 3 PUMPING RATE (gal. per min.) 8.5 METHOD USED TO MEASURE PUMPING RATE Bucket WATER LEVEL (distance from land surface) BEFORE PUMPING 35 ft. WHEN PUMPING 100 ft. TYPE OF PUMP USED (for test) S submersible

PUMP INSTALLED DRILLER WILL INSTALL PUMP YES (NO) TYPE OF PUMP INSTALLED PLACE (A,C,J,P,R,S,T,O) IN BOX 29 CAPACITY: GALLONS PER MINUTE (to nearest gallon) 31 35 PUMP HORSE POWER 37 41 PUMP COLUMN LENGTH (nearest ft.) 43 47 CASING HEIGHT (circle appropriate box and enter casing height) (+) above LAND SURFACE (-) below (nearest foot) 1

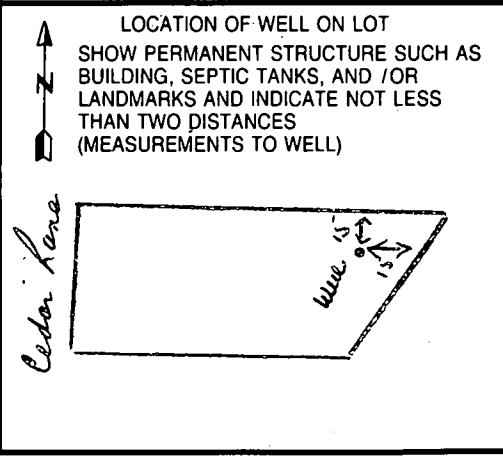

B 1 **7488**

SEQUENCE NO. (MDE USE ONLY)

STATE OF MARYLAND
PERMIT TO DRILL WELL
please print or type

STATE PERMIT NUMBER

HO - 94 - 2221

fill in this form completely

Date Received (APA)

04 13 99

OWNER INFORMATION

8 MM DD YY 13
Zielski **Warren**
15 Last Name Owner First Name 34
Box 436
36 Street or RFD 55
Stenerson Md. 21153
57 Town 70 State 72 Zip 76

B 3 LOCATION OF WELL

8 COUNTY **Howard** 21
23 SUBDIVISION **Bray Property** 42
SECTION **3** LOT **3**
44 46 48 50
Simpsonville
52 NEAREST TOWN 71
MILES FROM TOWN (enter 0 if in town) **1** M I
73 76 77 78

DRILLER INFORMATION

Driller's Name **Joseph L. Mayne MS D 024** 76 License No. 81
Firm Name **Joseph L. Mayne Well Drilling**
Address **5512 Ridge Rd. Mt. Airy 21771**
Signature **Joseph L. Mayne** Date **4/10/99**

B 4 DIRECTION OF WELL FROM TOWN (CIRCLE BOX)

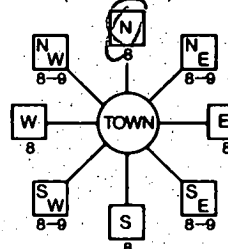

Cedar Lane
11 NEAR WHAT ROAD 30
ON WHICH SIDE OF ROAD (CIRCLE APPROPRIATE BOX)
NORTH N
WEST W
EAST E
SOUTH S
34 **310** 37
DISTANCE FROM ROAD FT
ENTER FT OR MI 38 39
TAX MAP: **35** BLK: _____ PARCEL **261**

B 2 WELL INFORMATION

APPROX. PUMPING RATE (GAL. PER MIN.) **5** 8 12
AVERAGE DAILY QUANTITY NEEDED (GAL. PER DAY) **500** 14 20

USE FOR WATER (CIRCLE APPROPRIATE BOX)

- DOMESTIC POTABLE SUPPLY & RESIDENTIAL IRRIGATION
- FARMING (LIVESTOCK WATERING & AGRICULTURAL IRRIGATION)
- INDUSTRIAL, COMMERCIAL, DEWATERING
- PUBLIC WATER SUPPLY WELL
- TEST, OBSERVATION, MONITORING
- GEO-THERMAL

NOT TO BE FILLED IN BY DRILLER HEALTH DEPARTMENT APPROVAL

Howard **511427C**
COUNTY NAME COUNTY NO.
STATE SIGNATURE **Steven R. Krieg** INSERT S → **S** 41
DATE ISSUED **04 15 99** **04 15 00**
43 MM DD YY 48 CO SIGNATURE EXP. DATE
NORTH GRID **495** 000 EAST GRID **831** 000
50 55 57 63

APPROXIMATE DEPTH OF WELL **300** FEET
24 28

APPROXIMATE DIAMETER OF WELL **6** INCH
NEAREST INCH

METHOD OF DRILLING (circle one)

BORED (or Augered) JETTED Jetted & DRIVEN
30 **AIR-ROTary** AIR-PERCussion ROTARY (Hydraulic Rotary)
37 CABLE REVERSE-ROTary DRIVE-POINT
other _____

REPLACEMENT OR DEEPEMED WELLS (CIRCLE APPROPRIATE BOX)

- THIS WELL WILL NOT REPLACE AN EXISTING WELL
- THIS WELL WILL REPLACE A WELL THAT WILL BE ABANDONED AND SEALED
- 39 THIS WELL WILL REPLACE A WELL THAT WILL BE USED AS A STANDBY-CONTACT LOCAL APPROVING AUTHORITY FOR POLICY ON STANDBY WELLS
- THIS WELL WILL DEEPEMED AN EXISTING WELL

PERMIT NUMBER OF WELL TO BE REPLACED OR DEEPEMED (IF AVAILABLE) 41 _____ 52

Not to be filled in by driller (MDE OR COUNTY USE ONLY)

APPROX. PERMIT NUMBER GAP
54 63
PERMIT No **HO - 94 - 2221**
70 71 72 73 74 75 76 77 78 79

SHOW MAJOR FEATURES OF BOX & LOCATE WELL WITH AN X

SOURCES OF DRILLING WATER
1. **Well**
2.
3.

WRITE THE BOX NUMBER FROM THE MAP HERE

E **8301**
N **4905**

DRAW A SKETCH BELOW SHOWING LOCATION OF WELL IN RELATION TO NEARBY TOWNS AND ROADS AND GIVE DISTANCE FROM WELL TO NEAREST ROAD JUNCTION

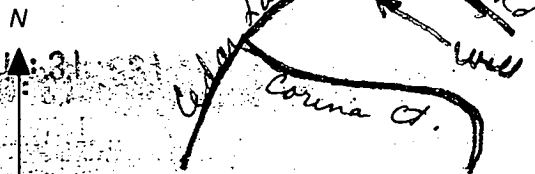

SPECIAL CONDITIONS

NOTE - APPROVING AUTHORITIES SHOULD USE SEPARATE SHEET IF NEEDED

Simpsonville

HOWARD COUNTY HEALTH DEPARTMENT
Bureau of Environmental Health
3525-B Millcott Mill Drive
Ellicott City, MD 21043
410-9938

APPLICATION FOR PITLESS ADAPTER, WELL PUMP AND PRESSURE TANK INSTALLATION

New Installation Replacement
Receipt # _____ Date 11-1-2000
Name of Installer Associated Plumbing Services Telephone 410-242-2600
License Number 1787 Certified Well Pump Installer _____ Well Driller _____ Registered Plumber
Name of Property Owner ADZ Homes Telephone 410-242-9641
Subdivision WHISPERING PINES Lot # 3 Well Tag # HO-24-2221
Site Address 6565 CEDAR LAKE

Pump Motor Pitless Adapter
1. Type 1. Horsepower 3/4 1. Make _____
a. Deep well jet _____ 2. RPM 3350 2. Model # _____
b. Shallow well jet _____ 3. Voltage _____ 3. Depth 4'-6"
c. Submersible a. 110 _____
2. Make Goulds b. 220 VVV
3. Model # 56507
4. Capacity 5 GPM
5. Pump exceeds well capacity Yes _____ No
6. If Yes, is low pressure cutoff switch installed? Yes _____ No _____
7. What methods are used to protect the pump and electrical wiring from vibrations? Torque arrestors Cable guards Other _____

Tank Piping Well data
1. Capacity _____ 1. Type _____ 1. Depth _____ ft.
2. Pressure relief valve? YES 75 PSI 2. Size _____ 2. Yield _____ GPM
3. NSF and/or BOCA Code approved _____ 3. Static water level _____ ft.
4. Depth of supply line _____ 4. Will water supply be disinfected by installer? _____

I understand that it is my responsibility to notify the Howard County Health Department when the installation is ready for inspection (otherwise this permit is null and void).

All information given above is true to the best of my knowledge.
Signature of Applicant: By: Howard J. Kappes *Associated Plumbing Services, Inc*
Date: 11-6-'00

Note: A sticker indicating approval/status of the installation will be placed on the well casing at the time of the inspection.
MD-215 11/8/00- Discussion w/Howard of APS. He did not call in for inspection of well line. Discussed proper procedure and new forms.
OK (BRK) Added APS to mailing list

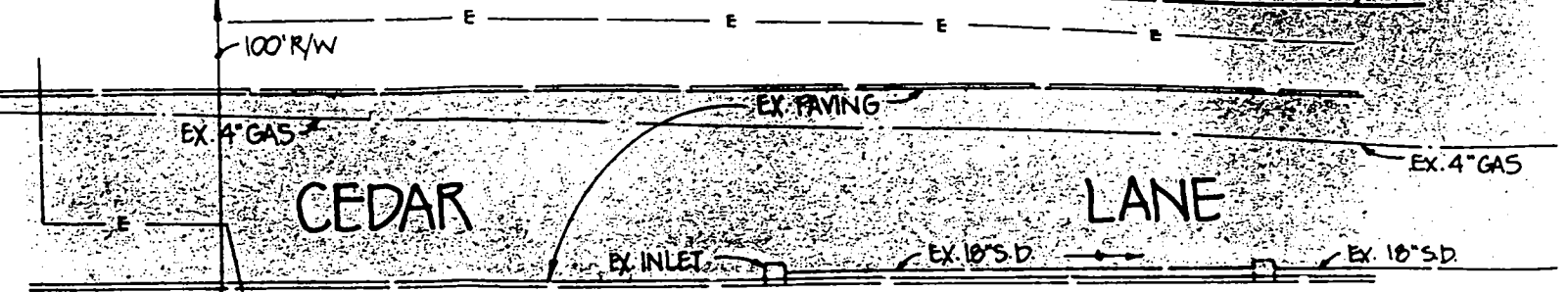

TO BE DEDICATED
 WARD COUNTY

MnD

MgC3

M1

LA 151A
 LOT 15 OF
 PROPERTY OF
 MR. & MRS. RAJENDRA TRIPATHI
 L. 02555, F. 0534

MR. & MRS. LONKAR
 L. 01102, F. 0366

LOT 1
 30,000 #

LOT 3
 30,300 #

LOT 2
 52,200 #

Well site approved as shown here
 S. 40° 53' E
 515.00'
 100' RAD.
 PROP. WELL

100' RAD.
 PROP. WELL

100' RAD.
 PROP. WELL

100' RAD.
 EX. WELL

307.50'

375

CEDAR

