

12/13/93  
AM

02-351957  
**PERMIT** ✓

**SEWAGE DISPOSAL SYSTEM**

**DEPARTMENT OF HEALTH AND MENTAL HYGIENE**

P 49802

A REPAIR

DISTRICT \_\_\_\_\_

DATE 12/16/93

**HOWARD COUNTY HEALTH DEPARTMENT**  
**BUREAU OF ENVIRONMENTAL HEALTH**  
~~XXXXXX~~ 313-2640

**INDEXED**  
*No need for Septic*  
*EXISTING SYSTEM*

DATE SYSTEM APPROVED 12/13/93

INSPECTOR RJP

Jenkins Brothers Septic Tank Service IS PERMITTED TO INSTALL \_\_\_\_\_ ALTER X

ADDRESS 7670 Smiths Private Road, Sykesville, Maryland 21784 PHONE 461-9282

SUBDIVISION \_\_\_\_\_ LOT \_\_\_\_\_ ROAD 4391 College Avenue

PROPERTY OWNER Bob Gravely

ADDRESS 4391 College Avenue  
Ellicott City, Maryland

SEPTIC TANK CAPACITY 1000 <sup>Existing</sup> GALLONS

NUMBER OF BEDROOMS 3

125 SQUARE FEET PER BEDROOM

*No Public Sewer per Jan*  
*Steel - 12/8/93*

LINEAR FEET OF TRENCH REQUIRED 65

REPAIR - PURPOSE - SEPTIC SYSTEM HAS FAILED.

Call for inspection when ground is opened so sanitarian can recommend repair. 12/08/93  
*Trench to be 65ft long, 3ft wide, 5ft of stone, in lot at S/Bottoma 10'*

*Treat tie in to existing Dry well. RJP 12/13/93*

*Need to fix broken cleanout pipe on existing ST. and plug hole in outlet Baffle Lid.*

PLANS APPROVED BY \_\_\_\_\_ DATE \_\_\_\_\_

COVER NO WORK UNTIL INSPECTED AND APPROVED

NEITHER THE HOWARD COUNTY COUNCIL NOR THE HEALTH DEPARTMENT IS RESPONSIBLE FOR THE SUCCESSFUL OPERATION OF ANY SYSTEM

NOTE: CLEANOUT REQUIRED EVERY 70 FEET OF SEWER LINE AND/OR AT 90° SWEEPS IN LINES FROM HOUSE TO DRAIN FIELDS, 90° ELBOWS NOT ACCEPTABLE.

NOTE: ALL PARTS OF SEPTIC SYSTEMS (I.E. TANK, DISTRIBUTION BOX TRENCHES) TO BE 100 FEET FROM WELL (UNLESS OTHERWISE SPECIFICALLY AUTHORIZED)

NOTE: IF DEEP TRENCH(ES) ARE USED CALL FOR INSPECTION BEFORE AND AFTER PLACING GRAVEL IN TRENCH(ES)

NOTE: NO DRY WELL SHALL EXCEED 15 FOOT IN DIAMETER NO ABSORPTION TRENCH TO EXCEED 100 FEET IN LENGTH

NOTE: ALL PIPE FROM HOUSE TO SEPTIC TANK MUST BE CAST IRON OR SCHEDULE 35/40 PVC OR ABS

PERMIT VOID AFTER TWO YEARS

NOTE: INSTALL STAND PIPE ON SEPTIC TANK AND DRY WELL STAND PIPES MUST BE 6 INCHES IN DIAMETER CAST IRON, CONCRETE OR TERRA COTTA OR PVA OR ABS ACCEPTED. IF TOP OF SEPTIC TANK IS DEEPER THAN 3 FEET. MANHOLE TO GRADE REQUIRED.

NOTE: DISTRIBUTION BOXES MUST HAVE BAFFLES

**\*INSTALLER IS RESPONSIBLE FOR OBTAINING FINAL APPROVAL ON THIS PERMIT**

*R 49802*

Red 2i30

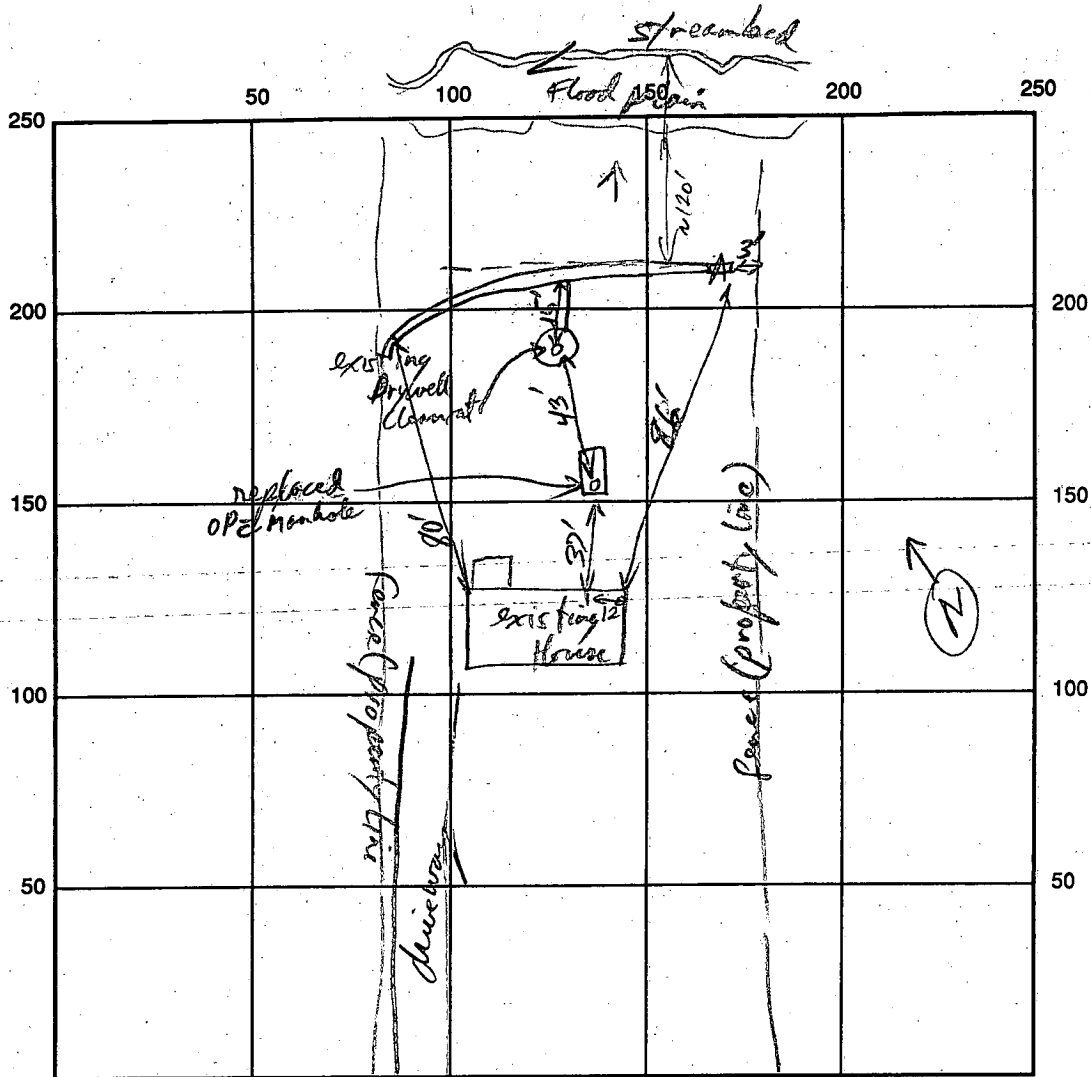

INDICATE NORTH - NAME ADJOINING ROADWAY AS BASE LINE  
College Ave

SEPTIC TANK LEVEL existing 100 gal CLEANOUTS New Manhole on S.T.  
 DISTRIBUTION BOX LEVEL NA  
 DRAIN FIELD/TITLE DEPTH 10 FT. TRENCH WIDTH 3 FT. INLET DEPTH 5 FT.  
 EFFECTIVE GRAVEL DEPTH 5 FT. TOTAL LENGTH 65 FT.  
 NUMBER OF TRENCHES 1 ONE SIDEWALL/BOTTOM AREA 395 SQ. FT.  
 DRYWALL INSIDE DIAMETER \_\_\_\_\_ FT. EFFECTIVE DEPTH BELOW INLET \_\_\_\_\_ FT.  
 ABSORBENT AREA \_\_\_\_\_ SQ. FT.

REMARKS: Begin Open Trench OK. R/P 12/13/93 New Manhole, Trench OK to cover

DATE SYSTEM APPROVED 12/13/93 INSPECTOR [Signature]