

PERMIT

SEWAGE DISPOSAL SYSTEM

DEPARTMENT OF HEALTH AND MENTAL HYGIENE

P 49773

A REPAIR

DISTRICT _____

DATE 11/30/93

DATE SYSTEM APPROVED 12/7/93

INSPECTOR M. Rifkin

HOWARD COUNTY HEALTH DEPARTMENT

BUREAU OF ENVIRONMENTAL HEALTH

~~764-9933~~ 313-2640

INDEXED

Jack Fyock Septic Service IS PERMITTED TO INSTALL _____ ALTER X

ADDRESS _____ PHONE 988-9270

SUBDIVISION _____ LOT _____ ROAD 13779 Old Rover Road

PROPERTY OWNER _____ Robert Ames Tax Map: 15

ADDRESS _____ 13779 Old Rover Road Parcel: 56

_____ West Friendship, Maryland 21794 Grid: 13

SEPTIC TANK CAPACITY 1000 GALLONS

NUMBER OF BEDROOMS 3

_____ SQUARE FEET PER BEDROOM

LINEAR FEET OF TRENCH REQUIRED _____

REPAIR - PURPOSE - METAL SEPTIC TANK HAS COLLAPSED. REPLACE THE SEPTIC TANK WITH A 1000 GALLON CONCRETE TANK.

Call for inspection when tank is in place so that a sanitarian can approve the size and location.

PLANS APPROVED BY _____ DATE _____

COVER NO WORK UNTIL INSPECTED AND APPROVED

NEITHER THE HOWARD COUNTY COUNCIL NOR THE HEALTH DEPARTMENT IS RESPONSIBLE FOR THE SUCCESSFUL OPERATION OF ANY SYSTEM

NOTE: CLEANOUT REQUIRED EVERY 70 FEET OF SEWER LINE AND/OR AT 90° SWEEPS IN LINES FROM HOUSE TO DRAIN FIELDS, 90° ELBOWS NOT ACCEPTABLE.

NOTE: ALL PARTS OF SEPTIC SYSTEMS (I.E. TANK, DISTRIBUTION BOX TRENCHES) TO BE 100 FEET FROM WELL (UNLESS OTHERWISE SPECIFICALLY AUTHORIZED)

NOTE: IF DEEP TRENCH(ES) ARE USED CALL FOR INSPECTION BEFORE AND AFTER PLACING GRAVEL IN TRENCH(ES)

NOTE: NO DRY WELL SHALL EXCEED 15 FOOT IN DIAMETER NO ABSORPTION TRENCH TO EXCEED 100 FEET IN LENGTH

NOTE: ALL PIPE FROM HOUSE TO SEPTIC TANK MUST BE CAST IRON OR SCHEDULE 35/40 PVC OR ABS

PERMIT VOID AFTER TWO YEARS

NOTE: INSTALL STAND PIPE ON SEPTIC TANK AND DRY WELL STAND PIPES MUST BE 6 INCHES IN DIAMETER CAST IRON. CONCRETE OR TERRA COTTA OR PVA OR ABS ACCEPTED. IF TOP OF SEPTIC TANK IS DEEPER THAN 3 FEET. MANHOLE TO GRADE REQUIRED.

NOTE: DISTRIBUTION BOXES MUST HAVE BAFFLES

***INSTALLER IS RESPONSIBLE FOR OBTAINING FINAL APPROVAL ON THIS PERMIT**

*CALL 461-9933 FOR INSPECTION OF SEPTIC SYSTEM.

P
49773

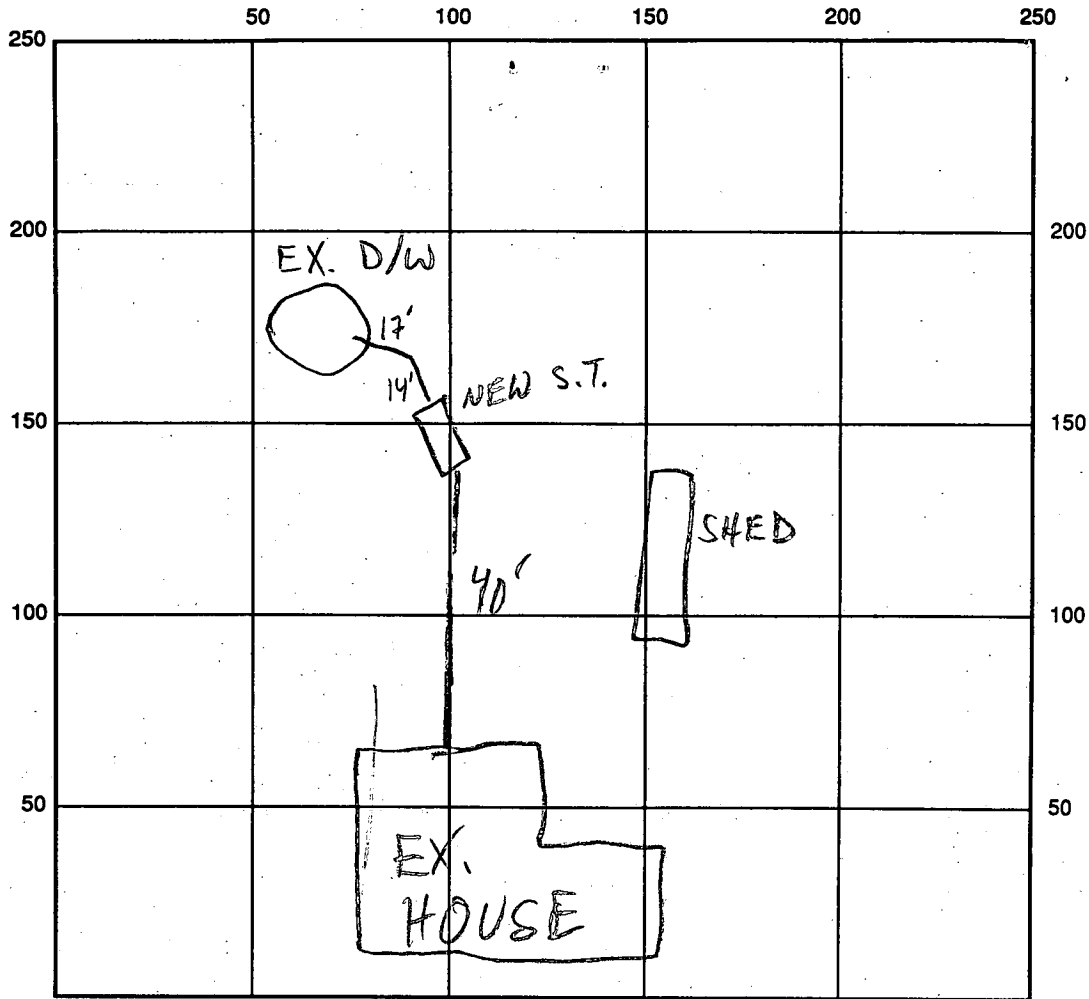

OLD ROVER RD INDICATE NORTH - NAME ADJOINING ROADWAY AS BASE LINE

SEPTIC TANK LEVEL 1000 GAL-OK CLEANOUTS _____

DISTRIBUTION BOX LEVEL _____

DRAIN FIELD/TITLE DEPTH _____ FT. TRENCH WIDTH _____ FT. INLET DEPTH _____ FT.

EFFECTIVE GRAVEL DEPTH _____ FT. TOTAL LENGTH _____ FT.

NUMBER OF TRENCHES _____ ONE SIDEWALL/BOTTOM AREA _____ SQ. FT.

DRYWALL INSIDE DIAMETER _____ FT. EFFECTIVE DEPTH BELOW INLET _____ FT.

ABSORBENT AREA _____ SQ. FT.

REMARKS: 12/7/93 EMERGENCY TANK REPLACEMENT COMPLETED
W/O INSP. - DRAWING PER. J. FROCK + OK FOR
FINAL MR

DATE SYSTEM APPROVED 12/7/93 INSPECTOR M. Ripkin