

12/2/93 ASAP

12/2 (1) F.C.O. Early C.B.D.

PERMIT

SEWAGE DISPOSAL SYSTEM

DEPARTMENT OF HEALTH AND MENTAL HYGIENE

02-217031

P 49772
P 46897
A REPAIR

DISTRICT _____

DATE 11/30/93

DATE SYSTEM APPROVED 12/2/93

INSPECTOR C.B.D.

HOWARD COUNTY HEALTH DEPARTMENT

BUREAU OF ENVIRONMENTAL HEALTH

~~XXXX-XXXX~~ 313-2640

INDEXED

Jack Fyock Septic Service _____ IS PERMITTED TO INSTALL _____ ALTER X

ADDRESS 13775 Triadelphia Road, Glenelg, Maryland 21737 PHONE 988-9270

SUBDIVISION _____ LOT _____ ROAD 8613 Old Frederick Road

PROPERTY OWNER _____ Donahue
ADDRESS _____ 8613 Old Frederick Road

SEPTIC TANK CAPACITY 1000 GALLONS

NUMBER OF BEDROOMS 3

_____ SQUARE FEET PER BEDROOM

LINEAR FEET OF TRENCH REQUIRED _____

REPAIR - PURPOSE - Septic System Has Failed.

Call for inspection when ground is opened so sanitarian can recommend repair. 11/24/93

12/2/93 (Please see -> Repair on P 46897)

PLANS APPROVED BY C.B.D. for Ms. C. "W." of site DATE 12/2/93

COVER NO WORK UNTIL INSPECTED AND APPROVED

NEITHER THE HOWARD COUNTY COUNCIL NOR THE HEALTH DEPARTMENT IS RESPONSIBLE FOR THE SUCCESSFUL OPERATION OF ANY SYSTEM

NOTE: CLEANOUT REQUIRED EVERY 70 FEET OF SEWER LINE AND/OR AT 90° SWEEPS IN LINES FROM HOUSE TO DRAIN FIELDS, 90° ELBOWS NOT ACCEPTABLE.

NOTE: ALL PARTS OF SEPTIC SYSTEMS (I.E. TANK, DISTRIBUTION BOX TRENCHES) TO BE 100 FEET FROM WELL (UNLESS OTHERWISE SPECIFICALLY AUTHORIZED)

NOTE: IF DEEP TRENCH(ES) ARE USED CALL FOR INSPECTION BEFORE AND AFTER PLACING GRAVEL IN TRENCH(ES)

NOTE: NO DRY WELL SHALL EXCEED 15 FOOT IN DIAMETER NO ABSORPTION TRENCH TO EXCEED 100 FEET IN LENGTH

NOTE: ALL PIPE FROM HOUSE TO SEPTIC TANK MUST BE CAST IRON OR SCHEDULE 35/40 PVC OR ABS

PERMIT VOID AFTER TWO YEARS

NOTE: INSTALL STAND PIPE ON SEPTIC TANK AND DRY WELL STAND PIPES MUST BE 6 INCHES IN DIAMETER CAST IRON, CONCRETE OR TERRA COTTA OR PVA OR ABS ACCEPTED. IF TOP OF SEPTIC TANK IS DEEPER THAN 3 FEET. MANHOLE TO GRADE REQUIRED.

NOTE: DISTRIBUTION BOXES MUST HAVE BAFFLES

***INSTALLER IS RESPONSIBLE FOR OBTAINING FINAL APPROVAL ON THIS PERMIT**

49772

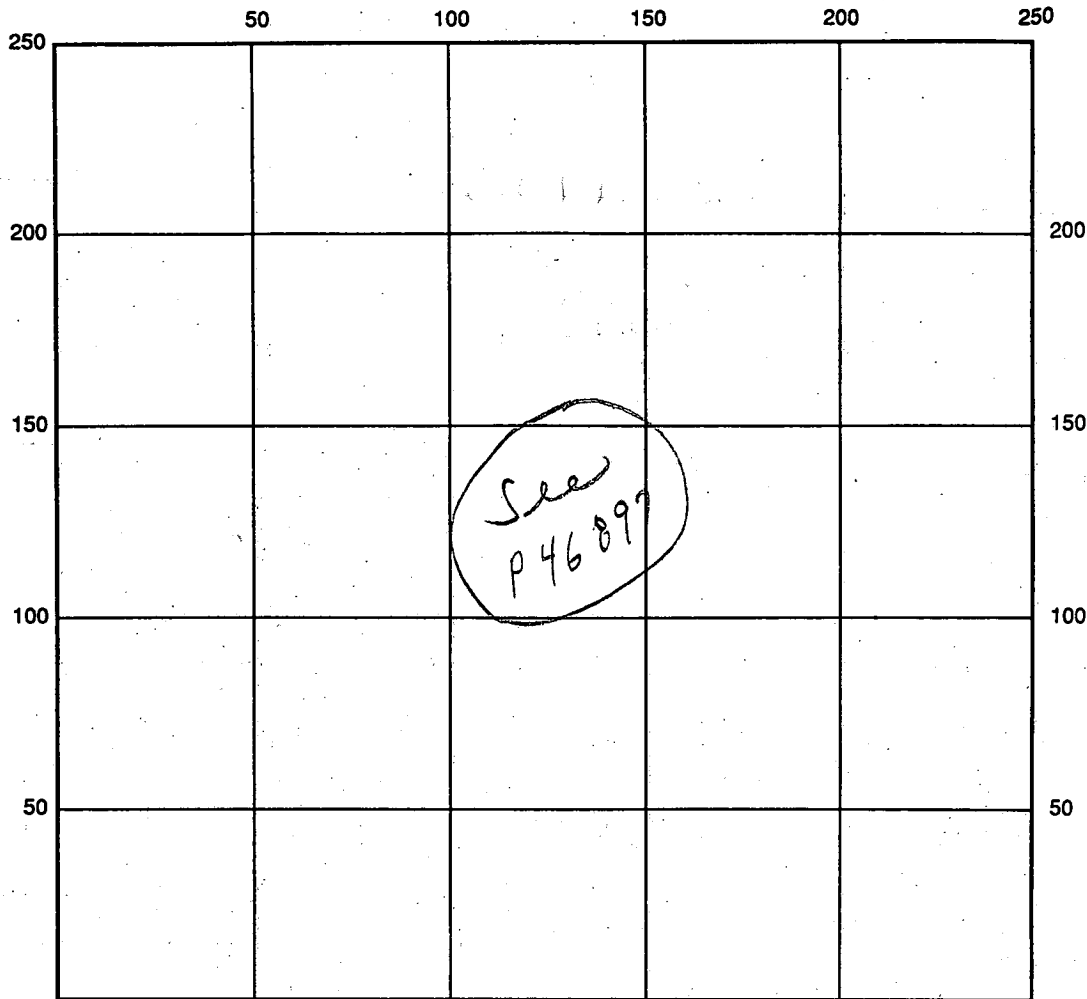

INDICATE NORTH - NAME ADJOINING ROADWAY AS BASE LINE

SEPTIC TANK LEVEL _____ CLEANOUTS _____

DISTRIBUTION BOX LEVEL _____

DRAIN FIELD/TITLE DEPTH _____ FT. TRENCH WIDTH _____ FT. INLET DEPTH _____ FT.

EFFECTIVE GRAVEL DEPTH _____ FT. TOTAL LENGTH _____ FT.

NUMBER OF TRENCHES _____ ONE SIDEWALL/BOTTOM AREA _____ SQ. FT.

DRYWALL INSIDE DIAMETER _____ FT. EFFECTIVE DEPTH BELOW INLET _____ FT.

ABSORBENT AREA _____ SQ. FT.

REMARKS: 12/2/93 please see (repair of 2/13/91) Trench 72'
added to rear of dry well; CBP

DATE SYSTEM APPROVED 12/2/93 INSPECTOR C.B. [Signature]

Pg 1 of 2

2/13/91
NOON
12/2/93

PERMIT

SEWAGE DISPOSAL SYSTEM

DEPARTMENT OF HEALTH AND MENTAL HYGIENE

P 46897

A REPAIR

DISTRICT _____

DATE 3/7/91

DATE SYSTEM APPROVED 2-13-91

INSPECTOR JEN

HOWARD COUNTY HEALTH DEPARTMENT
BUREAU OF ENVIRONMENTAL HEALTH
461-9933

INDEXED

Jack Fyock _____ IS PERMITTED TO INSTALL _____ ALTER

ADDRESS 137754 Triadelphia Road, Glenelg, Maryland 21737 PHONE 988-9270

SUBDIVISION _____ LOT _____ ROAD _____

PROPERTY OWNER _____ Donohue

ADDRESS _____ 8613 Old Frederick Road

SEPTIC TANK CAPACITY _____ GALLONS

NUMBER OF BEDROOMS _____

_____ SQUARE FEET PER BEDROOM

LINEAR FEET OF TRENCH REQUIRED _____

REPAIR - REPLACE METAL TANK AND OUTGOING LINE.

Note: also repair of 12/2/93 C. Bud.

PLANS APPROVED BY Craig Williams cm DATE 02/12/91

- COVER NO WORK UNTIL INSPECTED AND APPROVED
- NEITHER THE HOWARD COUNTY COUNCIL NOR THE HEALTH DEPARTMENT IS RESPONSIBLE FOR THE SUCCESSFUL OPERATION OF ANY SYSTEM
- NOTE: CLEANOUT REQUIRED EVERY 70 FEET OF SEWER LINE AND/OR AT 90° SWEEPS IN LINES FROM HOUSE TO DRAIN FIELDS, 90° ELBOWS NOT ACCEPTABLE.
- NOTE: ALL PARTS OF SEPTIC SYSTEMS (I.E. TANK, DISTRIBUTION BOX TRENCHES) TO BE 100 FEET FROM WELL (UNLESS OTHERWISE SPECIFICALLY AUTHORIZED)
- NOTE: IF DEEP TRENCH(ES) ARE USED CALL FOR INSPECTION BEFORE AND AFTER PLACING GRAVEL IN TRENCH(ES)
- NOTE: NO DRY WELL SHALL EXCEED 15 FOOT IN DIAMETER NO ABSORPTION TRENCH TO EXCEED 100 FEET IN LENGTH
- NOTE: ALL PIPE FROM HOUSE TO SEPTIC TANK MUST BE CAST IRON OR SCHEDULE 35/40 PVC OR ABS
- PERMIT VOID AFTER TWO YEARS
- NOTE: INSTALL STAND PIPE ON SEPTIC TANK AND DRY WELL STAND PIPES MUST BE 6 INCHES IN DIAMETER CAST IRON. CONCRETE OR TERRA COTTA OR PVA OR ABS ACCEPTED. IF TOP OF SEPTIC TANK IS DEEPER THAN 3 FEET. MANHOLE TO GRADE REQUIRED.
- NOTE: DISTRIBUTION BOXES MUST HAVE BAFFLES

***INSTALLER IS RESPONSIBLE FOR OBTAINING FINAL APPROVAL ON THIS PERMIT**
*CALL 461-9933 FOR INSPECTION OF SEPTIC SYSTEM.

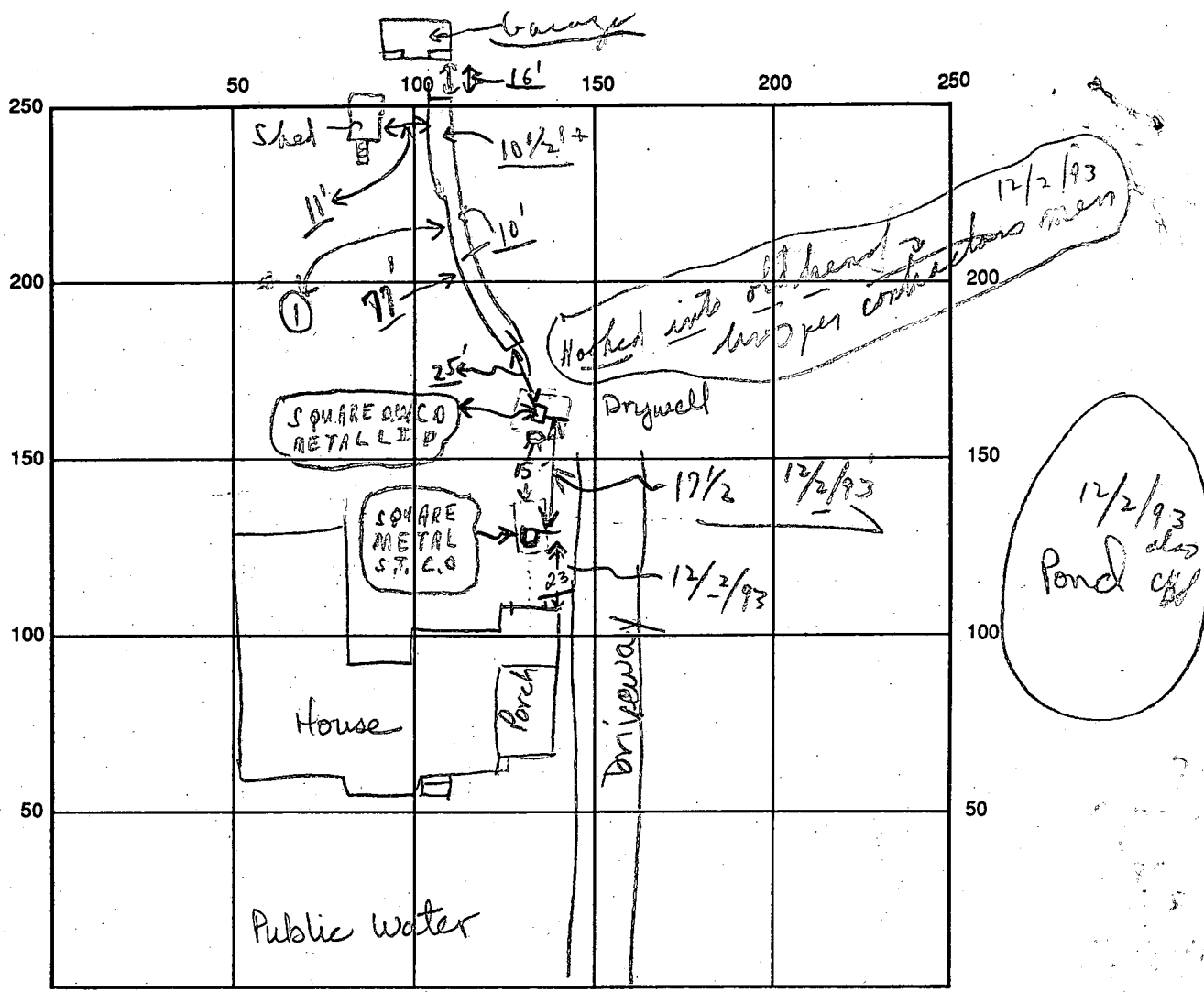

INDICATE NORTH - NAME ADJOINING ROADWAY AS BASE LINE
 Old Frederick Road

SEPTIC TANK LEVEL 1000 gal CLEANOUTS 1 on tank, one in line
 DISTRIBUTION BOX LEVEL N/A
 DRAIN FIELD/TITLE DEPTH 10 + 2 1/2 / 13 FT. TRENCH WIDTH 2 FT. INLET DEPTH 5 FT.
 EFFECTIVE GRAVEL DEPTH 5 + 2 FT. TOTAL LENGTH 77 FT.
 NUMBER OF TRENCHES 1 (1 1/2 / 13) ONE SIDEWALL/BOX AREA 385 SQ. FT. = (old system)
 DRYWALL INSIDE DIAMETER _____ FT. EFFECTIVE DEPTH BELOW INLET _____ FT.
 ABSORBENT AREA 385 SQ. FT.

REMARKS: 2-13-91 septic tank to replace old tank. Line from septic tank to drywell replaced. Ok to cover all work. Unable to observe work due to tight work schedule. JEN (RM) 12/2/93 ok to cover 41' of trench. 12/2/93 ok to cover as per 77' trench ctd (Material on site) (see above) Final!!
ctd

DATE SYSTEM APPROVED 2-13-91 INSPECTOR Jane E. Wadean
12-2-93 (Trench off) C.B. Streater
dry well
as shown
 Pg. 2 of 2