

PUB. SEWER STATUS VERIFIED BY _____

ISSUE DATE: 05-19-08

P 528950

APPROVAL DATE: 5/19/08

PERMIT

29860

Tax ID # 05-363004

ON-SITE SEWAGE DISPOSAL SYSTEM HOWARD COUNTY HEALTH DEPARTMENT BUREAU OF ENVIRONMENTAL HEALTH

Fogles Septic Clean, Inc IS PERMITTED TO INSTALL ALTER

ADDRESS: 580 Obrecht Road, Sykesville, MD 21784 PHONE NUMBER: 410-795-5670

SUBDIVISION: The Warfields II LOT NUMBER: Pres Parcel A

ADDRESS: 6547 Cedar Lane PROPERTY OWNER: Christy Peters

SEPTIC TANK CAPACITY (GALLONS): 1500 COMPARTMENTED TANK REQUIRED

PUMP CHAMBER CAPACITY (GALLONS): _____

NUMBER OF BEDROOMS: 3

SQUARE FEET PER BEDROOM: _____

LINEAR FEET OF TRENCH REQUIRED: _____

TRENCHES:	Trench to be _____ feet wide. Inlet _____ feet below original grade. Bottom maximum depth _____ feet below original grade. Effective area begins at _____ feet below original grade. _____ feet of stone below distribution pipe.
LOCATION:	_____
PURPOSE:	To replace existing septic tank. Collapse and fill existing system ^{tank} .

PLANS APPROVED: ~~Heidi Scott~~ SFO DATE: 5/19/08

- NOTE: PERMIT VOID AFTER 2 YEARS
- NOTE: CONTRACTOR RESPONSIBLE FOR SCHEDULING A PRE-CONSTRUCTION INSPECTION FOR ALL INSTALLATIONS
- NOTE: WATERTIGHT SEPTIC TANKS REQUIRED
- NOTE: ALL PARTS OF SEPTIC SYSTEM SHALL BE 100 FEET FROM ANY WATER WELL
- NOTE: MANHOLE RISERS REQUIRED ON ALL SEPTIC TANKS AND PUMP CHAMBERS

NEITHER THE HOWARD COUNTY COUNCIL OR THE HEALTH DEPARTMENT IS RESPONSIBLE FOR THE SUCCESSFUL OPERATION OF ANY SYSTEM PERMITTEE RESPONSIBLE FOR OBTAINING FINAL APPROVAL ON THIS PERMIT CALL 410-313-2640 FOR INSPECTION OF SEPTIC SYSTEM

NOT TO SCALE

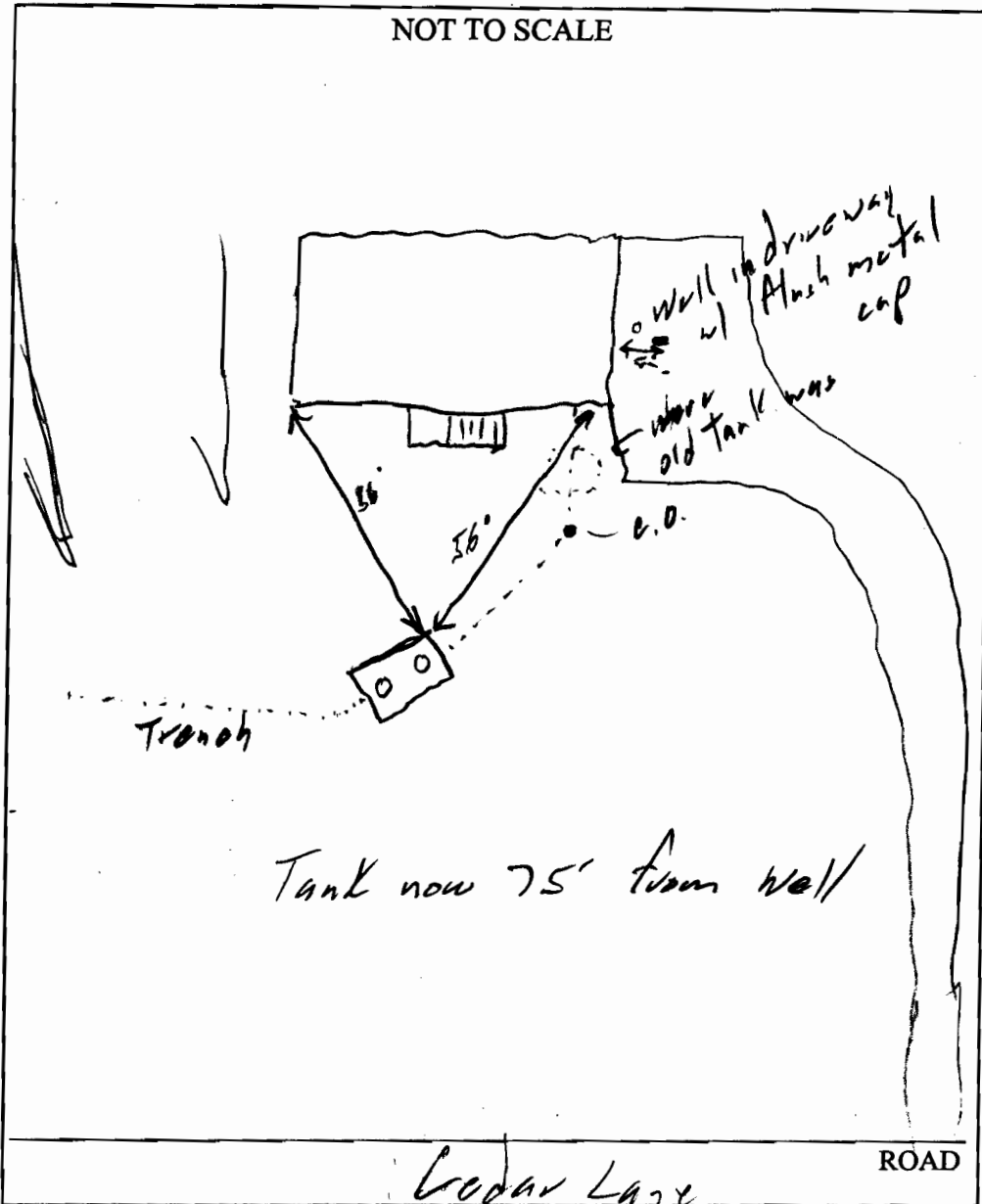

TRENCH/DRAINFIELD DATA		
WIDTH	INLET	BOTTOM

SEPTIC TANK DATA	
SEPTIC TANK 1 LEVEL	<u>Yes - 2 Comp</u>
CAPACITY	<u>1500 GAL</u>
SEAM LOC	<u>Top</u>
TANK LID DEPTH	<u>1'-2'</u>
BAFFLES	<u>Yes</u>
BAFFLE FILTER	<u> </u>
MANHOLE LOC	<u>F&B</u>
6" PORT LOC	<u> </u>
WATERTIGHT TEST	<u> </u>
SEPTIC TANK 2 LEVEL	
CAPACITY	<u> </u> GAL
SEAM LOC	<u> </u>
TANK LID DEPTH	<u> </u>
BAFFLES	<u> </u>
BAFFLE FILTER	<u> </u>
MANHOLE LOC	<u> </u>
6" PORT LOC	<u> </u>
WATERTIGHT TEST	<u> </u>

Tank now 75' from well

Cedar Lane

ROAD

PRE-CONSTRUCTION Original S. Tank was 50' from well

INSTALLATION 5/19/08 - Metal tank collapsed. Contractor pumped & hauled away. New 1500 gal tank installed w/ baffles, connect to ex. trench. (SC)

FINAL INSPECTOR

[Signature]

DATE OF APPROVAL

5/19/08

~~6/6/79~~
~~9:30 A.M.~~

6/7/79
won't be ready until around noon.

01/1/79
P 29860
A Repair
R1

PERMIT

SEWAGE DISPOSAL SYSTEM

MARYLAND STATE DEPARTMENT OF HEALTH*

HOWARD COUNTY

05-363004

ELLICOTT CITY

DISTRICT 5th

INDEXED⁴

DATE 5/22/79

Jack Fyock *Jenkins Bros.*

IS PERMITTED TO INSTALL ALTER

ADDRESS ~~13775 Triadelphia Rd., Glenelg, Md.~~

PHONE ~~988-9270~~

SUBDIVISION _____ ROAD 6547 Cedar Lane

LOT _____

PROPERTY OWNER Thomas E. Peters, Sr.

ADDRESS 6547 Cedar Lane, Clarksville, Md. 21031

SP