

APPLICATION

FOR PERCOLATION TESTING AND SITE EVALUATION

TEST DATE(S) _____ TEST TIME _____

AP 531942

AGENCY REVIEW: _____

DATE 10/1/09

DO NOT WRITE ABOVE THIS LINE

I HEREBY APPLY FOR THE NECESSARY TESTING/EVALUATION PRIOR TO ISSUANCE OF SEWAGE DISPOSAL SYSTEM PERMIT(S) TO:

CHECK AS NEEDED:

- CONSTRUCT NEW SEPTIC SYSTEM(S)
- REPAIR/ADD TO AN EXISTING SEPTIC SYSTEM
- REPLACE AN EXISTING SEPTIC SYSTEM

CHECK AS NEEDED:

- NEW STRUCTURE(S)
- ADDITION TO AN EXISTING STRUCTURE
- REPLACE AN EXISTING STRUCTURE

CHECK ONE:

- CREATE NEW LOT(S)
- BUILD ON AN EXISTING LOT IN A SUBDIVISION
- BUILD ON AN EXISTING PARCEL OF RECORD

IS THE PROPERTY WITHIN 2500' OF ANY RESERVOIR?

- YES
- NO

THE TYPE OF STRUCTURE IS:

- RESIDENTIAL WITH _____ PROPOSED BEDROOMS IN THE COMPLETED STRUCTURE (NOTE UNKNOWN IF APPROPRIATE)
- COMMERCIAL (PROVIDE DETAIL OF NUMBERS AND TYPES OF EMPLOYEES/ CUSTOMERS ON ACCOMPANYING PLAN)
- INSTITUTIONAL/GOVERNMENT (PROVIDE DETAIL OF NUMBERS AND TYPES OF EMPLOYEES/USERS ON ACCOMPANYING PLAN)

PROPERTY OWNER(S) BENJAMIN GERMAN JR. DECORATED / PERSONAL REPRESENTATIVE RUSSELL GERMAN

DAYTIME PHONE AP 410-284-6088 CELL _____ FAX _____

MAILING ADDRESS REPAIR AT 10415 CAVEY LANE WOODSTOCK MD 21163
STREET CITY/TOWN STATE ZIP

APPLICANT JEFFREY MATHENA SR. T/A MATHENA SEWER SEN. E.N.C.

DAYTIME PHONE 410-239-1228 CELL _____ FAX 410-239-1215

MAILING ADDRESS PO BOX 429 MANCHESTER MD 21102
STREET CITY/TOWN STATE ZIP

APPLICANT'S ROLE: DEVELOPER BUILDER BUYER RELATIVE/FRIEND REALTOR CONSULTANT

PROPERTY LOCATION

SUBDIVISION/PROPERTY NAME _____ LOT NO. _____

PROPERTY ADDRESS 10415 Cavey Ln. _____
STREET TOWN/POST OFFICE

TAX MAP PAGE(S) 10 GRID 18 PARCEL(S) 94 PROPOSED LOT SIZE _____

AS APPLICANT, I UNDERSTAND THE FOLLOWING: THE SYSTEM INSTALLED SUBSEQUENT TO THIS APPLICATION IS ACCEPTABLE ONLY UNTIL PUBLIC SEWERAGE IS AVAILABLE. THIS APPLICATION IS COMPLETE WHEN ALL APPLICABLE FEES AND A SUITABLE SITE PLAN HAVE BEEN RECEIVED. I ACCEPT THE RESPONSIBILITY FOR COMPLIANCE WITH ALL M.O.S.H.A. AND "MISS UTILITY" REQUIREMENTS. APPROVAL IS BASED UPON SATISFACTORY REVIEW OF A PERC CERTIFICATION PLAN.

TEST RESULTS WILL BE MAILED TO APPLICANT.

[Signature]
SIGNATURE OF APPLICANT

HOWARD COUNTY HEALTH DEPARTMENT, BUREAU OF ENVIRONMENTAL HEALTH, WELL AND SEPTIC PROGRAM
7178 COLUMBIA GATEWAY DRIVE COLUMBIA, MARYLAND 21046 (410) 313-2640 FAX (410) 313-2648
TDD (410) 313-2323 TOLL FREE 1-877-4MD-DHMH

Cavay Lane

A/P

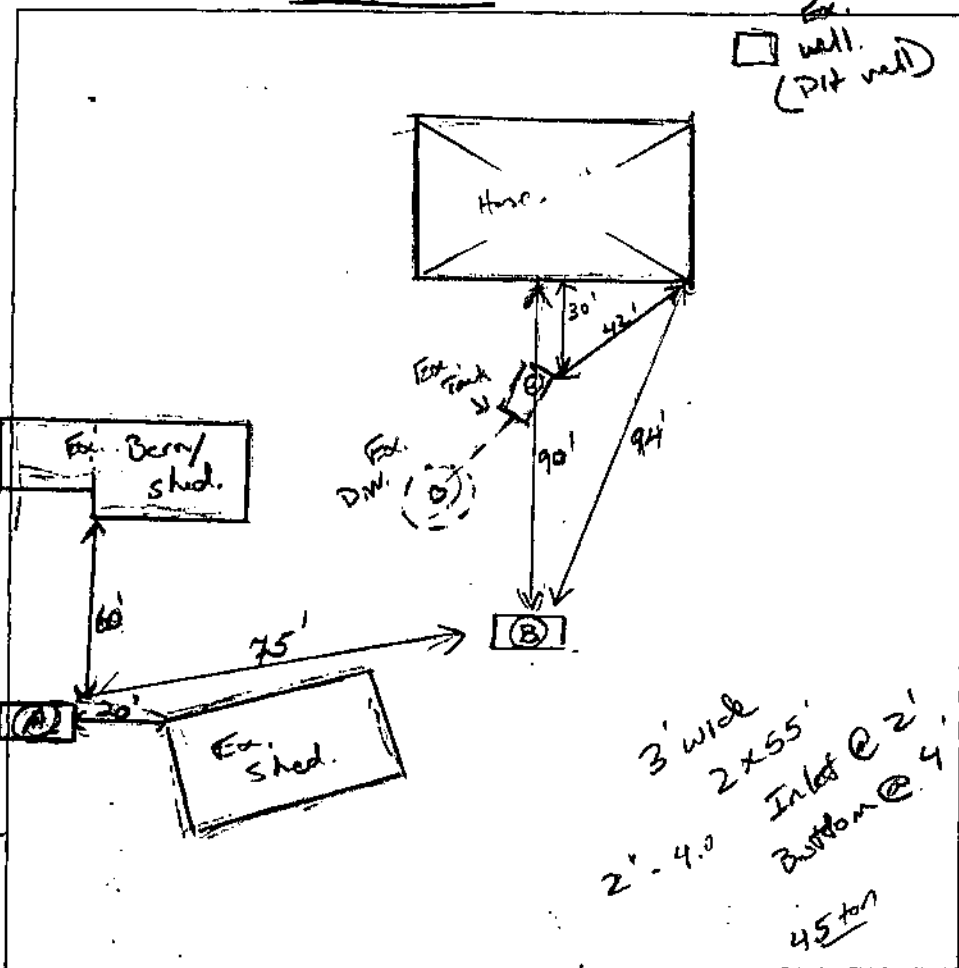

(A)
Loam AB
organic
SL, very loose,
decomposed S. shaly
friable.
FSL, friable.
Dry loose str.

8"
3'
7'

Rx 15%
Boulders
SL, highly
M. calcareous,
bleached and
bleached. L.S.
↓

(B)
Organic SSK
Loam, wk
fine granular
Course SL
CW, friable.
many roots,
shd + fragments
6'
light Br. - tan
Very fine fragments
of loam shaly.
L.S., very
house, friable
of snake shd
14'

8"
2-3'

DATE	TEST #	DEPTH	START	BREAK 1" DROP	STOP 2" DROP	TIME OF 2nd INCH	P/F/H
11/17/09	(A)	4' / 12.5'	10:24:00	10:28:00	10:33	5	P
	(B)	3'10" / 14'	11:05	11:07	11:08	1:00	?
		Repour	11:10	11:12	11:14	2:00	OK.
						(Rep shallow)	

REMARKS Poured H₂O @ bottom hole (A) & 2 mins

SANITARIAN K. Wolf BACKHOE Mark Seal OTHERS Randy, Jeff, mother

TEST HOLES USED IN SDA 2 AVG. PERC TIME 3 SQ. FT/BR

TRENCH WIDTH 3 INLET DEPTH 2 MAX. BOT DEPTH 4 EFFECTIVE SW

$150(3) = \frac{450}{7.2} = 385 \div 3 = 125 \text{ LF}$

To Scale (1:100)

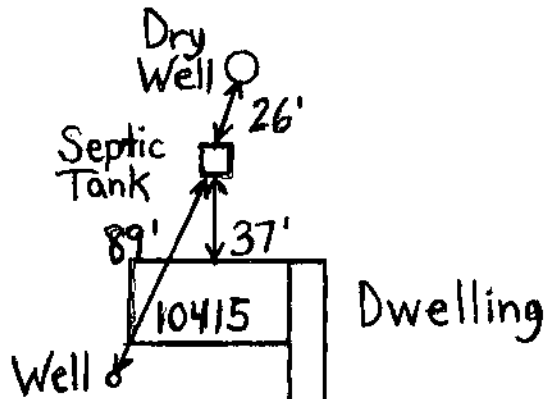

APPROXIMATE 89 FT FROM WELL TO SEPTIC TANK

Cavey Lane

DATE	TEST #	DEPTH	START	BREAK 1" DROP	STOP 2" DROP	TIME OF 2ND INCH	P/F/H

REMARKS _____

SANITARIAN _____ BACKHOE _____ OTHERS _____

TEST HOLES USED IN SDA _____ AVG. PERC TIME _____ SQ. FT/BR _____

TRENCH WIDTH _____ INLET DEPTH _____ MAX. BOT DEPTH _____ EFFECTIVE S/W _____