

4/30/90
7/23/90
ASAP
anytime
8/9/90
11 AM

02-339986

PERMIT

P 45827

SEWAGE DISPOSAL SYSTEM

A 38537

MARYLAND STATE DEPARTMENT OF HEALTH DISTRICT _____

HOWARD COUNTY
BUREAU OF ENVIRONMENTAL HEALTH
461-9933

DATE 4/25/90

DATE SYSTEM APPROVED 8-9-90

INSPECTOR JEN

INDEXED

Frall Septic Service

IS PERMITTED TO INSTALL ALTER _____

ADDRESS P. O. Box 659, Mt. Airy, Maryland 21771 PHONE 795-5674

SUBDIVISION Burleigh Manor, Sec. II ROAD 10320 Castlefield St. LOT 708

PROPERTY OWNER Drs. Khatibi & Hubbard

ADDRESS _____

~~IF GARAGE GRINDER USES INCREASE SEPTIC TANK CAPACITY BY 50% IN ABSORPTION TRENCHES~~

~~GARAGE GRINDER? YES NO~~

SEPTIC TANK CAPACITY 2000 GALLONS NUMBER OF BEDROOMS 6

TRENCHES - 200 sq. ft. per bedroom. Trench to be 3 feet wide. Inlet 3 feet below original grade. Bottom maximum depth 5 feet below original grade. Effective area begins at 3 feet below original grade. 2 feet of stone below distribution pipe.

LOCATION - Place the distribution box 275 feet from the center of Castlefield Court and 175 feet from the left lot line. Run trenches along contour toward right lot line.

NOTE - No trench to exceed 100 feet in length. Provide 6" - 8" diameter cleanout and cap to grade or above on septic tank. OK(CW)

PLANS APPROVED BY C. Williams REVISED DATE 4/24/90

COVER NO WORK UNTIL INSPECTED AND APPROVED

NEITHER THE HOWARD COUNTY COUNCIL NOR THE HEALTH DEPARTMENT IS RESPONSIBLE FOR THE SUCCESSFUL OPERATION OF ANY SYSTEM.

- NOTE: CLEANOUT REQUIRED EVERY 70 FEET OF SEWER LINE AND/OR AT 90° SWEEPS IN LINES FROM HOUSE TO DRAIN FIELDS
 - NOTE: ALL PARTS OF SEPTIC SYSTEMS (I.E. TANK, DISTRIBUTION BOX, TRENCHES) TO BE 100 FEET FROM WELL (UNLESS OTHERWISE SPECIFICALLY AUTHORIZED)
 - NOTE: IF DEEP TRENCHES ARE USED CALL FOR INSPECTION BEFORE AND AFTER PLACING GRAVEL IN TRENCHES
 - NOTE: NO DRY WELL SHALL EXCEED 15 FOOT IN DIAMETER NO ABSORPTION TRENCH TO EXCEED 100 FEET IN LENGTH.
 - NOTE: ALL PIPE FROM HOUSE TO SEPTIC TANK MUST BE CAST IRON OR SCHEDULE 40 PVC OR ABS
- PERMIT VOID AFTER TWO YEARS
- NOTE: INSTALL STAND PIPE ON SEPTIC TANK AND DRY WELL. STAND PIPES MUST BE 6 INCHES IN DIAMETER. CAST IRON, CONCRETE OR TERRA COTTA OR PVC OR ABS ACCEPTED. IF TOP OF SEPTIC TANK IS DEEPER THAN 3 FEET, MANHOLE TO GRADE REQUIRED
 - NOTE: DISTRIBUTION BOXES MUST HAVE BAFFLES

BOG. PERMIT SIGNED AND RETURNED 7/30/90
Serial # 34234-Pool.

***INSTALLER IS RESPONSIBLE FOR OBTAINING FINAL APPROVAL ON THIS PERMIT**

*CALL 461-9933 FOR INSPECTION OF SEPTIC SYSTEMS.

A 38537

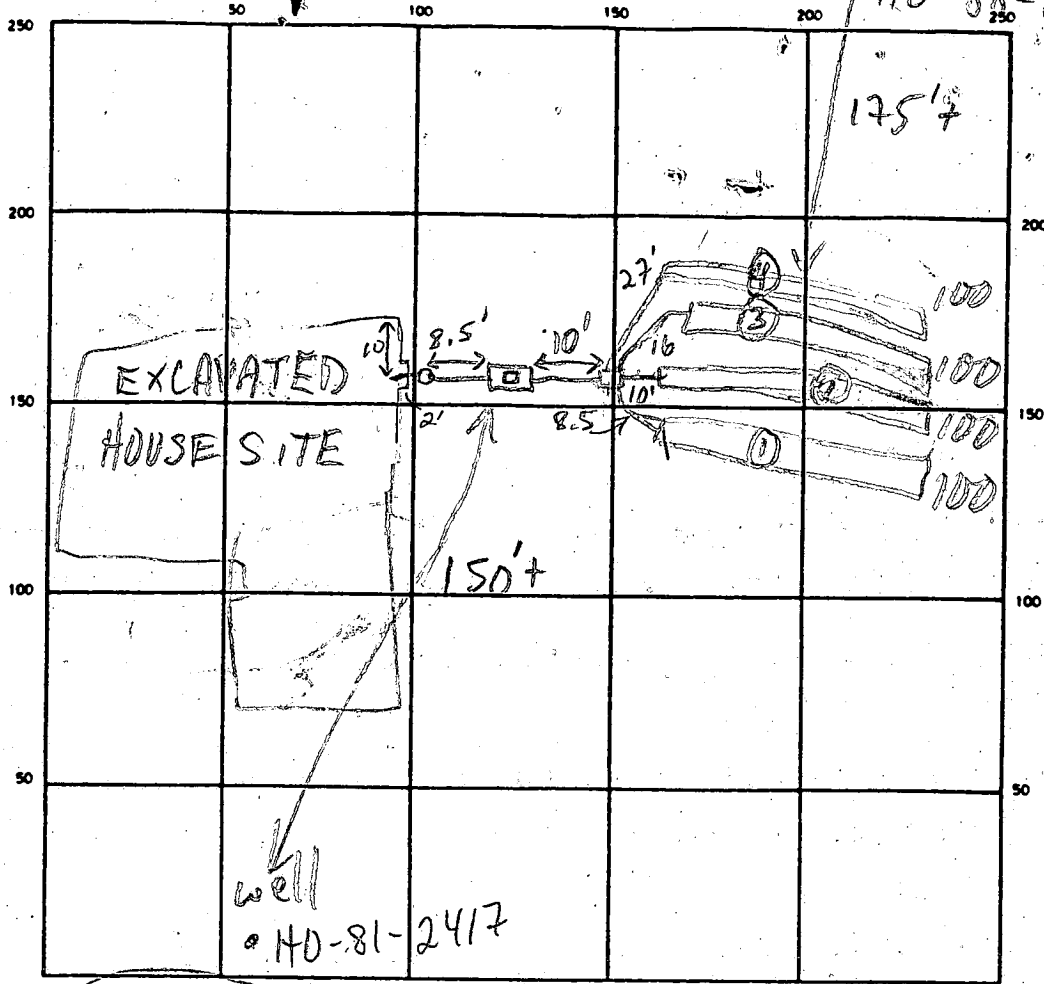

CASTLEFIELD ST

SEPTIC TANK. LEVEL 2000 GAL? CLEANOUTS OK - MANHOLE

DISTRIBUTION BOX. LEVEL OK - BAFFLE IN

DRAIN FIELD/TILE FIELD. DEPTH 5 FT. TRENCH WIDTH 3 FT. INLET DEPTH 3 FT.

EFFECTIVE GRAVEL DEPTH 2 FT. TOTAL LENGTH 2100 FT.

NUMBER OF TRENCHES 4 ONE SIDEWALL/BOTTOM AREA 4 @ 300 SQ. FT.

DRYWELL INSIDE DIAMETER — FT. EFFECTIVE DEPTH BELOW INLET — FT.

ABSORBENT AREA 1200 SQ. FT.

REMARKS 4/30/90 OK TO COVER S.T. TO ENDS OF TRENCHES

NO HOUSE CONN MR 7/23/90 NOTHING VISIBLE,

MESSAGE LEFT FOR BUILDER MR

7/23 8-9-90 OK to 8-9-90. House connector ok, JEN

DATE SYSTEM APPROVED 8-9-90 INSPECTOR Jane E. Rademan

1/4" = 12'
VERT. FOOT

44" STRUT

N56°19'10"E

720.00'

30' 02" 1/2

10' DRAINAGE UTILITY EASMT

211'

5' HIGH
FENCE WOOD P
BY OWNER AS DE
CODE

85'

20' x 40'
POOL

04'

WOOD
DECK

RES. (UNDER
CONSTRUCTION)

SEPIC
TANK

PROPOSED
DRIVEWAY

170'

163'

EX. WELL

30' PCL

N29°04'57"E

225.00'

SITE PLAN

1" = 30'

PRIVATE WELL
SEPTIC

460

30' BRL

LOT 708
3.96 ACRES

K
N FIELDS

358'

60' BRL

30' BRL

59" E

208.71'

N 51° 12.04' N
140.27' W

