

PERMIT

SEWAGE DISPOSAL SYSTEM

DEPARTMENT OF HEALTH AND MENTAL HYGIENE

P 48758
A REPAIR

DISTRICT _____

DATE 12/15/92

DATE SYSTEM APPROVED 12/9/92

INSPECTOR RH

HOWARD COUNTY HEALTH DEPARTMENT
BUREAU OF ENVIRONMENTAL HEALTH
~~461-9933~~ 313-2640

INDEXED

Jenkins Brothers IS PERMITTED TO INSTALL _____ ALTER X

ADDRESS 7670 Smith's Private Road, Sykesville, Maryland 21784 PHONE 461-9282

SUBDIVISION _____ LOT _____ ROAD 8475 Old Frederick Road

PROPERTY OWNER Rick Pagliacoli
8475 Old Frederick Road (Across from Daniel's Road)

ADDRESS _____

SEPTIC TANK CAPACITY 1000 GALLONS

NUMBER OF BEDROOMS 3

_____ SQUARE FEET PER BEDROOM

LINEAR FEET OF TRENCH REQUIRED _____

REPAIR - PURPOSE - DRYWELL FULL

Call for inspection when ground is opened so sanitarian can recommend repair. 11/24/92

12/4/92 PUT IN EXTRA TRENCH 60 FT LONG
12 FT DEEP 8 FT STONE 2 FT WIDE INLET
4 FT DEEP SIMILAR TO FIRST TRENCH

PLANS APPROVED BY _____ DATE _____

COVER NO WORK UNTIL INSPECTED AND APPROVED

NEITHER THE HOWARD COUNTY COUNCIL NOR THE HEALTH DEPARTMENT IS RESPONSIBLE FOR THE SUCCESSFUL OPERATION OF ANY SYSTEM

NOTE: CLEANOUT REQUIRED EVERY 70 FEET OF SEWER LINE AND/OR AT 90° SWEEPS IN LINES FROM HOUSE TO DRAIN FIELDS, 90° ELBOWS NOT ACCEPTABLE.

NOTE: ALL PARTS OF SEPTIC SYSTEMS (I.E. TANK, DISTRIBUTION BOX TRENCHES) TO BE 100 FEET FROM WELL (UNLESS OTHERWISE SPECIFICALLY AUTHORIZED)

NOTE: IF DEEP TRENCH(ES) ARE USED CALL FOR INSPECTION BEFORE AND AFTER PLACING GRAVEL IN TRENCH(ES)

NOTE: NO DRY WELL SHALL EXCEED 15 FOOT IN DIAMETER NO ABSORPTION TRENCH TO EXCEED 100 FEET IN LENGTH

NOTE: ALL PIPE FROM HOUSE TO SEPTIC TANK MUST BE CAST IRON OR SCHEDULE 35/40 PVC OR ABS

PERMIT VOID AFTER TWO YEARS

NOTE: INSTALL STAND PIPE ON SEPTIC TANK AND DRY WELL STAND PIPES MUST BE 6 INCHES IN DIAMETER CAST IRON. CONCRETE OR TERRA COTTA OR PVA OR ABS ACCEPTED. IF TOP OF SEPTIC TANK IS DEEPER THAN 3 FEET. MANHOLE TO GRADE REQUIRED.

NOTE: DISTRIBUTION BOXES MUST HAVE BAFFLES

***INSTALLER IS RESPONSIBLE FOR OBTAINING FINAL APPROVAL ON THIS PERMIT**

P 48758

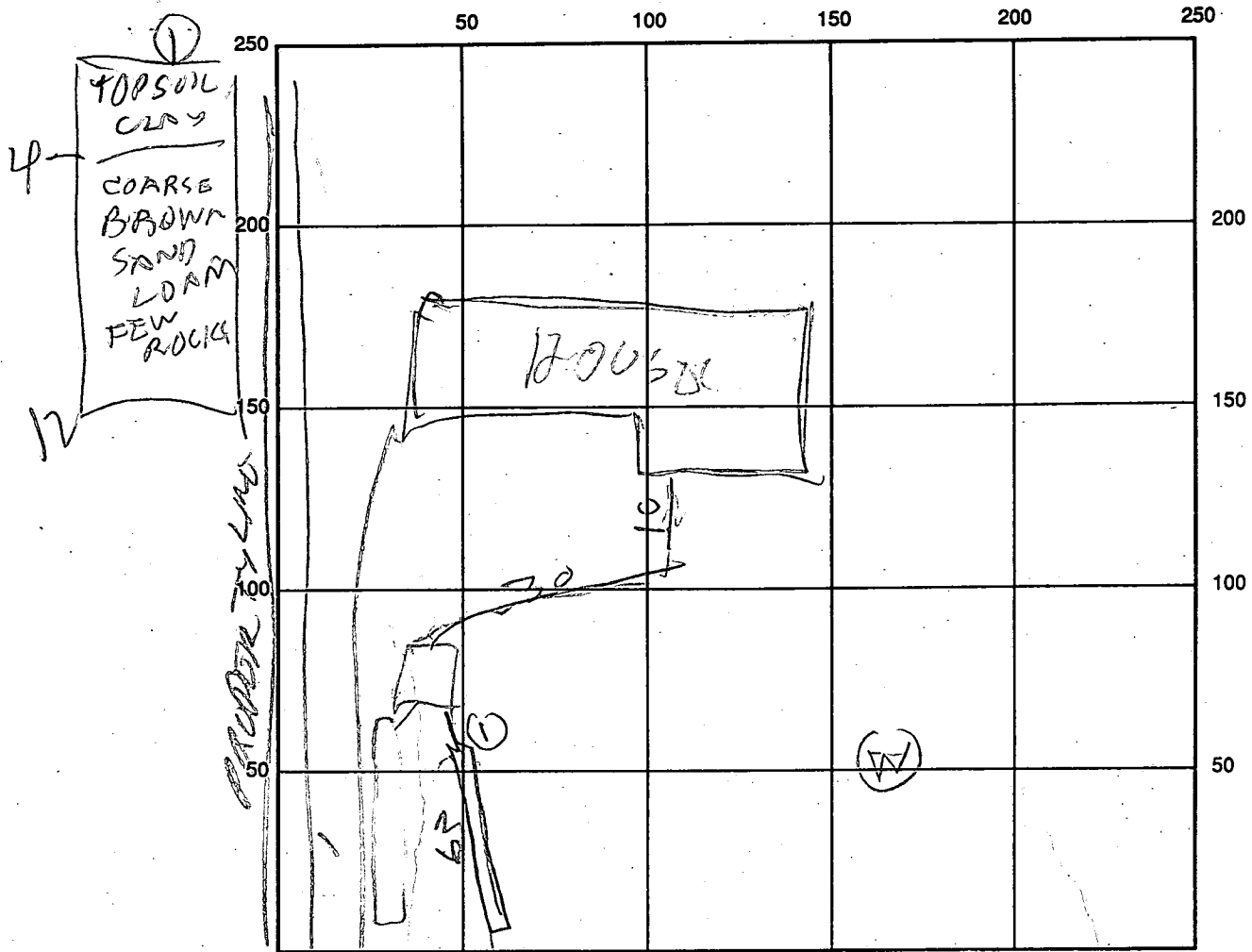

SEPTIC TANK LEVEL _____ CLEANOUTS _____

DISTRIBUTION BOX LEVEL _____

DRAIN FIELD/TITLE DEPTH 8 FT. TRENCH WIDTH 2 FT. INLET DEPTH _____ FT.

EFFECTIVE GRAVEL DEPTH 12 FT. TOTAL LENGTH 63 FT.

NUMBER OF TRENCHES 1 ONE SIDEWALL/BOTTOM AREA 504 SQ. FT.

DRYWALL INSIDE DIAMETER _____ FT. EFFECTIVE DEPTH BELOW INLET _____ FT.

ABSORBENT AREA _____ SQ. FT.

REMARKS: 12/4/92 EXISTING TRENCH ALREADY TOO CLOSE TO WELL
ONLY WAY TO REPAIR IS TO PUT EXTRA TRENCH A LITTLE
CLOSER TO THE WELL THAN DESIRABLE TRENCH
STARTED RH
12/3/92 PM - TRENCH FINISHED RH

DATE SYSTEM APPROVED 12/4/92 INSPECTOR B. Hodge

6/26/75

PERMIT

SEWAGE DISPOSAL SYSTEM

MARYLAND STATE DEPARTMENT OF HEALTH

HOWARD COUNTY

ELLICOTT CITY

DISTRICT 2

DATE 5/2/75

21430

P ~~0288X~~

A

INDEXED

Eric Wissel IS PERMITTED TO INSTALL ALTER X

ADDRESS 8475 Old Frederick Road, Ellicott City, Md. PHONE Ext. 381

A SEWAGE DISPOSAL SYSTEM LOCATED AT _____

SUBDIVISION _____ ROAD 8475 Old Frederick Rd. LOT _____
intersection of Daniels Rd. & Old Fred. Rd.

PROPERTY OWNER Eric Wissel

ADDRESS _____

SPECIFICATIONS

DRAIN FIELD _____ DEPTH _____ FEET, BOTTOM AREA _____ SQ. FT.

SEEPAGE PITS _____ ABSORBENT SIDE-WALL AREA _____ SQ. FT.

SEPTIC TANK CAPACITY _____ GALLONS

FOR GARBAGE GRINDER, INCREASE DISPOSAL AREA 22% & TANK CAPACITY 50%.

OTHER REPAIR - Call for inspection when ground is opened up so Sanitarian can
recommend repair system.

PLANS APPROVED BY Palmer F. Wine DATE 5/2/75

FILL SEPTIC TANK AND DISTRIBUTION BOX WITH WATER BEFORE CALLING FOR AN INSPECTION. COVER NO WORK UNTIL INSPECTED AND APPROVED.

NEITHER THE HOWARD COUNTY COMMISSIONERS NOR THE HEALTH DEPARTMENT IS RESPONSIBLE FOR THE SUCCESSFUL OPERATION OF ANY SYSTEM.

BLDG. PERMIT SIGNED
AND RETURNED 3/27/78

X P 21430

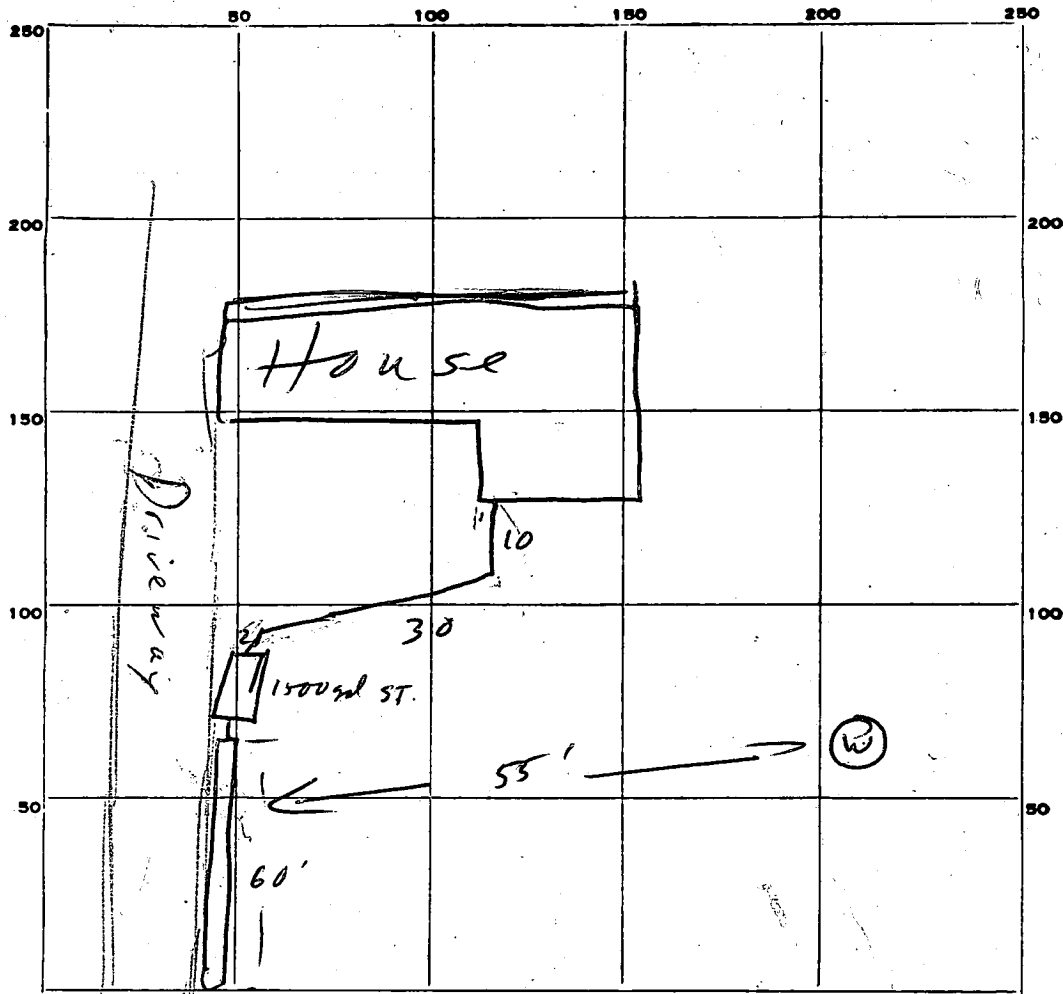

INDICATE NORTH. - NAME ADJOINING ROADWAY AS BASE LINE.

← Old Fred. Rd →



PERMIT CARD

SEPTIC TANK, LEVEL

CLEANOUTS

~~DISTRIBUTION BOX, LEVEL~~

TILE FIELD, DEPTH 12 FT. TRENCH WIDTH 2 FT.

GRAVEL DEPTH 8 FT. TOTAL LENGTH 60 FT.

NUMBER OF TRENCHES 1 TOTAL BOTTOM AREA 480 ^{sidewall}

~~SEEPAGE FITS, INSIDE DIAMETER _____ FT. DEPTH BELOW INLET _____ FT.~~

ABSORBENT AREA 480 SQ. FT.

REMARKS

(3 BR House)

Soil is variable fair to poor; system is max. amount able to install

DATE SYSTEM APPROVED

6/26/75

INSPECTOR

R Moorfield