

5/4/92 12:00

Tag IO-04-316797

PERMIT

SEWAGE DISPOSAL SYSTEM

DEPARTMENT OF HEALTH AND MENTAL HYGIENE

P 48167

A REPAIR

DISTRICT 4th

DATE 5/27/92
4/28/92

HOWARD COUNTY HEALTH DEPARTMENT
BUREAU OF ENVIRONMENTAL HEALTH
461-9933

INDEXED

DATE SYSTEM APPROVED 5/4/92

INSPECTOR [Signature]

Jack Fyock _____ IS PERMITTED TO INSTALL _____ ALTER

ADDRESS 13775 Triadelphia Road, Glenelg, MD 21737 PHONE 988-9270

SUBDIVISION Warfield Estates LOT 26A ROAD 3313 Stapleton Drive

PROPERTY OWNER Timothy and Linda Krause

ADDRESS 3313 Stapleton Drive, Glenwood, Maryland 21738 PHONE: 489-4846

SEPTIC TANK CAPACITY 1250 GALLONS

NUMBER OF BEDROOMS 4

120 SQUARE FEET PER BEDROOM

LINEAR FEET OF TRENCH REQUIRED 72

REPAIR - PURPOSE - SEPTIC SYSTEM HAS FAILED.

Call for inspection when ground is opened so sanitarian can recommend repair.

Install one 72 ft long, 11 ft deep, 2 ft wide trench. Inlet depth from existing dry well @ 3 1/2 ft below existing grade, place 7 ft stone fill below drain pipe.
RJP 5/4/92

PLANS APPROVED BY Craig Williams DATE 4/28/92

COVER NO WORK UNTIL INSPECTED AND APPROVED

NEITHER THE HOWARD COUNTY COUNCIL NOR THE HEALTH DEPARTMENT IS RESPONSIBLE FOR THE SUCCESSFUL OPERATION OF ANY SYSTEM

NOTE: CLEANOUT REQUIRED EVERY 70 FEET OF SEWER LINE AND/OR AT 90° SWEEPS IN LINES FROM HOUSE TO DRAIN FIELDS, 90° ELBOWS NOT ACCEPTABLE.

NOTE: ALL PARTS OF SEPTIC SYSTEMS (I.E. TANK, DISTRIBUTION BOX TRENCHES) TO BE 100 FEET FROM WELL (UNLESS OTHERWISE SPECIFICALLY AUTHORIZED)

NOTE: IF DEEP TRENCH(ES) ARE USED CALL FOR INSPECTION BEFORE AND AFTER PLACING GRAVEL IN TRENCH(ES)

NOTE: NO DRY WELL SHALL EXCEED 15 FOOT IN DIAMETER NO ABSORPTION TRENCH TO EXCEED 100 FEET IN LENGTH

NOTE: ALL PIPE FROM HOUSE TO SEPTIC TANK MUST BE CAST IRON OR SCHEDULE 35/40 PVC OR ABS

PERMIT VOID AFTER TWO YEARS

NOTE: INSTALL STAND PIPE ON SEPTIC TANK AND DRY WELL STAND PIPES MUST BE 6 INCHES IN DIAMETER CAST IRON, CONCRETE OR TERRA COTTA OR PVA OR ABS ACCEPTED. IF TOP OF SEPTIC TANK IS DEEPER THAN 3 FEET, MANHOLE TO GRADE REQUIRED.

NOTE: DISTRIBUTION BOXES MUST HAVE BAFFLES

***INSTALLER IS RESPONSIBLE FOR OBTAINING FINAL APPROVAL ON THIS PERMIT**

P 48167

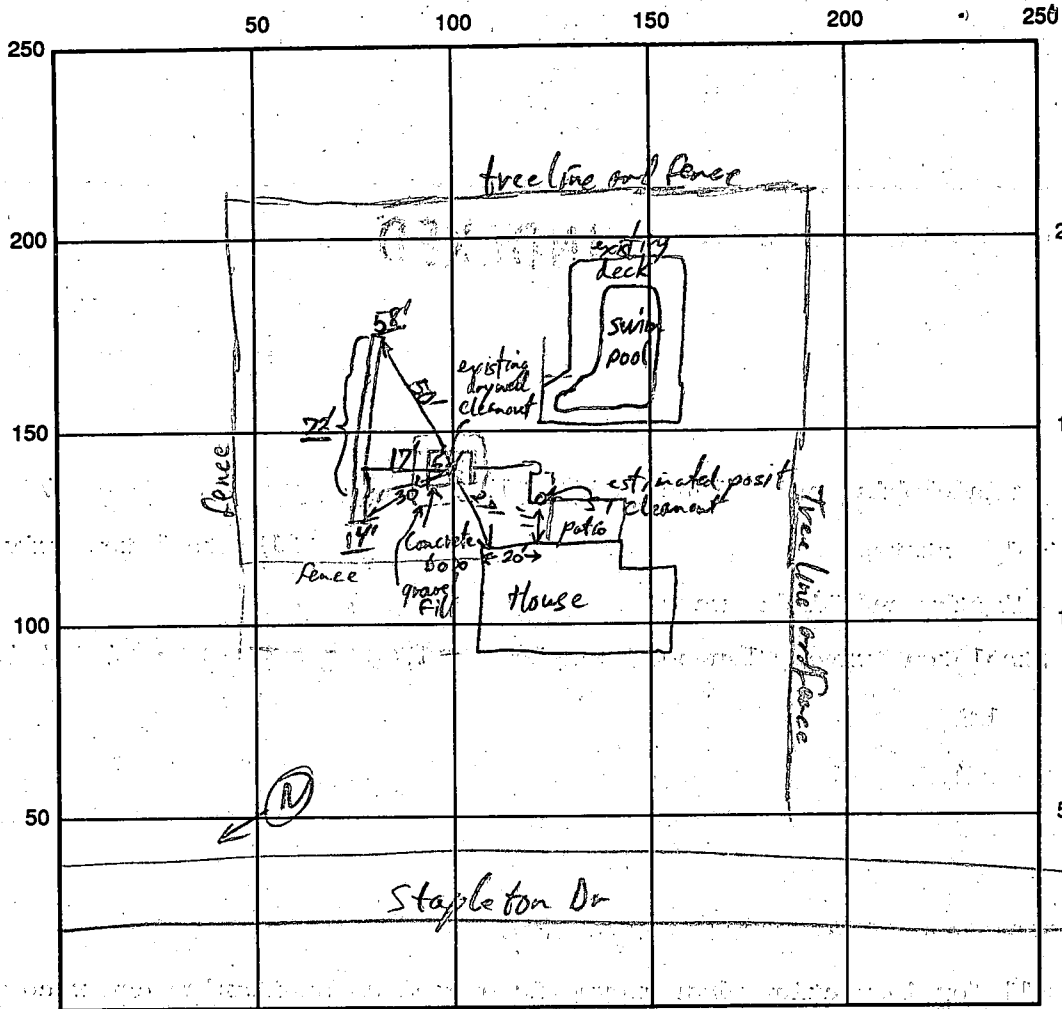

West End	East End
dark red brown clay loam	Heavy clay loam
light brown to yellowish silt loam	light red to yellowish silt loam
	at East end some blue gray (1.5% Fe) nodules at 8-11'

125
4
71500
72

INDICATE NORTH - NAME ADJOINING ROADWAY AS BASE LINE

SEPTIC TANK LEVEL existing (1250 per A14967) CLEANOUTS @ Drywell

DISTRIBUTION BOX LEVEL NA

DRAIN FIELD/TITLE DEPTH 11' FT. TRENCH WIDTH 2' FT. INLET DEPTH 3 1/2' FT.

EFFECTIVE GRAVEL DEPTH 7' FT. TOTAL LENGTH 72 FT.

NUMBER OF TRENCHES 1 ONE SIDEWALL/BOTTOM AREA 504 SQ. FT.

DRYWELL INSIDE DIAMETER _____ FT. EFFECTIVE DEPTH BELOW INLET _____ FT.

ABSORBENT AREA _____ SQ. FT.

REMARKS: Trench already dug and partially stone filled / soils OK from 4' to 11' (old records show 2-4' in part) pipe laid @ 4' below grade Stone fill to 3-3 1/2' below grade, OK to cover when finished 11/5/92

DATE SYSTEM APPROVED 5-4-92 INSPECTOR [Signature]

File
6/29/73

PERMIT

P 18510
A 28 14967

SEWAGE DISPOSAL SYSTEM

MARYLAND STATE DEPARTMENT OF HEALTH

HOWARD COUNTY

INDEXED

ELLICOTT CITY

DISTRICT 4th

DATE 5/22/73

Howard Pickett

IS PERMITTED TO INSTALL ALTER

ADDRESS Watersville Road, Mt. Airy, Maryland

PHONE 829-0543

A SEWAGE DISPOSAL-SYSTEM LOCATED AT _____

SUBDIVISION Warfield Estates

³³¹³ ROAD Stapleton Drive

LOT 26A

PROPERTY OWNER ~~Maple Hill Farm Associates~~

Timothy + Linda Krause

ADDRESS 9300 Fontana Avenue, Seabrook, Md. 20801

SPECIFICATIONS 4 bedrooms

DRAIN FIELD _____ DEPTH _____ FEET, BOTTOM AREA _____ SQ. FT.

SEEPAGE PITS _____ ABSORBENT SIDE-WALL AREA _____ SQ. FT.

SEPTIC TANK CAPACITY 1250 GALLONS

FOR GARBAGE GRINDER, INCREASE DISPOSAL AREA 22% & TANK CAPACITY 50%.

OTHER DRY WELL - 100 sq. ft. of absorbent sidewall area per bedroom to begin below the first $4\frac{1}{2}$ ft. of non-porous soil. Maximum depth permitted for dry well is 12 ft. below original grade. Locate dry well 150 ft. from front lot line and 70 ft. from left side line as seen from Stapleton Drive.

NOTE: ALL PIPE FROM HOUSE TO DRY WELL MUST BE CAST IRON.
PERMIT VOID AFTER THREE YEARS.

NOTE: INSTALL STAND PIPE ON SEPTIC TANK AND DRY WELL.

PLANS APPROVED BY J. T. Wright and Robert Torre

DATE 12/2/69 and 3/28/73

FILL SEPTIC TANK AND DISTRIBUTION BOX WITH WATER BEFORE CALLING FOR AN INSPECTION. COVER NO WORK UNTIL INSPECTED AND APPROVED.

NEITHER THE HOWARD COUNTY COMMISSIONERS NOR THE HEALTH DEPARTMENT IS RESPONSIBLE FOR THE SUCCESSFUL OPERATION OF ANY SYSTEM.

BUDG. PERMIT SIGNED
AND RETURNED

Serial # 32395
Renovate Ketcher

A 14967

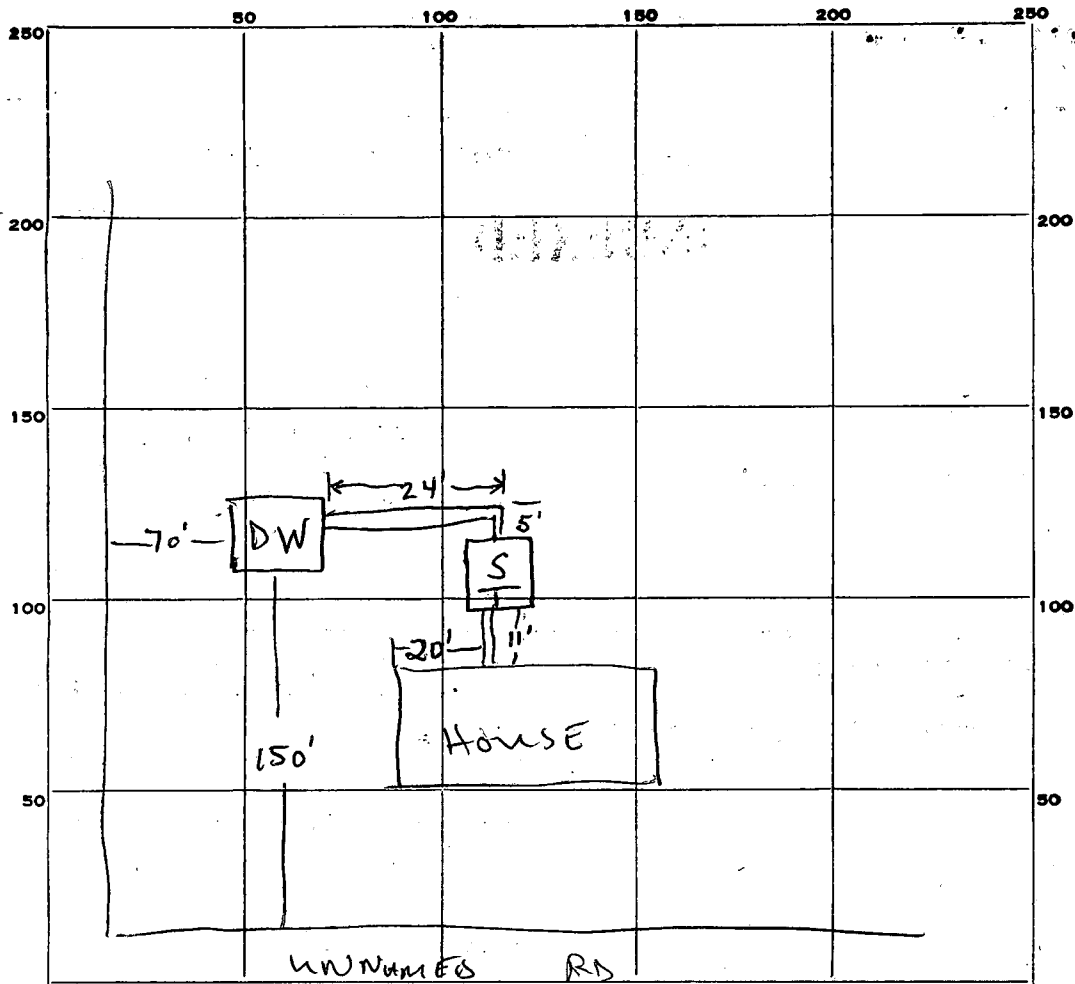

INDICATE NORTH. - NAME ADJOINING ROADWAY AS BASE LINE.

PERMIT CARD _____
 SEPTIC TANK, LEVEL _____ CLEANOUTS _____
 DISTRIBUTION BOX, LEVEL _____
 TILE FIELD, DEPTH _____ FT. TRENCH WIDTH _____ FT.
 GRAVEL DEPTH _____ IN. TOTAL LENGTH _____ FT.
 NUMBER OF TRENCHES _____ TOTAL BOTTOM AREA _____
 SEEPAGE PITS, ^{OUTSIDE} INSIDE DIAMETER ~~14 x 14~~ ^{14 x 14} FT. DEPTH BELOW INLET 7 1/2 FT.
 ABSORBENT AREA 420 SQ. FT. OK

56
 7 1/2
 392
 28
 420

REMARKS _____

DATE SYSTEM APPROVED 8/29/73 INSPECTOR W. W. Ziegler

ST.

77.82

77.00

Well
E. El. 579.2
15'

± 20'

84' ±

275.15

77' ±

B

E. El. 812
BAS. 722

80' ±

78.0
IND. 73.0
IND. 73.0
80'

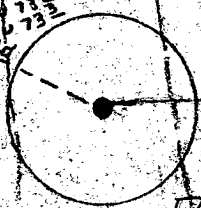

Drywell
E. El. 577.0
In. El. 572.2

26
46,774 A Approval
2/23/73
R.T.

215.00'

628.47

02° 13' 01" W

N 70° 59' 05" W

N 75° 30' 57" W

APPLICATION

A 14967

SEWAGE DISPOSAL TESTING

P _____

MARYLAND STATE DEPARTMENT OF HEALTH

HOWARD COUNTY *Septic Tank - 3 bedrooms - 1000 gal* *4 " - 1250 gal* ELLICOTT CITY

Dry Well - 100 sq. ft. of absorbent sidewall area DISTRICT 4
per bedroom. To begin below the first 4 1/2 ft of non- DATE 11/17/69
porous soil. Maximum depth permitted for
dry well is 11 ft. below original grade. Locate
dry well 150 ft. from front lot line and 70 ft.
from left side line as seen from Stapleton Drive.

TO: THE COUNTY HEALTH OFFICER
ELLICOTT CITY, MARYLAND

I, HEREBY, APPLY FOR THE NECESSARY TESTS IN ORDER TO CONSTRUCT (OR RECONSTRUCT) A SEWAGE DISPOSAL SYSTEM.

PROPERTY OWNER Maple Hill Farm Associates

ADDRESS 300 Fontana Ave., Seabrook, Md. 20801 PHONE _____

PROPERTY LOCATION: _____

SUBDIVISION _____ LOT NO. 60, Sec. 4

ROAD AND DESCRIPTION Circle 4

OCCUPANT _____ PHONE _____

PERSON TO CONSTRUCT SYSTEM _____

ADDRESS _____ PHONE _____

SIZE OF LOT 136' 248' x 220' x 297' TYPE BLDG. 3 or 4
NUMBER OF BEDROOMS

IF NOT SINGLE RESIDENCE DESCRIBE _____

SIGNATURE OF APPLICANT /s/ Campaigne & Huster

APPROVED BY Tested by J. T. Wright FOR Dry Well DATE 12/2/69
(KIND OF SYSTEM)

REJECTED BY _____ FOR _____ DATE _____
(KIND OF SYSTEM)

HOLD PENDING FURTHER TESTS _____ DATE _____

REASONS FOR REJECTION OR HOLDING _____

THIS IS NOT A PERMIT

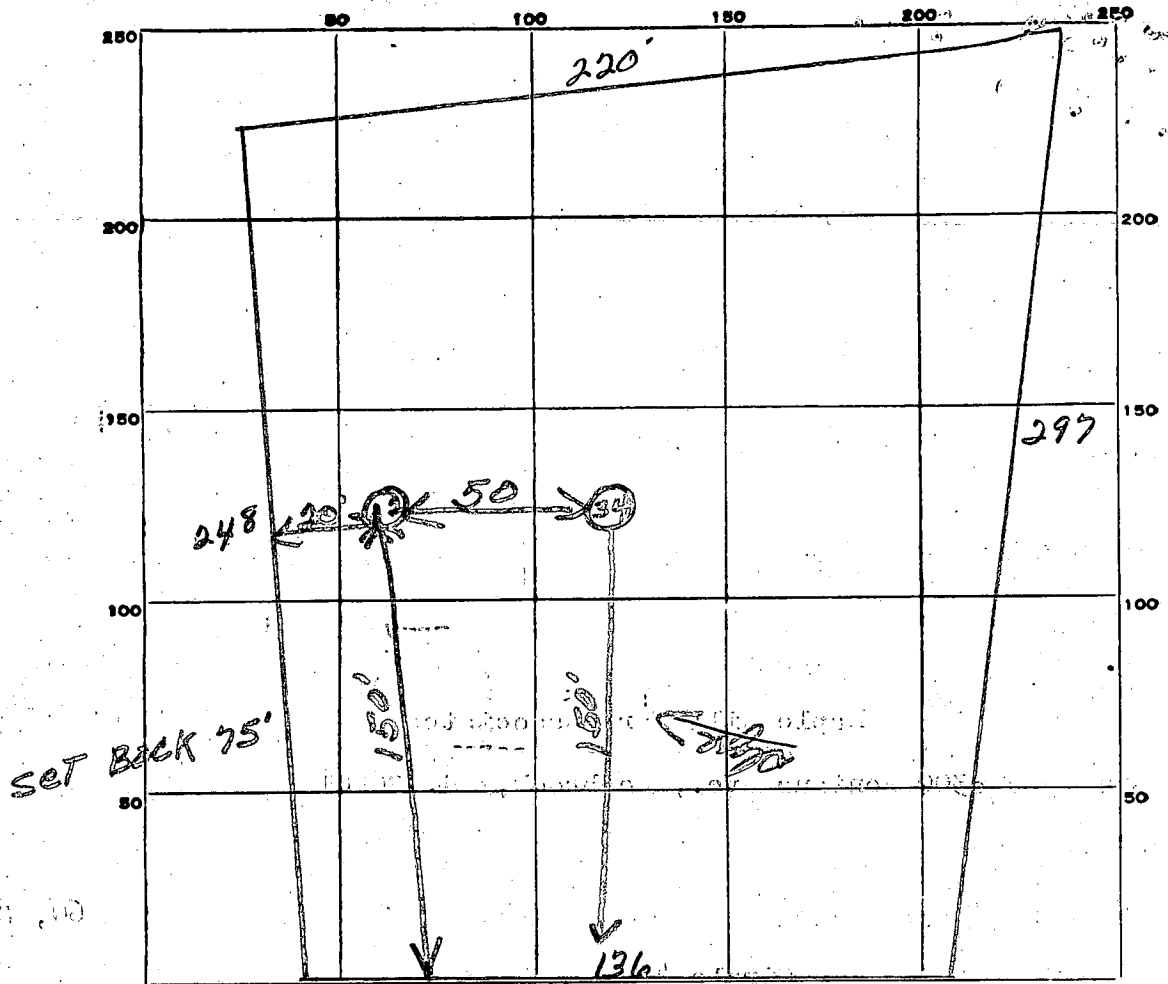

Circle 4 sec. 4

DATE	TEST NO.	DEPTH	PRE-WET		TEST - 1" DROP		TIME
			START	STOP	START	STOP	
12/6/69	1	11'	132	130	130	132	2 min
	2	5'	135	130	130	134	4 min
	3	11'	136	138	138	140	2 min
	4	5'	134	135	135	137	2 min

10m
 60
 3 min HV

SOIL AUGER FINDING _____

TESTED BY *JTD*

REMARKS _____

C 1 2461 (SEQ. NO.)
 (THIS NUMBER IS TO BE PUNCHED IN COLS. 3-6 ON ALL CARDS)

STATE OF MARYLAND
WATER RESOURCES ADMINISTRATION
 TAWES STATE OFFICE BLDG., ANNAPOLIS, MD. 21401
WELL COMPLETION REPORT

THIS REPORT MUST BE SUBMITTED WITHIN 30 DAYS AFTER WELL COMPLETION
 FILL IN THIS FORM COMPLETELY
 COUNTY NUMBER

DATE RECEIVED (DWR USE ONLY) 6-21-75 DEPTH OF WELL 440 PERMIT NO. FROM "PERMIT TO DRILL WELL" 110-92-0540
 DATE WELL COMPLETED 440 (TO NEAREST FOOT) 22 26
 DRILLERS IDENTIFICATION NO. 42

OWNER 1496 Halle Enterprises Inc LAST NAME Halle FIRST NAME Enterprise
 STREET OR RFD 9332 Annapolis Rd. POST OFFICE London Md.

WELL LOG
 STATE THE KIND OF FORMATIONS PENETRATED, THEIR COLOR, DEPTH, THICKNESS AND IF WATER BEARING

DESCRIPTION (USE ADDITIONAL SHEETS IF NECESSARY)	FEET		CHECK IF WATER BEARING
	FROM	TO	
<u>top soil</u>	<u>0</u>	<u>2</u>	
<u>sandy</u>	<u>2</u>	<u>65</u>	
<u>sand stone</u>	<u>65</u>	<u>80</u>	<input checked="" type="checkbox"/>
<u>granite</u>	<u>80</u>	<u>440</u>	

WELL DESCRIPTION

GROUTING RECORD
 WELL HAS BEEN GROUTED (CIRCLE APPROPRIATE BOX) YES NO
 TYPE OF GROUTING MATERIAL (CIRCLE BOX):
 CEMENT BENTONITE CLAY
 NO. OF BAGS 7 NO. OF POUNDS 200
 GALLONS OF WATER 45
 DEPTH OF GROUT SEAL (TO NEAREST FOOT)
 FROM 0 FT. TO 30+ FT.
 (ENTER 0 IF FROM SURFACE)

CASING RECORD
 INSERT APPROPRIATE CODE BELOW
 S T C O
 STEEL CONCRETE
 P L O T
 PLASTIC OTHER

MAIN CASING TYPE S T 6 72
 NOMINAL DIAMETER TOP (MAIN) CASING (NEAREST INCH) 6
 TOTAL DEPTH OF MAIN CASING (NEAREST FOOT) 72

OTHER CASING (IF USED)
 DIAMETER (INCH) DEPTH (FEET) FROM TO
 C H A S I N G

SCREEN RECORD
 SCREEN TYPE OR OPEN HOLE (INSERT APPROPRIATE CODE BELOW)
 S T B R H O
 STEEL BRASS OR BRONZE OPEN HOLE
 P L O T
 PLASTIC OTHER

C 2 (SEQ. NO.) 6
 DEPTH (NEAREST WHOLE FOOT) FROM TO
 1 8 9 11 15 17 21
 2 23 24 26 30 32 36
 3 38 39 41 45 47 51
 SLOT SIZE 1. 2. 3.

DIAMETER OF SCREEN 56 60 (NEAREST INCH) FROM TO
 GRAVEL PACK
 IF WELL DRILLED WAS A FLOWING WELL CIRCLE BOX F

DWR USE ONLY (NOT TO BE FILLED IN BY DRILLER) (E.R.O.S.) W Q
 TELESCOPE CASING LOG INDICATOR OTHER DATA AVAILABLE

C 3 (SEQ. NO.) 6

PUMPING TEST
 HOURS PUMPED (TO NEAREST HOUR) 9
 PUMPING RATE (GALLONS PER MINUTE TO NEAREST GALLON) 5
 METHOD USED TO MEASURE PUMPING RATE bucket

WATER LEVEL: (DISTANCE FROM LAND SURFACE)
 BEFORE PUMPING 40 (NEAREST FOOT) 17 20
 WHEN PUMPING 440 (NEAREST FOOT) 22 25

TYPE OF PUMP USED (CIRCLE APPROPRIATE BOX) (FOR PUMPING TEST)
 AIR P PISTON T TURBINE
 CENTRIFUGAL R ROTARY O OTHER (DESCRIBE BELOW)
 J JET S SUBMERSIBLE

PUMP INSTALLED
 TYPE OF PUMP (WRITE APPROPRIATE LETTER IN BOX - SEE ABOVE: A, C, J, P, R, S, T, O)

DRILLER WILL INSTALL PUMP (CIRCLE APPROPRIATE BOX) YES NO
 CAPACITY: GALLONS PER MINUTE (TO NEAREST GALLON) 31 35
 PUMP HORSE POWER 37 41
 PUMP COLUMN LENGTH (NEAREST FOOT) 43 47

CASING HEIGHT (CIRCLE APPROPRIATE BOX AND ENTER CASING HEIGHT)
 ABOVE } LAND SURFACE (NEAREST FOOT) 2
 BELOW } 49 50 51

LOCATION OF WELL ON LOT
 SHOW PERMANENT STRUCTURE SUCH AS BUILDINGS, SEPTIC TANKS, AND/OR OTHER LAND MARKS AND INDICATE NOT LESS THAN TWO DISTANCES (MEASUREMENTS TO WELL).

CIRCLE APPROPRIATE BOXES
 A A WELL WAS ABANDONED AND SEALED WHEN THIS WELL WAS COMPLETED
 E ELECTRIC LOG OBTAINED
 P TEST WELL CONVERTED TO PRODUCTION WELL

I HEREBY CERTIFY THAT I HAVE COMPLIED WITH ALL CONDITIONS STATED ON THE ABOVE-CAPTIONED "PERMIT TO DRILL WELL" AND THAT INFORMATION CONTAINED IN THIS REPORT IS TRUE, ACCURATE, AND COMPLETE TO THE BEST OF MY KNOWLEDGE, INFORMATION AND BELIEF.

DRILLERS NAME [Signature]
 SIGNATURE [Signature]

