

1047D-05-373697

PERMIT

SEWAGE DISPOSAL SYSTEM

DEPARTMENT OF HEALTH AND MENTAL HYGIENE

P 48162
A REPAIR

DISTRICT _____

DATE 5/27/92

DATE SYSTEM APPROVED 3/4/92

INSPECTOR M. Rittin

HOWARD COUNTY HEALTH DEPARTMENT
BUREAU OF ENVIRONMENTAL HEALTH
461-9933

INDEXED

Jack Fyock IS PERMITTED TO INSTALL _____ ALTER X

ADDRESS _____ PHONE 988-9270

SUBDIVISION The Heritage LOT _____ ROAD 4050 Hobbs Hill Road

PROPERTY OWNER Richard A. McFaul Beatrice Dame Tax Map: 21

ADDRESS 4050 Hobbs Hill Road Grid: 24
Parcel: 165

SEPTIC TANK CAPACITY 1250 GALLONS

NUMBER OF BEDROOMS 4

125 SQUARE FEET PER BEDROOM

LINEAR FEET OF TRENCH REQUIRED 83

REPAIR - PURPOSE - TO REPAIR FAILING SEPTIC SYSTEM

INLET 5' BOTTOM 11' 6" STONE

PLANS APPROVED BY _____ DATE _____

COVER NO WORK UNTIL INSPECTED AND APPROVED

NEITHER THE HOWARD COUNTY COUNCIL NOR THE HEALTH DEPARTMENT IS RESPONSIBLE FOR THE SUCCESSFUL OPERATION OF ANY SYSTEM

NOTE: CLEANOUT REQUIRED EVERY 70 FEET OF SEWER LINE AND/OR AT 90° SWEEPS IN LINES FROM HOUSE TO DRAIN FIELDS, 90° ELBOWS NOT ACCEPTABLE.

NOTE: ALL PARTS OF SEPTIC SYSTEMS (I.E. TANK, DISTRIBUTION BOX TRENCHES) TO BE 100 FEET FROM WELL (UNLESS OTHERWISE SPECIFICALLY AUTHORIZED)

NOTE: IF DEEP TRENCH(ES) ARE USED CALL FOR INSPECTION BEFORE AND AFTER PLACING GRAVEL IN TRENCH(ES)

NOTE: NO DRY WELL SHALL EXCEED 15 FOOT IN DIAMETER NO ABSORPTION TRENCH TO EXCEED 100 FEET IN LENGTH

NOTE: ALL PIPE FROM HOUSE TO SEPTIC TANK MUST BE CAST IRON OR SCHEDULE 35/40 PVC OR ABS

PERMIT VOID AFTER TWO YEARS

NOTE: INSTALL STAND PIPE ON SEPTIC TANK AND DRY WELL STAND PIPES MUST BE 6 INCHES IN DIAMETER CAST IRON. CONCRETE OR TERRA COTTA OR PVA OR ABS ACCEPTED. IF TOP OF SEPTIC TANK IS DEEPER THAN 3 FEET. MANHOLE TO GRADE REQUIRED.

NOTE: DISTRIBUTION BOXES MUST HAVE BAFFLES

***INSTALLER IS RESPONSIBLE FOR OBTAINING FINAL APPROVAL ON THIS PERMIT**

P 48162

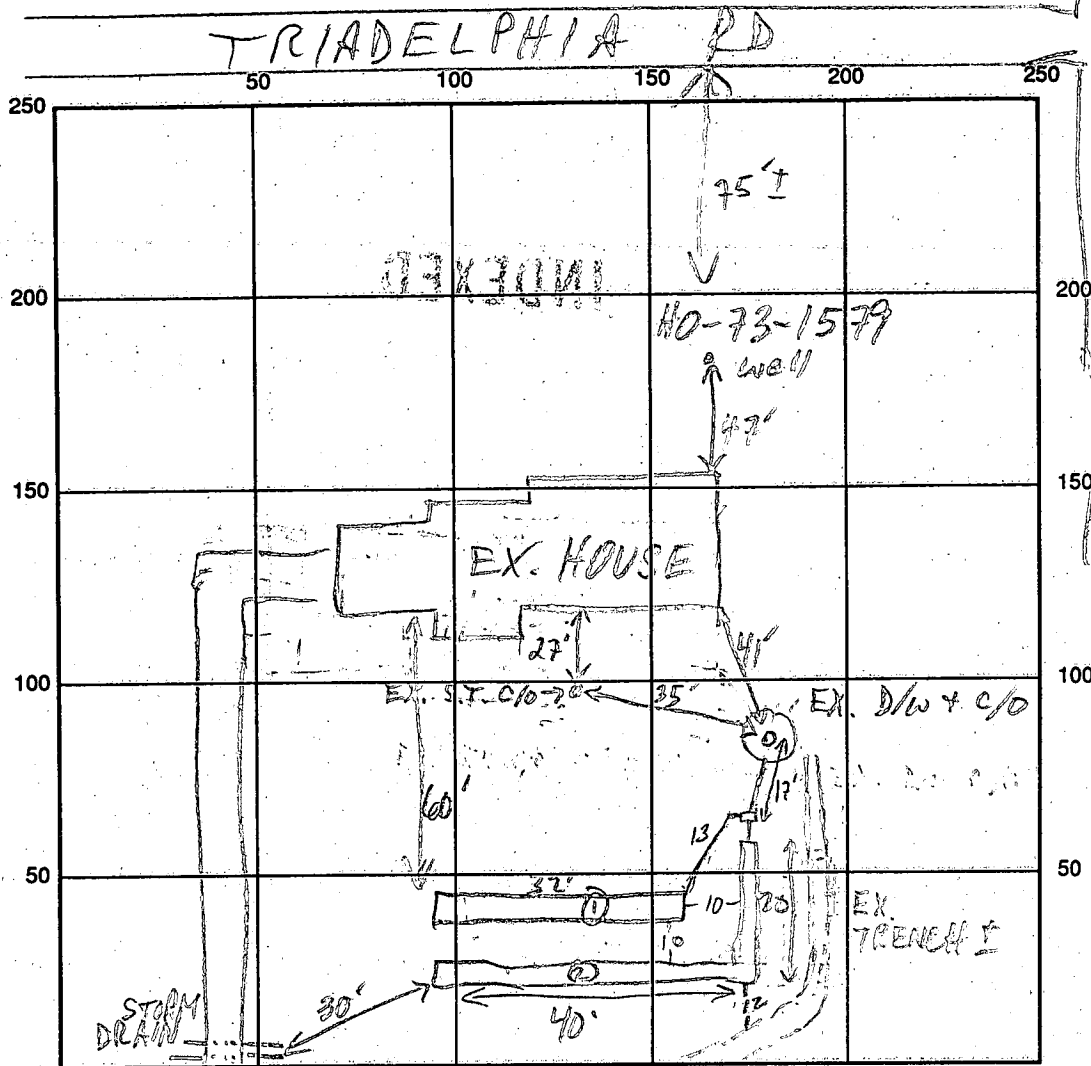

HOBBS HILL RD INDICATE NORTH - NAME ADJOINING ROADWAY AS BASE LINE

SEPTIC TANK LEVEL OK CLEANOUTS OK

DISTRIBUTION BOX LEVEL OK - Baffle IN

DRAIN FIELD/TITLE DEPTH $\frac{11}{11}$ FT. TRENCH WIDTH 2 FT. INLET DEPTH $\frac{1}{5}$ FT.

EFFECTIVE GRAVEL DEPTH $\frac{6}{6}$ FT. TOTAL LENGTH $\frac{32}{60}$ FT.

NUMBER OF TRENCHES 2 ONE SIDEWALL/BOTTOM AREA $\frac{192}{360}$ SQ. FT.

DRYWALL INSIDE DIAMETER FT. EFFECTIVE DEPTH BELOW INLET FT.

ABSORBENT AREA 558 SQ. FT.

REMARKS: 3/4/92 #1 CONTINUE - TRENCH DESIGN DUE TO UNEXPECTED EX. TRENCH MR
3/4/92 #2 INSPECTOR ARRIVED AT TIME AGREED UPON W/
INSTALLER, BUT TRENCH AND ALL OTHER WORK ALREADY
COVERED; NUMBERS ON TRENCH 1 PER INSTALLER MR

DATE SYSTEM APPROVED 3/4/92 INSPECTOR M. Rifkin