

4/1/92 noon

10410-03-288218

# PERMIT

## SEWAGE DISPOSAL SYSTEM

### DEPARTMENT OF HEALTH AND MENTAL HYGIENE

P 4458

A REPAIR

DISTRICT \_\_\_\_\_

DATE 5/27/92

DATE SYSTEM APPROVED 1 April 92

INSPECTOR RH

HOWARD COUNTY HEALTH DEPARTMENT  
BUREAU OF ENVIRONMENTAL HEALTH  
461-9933

**INDEXED**

*Cannot locate permit*

\_\_\_\_\_ Jack Fyock \_\_\_\_\_ IS PERMITTED TO INSTALL \_\_\_\_\_ ALTER X

ADDRESS \_\_\_\_\_ PHONE 988-9270

SUBDIVISION \_\_\_\_\_ LOT \_\_\_\_\_ ROAD 3698 Folly Quarter Road

PROPERTY OWNER \_\_\_\_\_ Richard Morrison Vincent Cifello  
3698 Folly Quarter Road

ADDRESS \_\_\_\_\_

SEPTIC TANK CAPACITY 1000 GALLONS

NUMBER OF BEDROOMS 3

N/A SQUARE FEET PER BEDROOM

LINEAR FEET OF TRENCH REQUIRED N/A

REPAIR - PURPOSE - METAL SEPTIC TANK HAS COLLASPED. REPLACE METAL TANK WITH A CONCRETE TANK.  
CALL FOR INSPECTION WHEN TANK IS IN PLACE SO SANITARIAN CAN APPROVE.

3/31/92

PLANS APPROVED BY \_\_\_\_\_ DATE \_\_\_\_\_

COVER NO WORK UNTIL INSPECTED AND APPROVED

NEITHER THE HOWARD COUNTY COUNCIL NOR THE HEALTH DEPARTMENT IS RESPONSIBLE FOR THE SUCCESSFUL OPERATION OF ANY SYSTEM

NOTE: CLEANOUT REQUIRED EVERY 70 FEET OF SEWER LINE AND/OR AT 90° SWEEPS IN LINES FROM HOUSE TO DRAIN FIELDS, 90° ELBOWS NOT ACCEPTABLE.

NOTE: ALL PARTS OF SEPTIC SYSTEMS (I.E. TANK, DISTRIBUTION BOX TRENCHES) TO BE 100 FEET FROM WELL (UNLESS OTHERWISE SPECIFICALLY AUTHORIZED)

NOTE: IF DEEP TRENCH(ES) ARE USED CALL FOR INSPECTION BEFORE AND AFTER PLACING GRAVEL IN TRENCH(ES)

NOTE: NO DRY WELL SHALL EXCEED 15 FOOT IN DIAMETER NO ABSORPTION TRENCH TO EXCEED 100 FEET IN LENGTH

NOTE: ALL PIPE FROM HOUSE TO SEPTIC TANK MUST BE CAST IRON OR SCHEDULE 35/40 PVC OR ABS

PERMIT VOID AFTER TWO YEARS

NOTE: INSTALL STAND PIPE ON SEPTIC TANK AND DRY WELL STAND PIPES MUST BE 6 INCHES IN DIAMETER CAST IRON. CONCRETE OR TERRA COTTA OR PVA OR ABS ACCEPTED. IF TOP OF SEPTIC TANK IS DEEPER THAN 3 FEET. MANHOLE TO GRADE REQUIRED.

NOTE: DISTRIBUTION BOXES MUST HAVE BAFFLES

**\*INSTALLER IS RESPONSIBLE FOR OBTAINING FINAL APPROVAL ON THIS PERMIT**

HD-260(6-90)

\*CALL 461-9933 FOR INSPECTION OF SEPTIC SYSTEM.

48158

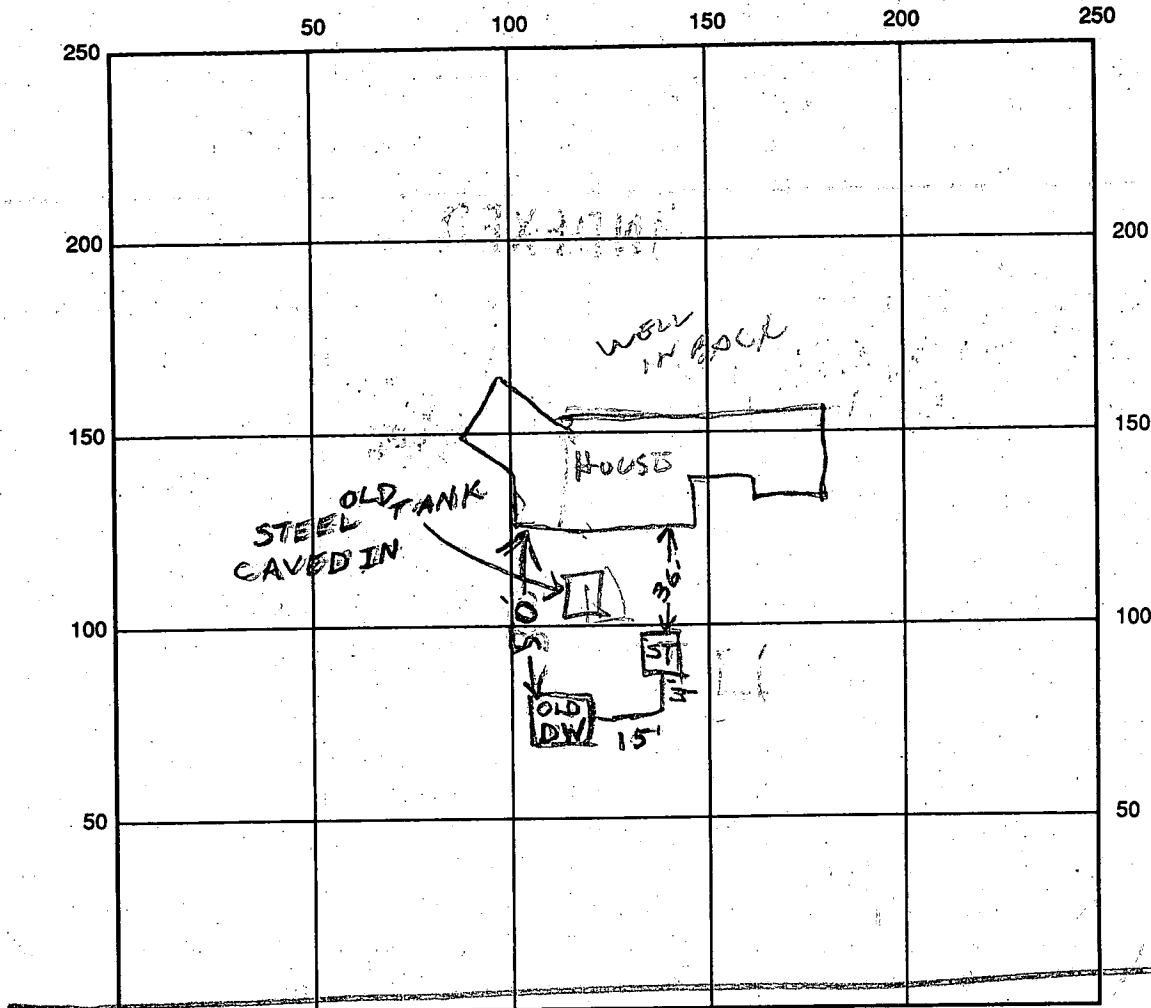

INDICATE NORTH, NAME ADJOINING ROADWAY AS BASE LINE

FOLLY VARTER

SEPTIC TANK LEVEL 1000 CONCRETE CLEANOUTS OK

DISTRIBUTION BOX LEVEL \_\_\_\_\_

DRAIN FIELD/TITLE DEPTH \_\_\_\_\_ FT. TRENCH WIDTH \_\_\_\_\_ FT. INLET DEPTH \_\_\_\_\_ FT.

EFFECTIVE GRAVEL DEPTH \_\_\_\_\_ FT. TOTAL LENGTH \_\_\_\_\_ FT.

NUMBER OF TRENCHES \_\_\_\_\_ ONE SIDEWALL/BOTTOM AREA \_\_\_\_\_ SQ. FT.

DRYWALL INSIDE DIAMETER \_\_\_\_\_ FT. EFFECTIVE DEPTH BELOW INLET \_\_\_\_\_ FT.

ABSORBENT AREA \_\_\_\_\_ SQ. FT.

REMARKS: 4/1/92 FINISH HOOKING UP TANK & COVER WORK

DATE SYSTEM APPROVED 4/1/92 INSPECTOR Raymond Hodges