

4/6 5/14/92
@ 2:00 PM

PERMIT

SEWAGE DISPOSAL SYSTEM

DEPARTMENT OF HEALTH AND MENTAL HYGIENE

P 48141

A REPAIR

DISTRICT _____

DATE 5/21/92

HOWARD COUNTY HEALTH DEPARTMENT
BUREAU OF ENVIRONMENTAL HEALTH
461-9933

INDEXED
Don't permit

DATE SYSTEM APPROVED 5-14-92

INSPECTOR R.P. Pugh

Jenkins Brothers Septic Tank Service IS PERMITTED TO INSTALL _____ ALTER

ADDRESS 7670 Smiths Private Road, Sykesville, Maryland PHONE 461-9282

SUBDIVISION _____ LOT _____ ROAD 10425 Route 108

PROPERTY OWNER Allen (next to bar)
10425 Route 108

ADDRESS _____

SEPTIC TANK CAPACITY 1500 GALLONS

NUMBER OF BEDROOMS 4

126 SQUARE FEET PER BEDROOM

LINEAR FEET OF TRENCH REQUIRED 100

REPORTED
125
4
5 [500 / 100]
4BR-3APT
UNIT

*Test hole 13 ft deep
4 1/2' - 5' to bottom is mix of brown
very fine sand brown and white
& light green clay sands but
No rock or water encountered*

REPAIR - PURPOSE - REPLACE COLLAPSED SEPTIC TANK, FAILING DRYWELL. 5/13/92
Call for inspection when ground is opened so sanitarian can recommend repair.

*Replace existing collapsed septic tank with a 1500 gallon septic tank. Abandon old dry well and
fill in collapsed septic tank. Install one trench 9ft deep, 2ft wide, 5 ft gravel fill,
inlet at 4 ft. RP 5/13/92*

PLANS APPROVED BY R. Pugh DATE 5-13-92

COVER NO WORK UNTIL INSPECTED AND APPROVED

NEITHER THE HOWARD COUNTY COUNCIL NOR THE HEALTH DEPARTMENT IS RESPONSIBLE FOR THE SUCCESSFUL OPERATION OF ANY SYSTEM

NOTE: CLEANOUT REQUIRED EVERY 70 FEET OF SEWER LINE AND/OR AT 90° SWEEPS IN LINES FROM HOUSE TO DRAIN FIELDS, 90° ELBOWS NOT ACCEPTABLE.

NOTE: ALL PARTS OF SEPTIC SYSTEMS (I.E. TANK, DISTRIBUTION BOX TRENCHES) TO BE 100 FEET FROM WELL (UNLESS OTHERWISE SPECIFICALLY AUTHORIZED)

NOTE: IF DEEP TRENCH(ES) ARE USED CALL FOR INSPECTION BEFORE AND AFTER PLACING GRAVEL IN TRENCH(ES)

NOTE: NO DRY WELL SHALL EXCEED 15 FOOT IN DIAMETER NO ABSORPTION TRENCH TO EXCEED 100 FEET IN LENGTH

NOTE: ALL PIPE FROM HOUSE TO SEPTIC TANK MUST BE CAST IRON OR SCHEDULE 35/40 PVC OR ABS

PERMIT VOID AFTER TWO YEARS

NOTE: INSTALL STAND PIPE ON SEPTIC TANK AND DRY WELL STAND PIPES MUST BE 6 INCHES IN DIAMETER CAST IRON. CONCRETE OR TERRA COTTA OR PVA OR ABS ACCEPTED. IF TOP OF SEPTIC TANK IS DEEPER THAN 3 FEET. MANHOLE TO GRADE REQUIRED.

NOTE: DISTRIBUTION BOXES MUST HAVE BAFFLES

***INSTALLER IS RESPONSIBLE FOR OBTAINING FINAL APPROVAL ON THIS PERMIT**

48141

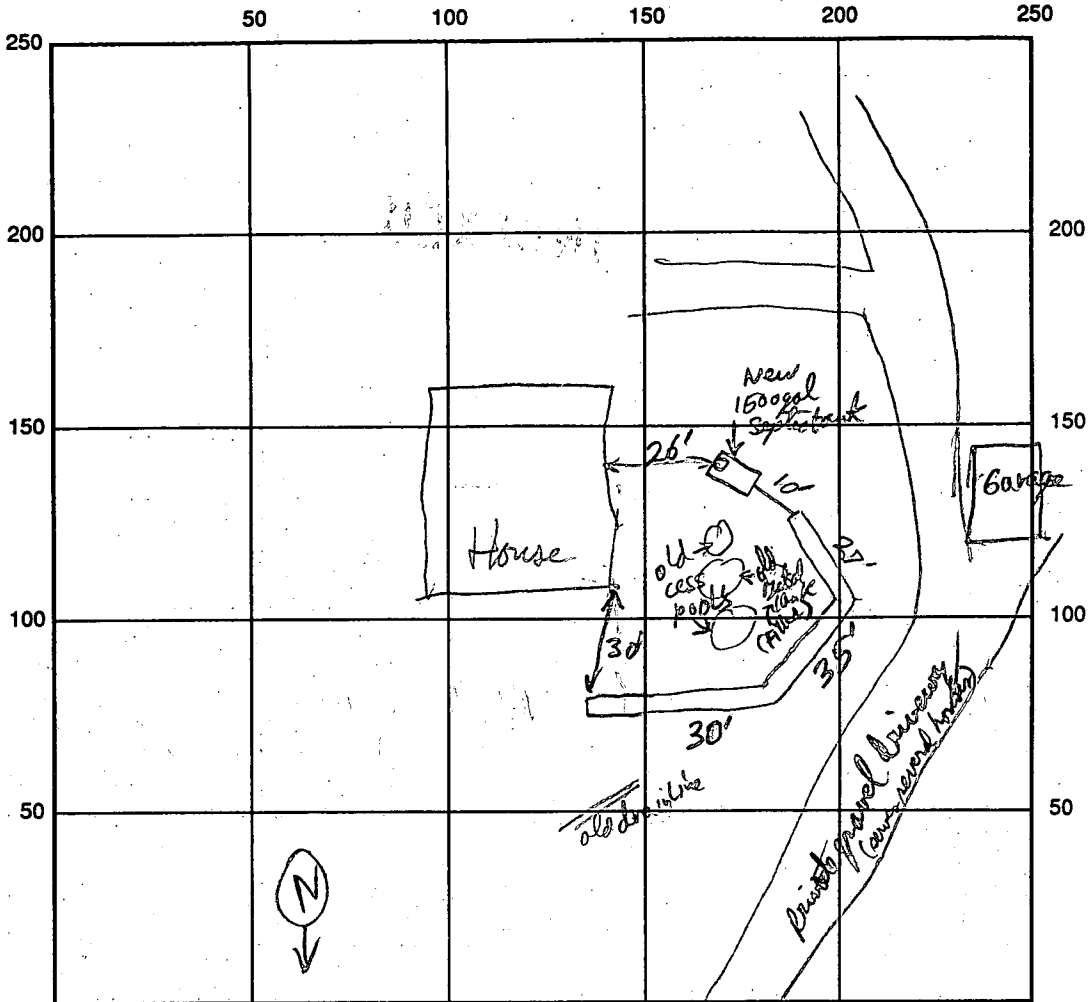

Rt 108 INDICATE NORTH - NAME ADJOINING ROADWAY AS BASE LINE

SEPTIC TANK LEVEL 1500 gal S.T. CLEANOUTS 2 S.T.

DISTRIBUTION BOX LEVEL NA

DRAIN FIELD/TITLE DEPTH 9' FT. TRENCH WIDTH 2' FT. INLET DEPTH 4' FT.

EFFECTIVE GRAVEL DEPTH 8' FT. TOTAL LENGTH 100 FT.

NUMBER OF TRENCHES 1 ONE SIDEWALL/BOTTOM AREA 500 SQ. FT.

DRYWALL INSIDE DIAMETER _____ FT. EFFECTIVE DEPTH BELOW INLET _____ FT.

ABSORBENT AREA _____ SQ. FT.

REMARKS: Trench & Tank OK to connect R/P 5/14/92

DATE SYSTEM APPROVED 5-14-92 INSPECTOR [Signature]