

4/23 → ① P.C.O. → A.M.  
→ ② P.C.O. → P.M.  
P = 48042

# PERMIT

## SEWAGE DISPOSAL SYSTEM

### DEPARTMENT OF HEALTH AND MENTAL HYGIENE

A REPAIR

DISTRICT \_\_\_\_\_

DATE 4/16/92

(Replaced pipe only + covered)  
DATE SYSTEM APPROVED \_\_\_\_\_  
c.B.S.

INSPECTOR \_\_\_\_\_

# INDEXED

HOWARD COUNTY HEALTH DEPARTMENT  
BUREAU OF ENVIRONMENTAL HEALTH  
461-9933

4/22/92 10:00 P.S.A.B.  
4/23/92 10:00  
Case  
X 2:30  
✓ ③ 4:30

4/23/92  
(Dave Dietzel at site)  
Works For

J. A. Smith IS PERMITTED TO INSTALL \_\_\_\_\_ ALTER

ADDRESS 5705 Landing Road, Elkridge, Maryland 21227 PHONE 796-7532

SUBDIVISION \_\_\_\_\_ LOT \_\_\_\_\_ ROAD 10609 Gorman Road

PROPERTY OWNER John McCoy

ADDRESS 10609 Gorman Road  
Laurel, Maryland 20707

SEPTIC TANK CAPACITY 1000 GALLONS PUBLIC SEWER IS NOT AVAILABLE TO THE PROPERTY PER  
NUMBER OF BEDROOMS 3 JEAN REED - 4/15/92

\_\_\_\_\_ SQUARE FEET PER BEDROOM

LINEAR FEET OF TRENCH REQUIRED \_\_\_\_\_

DIRECTIONS - "ON THE LOOP"  
(SAME ADDRESS ON STRAIGHT STREET IS ACTUALLY DIFFERENT RD (J. HOOKING))

REPAIR - PURPOSE - Drainfield Problems.

Call for inspection when ground is opened so sanitarian can recommend repair. 4/14/92

- # ① 10:05 pipe not in end of septic tank - 2 1/2' below hole of tank per Mr. Smith @ site; Rechecked @ 12:30 p.m. 4/23/92
- # ② Recommend Replace pipe with schedule 40 from tank to dry well
- # ③ Plans approved by C. B. S. for C. William DATE 4/23/92  
1:30 near tank Later P.M. - all covered. c.B.S.

- NEITHER THE HOWARD COUNTY COUNCIL NOR THE HEALTH DEPARTMENT IS RESPONSIBLE FOR THE SUCCESSFUL OPERATION OF ANY SYSTEM
- NOTE: CLEANOUT REQUIRED EVERY 70 FEET OF SEWER LINE AND/OR AT 90° SWEEPS IN LINES FROM HOUSE TO DRAIN FIELDS, 90° ELBOWS NOT ACCEPTABLE.
- NOTE: ALL PARTS OF SEPTIC SYSTEMS (I.E. TANK, DISTRIBUTION BOX TRENCHES) TO BE 100 FEET FROM WELL (UNLESS OTHERWISE SPECIFICALLY AUTHORIZED)
- NOTE: IF DEEP TRENCH(ES) ARE USED CALL FOR INSPECTION BEFORE AND AFTER PLACING GRAVEL IN TRENCH(ES)
- NOTE: NO DRY WELL SHALL EXCEED 15 FOOT IN DIAMETER NO ABSORPTION TRENCH TO EXCEED 100 FEET IN LENGTH
- NOTE: ALL PIPE FROM HOUSE TO SEPTIC TANK MUST BE CAST IRON OR SCHEDULE 35/40 PVC OR ABS
- PERMIT VOID AFTER TWO YEARS
- NOTE: INSTALL STAND PIPE ON SEPTIC TANK AND DRY WELL STAND PIPES MUST BE 6 INCHES IN DIAMETER CAST IRON. CONCRETE OR TERRA COTTA OR PVA OR ABS ACCEPTED. IF TOP OF SEPTIC TANK IS DEEPER THAN 3 FEET. MANHOLE TO GRADE REQUIRED.
- NOTE: DISTRIBUTION BOXES MUST HAVE BAFFLES

**\*INSTALLER IS RESPONSIBLE FOR OBTAINING FINAL APPROVAL ON THIS PERMIT**

48042

GORMAN ROAD  
 JOHN HOPKINS ROAD

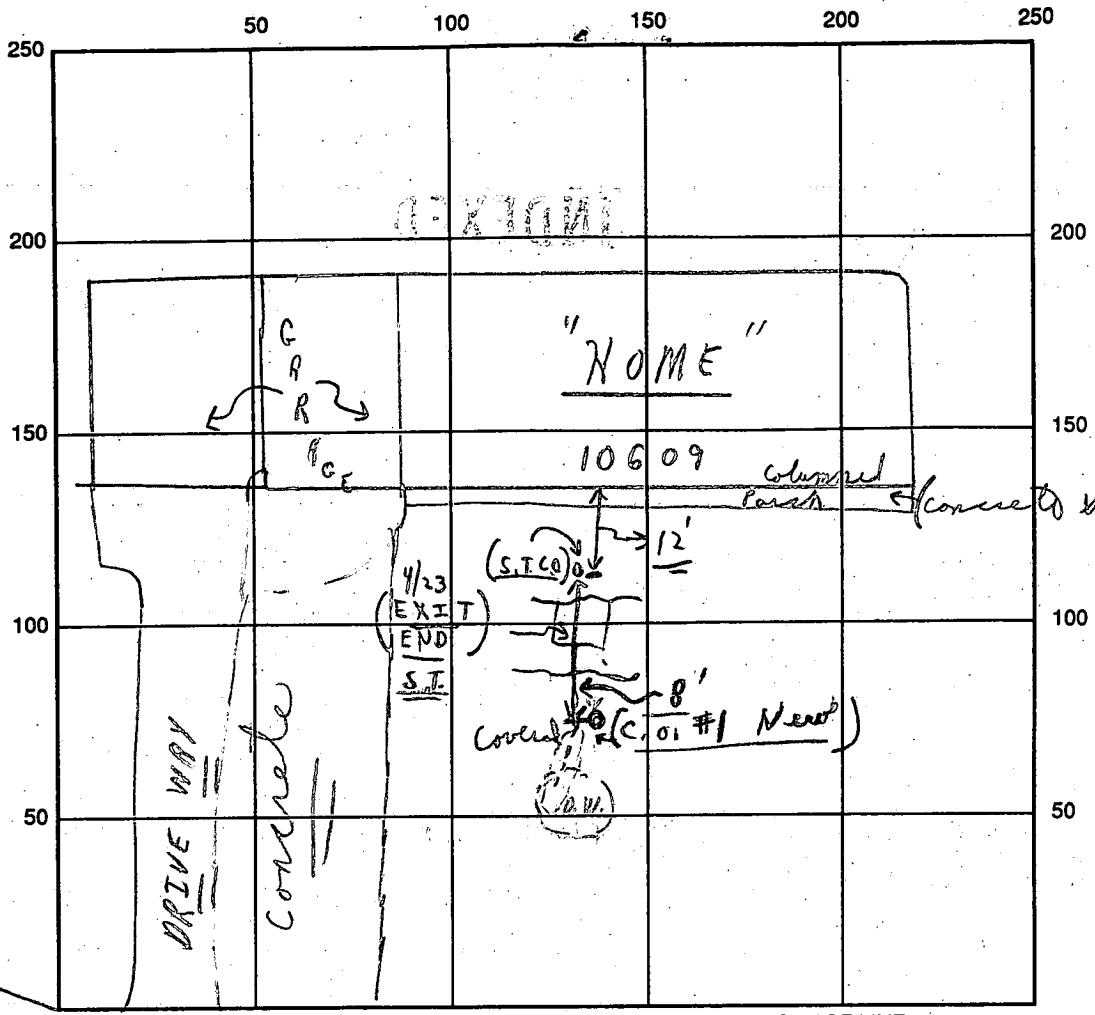

INDICATE NORTH - NAME ADJOINING ROADWAY AS BASE LINE

GORMAN ROAD

SEPTIC TANK LEVEL Existing CLEANOUTS Existing / c.o. #1 New  
 DISTRIBUTION BOX LEVEL N/A 2:02 P.M.

DRAIN FIELD/TITLE DEPTH      FT. TRENCH WIDTH      FT. INLET DEPTH      FT.  
 EFFECTIVE GRAVEL DEPTH      FT. TOTAL LENGTH      FT.  
 NUMBER OF TRENCHES      ONE SIDEWALL/BOTTOM AREA      SQ. FT.  
 DRYWALL INSIDE DIAMETER      FT. EFFECTIVE DEPTH BELOW INLET      FT.  
 ABSORBENT AREA      SQ. FT.

REMARKS: 4/23/92 A.M. - OK TO CONTINUE - LEFT CARD P.D. P.M. 4/23/92  
Line from septic tank to dry well - old mangelberg, to  
be replaced; C.B.D.

(P.O. 4/15) / etc. pipes all covered; new white plastic c.o. to grade  
 near S. Tank (Steve Lampert son of Mc Carstairs), c.b.d.  
 DATE SYSTEM APPROVED (all covered) INSPECTOR "Not seen" and  
(replaced pipe) only C.B.D.

app. 7-24-79  
D.I.

# PERMIT

P 30011  
A REPAIR

SEWAGE DISPOSAL SYSTEM

MARYLAND STATE DEPARTMENT OF HEALTH\*

HOWARD COUNTY

ELLICOTT CITY

DISTRICT \_\_\_\_\_

DATE 7/23/79

**INDEXED**

Olen Ketterman IS PERMITTED TO INSTALL \_\_\_\_\_ ALTER X

ADDRESS \_\_\_\_\_ PHONE \_\_\_\_\_

SUBDIVISION \_\_\_\_\_ ROAD 10609 Gorman Road LOT \_\_\_\_\_

PROPERTY OWNER Bob Rinehart

ADDRESS 10609 Gorman Road, Laurel, Md.

SPECIFICATIONS 3 bedrooms

SEPTIC TANK CAPACITY 1000 GALLONS

DRAIN FIELD \_\_\_\_\_ DEPTH \_\_\_\_\_ FEET, BOTTOM AREA \_\_\_\_\_ SQ. FT.

DEEP TRENCH \_\_\_\_\_ DEPTH \_\_\_\_\_ FEET, BOTTOM AREA \_\_\_\_\_ SQ. FT.

SEEPAGE PITS \_\_\_\_\_ ABSORBENT SIDE-WALL AREA \_\_\_\_\_ SQ. FT.

INLET PIPE \_\_\_\_\_ FT. BELOW ORIGINAL GRADE. MAXIMUM DEPTH \_\_\_\_\_ FT. BELOW ORIGINAL GRADE

EFFECTIVE DEPTH AT \_\_\_\_\_ FT. BELOW ORIGINAL GRADE.

LOCATE DISPOSAL AREA \_\_\_\_\_ FT. FROM \_\_\_\_\_ LOT LINE AND \_\_\_\_\_ FT. FROM \_\_\_\_\_ LOT LINE AS SEEN WHEN  
FACING LOT FROM \_\_\_\_\_

REPAIR-CALL FOR INSPECTION WHEN GROUND IS OPENED UP SO SANITARIAN CAN

RECOMMEND REPAIR.

PLANS APPROVED BY Palmer F. Wine DATE 7/23/79

COVER NO WORK UNTIL INSPECTED AND APPROVED.

NEITHER THE HOWARD COUNTY COUNCIL NOR THE HEALTH DEPARTMENT IS RESPONSIBLE FOR THE SUCCESSFUL OPERATION OF ANY SYSTEM.

NOTE: IF TRENCH IS USED CALL FOR INSPECTION BEFORE PLACING GRAVEL IN TRENCH.

NOTE: NO DRY WELL SHALL EXCEED 15 FOOT IN DIAMETER.

NOTE: ALL PIPE FROM HOUSE TO DISPOSAL AREA MUST BE CAST IRON.

PERMIT VOID AFTER THREE YEARS.

NOTE: INSTALL STAND PIPE ON SEPTIC TANK AND DRY WELL. STAND PIPES MUST BE 6 INCHES IN DIAMETER. CAST IRON, CONCRETE OR TERRA  
COTTA ACCEPTED.

**\*INSTALLER IS RESPONSIBLE FOR OBTAINING FINAL APPROVAL ON THIS PERMIT.**

P 30011

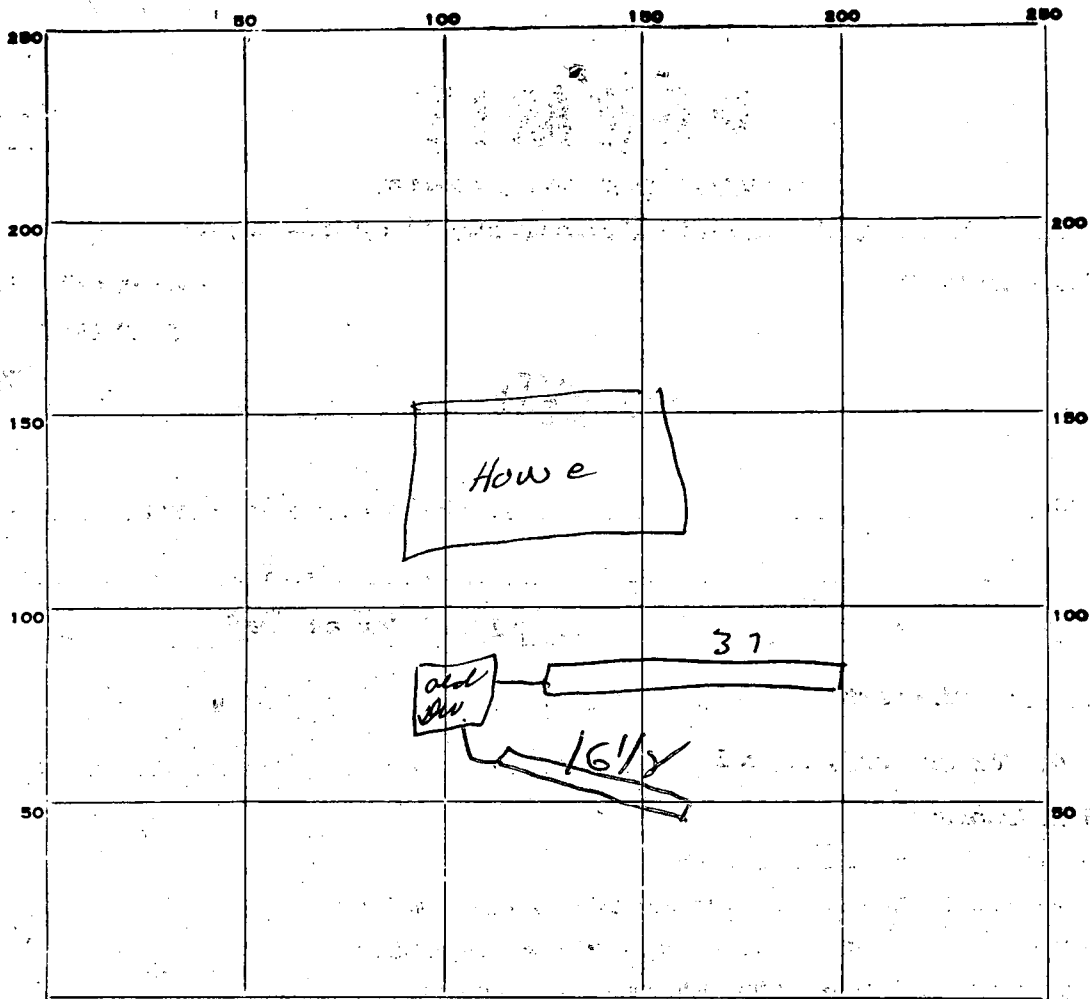

INDICATE NORTH. - NAME ADJOINING ROADWAY AS BASE LINE.

*Sorman Rd*

PERMIT CARD \_\_\_\_\_

SEPTIC TANK, LEVEL \_\_\_\_\_

CLEANOUTS \_\_\_\_\_

DISTRIBUTION BOX, LEVEL \_\_\_\_\_

*Trench #1 12 1/2*

*2*

TILE FIELD, DEPTH \_\_\_\_\_ FT. TRENCH WIDTH \_\_\_\_\_ FT.

GRAVEL DEPTH *7 1/2* IN. TOTAL LENGTH *Trench #1 37 1/2* FT.

NUMBER OF TRENCHES \_\_\_\_\_ TOTAL BOTTOM AREA \_\_\_\_\_

SEEPAGE PITS, INSIDE DIAMETER \_\_\_\_\_ FT. DEPTH BELOW INLET \_\_\_\_\_ FT.

ABSORBENT AREA *Trench #1 - 2770 sq ft* } *389+*  
*112 sq ft*

REMARKS \_\_\_\_\_

DATE SYSTEM APPROVED *7/24/79*

INSPECTOR *W. J. Manoy*

To Whom It May Concern

We (ROBERT C. RINEHART & SUE A. THOMAS)  
owners of the property at 10609 Gorman  
Rd, contracted with Olin Ketterman to  
repair our septic system.

Sue A. Thomas observed the new trench  
before backfill. It was 12 1/2 feet deep  
and 37 1/2 feet long and 2 feet wide.

Robert C. Rinehart & Sue A. Thomas  
7-25-79

HOUSE

16 1/2'

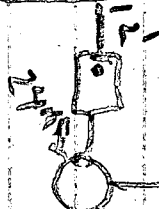

37 1/2' long

16 1/2' long

12 1/2' deep

16 1/2  
- 4  
12 1/2