

Contractor to install 6 in clean out to tank JEN 3-3-92

2-14-92  
11:00am

# PERMIT

## SEWAGE DISPOSAL SYSTEM

### DEPARTMENT OF HEALTH AND MENTAL HYGIENE

P 47831

A REPAIR

DISTRICT \_\_\_\_\_

DATE 2/11/92

DATE SYSTEM APPROVED 2-14-92

INSPECTOR JEN

**HOWARD COUNTY HEALTH DEPARTMENT**  
**BUREAU OF ENVIRONMENTAL HEALTH**  
461-9933

**INDEXED**

Jenkins Brothers IS PERMITTED TO INSTALL \_\_\_\_\_ ALTER X

ADDRESS 7670 Smith's Private Road, Sykesville, Maryland PHONE 465-6646

SUBDIVISION \_\_\_\_\_ LOT \_\_\_\_\_ ROAD 12690 Old Frederick road

PROPERTY OWNER \_\_\_\_\_ Calder

ADDRESS \_\_\_\_\_ 12690 Old Frederick Road  
Sykesville, Maryland 21784

SEPTIC TANK CAPACITY 1000 GALLONS

NUMBER OF BEDROOMS 3

\_\_\_\_\_ SQUARE FEET PER BEDROOM

LINEAR FEET OF TRENCH REQUIRED \_\_\_\_\_

85' - 10' DEEP  
w 6' STUMB

REPAIR - PURPOSE - SEPTIC SYSTEM HAS FAILED.  
CALL FOR INSPECTION WHEN GROUND IS OPENED SO SANITARIAN CAN RECOMMEND  
REPAIR.

PLANS APPROVED BY \_\_\_\_\_ C. Williams DATE 2/7/92

COVER NO WORK UNTIL INSPECTED AND APPROVED

NEITHER THE HOWARD COUNTY COUNCIL NOR THE HEALTH DEPARTMENT IS RESPONSIBLE FOR THE SUCCESSFUL OPERATION OF ANY SYSTEM

NOTE: CLEANOUT REQUIRED EVERY 70 FEET OF SEWER LINE AND/OR AT 90° SWEEPS IN LINES FROM HOUSE TO DRAIN FIELDS, 90° ELBOWS NOT ACCEPTABLE.

NOTE: ALL PARTS OF SEPTIC SYSTEMS (I.E. TANK, DISTRIBUTION BOX TRENCHES) TO BE 100 FEET FROM WELL (UNLESS OTHERWISE SPECIFICALLY AUTHORIZED)

NOTE: IF DEEP TRENCH(ES) ARE USED CALL FOR INSPECTION BEFORE AND AFTER PLACING GRAVEL IN TRENCH(ES)

NOTE: NO DRY WELL SHALL EXCEED 15 FOOT IN DIAMETER NO ABSORPTION TRENCH TO EXCEED 100 FEET IN LENGTH

NOTE: ALL PIPE FROM HOUSE TO SEPTIC TANK MUST BE CAST IRON OR SCHEDULE 35/40 PVC OR ABS

PERMIT VOID AFTER TWO YEARS

NOTE: INSTALL STAND PIPE ON SEPTIC TANK AND DRY WELL STAND PIPES MUST BE 6 INCHES IN DIAMETER CAST IRON. CONCRETE OR TERRA COTTA OR PVA OR ABS ACCEPTED. IF TOP OF SEPTIC TANK IS DEEPER THAN 3 FEET. MANHOLE TO GRADE REQUIRED.

NOTE: DISTRIBUTION BOXES MUST HAVE BAFFLES

**\*INSTALLER IS RESPONSIBLE FOR OBTAINING FINAL APPROVAL ON THIS PERMIT**

47831

2/12/92

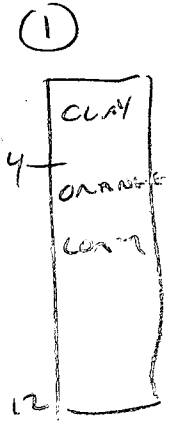

INSTALL 85' TRENCH  
w/ 6' STONE  
MAX BOTTOM  
DEPTH 10'  
CW

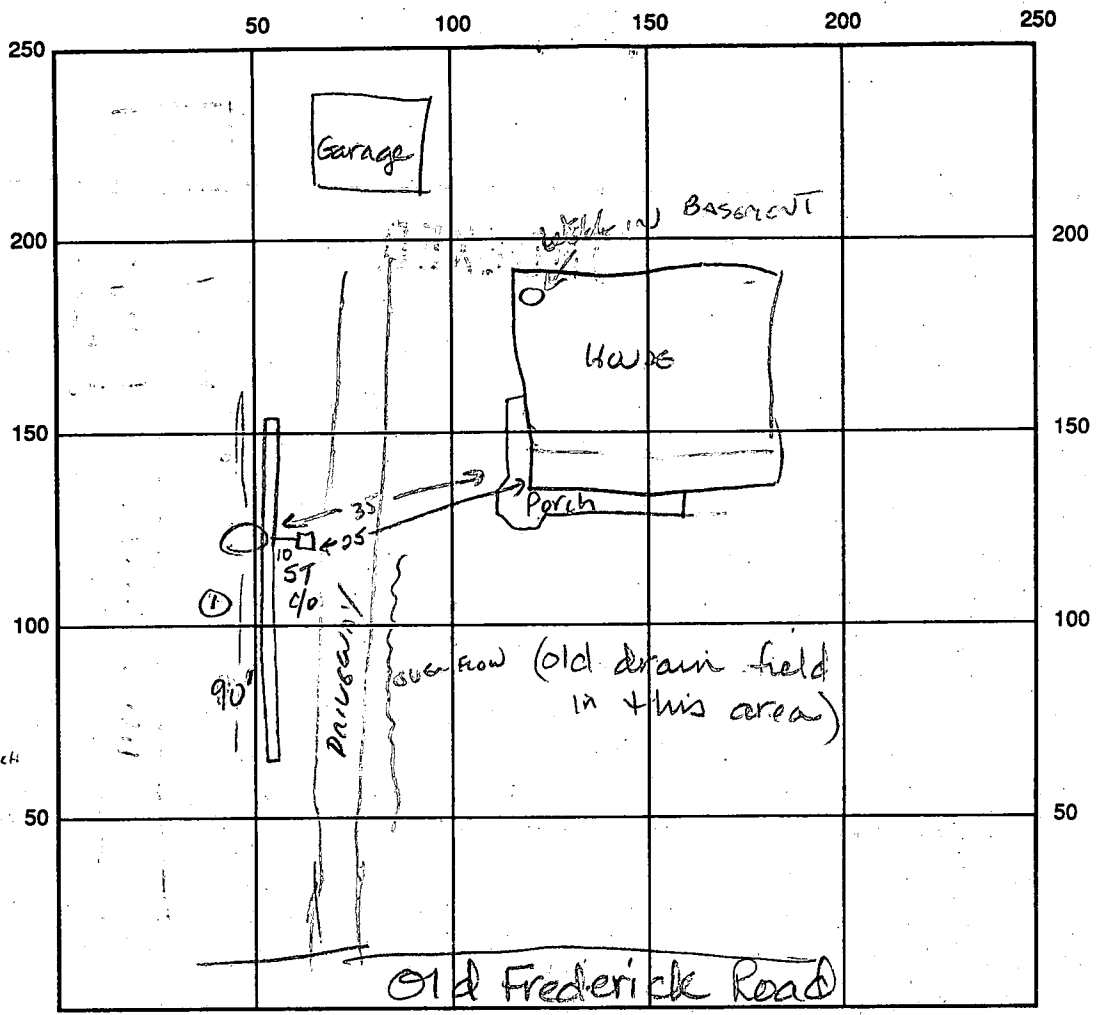

INDICATE NORTH - NAME ADJOINING ROADWAY AS BASE LINE

SEPTIC TANK LEVEL EXISTING CLEANOUTS 1 on ST (to be placed)

DISTRIBUTION BOX LEVEL N/A

DRAIN FIELD/TILE DEPTH 10± FT. TRENCH WIDTH 2 FT. INLET DEPTH 2-4 FT.

EFFECTIVE GRAVEL DEPTH 6± FT. TOTAL LENGTH 90 FT.

NUMBER OF TRENCHES 1 ONE SIDEWALL/BOTTOM AREA 540 SQ. FT.

DRYWALL INSIDE DIAMETER \_\_\_\_\_ FT. EFFECTIVE DEPTH BELOW INLET \_\_\_\_\_ FT.

ABSORBENT AREA 540 SQ. FT.

REMARKS: 2-14-92 Trench stoned and completed upon arrival. No bottom observed. Snow covered paper on half of trench. Installer stated trench depth and pipe installed for total length. JEN

2-27-92 Observed 4inch diameter pvc pipe w/cap at location of septic tank cleanout. Installed after inspector left site. JEN

DATE SYSTEM APPROVED 2-14-92 INSPECTOR Jane E. Madson