

# PERMIT

## SEWAGE DISPOSAL SYSTEM

### DEPARTMENT OF HEALTH AND MENTAL HYGIENE

P 47709  
A 05730  
A REPAIR

HOWARD COUNTY HEALTH DEPARTMENT  
BUREAU OF ENVIRONMENTAL HEALTH  
461-9933

# INDEXED

DISTRICT \_\_\_\_\_

DATE 1/3/92

DATE SYSTEM APPROVED 11-12-91

INSPECTOR JEN

\_\_\_\_\_ Jack Fyock \_\_\_\_\_ IS PERMITTED TO INSTALL \_\_\_\_\_ ALTER

ADDRESS \_\_\_\_\_ PHONE 988-9270

SUBDIVISION Arverne S/L LOT 4 ROAD 1270 Drive Road

PROPERTY OWNER George Cain

ADDRESS 1270 Drive Road  
Marriottsville, Maryland

SEPTIC TANK CAPACITY 1000 GALLONS

NUMBER OF BEDROOMS 3

\_\_\_\_\_ SQUARE FEET PER BEDROOM

LINEAR FEET OF TRENCH REQUIRED \_\_\_\_\_

REPAIR - PURPOSE REPLACE COLLAPSED SEPTIC TANK.

Call for inspection when tank is in place.

PLANS APPROVED BY C. Williams DATE 11/12/91

COVER NO WORK UNTIL INSPECTED AND APPROVED

NEITHER THE HOWARD COUNTY COUNCIL NOR THE HEALTH DEPARTMENT IS RESPONSIBLE FOR THE SUCCESSFUL OPERATION OF ANY SYSTEM

NOTE: CLEANOUT REQUIRED EVERY 70 FEET OF SEWER LINE AND/OR AT 90° SWEEPS IN LINES FROM HOUSE TO DRAIN FIELDS, 90° ELBOWS NOT ACCEPTABLE.

NOTE: ALL PARTS OF SEPTIC SYSTEMS (I.E. TANK, DISTRIBUTION BOX TRENCHES) TO BE 100 FEET FROM WELL (UNLESS OTHERWISE SPECIFICALLY AUTHORIZED)

NOTE: IF DEEP TRENCH(ES) ARE USED CALL FOR INSPECTION BEFORE AND AFTER PLACING GRAVEL IN TRENCH(ES)

NOTE: NO DRY WELL SHALL EXCEED 15 FOOT IN DIAMETER NO ABSORPTION TRENCH TO EXCEED 100 FEET IN LENGTH

NOTE: ALL PIPE FROM HOUSE TO SEPTIC TANK MUST BE CAST IRON OR SCHEDULE 35/40 PVC OR ABS

PERMIT VOID AFTER TWO YEARS

NOTE: INSTALL STAND PIPE ON SEPTIC TANK AND DRY WELL STAND PIPES MUST BE 6 INCHES IN DIAMETER CAST IRON. CONCRETE OR TERRA COTTA OR PVA OR ABS ACCEPTED. IF TOP OF SEPTIC TANK IS DEEPER THAN 3 FEET. MANHOLE TO GRADE REQUIRED.

NOTE: DISTRIBUTION BOXES MUST HAVE BAFFLES

**\*INSTALLER IS RESPONSIBLE FOR OBTAINING FINAL APPROVAL ON THIS PERMIT**

P 47709

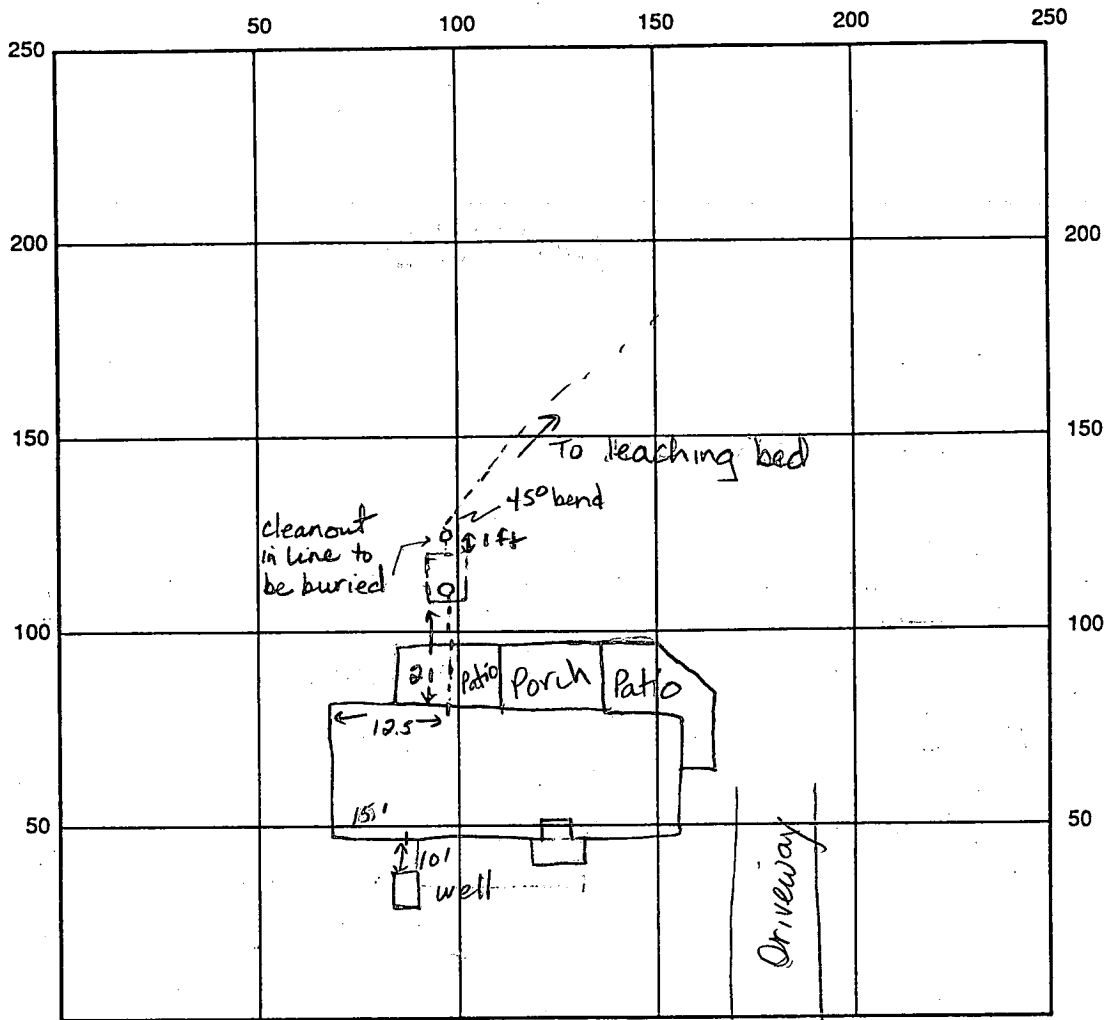

INDICATE NORTH - NAME ADJOINING ROADWAY AS BASE LINE

Driver Road

SEPTIC TANK LEVEL 1000 gal CLEANOUTS 1 on S. Tank, 1 in line

DISTRIBUTION BOX LEVEL N/A

DRAIN FIELD/TITLE DEPTH      FT. TRENCH WIDTH      FT. INLET DEPTH      FT.

EFFECTIVE GRAVEL DEPTH      FT. TOTAL LENGTH      FT.

NUMBER OF TRENCHES      ONE SIDEWALL/BOTTOM AREA      SQ. FT.

DRYWALL INSIDE DIAMETER      FT. EFFECTIVE DEPTH BELOW INLET      FT.

Leaching Bed ABSORBENT AREA 468 SQ. FT.

REMARKS: 11-12-91 OK to cover all work. 750 gallon tank pumped and removed. JENadeau

DATE SYSTEM APPROVED 11-12-91 INSPECTOR Jane E. Nadeau

9/17/62

# PERMIT

Approved  
9/18/62

P 05781  
A 05730

SEWAGE DISPOSAL SYSTEM

MARYLAND STATE DEPARTMENT OF HEALTH

HOWARD COUNTY

ELLICOTT CITY 3

DISTRICT

INDEXED

IND

DATE

9/17/62

*Excavating Contractors*

IS PERMITTED TO INSTALL  ALTER

ADDRESS \_\_\_\_\_ PHONE \_\_\_\_\_

A SEWAGE DISPOSAL SYSTEM LOCATED AT \_\_\_\_\_

SUBDIVISION Driver ROAD Driver Rd LOT 4

PROPERTY OWNER Allen Driver Geo. Cain, Jr.

ADDRESS 92C Driver Rd.  
328-3265

### SPECIFICATIONS

DRAIN FIELD \_\_\_\_\_ DEPTH \_\_\_\_\_ FEET, BOTTOM AREA \_\_\_\_\_ SQ. FT.

SEEPAGE PITS \_\_\_\_\_ ABSORBENT SIDE-WALL AREA \_\_\_\_\_ SQ. FT.

SEPTIC TANK CAPACITY 750 GALLONS

FOR GARBAGE GRINDER, INCREASE DISPOSAL AREA 22% & TANK CAPACITY 50%.

### OTHER

*Leaching bed - 438 sq. ft. absorbent bottom area.*

*to be located about 120 to 150 feet behind existing house*

PLANS APPROVED BY D.W. Magowan DATE 9/6/62

FILL SEPTIC TANK AND DISTRIBUTION BOX WITH WATER BEFORE CALLING FOR AN INSPECTION. COVER NO WORK UNTIL INSPECTED AND APPROVED.

NEITHER THE HOWARD COUNTY COMMISSIONERS NOR THE HEALTH DEPARTMENT IS RESPONSIBLE FOR THE SUCCESSFUL OPERATION OF ANY SYSTEM.

A 05730

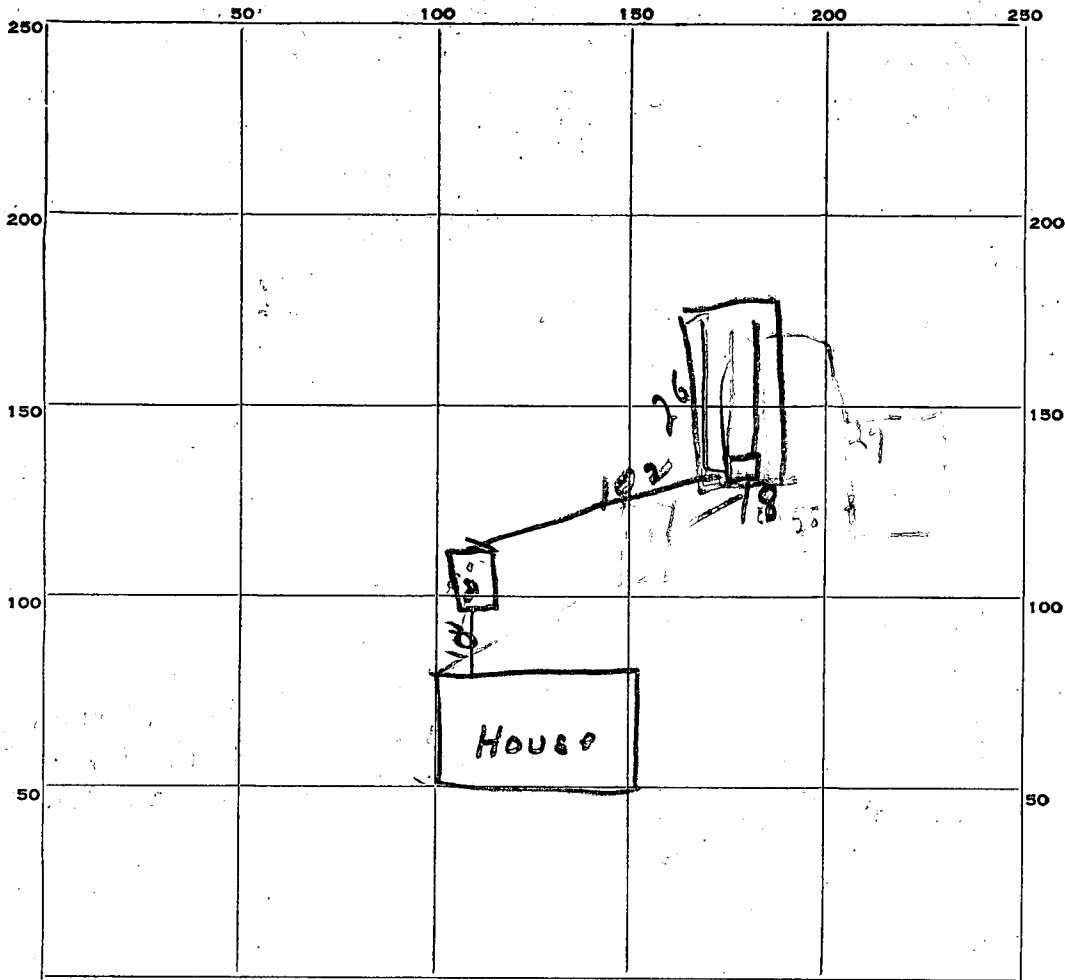

INDICATE NORTH. NAME ADJOINING ROADWAY AS BASE LINE.

*Driver Road*

*Handwritten notes:*  
 26  
 102  
 10  
 108  
 468

PERMIT CARD \_\_\_\_\_

SEPTIC TANK, LEVEL

CLEANOUTS

DISTRIBUTION BOX, LEVEL

*Handwritten:* 5 FT. 19 FT.  
 TILE FIELD, DEPTH \_\_\_\_\_ FT. TRENCH WIDTH \_\_\_\_\_ FT.

GRAVEL DEPTH 3 ft IN. TOTAL LENGTH 26 FT.

NUMBER OF TRENCHES \_\_\_\_\_ TOTAL BOTTOM AREA 468 sq ft

SEEPAGE PITS, INSIDE DIAMETER \_\_\_\_\_ FT. DEPTH BELOW INLET \_\_\_\_\_ FT.

ABSORBENT AREA \_\_\_\_\_ SQ. FT.

REMARKS \_\_\_\_\_

DATE SYSTEM APPROVED 9/18/62

INSPECTOR *[Signature]*

Retest

9/6/62  
1:00

# APPLICATION

A OS 7.30

P \_\_\_\_\_

SEWAGE DISPOSAL TESTING

MARYLAND STATE DEPARTMENT OF HEALTH

HOWARD COUNTY

ELLICOTT CITY

*Septic Tank - 750 gal.*

DISTRICT 3

*Leaching Bed - 438 sqft absorbent bottom area  
to be located about <sup>120</sup> 150 ft behind existing house.*

DATE 9/6/62

TO: THE COUNTY HEALTH OFFICER  
ELLICOTT CITY, MARYLAND

I, HEREBY, APPLY FOR THE NECESSARY TESTS IN ORDER TO CONSTRUCT (OR RECONSTRUCT) A SEWAGE DISPOSAL SYSTEM.

PROPERTY OWNER Allen Driver

ADDRESS \_\_\_\_\_ PHONE \_\_\_\_\_

PROPERTY LOCATION: \_\_\_\_\_

SUBDIVISION Driver LOT NO. 4

ROAD AND DESCRIPTION Driver Rd.

OCCUPANT \_\_\_\_\_ PHONE \_\_\_\_\_

PERSON TO CONSTRUCT SYSTEM \_\_\_\_\_

ADDRESS \_\_\_\_\_ PHONE \_\_\_\_\_

SIZE OF LOT 200' X 400' TYPE BLDG. 3

NUMBER OF BEDROOMS

IF NOT SINGLE RESIDENCE DESCRIBE \_\_\_\_\_

SIGNATURE OF APPLICANT Colin I. Smith

APPROVED BY Ill. Monaghan FOR Leaching Bed DATE 9-6-62

(KIND OF SYSTEM)

REJECTED BY \_\_\_\_\_ FOR \_\_\_\_\_ DATE \_\_\_\_\_

(KIND OF SYSTEM)

HOLD PENDING FURTHER TESTS \_\_\_\_\_ DATE \_\_\_\_\_

REASONS FOR REJECTION OR HOLDING \_\_\_\_\_

# THIS IS NOT A PERMIT

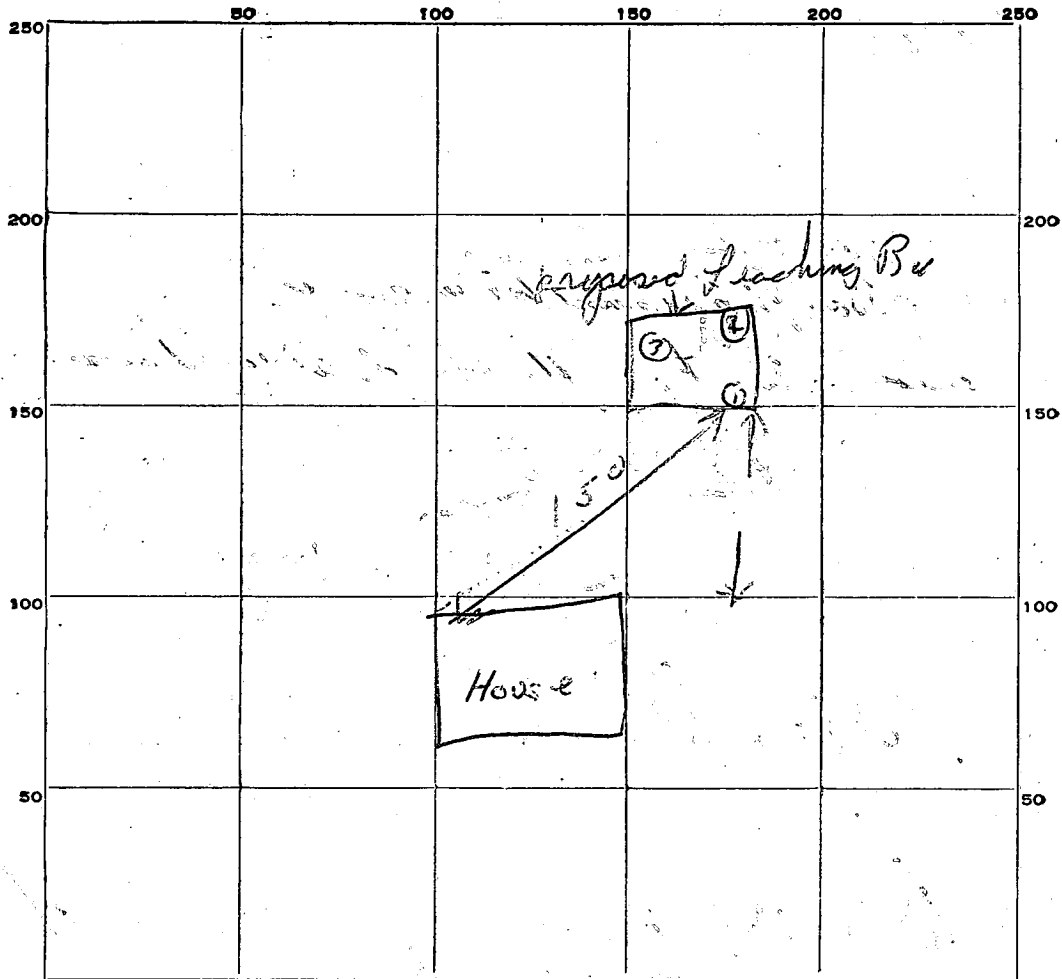

INDICATE NORTH - NAME ADJOINING ROADWAY AS BASE LINE.

*Dinner Road*

$$\begin{array}{r} 35 \\ 72 \\ \hline 34 \\ 43.2 \end{array}$$

DATE	TEST NO.	DEPTH	PRE-WET		TEST - 1" DROP		TIME
			START	STOP	START	STOP	
9/6/62	1	5 1/2	1120	1122	1122	1127	5 min
	2	5 1/2	1125	1132	1132	1150	18 min
	3	5 1/2	1128	1134	1134	1157	23 min

} 15 1/2

SOIL AUGER FINDING \_\_\_\_\_

TESTED BY *Dwm 9/6/62*

REMARKS \_\_\_\_\_

ALSO PRESENT *[Signature]*

LOT NO. *4*

# APPLICATION

A 04482

SEWAGE DISPOSAL TESTING

P \_\_\_\_\_

MARYLAND STATE DEPARTMENT OF HEALTH

HOWARD COUNTY

ELLICOTT CITY

DISTRICT 3

DATE 11/8/61

*one 8 ft in dia by 12 ft deep  
below the inlet located 35 ft  
from the front property line and 55 ft from  
the right side property line. Right side  
property line determined when facing lot  
from Driver Road.*

*750 gal septic tank*

TO: THE COUNTY HEALTH OFFICER  
ELLICOTT CITY, MARYLAND

I, HEREBY, APPLY FOR THE NECESSARY TESTS IN ORDER TO CONSTRUCT (OR RECONSTRUCT) A SEWAGE DISPOSAL SYSTEM.

PROPERTY OWNER Allen Driver

ADDRESS Marriottsville PHONE \_\_\_\_\_

PROPERTY LOCATION:

SUBDIVISION Allen Driver LOT NO. 4

ROAD AND DESCRIPTION Driver Rd.

OCCUPANT \_\_\_\_\_ PHONE \_\_\_\_\_

PERSON TO CONSTRUCT SYSTEM \_\_\_\_\_

ADDRESS \_\_\_\_\_ PHONE \_\_\_\_\_

SIZE OF LOT 200 X 400 TYPE BLDG. 3  
NUMBER OF BEDROOMS

IF NOT SINGLE RESIDENCE DESCRIBE \_\_\_\_\_

SIGNATURE OF APPLICANT *Allen Driver*

APPROVED BY *Jos. Hennigan* FOR *Day Walk* DATE 11-10-61  
(KIND OF SYSTEM)

REJECTED BY \_\_\_\_\_ FOR \_\_\_\_\_ DATE \_\_\_\_\_  
(KIND OF SYSTEM)

HOLD PENDING FURTHER TESTS \_\_\_\_\_ DATE \_\_\_\_\_

REASONS FOR REJECTION OR HOLDING \_\_\_\_\_

# THIS IS NOT A PERMIT

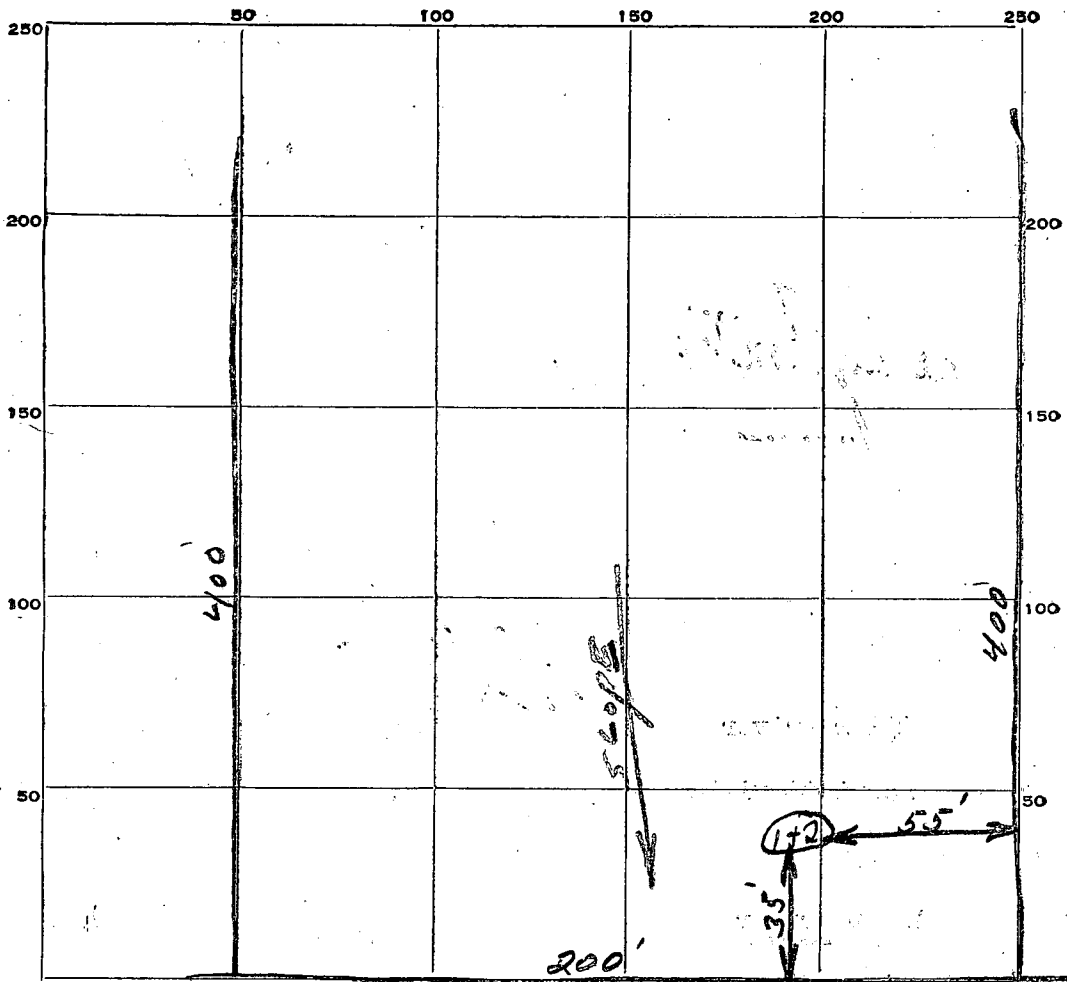

INDICATE NORTH. - NAME ADJOINING ROADWAY AS BASE LINE.

**DRIVER ROAD**

DATE	TEST NO.	DEPTH	PRE-WET		TEST - 1" DROP		TIME
			START	STOP	START	STOP	
11-10-61	1	10'	10:30	10:34	10:34	10:39	57 Min.
	2	5'	10:33	10:36	10:36	10:39	37 Min.
	3						

SOIL AUGER FINDING \_\_\_\_\_

TESTED BY: *J.H.*

REMARKS: *Good ground after 3 FT.*

11-10-61

ALSO PRESENT \_\_\_\_\_

LOT-NO. *4*