

11/15/91 ASAP

PERMIT

292460

SEWAGE DISPOSAL SYSTEM

P 47618

DEPARTMENT OF HEALTH AND MENTAL HYGIENE

A REPAIR

DISTRICT _____

INDEXED

DATE 11-14-91

HOWARD COUNTY HEALTH DEPARTMENT

BUREAU OF ENVIRONMENTAL HEALTH

461-9933

DATE SYSTEM APPROVED 11/15/91

INSPECTOR M. Rifkin

Collins Company, Inc. IS PERMITTED TO INSTALL _____ ALTER

ADDRESS 7702 Gaither Road, Sykesville, Maryland 21784 PHONE 795-8618

SUBDIVISION _____ LOT _____ ROAD 11320 Old Frederick Road

PROPERTY OWNER Renee Thomas
11320 Old Frederick Road

ADDRESS _____

SEPTIC TANK CAPACITY 1000 GALLONS

NUMBER OF BEDROOMS 3

125 SQUARE FEET PER BEDROOM

LINEAR FEET OF TRENCH REQUIRED 63

REPAIR - PURPOSE - Existing septic system close to failing.

Call for inspection when ground is opened so sanitarian can recommend repair.

TRENCH 75' LONG INLET 6" BOTTOM 12"

PLANS APPROVED BY Mark Rifkin DATE 11/13/91

COVER NO WORK UNTIL INSPECTED AND APPROVED

NEITHER THE HOWARD COUNTY COUNCIL NOR THE HEALTH DEPARTMENT IS RESPONSIBLE FOR THE SUCCESSFUL OPERATION OF ANY SYSTEM

NOTE: CLEANOUT REQUIRED EVERY 70 FEET OF SEWER LINE AND/OR AT 90° SWEEPS IN LINES FROM HOUSE TO DRAIN FIELDS, 90° ELBOWS NOT ACCEPTABLE.

NOTE: ALL PARTS OF SEPTIC SYSTEMS (I.E. TANK, DISTRIBUTION BOX TRENCHES) TO BE 100 FEET FROM WELL (UNLESS OTHERWISE SPECIFICALLY AUTHORIZED)

NOTE: IF DEEP TRENCH(ES) ARE USED CALL FOR INSPECTION BEFORE AND AFTER PLACING GRAVEL IN TRENCH(ES)

NOTE: NO DRY WELL SHALL EXCEED 15 FOOT IN DIAMETER NO ABSORPTION TRENCH TO EXCEED 100 FEET IN LENGTH

NOTE: ALL PIPE FROM HOUSE TO SEPTIC TANK MUST BE CAST IRON OR SCHEDULE 35/40 PVC OR ABS

PERMIT VOID AFTER TWO YEARS

NOTE: INSTALL STAND PIPE ON SEPTIC TANK AND DRY WELL STAND PIPES MUST BE 6 INCHES IN DIAMETER CAST IRON. CONCRETE OR TERRA COTTA OR PVA OR ABS ACCEPTED. IF TOP OF SEPTIC TANK IS DEEPER THAN 3 FEET. MANHOLE TO GRADE REQUIRED. Temporary vent

NOTE: DISTRIBUTION BOXES MUST HAVE BAFFLES

***INSTALLER IS RESPONSIBLE FOR OBTAINING FINAL APPROVAL ON THIS PERMIT**

47618

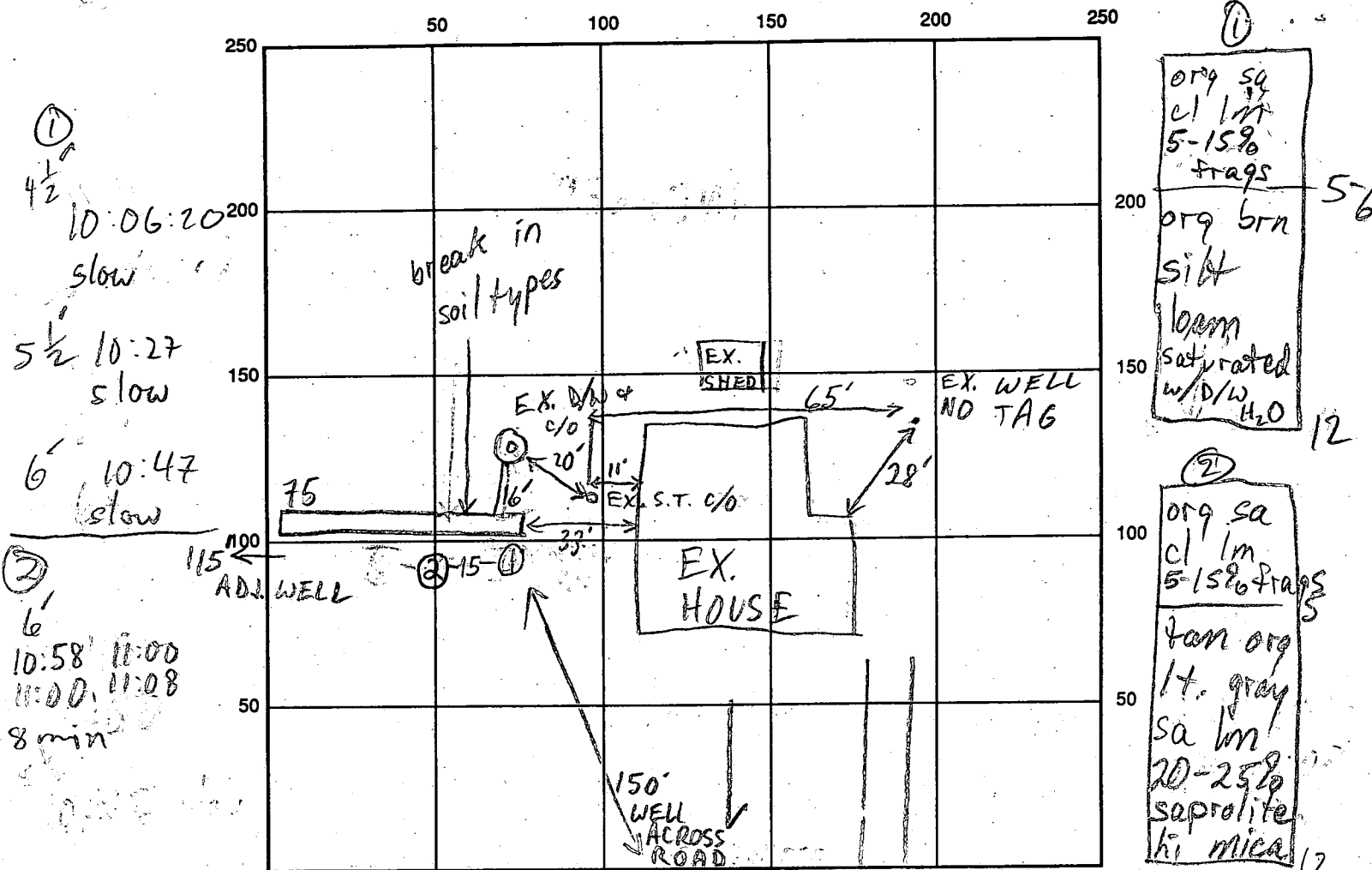

INDICATE NORTH - NAME ADJOINING ROADWAY AS BASE LINE
 OLD FRED. RD

SEPTIC TANK LEVEL OK CLEANOUTS OK

DISTRIBUTION BOX LEVEL

DRAIN FIELD/TITLE DEPTH 12 FT. TRENCH WIDTH 2 FT. INLET DEPTH 6 FT.

EFFECTIVE GRAVEL DEPTH 6 FT. TOTAL LENGTH 75 FT.

NUMBER OF TRENCHES 1 ONE SIDEWALL/BOTTOM AREA 450 SQ. FT.

DRYWALL INSIDE DIAMETER FT. EFFECTIVE DEPTH BELOW INLET FT.

ABSORBENT AREA 450 SQ. FT.

REMARKS: 11/15/91 #1 OK TO DIG MR 11/15/91 #2 OK TO COVER ALL MR

DATE SYSTEM APPROVED 11/15/91 INSPECTOR M. Ritkin