

12:00 pm
9/12/91

Tax ID-03-301656

PERMIT

SEWAGE DISPOSAL SYSTEM

DEPARTMENT OF HEALTH AND MENTAL HYGIENE

P 47568

A REPAIR

DISTRICT _____

DATE 10/17/91

DATE SYSTEM APPROVED 9/12/91

INSPECTOR M. Rifkin

HOWARD COUNTY HEALTH DEPARTMENT
BUREAU OF ENVIRONMENTAL HEALTH
461-9933

INDEXED

Jack Fyock Septic Service IS PERMITTED TO INSTALL _____ ALTER

ADDRESS 13775 Triadelphia Road, Glenelg, Maryland 21737 PHONE 988-9270

SUBDIVISION _____ LOT _____ ROAD 12480 Frederick Road

PROPERTY OWNER Gordon J. Waffield Leonard McClements

ADDRESS _____

SEPTIC TANK CAPACITY 1000 GALLONS

NUMBER OF BEDROOMS 2

125 SQUARE FEET PER BEDROOM

LINEAR FEET OF TRENCH REQUIRED 55

REPAIR - Failing Septic System. Call for inspection when ground is opened so sanitarian can recommend repair.

PLANS APPROVED BY Craig Williams cm DATE 9/11/91

COVER NO WORK UNTIL INSPECTED AND APPROVED

NEITHER THE HOWARD COUNTY COUNCIL NOR THE HEALTH DEPARTMENT IS RESPONSIBLE FOR THE SUCCESSFUL OPERATION OF ANY SYSTEM

NOTE: CLEANOUT REQUIRED EVERY 70 FEET OF SEWER LINE AND/OR AT 90° SWEEPS IN LINES FROM HOUSE TO DRAIN FIELDS, 90° ELBOWS NOT ACCEPTABLE.

NOTE: ALL PARTS OF SEPTIC SYSTEMS (I.E. TANK, DISTRIBUTION BOX TRENCHES) TO BE 100 FEET FROM WELL (UNLESS OTHERWISE SPECIFICALLY AUTHORIZED)

NOTE: IF DEEP TRENCH(ES) ARE USED CALL FOR INSPECTION BEFORE AND AFTER PLACING GRAVEL IN TRENCH(ES)

NOTE: NO DRY WELL SHALL EXCEED 15 FOOT IN DIAMETER NO ABSORPTION TRENCH TO EXCEED 100 FEET IN LENGTH

NOTE: ALL PIPE FROM HOUSE TO SEPTIC TANK MUST BE CAST IRON OR SCHEDULE 35/40 PVC OR ABS

PERMIT VOID AFTER TWO YEARS

NOTE: INSTALL STAND PIPE ON SEPTIC TANK AND DRY WELL STAND PIPES MUST BE 6 INCHES IN DIAMETER CAST IRON. CONCRETE OR TERRA COTTA OR PVA OR ABS ACCEPTED. IF TOP OF SEPTIC TANK IS DEEPER THAN 3 FEET. MANHOLE TO GRADE REQUIRED.

NOTE: DISTRIBUTION BOXES MUST HAVE BAFFLES

***INSTALLER IS RESPONSIBLE FOR OBTAINING FINAL APPROVAL ON THIS PERMIT**

47568

W. F. SCHOOL

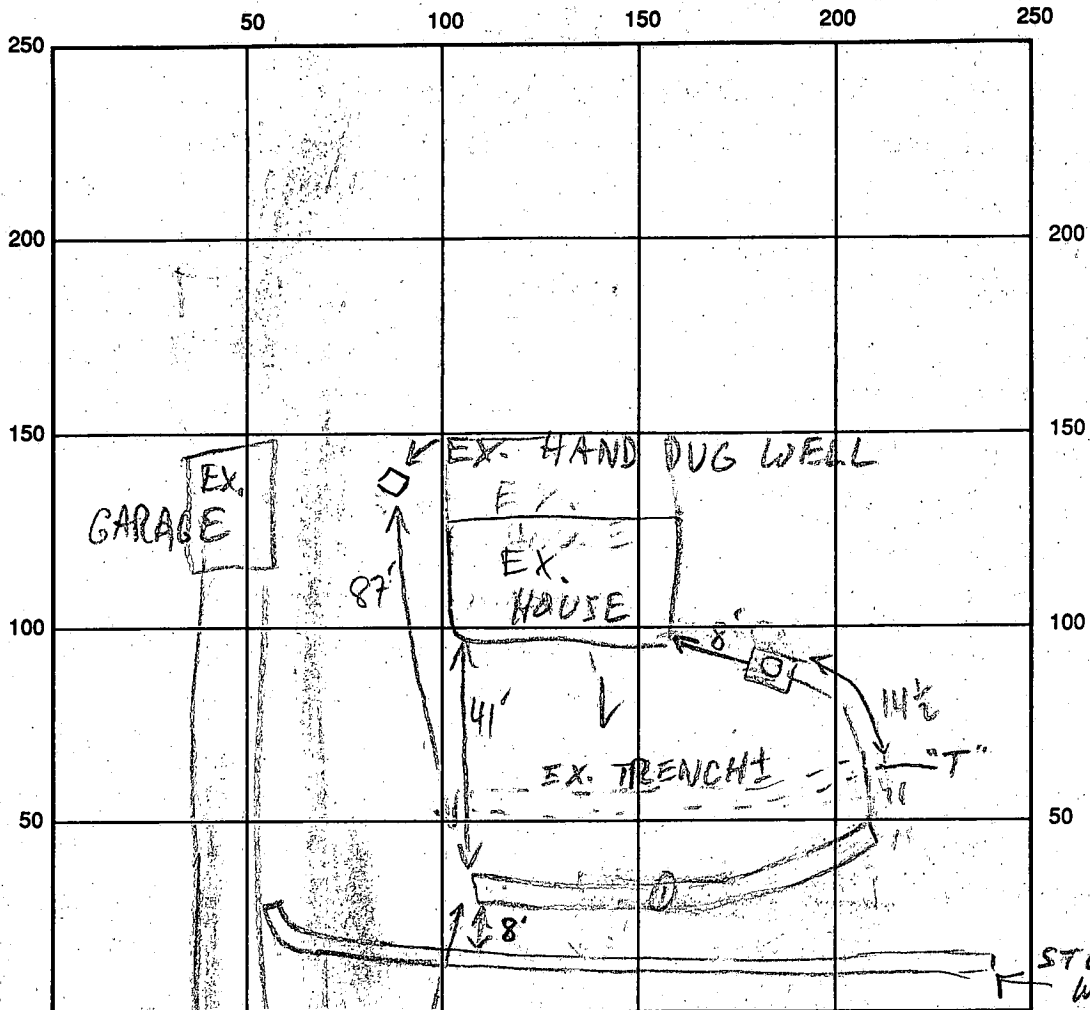

FIRE HOUSE

RT. 144

INDICATE NORTH - NAME ADJOINING ROADWAY AS BASE LINE
175' V TO WELL ACROSS RD.

SEPTIC TANK LEVEL EX. 1000 GAL - OK CLEANOUTS EX. MANHOLE OK

DISTRIBUTION BOX LEVEL —

DRAIN FIELD/TITLE DEPTH 10 FT. TRENCH WIDTH 2 FT. INLET DEPTH 3 FT.

EFFECTIVE GRAVEL DEPTH 7 FT. TOTAL LENGTH 55+ FT.

NUMBER OF TRENCHES 1 ONE SIDEWALL/BOTTOM AREA 380+ SQ. FT.

DRYWALL INSIDE DIAMETER — FT. EFFECTIVE DEPTH BELOW INLET — FT.

ABSORBENT AREA 380+ SQ. FT.

REMARKS: 9/12/91 LINE FROM S.T. TO TRENCHES REPLACED;
TRENCH OK TO COVER MR

DATE SYSTEM APPROVED 9/12/91 INSPECTOR M. Ripkin