

6/27/91
10:00 AM
10/10/91 noon

PERMIT

SEWAGE DISPOSAL SYSTEM

DEPARTMENT OF HEALTH AND MENTAL HYGIENE

INDEXED

HOWARD COUNTY HEALTH DEPARTMENT

BUREAU OF ENVIRONMENTAL HEALTH

461-9933

05-359554

P 47267

A REPAIR

DISTRICT _____

DATE 6/26/91

DATE SYSTEM APPROVED 11/4/91

INSPECTOR RH

Wayde Souder/Wesmar Corporation IS PERMITTED TO INSTALL _____ ALTER X

ADDRESS 13990 Triadelphia Mill Road, Dayton, Maryland PHONE 531-2166

SUBDIVISION _____ LOT _____ ROAD 11915 Hall Shop Road

PROPERTY OWNER Tom and Barbara Evans

ADDRESS 11915 Hall Shop Road
Clarksville, Maryland 21029

SEPTIC TANK CAPACITY 1250 GALLONS

NUMBER OF BEDROOMS 4

180 SQUARE FEET PER BEDROOM

LINEAR FEET OF TRENCH REQUIRED 103

REPAIR - PURPOSE To establish additional capacity sufficient to accommodate proposed addition (Building Permit 36268)

Call for inspection when ground is opened so sanitarian can recommend repair.

TRENCHES OFF OLD DRY WELL 10 FT DEEP INLET 3 FT DEEP

7 FT OF STONE 103 FT LONG RUN TRENCH TOWARD THE RIGHT

SIDE OF THE LOT AS SEEN WHEN FACING THE LOT FROM

HALL SHOP RD. OK TO USE OLD TANK IF IT IS IN

GOOD CONDITION AT LEAST 1250 GALLON

PLANS APPROVED BY Craig Williams DATE 6/25/91

COVER NO WORK UNTIL INSPECTED AND APPROVED

NEITHER THE HOWARD COUNTY COUNCIL NOR THE HEALTH DEPARTMENT IS RESPONSIBLE FOR THE SUCCESSFUL OPERATION OF ANY SYSTEM

NOTE: CLEANOUT REQUIRED EVERY 70 FEET OF SEWER LINE AND/OR AT 90° SWEEPS IN LINES FROM HOUSE TO DRAIN FIELDS, 90° ELBOWS NOT ACCEPTABLE.

NOTE: ALL PARTS OF SEPTIC SYSTEMS (I.E. TANK, DISTRIBUTION BOX TRENCHES) TO BE 100 FEET FROM WELL (UNLESS OTHERWISE SPECIFICALLY AUTHORIZED) 10/7/91 REVISED AT SITE OK TO USE 5 FT

NOTE: IF DEEP TRENCH(ES) ARE USED CALL FOR INSPECTION BEFORE AND AFTER PLACING GRAVEL IN TRENCH(ES) STONE INSTEAD

NOTE: NO DRY WELL SHALL EXCEED 15 FOOT IN DIAMETER NO ABSORPTION TRENCH TO EXCEED 100 FEET IN LENGTH OR 7 FT & MAKE TRENCH 144 FT LONG

NOTE: ALL PIPE FROM HOUSE TO SEPTIC TANK MUST BE CAST IRON OR SCHEDULE 35/40 PVC OR ABS

PERMIT VOID AFTER TWO YEARS

NOTE: INSTALL STAND PIPE ON SEPTIC TANK AND DRY WELL STAND PIPES MUST BE 6 INCHES IN DIAMETER CAST IRON, CONCRETE OR TERRA COTTA OR PVA OR ABS ACCEPTED. IF TOP OF SEPTIC TANK IS DEEPER THAN 3 FEET, MANHOLE TO GRADE REQUIRED.

NOTE: DISTRIBUTION BOXES MUST HAVE BAFFLES

*INSTALLER IS RESPONSIBLE FOR OBTAINING FINAL APPROVAL ON THIS PERMIT

BLDG. PERM. 36268
AND RETURNED 7/5/91
Seval 3/26/91
Additional - see building permit

P47267

REPAIR PERC

APPLICATION

PERCOLATION TESTING

A _____
P 47269

HOWARD COUNTY HEALTH DEPARTMENT
BUREAU OF ENVIRONMENTAL HEALTH
P.O. BOX 476 ELLICOTT CITY, MARYLAND 21043
TELEPHONE: 461-9933

DISTRICT _____

DATE _____

TO: THE COUNTY HEALTH OFFICER
ELLICOTT CITY, MARYLAND

I HEREBY APPLY FOR THE NECESSARY TEST IN ORDER TO CONSTRUCT (OR RECONSTRUCT) A SEWAGE DISPOSAL SYSTEM.

PROPERTY OWNER Tom & Barbara Evans

ADDRESS 11915 Holl Shopp Rd PHONE 531 2166

PROSPECTIVE BUYER _____

ADDRESS _____ PHONE _____

PROPERTY LOCATION:

SUBDIVISION _____ LOT NO. _____

ROAD AND DESCRIPTION _____

TAX MAP _____ PARCEL # _____

SIZE OF LOT _____ TYPE BLDG _____
(SINGLE FAMILY DWELLING OR COMMERCIAL)

THE SYSTEM INSTALLED UNDER THIS APPLICATION IS ACCEPTABLE ONLY UNTIL PUBLIC FACILITIES BECOME AVAILABLE. I FULLY UNDERSTAND THE FEE CONNECTED WITH THE FILING OF THIS PERC TEST APPLICATION IS NON-REFUNDABLE UNDER ANY CIRCUMSTANCES. I ALSO AGREE TO COMPLY WITH ALL M.O.S.H.A. REQUIREMENTS IN TESTING THIS LOT.

(SIGNATURE OF APPLICANT)

APPROVED BY _____ FOR _____ DATE _____

REJECTED BY _____ FOR _____ DATE _____

HOLD PENDING FURTHER TESTS _____ DATE _____

REASONS FOR REJECTION OR HOLDING 6/1/91 Perc OK for Repair Job

HD-216

THIS IS NOT A PERMIT

8/16/79
around noon phase

8/16/79
Approved RH
P 30070

PERMIT

SEWAGE DISPOSAL SYSTEM

MARYLAND STATE DEPARTMENT OF HEALTH*

P 30070
A Repair

HOWARD COUNTY

ELLICOTT CITY

DISTRICT 5th

INDEXED

DATE 8/7/79

Jack Fyock IS PERMITTED TO INSTALL ALTER X

ADDRESS 13775 Triadelphia Road, Glenelg, Md. PHONE 988-9270

SUBDIVISION _____ ROAD Hall Shop Road LOT _____

PROPERTY OWNER Mr. McCracken 4 Paul Conley on lot G

ADDRESS 1915 Hall Shop Road, Fulton, Md. Phone: 531-5992

SPECIFICATIONS near Pt 32

SEPTIC TANK CAPACITY _____ GALLONS

DRAIN FIELD _____ DEPTH _____ FEET. BOTTOM AREA _____ SQ. FT.

DEEP TRENCH _____ DEPTH _____ FEET. BOTTOM AREA _____ SQ. FT.

SEEPAGE PITS _____ ABSORBENT SIDE-WALL AREA _____ SQ. FT.

INLET PIPE _____ FT. BELOW ORIGINAL GRADE. MAXIMUM DEPTH _____ FT. BELOW ORIGINAL GRADE

EFFECTIVE DEPTH AT _____ FT. BELOW ORIGINAL GRADE.

LOCATE DISPOSAL AREA _____ FT. FROM _____ LOT LINE AND _____ FT. FROM _____ LOT LINE AS SEEN WHEN FACING LOT FROM

REPAIR - Call for an appointment when ground is opened up and Sanitarian will recommend the repair system.

PLANS APPROVED BY Palmer F. Wine DATE 8/7/79

COVER NO WORK UNTIL INSPECTED AND APPROVED.

NEITHER THE HOWARD COUNTY COUNCIL NOR THE HEALTH DEPARTMENT IS RESPONSIBLE FOR THE SUCCESSFUL OPERATION OF ANY SYSTEM.

NOTE: IF TRENCH IS USED CALL FOR INSPECTION BEFORE PLACING GRAVEL IN TRENCH.

NOTE: NO DRY WELL SHALL EXCEED 15 FOOT IN DIAMETER.

NOTE: ALL PIPE FROM HOUSE TO DISPOSAL AREA MUST BE CAST IRON.

PERMIT VOID AFTER THREE YEARS.

NOTE: INSTALL STAND PIPE ON SEPTIC TANK AND DRY WELL. STAND PIPES MUST BE 6 INCHES IN DIAMETER. CAST IRON, CONCRETE OR TERRAZO ACCEPTED.

*INSTALLER IS RESPONSIBLE FOR OBTAINING FINAL APPROVAL ON THIS PERMIT.

P 30070

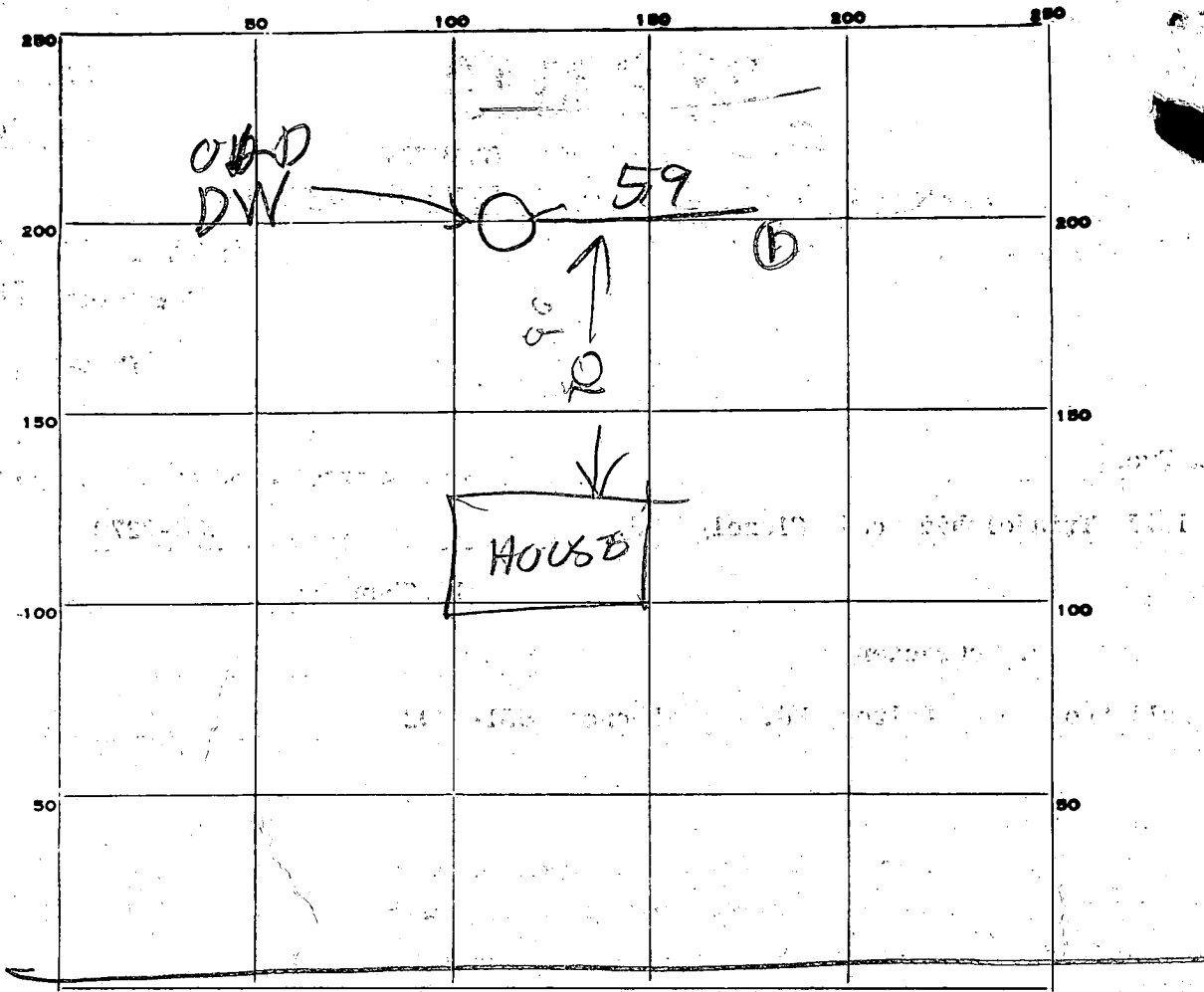

PERMIT CARD _____

SEPTIC TANK, LEVEL _____

CLEANOUTS _____

DISTRIBUTION BOX, LEVEL _____

TILE FIELD, DEPTH 11 FT. TRENCH WIDTH 2 FT.

GRAVEL DEPTH 2 1/2 IN. TOTAL LENGTH 59 FT.

NUMBER OF TRENCHES 1 TOTAL BOTTOM AREA 501

SEEPAGE PITS, INSIDE DIAMETER _____ FT. DEPTH BELOW INLET _____ FT.

ABSORBENT AREA _____ SQ. FT.

REMARKS

8/16/79 WELL IN FRONT OF HOUSE
 VISUAL HOLE ① TOP 3 FT CLAY
 BOT ② SAND & DRY
 SEE ATTACHED LETTER FROM
 OWNER

DATE SYSTEM APPROVED

8/16/79

INSPECTOR

Raymond Hodge

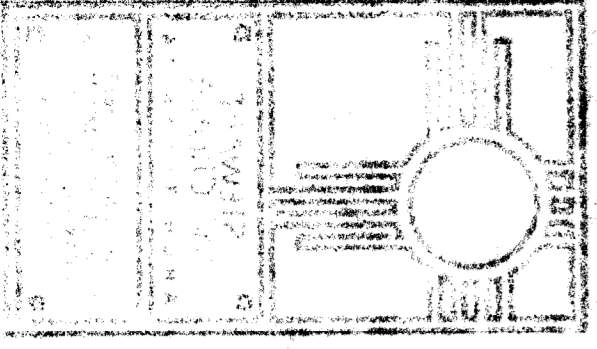

RECEIVED
HOWARD COUNTY
HEALTH DEPT.
91 JAN -4 PM 3:23

JUNE 27 10:00

WAYDE SUDDER INSTALLED

REPAIR
TO ESTABLISH ADDITIONAL CAPACITY
SUFFICIENT TO ACCOMMODATE
PROPOSED ADDITION
(BP 36268)

Note: This will be utilized as a SFD
with only one cooking facility.

Glenn III
Builder/Owner Agent

Current Bedrooms: 2

Bedrooms w/ Addition: 4

REPAIR TRENCH ADDED 1979
CONDITION OF SEPTIC TANK
AND ORIGINAL SYSTEM
NOT KNOWN.
NO PERCOLATION RECORDS ON
FILE.

2-3 HOLE PERCOLATION TEST
SUFFICIENT TO ESTABLISH
APPROXIMATELY 10,000 SQ FT
& FULL REPLACEMENT SEPTIC
SYSTEM TO BE INSTALLED.
EXISTING TANK CAN BE UTILIZED
ONLY IF EXCAVATED BY CONTRACTOR
& SHOWN TO BE SOUND CONDITION & SIZE.
6/25/91 CWL