

PERMIT

SEWAGE DISPOSAL SYSTEM

DEPARTMENT OF HEALTH AND MENTAL HYGIENE

P 4/2/91
A REPAIR

DISTRICT _____

DATE 5/20/91

HOWARD COUNTY HEALTH DEPARTMENT
BUREAU OF ENVIRONMENTAL HEALTH
461-9933

234971
INDEXED

DATE SYSTEM APPROVED 3/20/91

INSPECTOR M. R. F. KIN

Jack Fyock Septic Service

IS PERMITTED TO INSTALL

ALTER

ADDRESS 13775 Triadelphia Road, Glenelg, Maryland 21737 PHONE 988-9270

SUBDIVISION _____ LOT _____ ROAD 9385 Route 99

PROPERTY OWNER O'Leary

ADDRESS 9385 Route 99, Ellicott City, Maryland 21043

SEPTIC TANK CAPACITY _____ GALLONS

NUMBER OF BEDROOMS 3

125 SQUARE FEET PER BEDROOM

LINEAR FEET OF TRENCH REQUIRED 47

REPAIR - TO ADD TRENCH, DUE TO FULL DRYWELL. CALL FOR INSPECTION WHEN GROUND IS OPENED SO SANITARIAN CAN RECOMMEND REPAIR.

INLET 2' BOT 11' 8" STONE

PLANS APPROVED BY Craig Williams cm DATE 03/19/91

COVER NO WORK UNTIL INSPECTED AND APPROVED

NEITHER THE HOWARD COUNTY COUNCIL NOR THE HEALTH DEPARTMENT IS RESPONSIBLE FOR THE SUCCESSFUL OPERATION OF ANY SYSTEM

NOTE: CLEANOUT REQUIRED EVERY 70 FEET OF SEWER LINE AND/OR AT 90° SWEEPS IN LINES FROM HOUSE TO DRAIN FIELDS, 90° ELBOWS NOT ACCEPTABLE.

NOTE: ALL PARTS OF SEPTIC SYSTEMS (I.E. TANK, DISTRIBUTION BOX TRENCHES) TO BE 100 FEET FROM WELL (UNLESS OTHERWISE SPECIFICALLY AUTHORIZED)

NOTE: IF DEEP TRENCH(ES) ARE USED CALL FOR INSPECTION BEFORE AND AFTER PLACING GRAVEL IN TRENCH(ES)

NOTE: NO DRY WELL SHALL EXCEED 15 FOOT IN DIAMETER NO ABSORPTION TRENCH TO EXCEED 100 FEET IN LENGTH

NOTE: ALL PIPE FROM HOUSE TO SEPTIC TANK MUST BE CAST IRON OR SCHEDULE 35/40 PVC OR ABS

PERMIT VOID AFTER TWO YEARS

NOTE: INSTALL STAND PIPE ON SEPTIC TANK AND DRY WELL STAND PIPES MUST BE 6 INCHES IN DIAMETER CAST IRON, CONCRETE OR TERRA COTTA OR PVA OR ABS ACCEPTED. IF TOP OF SEPTIC TANK IS DEEPER THAN 3 FEET. MANHOLE TO GRADE REQUIRED.

NOTE: DISTRIBUTION BOXES MUST HAVE BAFFLES

***INSTALLER IS RESPONSIBLE FOR OBTAINING FINAL APPROVAL ON THIS PERMIT**

P
47122

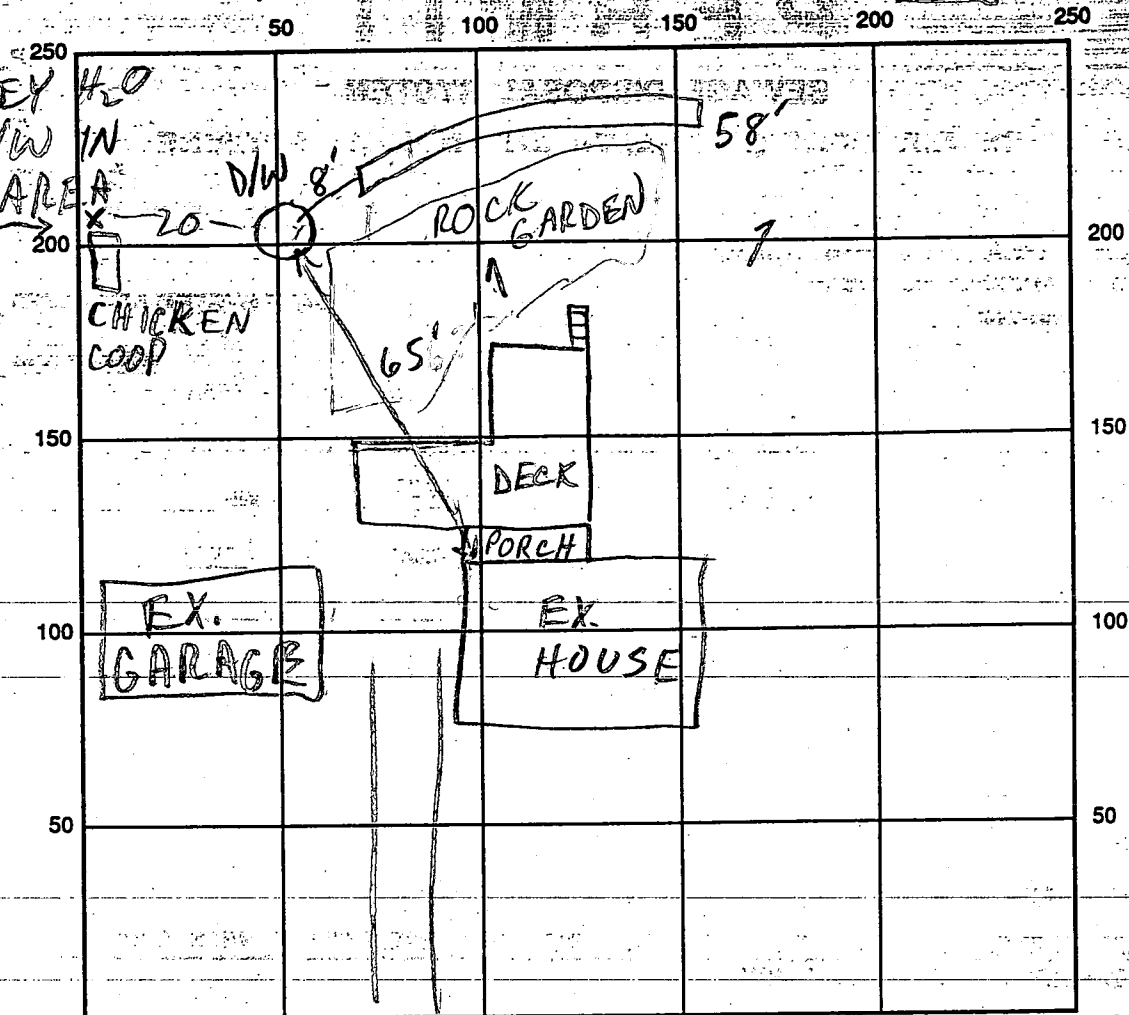

SULLAND CIR

Rt. 99 (OLD FRED. RD) INDICATE NORTH - NAME ADJOINING ROADWAY AS BASE LINE

SEPTIC TANK LEVEL UNKNOWN CLEANOUTS OK

DISTRIBUTION BOX LEVEL

DRAIN FIELD/TITLE DEPTH 11 FT. TRENCH WIDTH 2 FT. INLET DEPTH 3 FT.

EFFECTIVE GRAVEL DEPTH 8 FT. TOTAL LENGTH 58 FT.

NUMBER OF TRENCHES 1 ONE SIDEWALL/BOTTOM AREA 464 SQ. FT.

DRYWALL INSIDE DIAMETER FT. EFFECTIVE DEPTH BELOW INLET FT.

ABSORBENT AREA SQ. FT.

REMARKS: 3/20/91 S.T. LOC. UNKNOWN; SEPARATE D/W FOR GREY WATER; PUB H2O CONNECTED; OK TO FINISH & COVER w/CLEANOUT ON D/W

DATE SYSTEM APPROVED 2/20/91 INSPECTOR M. Ripkin