

12/12/90  
5:00 P.M. / JANE NAGLE  
NAGLE

05-357241

File

12/12/90  
① P.C.O.

# PERMIT

SEWAGE DISPOSAL SYSTEM

MARYLAND STATE DEPARTMENT OF HEALTH

P 46894  
A Repair

**HOWARD COUNTY**  
BUREAU OF ENVIRONMENTAL HEALTH  
461-9933

DISTRICT \_\_\_\_\_  
DATE 3/7/91

DATE SYSTEM APPROVED 12/12/90

INSPECTOR C.B.D.

INDEXED

Jack Fyock

IS PERMITTED TO INSTALL \_\_\_\_\_ ALTER \_\_\_\_\_

ADDRESS \_\_\_\_\_ PHONE \_\_\_\_\_

SUBDIVISION \_\_\_\_\_ ROAD \_\_\_\_\_ LOT \_\_\_\_\_

PROPERTY OWNER Mr. Blye

ADDRESS 13649 Highland Road

IF GARBAGE GRINDER IS USED INCREASE SEPTIC TANK CAPACITY BY 50% AND ABSORPTION AREA BY 22%.

GARBAGE GRINDER? YES  NO

SEPTIC TANK CAPACITY \_\_\_\_\_ GALLONS NUMBER OF BEDROOMS \_\_\_\_\_

TO REPAIR SEPTIC SYSTEM FAILURE. SANITARIAN TO RECOMMEND REPAIR. JEN 12-12-90 -> 12/12/90 trench already partially dug + being stoned - see book; C.B.D.  
12/12/90 Trench to be 60'+ long; inlet 2 1/2" x 2' wide  
1/2" of stone below pipe (below 0.6 rods) (520 sq ft + in trench)  
Run trench on contour - C.B.D. 12/12/90

PLANS APPROVED BY C. Williams DATE 12/12/90

COVER NO WORK UNTIL INSPECTED AND APPROVED

NEITHER THE HOWARD COUNTY COUNCIL NOR THE HEALTH DEPARTMENT IS RESPONSIBLE FOR THE SUCCESSFUL OPERATION OF ANY SYSTEM

- NOTE: CLEANOUT REQUIRED EVERY 70 FEET OF SEWER LINE AND/OR AT 90° SWEEPS IN LINES FROM HOUSE TO DRAIN FIELDS
- NOTE: ALL PARTS OF SEPTIC SYSTEMS (I.E. TANK, DISTRIBUTION BOX, TRENCHES) TO BE 100 FEET FROM WELL (UNLESS OTHERWISE SPECIFICALLY AUTHORIZED)
- NOTE: IF DEEP TRENCHES ARE USED CALL FOR INSPECTION BEFORE AND AFTER PLACING GRAVEL IN TRENCHES)
- NOTE: NO DRY WELL SHALL EXCEED 15 FOOT IN DIAMETER NO ABSORPTION TRENCH TO EXCEED 100 FEET IN LENGTH.
- NOTE: ALL PIPE FROM HOUSE TO SEPTIC TANK MUST BE CAST IRON OR SCHEDULE 40 PVC OR ABS
- PERMIT VOID AFTER TWO YEARS
- NOTE: INSTALL STAND PIPE ON SEPTIC TANK AND DRY WELL. STAND PIPES MUST BE 6 INCHES IN DIAMETER. CAST IRON, CONCRETE OR TERRA COTTA OR PVC OR ABS ACCEPTED. IF TOP OF SEPTIC TANK IS DEEPER THAN 3 FEET, MANHOLE TO GRADE REQUIRED
- NOTE: DISTRIBUTION BOXES MUST HAVE BAFFLES

**\*INSTALLER IS RESPONSIBLE FOR OBTAINING FINAL APROVAL ON THIS PERMIT**

\*CALL 461-9933 FOR INSPECTION OF SEPTIC SYSTEMS.

46894

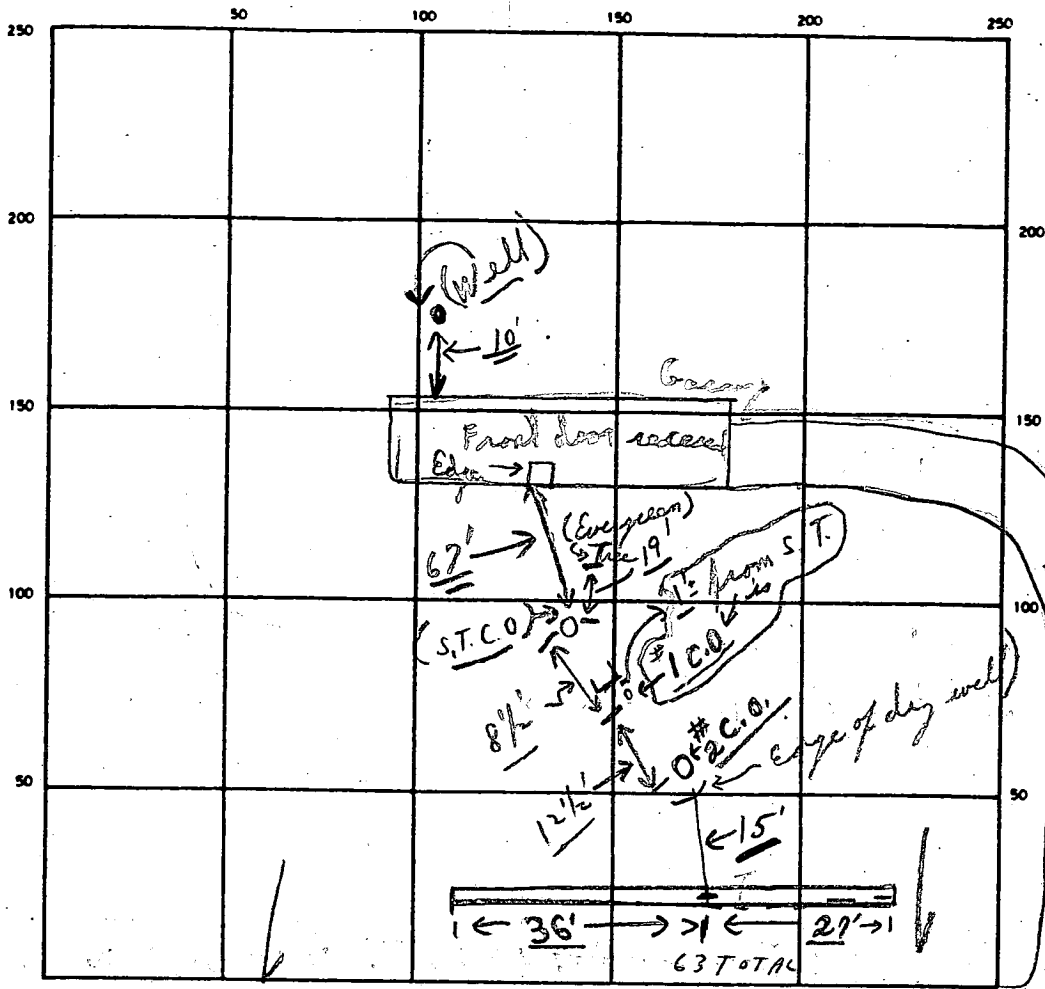

INDICATE NORTH — NAME ADJOINING ROADWAY AS BASE LINE

← Highland ←

PT # 216

	S.T.	C.O.1	C.O.2
SEPTIC TANK. LEVEL <u>Existing</u>	OK	OK	OK
DISTRIBUTION BOX. LEVEL <u>(Using old dry well) Existing</u>			
DRAIN FIELD/TILE FIELD. DEPTH <u>10</u> FT. TRENCH WIDTH <u>2</u> FT. INLET DEPTH <u>2 1/2</u> FT.			
EFFECTIVE GRAVEL DEPTH <u>7 1/2 average</u> FT. TOTAL LENGTH <u>63'</u> FT.			
NUMBER OF TRENCHES <u>1</u> ONE SIDEWALL/BOTTOM AREA <u>472</u> <sup>+</sup> (OLD DRY WELL) SQ. FT.			
DRYWELL INSIDE DIAMETER <u>    </u> FT. EFFECTIVE DEPTH BELOW INLET <u>    </u> FT.			
ABSORBENT AREA <u>472</u> <sup>+</sup> (OLD DRY WELL) = <u>520</u> <sup>+</sup> sq. ft. SQ. FT.			

12/12/90  
 REMARKS PARTIAL repair in progress; 1 trench 1/2 dug; 2' wide; 10' average deep; partially stoned, ok to continue;  
 ② FINAL - OK TO COVER AS FINISH.

DATE SYSTEM APPROVED 12/12/90 INSPECTOR Charles, Bryan, Steakes