

# PERMIT

SEWAGE DISPOSAL SYSTEM

MARYLAND STATE DEPARTMENT OF HEALTH DISTRICT 5th

HOWARD COUNTY

BUREAU OF ENVIRONMENTAL HEALTH  
461-9933

P 44676  
A REPAIR

DATE 12/10/90

DATE SYSTEM APPROVED 11/2/90

INSPECTOR RH

## INDEXED

Jack Fyock

IS PERMITTED TO INSTALL \_\_\_\_\_ ALTER X

ADDRESS \_\_\_\_\_ PHONE 988-9270

SUBDIVISION \_\_\_\_\_ ROAD 5186 Green Bridge Rd LOT Tax Map 29

PROPERTY OWNER \_\_\_\_\_ Daniel Bloom Parcel 90

ADDRESS 5186 ~~5181~~ Green Bridge Road Grid 13

IF GARBAGE GRINDER IS USED INCREASE SEPTIC TANK CAPACITY BY 50% AND ABSORPTION AREA BY 22%.

GARBAGE GRINDER? YES \_\_\_\_\_ NO \_\_\_\_\_

SEPTIC TANK CAPACITY 1000 GALLONS NUMBER OF BEDROOMS 3

REPAIR - PURPOSE - TO REPLACE FAILING DRYWELL.

CALL FOR INSPECTION WHEN GROUND IS OPENED SO SANITARIAN CAN RECOMMEND REPAIR.

11/2/90 - TRENCH OFF OLD DRY WELL  
375 SQ FT ABSORBENT AREA, INLET  
3 FT BOTTOM 10 FT 7 FT STONE  
54 FT LONG 2 FT WIDE

PLANS APPROVED BY C. Williams DATE 10/02/90

COVER NO WORK UNTIL INSPECTED AND APPROVED

NEITHER THE HOWARD COUNTY COUNCIL NOR THE HEALTH DEPARTMENT IS RESPONSIBLE FOR THE SUCCESSFUL OPERATION OF ANY SYSTEM

NOTE: CLEANOUT REQUIRED EVERY 70 FEET OF SEWER LINE AND/OR AT 90° SWEEPS IN LINES FROM HOUSE TO DRAIN FIELDS

NOTE: ALL PARTS OF SEPTIC SYSTEMS (I.E. TANK, DISTRIBUTION BOX, TRENCHES) TO BE 100 FEET FROM WELL (UNLESS OTHERWISE SPECIFICALLY AUTHORIZED)

NOTE: IF DEEP TRENCHES ARE USED CALL FOR INSPECTION BEFORE AND AFTER PLACING GRAVEL IN TRENCHES

NOTE: NO DRY WELL SHALL EXCEED 15 FOOT IN DIAMETER NO ABSORPTION TRENCH TO EXCEED 100 FEET IN LENGTH.

NOTE: ALL PIPE FROM HOUSE TO SEPTIC TANK MUST BE CAST IRON OR SCHEDULE 40 PVC OR ABS

PERMIT VOID AFTER TWO YEARS

NOTE: INSTALL STAND PIPE ON SEPTIC TANK AND DRY WELL STAND PIPES MUST BE 6 INCHES IN DIAMETER. CAST IRON, CONCRETE OR TERRA COTTA OR PVC OR ABS ACCEPTED. IF TOP OF SEPTIC TANK IS DEEPER THAN 3 FEET, MANHOLE TO GRADE REQUIRED

NOTE: DISTRIBUTION BOXES MUST HAVE BAFFLES

**\*INSTALLER IS RESPONSIBLE FOR OBTAINING FINAL APPROVAL ON THIS PERMIT**

\*CALL 461-9933 FOR INSPECTION OF SEPTIC SYSTEMS.

P 44676

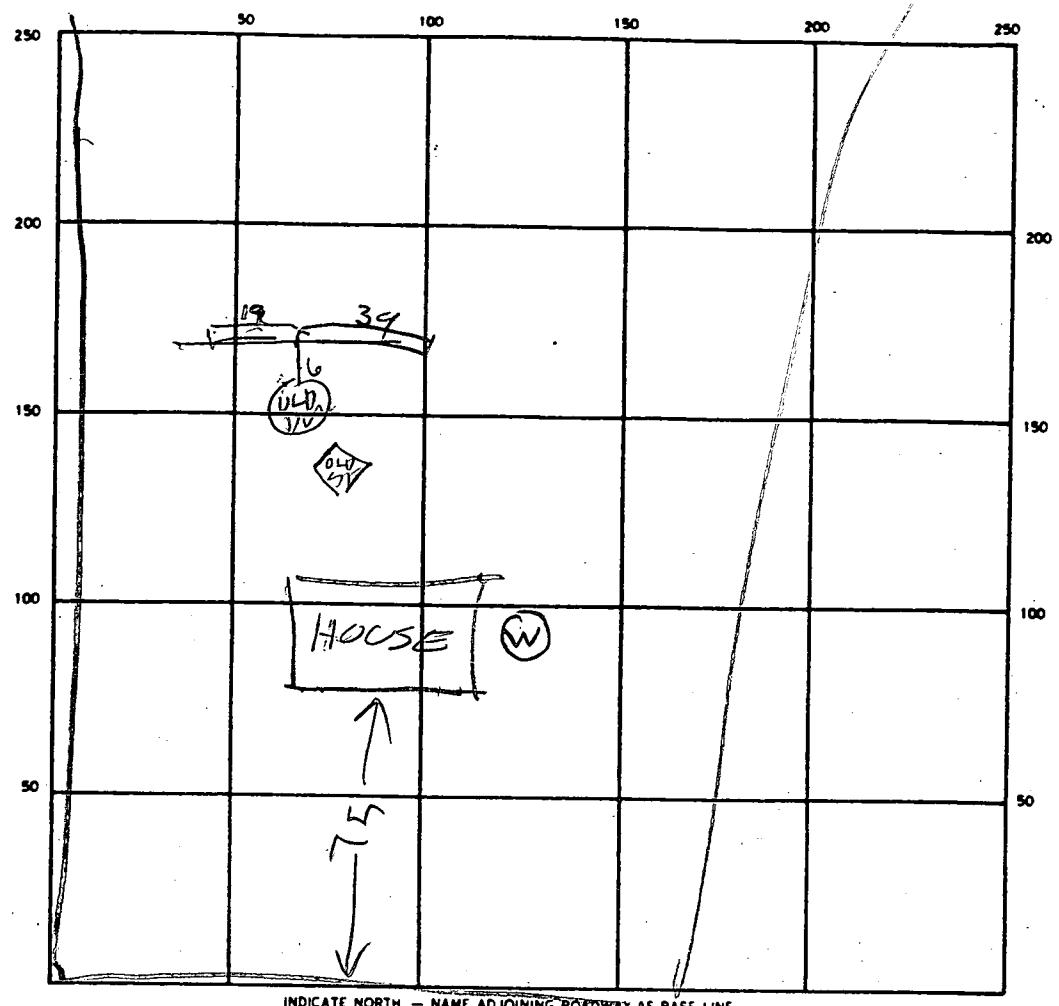
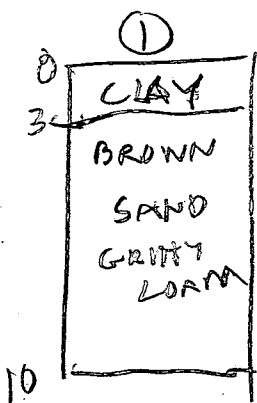

INDICATE NORTH — NAME ADJOINING ROADWAY AS BASE LINE

SEPTIC TANK. LEVEL \_\_\_\_\_ CLEANOUTS \_\_\_\_\_

DISTRIBUTION BOX. LEVEL \_\_\_\_\_

DRAIN FIELD/TILE FIELD. DEPTH 10 FT. TRENCH WIDTH 2 FT. INLET DEPTH 3 FT.

EFFECTIVE GRAVEL DEPTH 7 FT. TOTAL LENGTH 58 FT.

NUMBER OF TRENCHES 1 ONE SIDEWALL/BOTTOM AREA 406 SQ. FT.

DRYWELL INSIDE DIAMETER \_\_\_\_\_ FT. EFFECTIVE DEPTH BELOW INLET \_\_\_\_\_ FT.

ABSORBENT AREA \_\_\_\_\_ SQ. FT.

REMARKS 11/2/90 - TRENCH OK

DATE SYSTEM APPROVED 11/2/90 INSPECTOR Raymond Hodges