

①
Test hole
water at
10.5 ft
5-9-90

5-9-90
Well cap
cracked, flush
w/ ground, open
to contamination
JEN

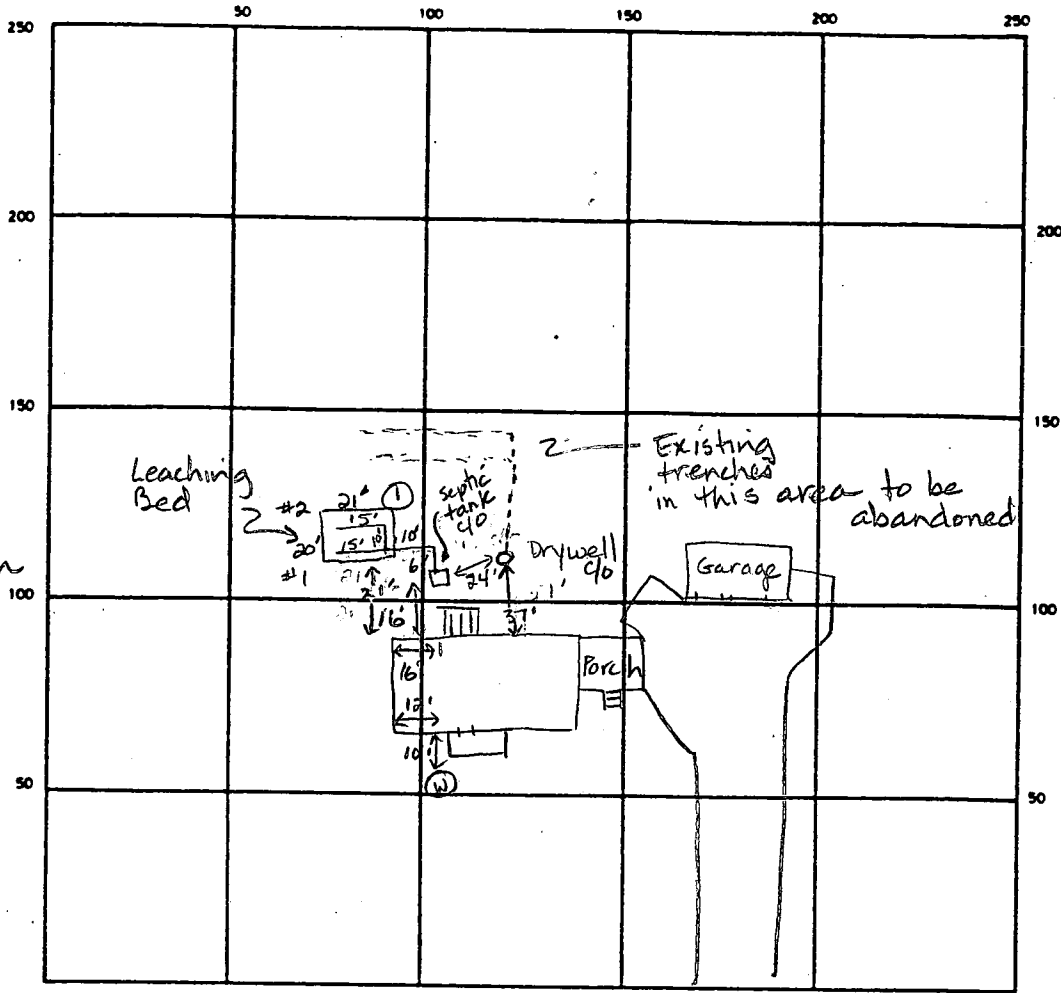

INDICATE NORTH — NAME ADJOINING ROADWAY AS BASE LINE
Route 108

SEPTIC TANK LEVEL Existing CLEANOUTS 1 on septic tank, 1 on drywell

DISTRIBUTION BOX LEVEL N/A

Leaching Bed ① ② Bed
DRAIN-FIELD/TILE-FIELD DEPTH 6.5 4.5 FT. TRENCH WIDTH 20 x 21 FT. INLET DEPTH 2.5 FT.

EFFECTIVE GRAVEL DEPTH ① ② FT. Bed
TOTAL LENGTH 21 FT.

NUMBER OF TRENCHES — ONE SIDEWALL BOTTOM AREA 420 SQ. FT.

Existing
DRYWELL INSIDE DIAMETER To be abandoned FT. EFFECTIVE DEPTH BELOW INLET — FT.

ABSORBENT AREA 420 SQ. FT.

REMARKS 5-9-90 Leaching bed 6.5 ft deep at upper end, 4.5 ft deep at lower end. Existing drywell to be abandoned with leaching bed connected to existing septic tank. JEN 6-29-90 Contractor indicated depth to inlet is 2.5 ft from original grade and drywell had been abandoned. JEN

DATE SYSTEM APPROVED 6-29-90 INSPECTOR Jane E. Nadeau

LANGENFELDER
12640 RT. 108
CLARKSVILLE

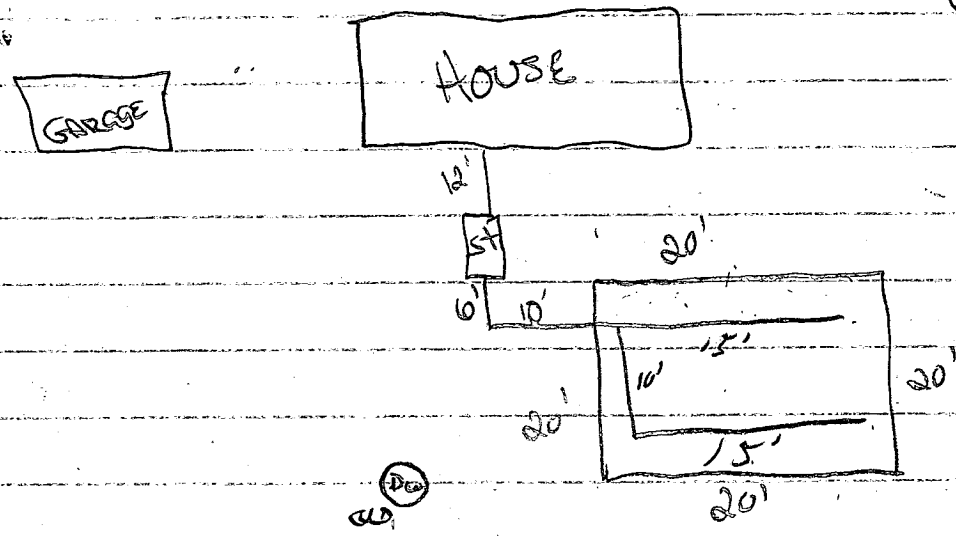

Jack C. Fyock

6/29/90

Rich Leshem

Depth to Inlet $2\frac{1}{2}$, to $5-5\frac{1}{2}$



HOWARD COUNTY HEALTH DEPARTMENT

Joyce M. Boyd, M.D., County Health Officer

July 5, 1990

Reply to:

Mr. Charles Langerfelder, Jr.
12640 Route 108
Clarksville, Maryland 21029

Dear Mr. Langenfelder:

During the course of the recent septic repair inspection (repair approved, copy of inspection report enclosed), a well construction defect was observed.

The well casing was observed to be flush with grade and the cap was cracked, leaving the well vulnerable to contamination from surface run-off. Maryland Well Construction Regulation (COMAR 26.04.04.10) specifies that "the well owner is responsible for maintaining the upper terminal at the proper height (not less than 8" above grade) ... and in a condition to conserve and protect the groundwater".

In order to protect your water supply from the threat of contamination and to comply with this regulation, the well casing should be extended to proper height and a secure cap should be placed atop the casing.

This work should be performed by a licensed well driller or plumber and this office (461-9933) should be notified to inspect the work.

Thank you for your cooperation in this matter. If you have any questions relative to this matter, please call me.

Very truly yours,

Craig Williams, Director
Water and Sewerage Program

CW:jr

Enclosure

DULEY & ASSOC.

NOTE:
POSSIBLE
ENCROACHMENTS
MAY EXIST

N 29°08'00" E
150.00

LIBER 4106 FOLIO 605
29906(S)

CONC.
AREA

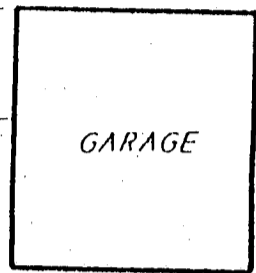

GARAGE



Septic

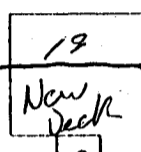

19
New Deck



12
B/E

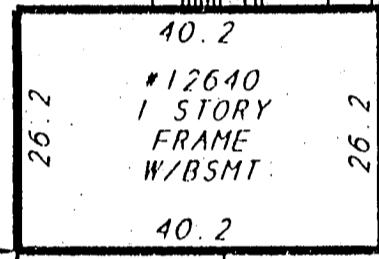

40.2
#12640
1 STORY
FRAME
W/BSMT

26.2

26.2

Existing
DECK
To be
New
Deck

PORCH

49'

D/W

Well

S 65°25'00" E
200.00

7/12/01- proposed
improvements
on SRM

94'

S 29°08'00" W
150.00

CLARKSVILLE PIKE

SURVEY OF:

40 CLARKSVILLE PIKE
N/F THE PROPERTY OF

A LAND SURVEYING AND DESIGN COMPANY



DULEY
AND

