

PERMIT

SEWAGE DISPOSAL SYSTEM

P 10776

A 07404

MARYLAND STATE DEPARTMENT OF HEALTH

HOWARD COUNTY

Incomplete 8/26/65 P.F. ELLICOTT CITY

DISTRICT 6

INDEXED

DATE 8/19/65

*8/30/65
8/26/65
Ready now
9/1/65
9/20/65*

A. G. County Dry Well Co. (Wiley Holston)
Jones, Robinson

IS PERMITTED TO INSTALL ALTER

ADDRESS Lark Brown Rd., Ellicott City, Md. PHONE 805-2200

A SEWAGE DISPOSAL SYSTEM LOCATED AT _____

SUBDIVISION Carroll Heights ROAD Gullford Rd. LOT 5

PROPERTY OWNER Willie Verren

ADDRESS _____

SPECIFICATIONS - 3 bedrooms

DRAIN FIELD _____ DEPTH _____ FEET, BOTTOM AREA _____ SQ. FT.

SEEPAGE PITS _____ ABSORBENT SIDE-WALL AREA _____ SQ. FT.

SEPTIC TANK CAPACITY 750 GALLONS

FOR GARBAGE GRINDER, INCREASE DISPOSAL AREA 22% & TANK CAPACITY 50%.

OTHER One dry well - 12 ft. in diameter and 8 ft. deep below inlets. Do not install dry wells deeper than 11 ft. below original grade. Place one dry well in area of test No. 6 about 30 ft. from the right side of the lot and about 20 ft. from the front lot line. Place the other dry well about 70 ft. from the right side of the lot and 20 ft. from the front lot line. That is the right side of the lot as seen when facing the lot from Carroll Rd.

PLANS APPROVED BY Raymond Hodges DATE 9/10/65

FILL SEPTIC TANK AND DISTRIBUTION BOX WITH WATER BEFORE CALLING FOR AN INSPECTION. COVER NO WORK UNTIL INSPECTED AND APPROVED.

NEITHER THE HOWARD COUNTY COMMISSIONERS NOR THE HEALTH DEPARTMENT IS RESPONSIBLE FOR THE SUCCESSFUL OPERATION OF ANY SYSTEM.

A 07404

Dry Well #1
 Diameter of top is 5 FT
 Depth below top is 7 ft
 No inlet or gravel seen
 Inlet is 1 ft below grade
 Depth below inlet is 6 ft
 Diameter of outside wall is 7 ft
 Dry Well #2
 Diameter of top is 5 FT
 Depth below top is 7 ft
 No inlet or gravel seen
 Depth below inlet is 8 ft
 Inlet is 2 ft below grade
 Diameter of outside wall is 7 ft
 $2.5 \times 7 \times 3.1 = 197.25 \text{ sq ft}$
 PERMIT CARD _____

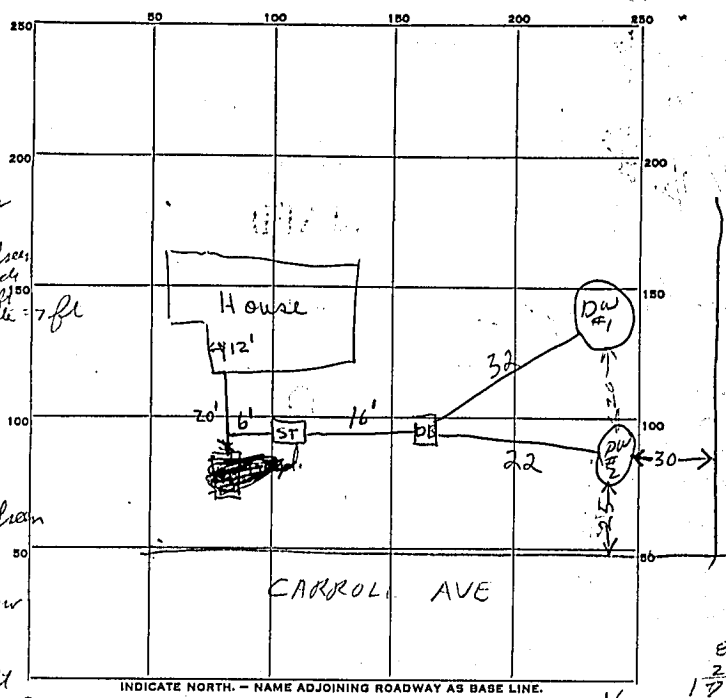

INDICATE NORTH. - NAME ADJOINING ROADWAY AS BASE LINE.

25 72 sq ft
 21
 170
 16
 85
 170
 30
 135.0
 1070

SEPTIC TANK, LEVEL 015 750 steel CLEANOUTS OK
 Top is 2 1/2 FT below grade
 DISTRIBUTION BOX, LEVEL 015 2720

TILE FIELD, DEPTH _____ FT. TRENCH WIDTH _____ FT. 187

GRAVEL DEPTH _____ IN. TOTAL LENGTH _____ FT. 187

NUMBER OF TRENCHES _____ TOTAL BOTTOM AREA _____ 374

SEEPAGE PITS, INSIDE DIAMETER _____ FT., DEPTH BELOW INLET _____ FT.
 306 sq ft Required 2.72 not covering stone
 ABSORBENT AREA 3.74 SQ. FT. ditch wall to ditch wall counting stone

REMARKS 8/26/65 - Dry Wells covered - M must be
uncovered for inspection - RF.

8/30/65 The dry wells are still covered OK to cover
tank & sewer lines

7 SEPT 65 - Dry Wells are still covered RF

14 SEPT 65 - Dry Wells not uncovered enough. Cannot see inlet or stone
around Dry Wells RF

DATE SYSTEM APPROVED 20 SEPT 65 INSPECTOR Raymond Hodge