

NOON 3/2/90

Tax ID - 02-22683

PERMIT

P 45097

SEWAGE DISPOSAL SYSTEM

A REPAIR

MARYLAND STATE DEPARTMENT OF HEALTH DISTRICT

HOWARD COUNTY
BUREAU OF ENVIRONMENTAL HEALTH
461-9933

INDEXED

DATE 2/28/91

DATE SYSTEM APPROVED 3/8/90

INSPECTOR Mark Rifkin

Olen Ketterman

IS PERMITTED TO INSTALL _____ ALTER X

ADDRESS 14960 Route 144, Woodbine, Maryland 21797 PHONE 442-1336

SUBDIVISION Kefauver Property ROAD 8507 Old Frederick Rd LOT 4 - Existing House

PROPERTY OWNER Emerson Kefauver John Wellham

ADDRESS _____

~~IF GARBAGE GRINDER IS USED INCREASE SEPTIC TANK CAPACITY BY 50% AND ABSORPTION AREA BY 22%.~~

GARBAGE GRINDER YES ~~XXXXXXXXXXXXNOXXXXXXXX~~

SEPTIC TANK CAPACITY 1500 GALLONS NUMBER OF BEDROOMS 5

TRENCHES - 180 sq. ft. per bedroom. Trench to be 3 feet wide. Inlet 4 feet below original grade. Bottom maximum depth 6 feet below original grade. Effective area begins at 4 feet below original grade. 2 feet of stone below distribution pipe.

LOCATION - Starting from front right lot corner, place distribution box 300 feet down right lot line and 100 feet off this same lot line. Run trenches on contour toward front of lot. MAINTAIN 20 FEET FROM HOUSE.

NOTE - No trench to exceed 100 feet in length. Provide 6" - 8" diameter cleanout and cap to grade or above on septic tank. 2-28-90 JEN

PLANS APPROVED BY Mark Rifkin DATE 1/18/90

COVER NO WORK UNTIL INSPECTED AND APPROVED

NEITHER THE HOWARD COUNTY COUNCIL NOR THE HEALTH DEPARTMENT IS RESPONSIBLE FOR THE SUCCESSFUL OPERATION OF ANY SYSTEM.

NOTE: CLEANOUT REQUIRED EVERY 70 FEET OF SEWER LINE AND/OR AT 90° SWEEPS IN LINES FROM HOUSE TO DRAIN FIELDS

NOTE: ALL PARTS OF SEPTIC SYSTEMS (I.E. TANK, DISTRIBUTION BOX, TRENCHES) TO BE 100 FEET FROM WELL (UNLESS OTHERWISE SPECIFICALLY AUTHORIZED)

NOTE: IF DEEP TRENCHES ARE USED CALL FOR INSPECTION BEFORE AND AFTER PLACING GRAVEL IN TRENCHES

NOTE: NO DRY WELL SHALL EXCEED 15 FOOT IN DIAMETER NO ABSORPTION TRENCH TO EXCEED 100 FEET IN LENGTH.

NOTE: ALL PIPE FROM HOUSE TO SEPTIC TANK MUST BE CAST IRON OR SCHEDULE 40 PVC OR ABS

PERMIT VOID AFTER TWO YEARS

NOTE: INSTALL STAND PIPE ON SEPTIC TANK AND DRY WELL. STAND PIPES MUST BE 6 INCHES IN DIAMETER. CAST IRON, CONCRETE OR TERRA COTTA OR PVC OR ABS ACCEPTED. IF TOP OF SEPTIC TANK IS DEEPER THAN 3 FEET, MANHOLE TO GRADE REQUIRED

NOTE: DISTRIBUTION BOXES MUST HAVE BAFFLES

BLDG. PERMIT SIGNED

AND RETURNED 10/21/93

Serial # 50967

Storage Shed.

P
45097

***INSTALLER IS RESPONSIBLE FOR OBTAINING FINAL APPROVAL ON THIS PERMIT**

CALL 461-9933 FOR INSPECTION OF SEPTIC SYSTEMS.

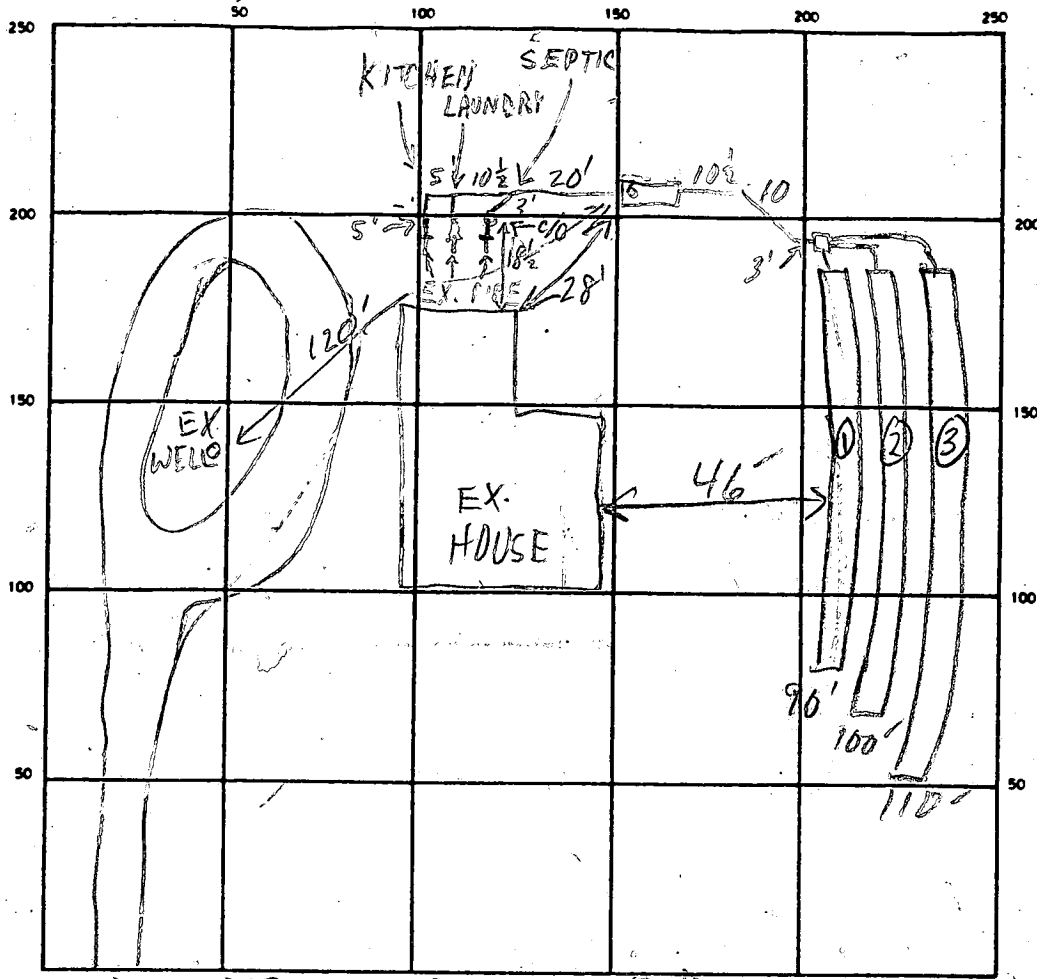

INDICATE NORTH NAME ADJOINING ROADWAY AS BASE LINE
 OLD FREDERICK RD

SEPTIC TANK LEVEL 1500 GAL-OK CLEANOUTS OK
 DISTRIBUTION BOX LEVEL OK BAFFLE IN
 DRAIN FIELD/TILE FIELD DEPTH 6 FT. TRENCH WIDTH 3 FT. INLET DEPTH 4 FT.
 EFFECTIVE GRAVEL DEPTH 2 FT. TOTAL LENGTH 090 02100 03110 FT.
 NUMBER OF TRENCHES 3 ONE SIDEWALL/BOTTOM AREA 0270 0330 SQ. FT.
 DRYWELL INSIDE DIAMETER _____ FT. EFFECTIVE DEPTH BELOW INLET _____ FT.
 ABSORBENT AREA 900 SQ. FT.

REMARKS 3/2/90 OK TO COVER TO DB EXCLUSIVE MR
3/8/90 OK TO COVER ALL MR

DATE SYSTEM APPROVED 3/8/90 INSPECTOR M. Ripkin

SUBDIVISION:

Kefauver Prop
Old Fred. Rd

A 45097

LOT NUMBER:

5 (EX. HOUSE)

DRY WELL OR DRY WELL AND TRENCH

4

sq. ft./bedroom

| | <u>Septic Tank</u> | <u>Minimum Total Square Feet</u> |
|-----------|--------------------|----------------------------------|
| 3 bedroom | 1000 gallon | _____ |
| 4 bedroom | 1250 gallon | _____ |
| 5 bedroom | 1500 gallon | _____ |

Inlet _____ feet below original grade.
 Bottom maximum depth _____ feet below original grade.
 Effective area begins at _____ feet below original grade.

NOTE: If trench is used to make up absorbent area, run the trench on level ground and leave a 5-foot earth buffer between dry well and trench. No trench is to exceed 100 feet in length. Trench inlet to be same as dry well, with _____ feet of stone below distribution pipe.

TRENCHES

180 sq. ft./bedroom

Trench to be 3 wide.
 Inlet 4 feet below original grade.
 Bottom maximum depth 6 feet below original grade.
 Effective area begins at 4 feet below original grade.
2 feet of stone below distribution pipe.

5BR
 $5 \times 180 = 900$ TOTAL
 $\div 3 = 300$
 LINEAR FEET
 NEEDED

- NOTE:
- (1) No trench to exceed 100 feet in length.
 - (2) If more than one trench used, a distribution box is required.
 - (3) Trenches to be installed on level ground.
 - (4) Call for inspection of trench before gravel is installed.
 - (5) Provide 6" - 8" diameter cleanout and cap to grade or above on septic tank and drywell.
 - (6) If a garbage disposal is used, increase septic tank capacity by 50% and increase absorbent sidewall area by 22%.

LOCATION: STARTING FROM FRONT RIGHT LOT CORNER, PLACE DISTRIBUTION BOX 300' DOWN RIGHT LOT LINE AND 100' OFF THIS SAME LOT LINE. RUN TRENCHES ON CONTOUR TOWARD FRONT OF LOT. MAINTAIN 20' FROM HOUSE.

MR 2/26/90

SPECS WRITTEN FROM PRELIM DATED 1/18/90

11-28-89
10:00am

APPLICATION

PERCOLATION TESTING

A 45097

P _____

HOWARD COUNTY HEALTH DEPARTMENT
BUREAU OF ENVIRONMENTAL HEALTH
P.O. BOX 476 ELLICOTT CITY, MARYLAND 21043
TELEPHONE: 461-9933

DISTRICT _____

DATE 10/19/89

1. Determine what surrounding structures exist.

TO: THE COUNTY HEALTH OFFICER
ELLICOTT CITY, MARYLAND

I HEREBY, APPLY FOR THE NECESSARY TEST IN ORDER TO CONSTRUCT (OR RECONSTRUCT) A SEWAGE DISPOSAL SYSTEM.

PROPERTY OWNER EMERSON KEFAUVER

ADDRESS 1841 WOODSTOCK RD, WOODSTOCK, MD 21163 PHONE 465-1416

PROSPECTIVE BUYER _____

ADDRESS _____ PHONE _____

PROPERTY LOCATION:

SUBDIVISION KEFAUVER PROP. LOT NO. Lot 4 Prelim Existing

ROAD AND DESCRIPTION SOUTH SIDE OLD FREDERICK RD @ DANIELS ROAD

TAX MAP 18 PARCEL # 19

SIZE OF LOT 8.65 Ac. ± TYPE BLDG. SFD (SBR)
(SINGLE FAMILY DWELLING OR COMMERCIAL)

THE SYSTEM INSTALLED UNDER THIS APPLICATION IS ACCEPTABLE ONLY UNTIL PUBLIC FACILITIES BECOME AVAILABLE. I FULLY UNDERSTAND THE FEE CONNECTED WITH THE FILING OF THIS PERC TEST APPLICATION IS NON-REFUNDABLE UNDER ANY CIRCUMSTANCES. I ALSO AGREE TO COMPLY WITH ALL M.O.S.H.A. REQUIREMENTS IN TESTING THIS LOT.

Emerson N. Kefauver
(SIGNATURE OF APPLICANT)

APPROVED BY _____ FOR _____ DATE _____

REJECTED BY _____ FOR _____ DATE _____

HOLD PENDING FURTHER TESTS _____ DATE _____

REASONS FOR REJECTION OR HOLDING HOLD FOR PLAT- PERC OR MR 12/1/89

THIS IS NOT A PERMIT

POND & STREAM 300' PLATTED HOLES NOT DUG (SURFACE ROCKY, STEEP NEAR POND)

①-④ SOIL PROFILE

dk org clay loam
 tan, org + beige sand loam
 5-10% frags

4 1/2 - 5

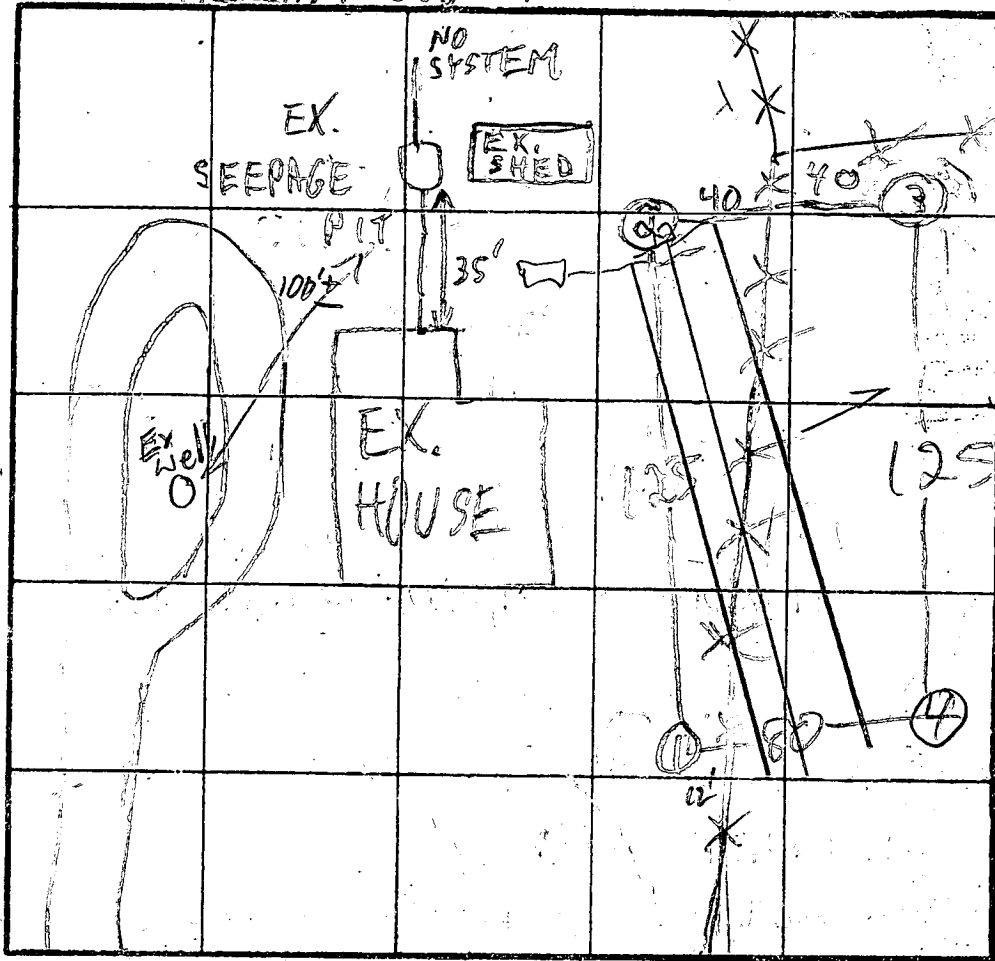

① ② H1
 ③ ④ L0

$\bar{x} = 2$
 Inlet 4'
 Bottom 6'
 188 A BR

INDICATE NORTH - NAME ADJOINING ROADWAY (AS BASE LINE)
 OLD FRED RD

| DATE | TEST NO. | DEPTH | PRE-WET | | TEST - 1" DROP | | TIME | |
|----------|----------|--------|-----------------------------------|------|----------------|------|------|--|
| | | | START | STOP | START | STOP | | |
| 11/29/89 | 1 M | 6 | 3:30 | 3:32 | 3:22 | 3:24 | 2 | |
| | | 8 | 3:29 | 3:31 | 3:31 | 3:34 | 2 | |
| | 1 V | 12 | OK see profile | | | | | |
| | 2 V | 12 1/2 | OK 15% frags some large | | | | | |
| | 3 S | 4 | 3:54 | 3:55 | 3:55 | 3:58 | 3 | |
| | 3 V | 11 | sim to ① clay to 3' 10% frags | | | | | |
| | 4 S | 3 1/2 | 4:01 | 4:02 | 4:02 | 4:04 | 2 | |
| | 4 V | 9 1/2 | sim to ① clay to 2 1/2' 10% frags | | | | | |
| | | | | | | | | |
| | | | | | | | | |
| | | | | | | | | |

REMARKS - SHALLOW SYSTEM, HOLES NOT PER PLAT

TYPE OF SOIL _____

TESTED BY M. Rifkin

ALSO PRESENT OK Jr. owner. eng'r

EH-12-1079

