

Tax ID - 03-299058

10/3/89
9/28/89
11 AM

PERMIT

P 45027

SEWAGE DISPOSAL SYSTEM

A REPAIR

MARYLAND STATE DEPARTMENT OF HEALTH DISTRICT _____

HOWARD COUNTY

BUREAU OF ENVIRONMENTAL HEALTH
461-9933

DATE 10/3/89

DATE SYSTEM APPROVED 9/28/89

INSPECTOR RH

INDEXED

Jack Fyock

IS PERMITTED TO INSTALL _____ ALTER X

ADDRESS _____ PHONE 988-9270

SUBDIVISION _____ ROAD 1550 Henryton Road LOT 2

PROPERTY OWNER Wockentuss
ADDRESS 1550 Henryton Road

IF GARBAGE GRINDER IS USED INCREASE SEPTIC TANK CAPACITY BY 50% AND ABSORPTION AREA BY 22%.

GARBAGE GRINDER? YES _____ NO X

SEPTIC TANK CAPACITY 1250 GALLONS NUMBER OF BEDROOMS 4

REPAIR - CALL FOR INSPECTION WHEN GROUND IS OPENED SO SANITARIAN CAN RECOMMEND REPAIR.

540 SOFT SIDEWALL AREA INLET 4 FT
BOTTOM 10 FT 6 FT STONE
RUN TRENCH OFF OLD DW

PLANS APPROVED BY C. Williams DATE 9/27/89

COVER NO WORK UNTIL INSPECTED AND APPROVED

NEITHER THE HOWARD COUNTY COUNCIL NOR THE HEALTH DEPARTMENT IS RESPONSIBLE FOR THE SUCCESSFUL OPERATION OF ANY SYSTEM.

NOTE: CLEANOUT REQUIRED EVERY 70 FEET OF SEWER LINE AND/OR AT 90° SWEEPS IN LINES FROM HOUSE TO DRAIN FIELDS

NOTE: ALL PARTS OF SEPTIC SYSTEMS (I.E. TANK, DISTRIBUTION BOX, TRENCHES) TO BE 100 FEET FROM WELL (UNLESS OTHERWISE SPECIFICALLY AUTHORIZED)

NOTE: IF DEEP TRENCHES ARE USED CALL FOR INSPECTION BEFORE AND AFTER PLACING GRAVEL IN TRENCHES

NOTE: NO DRY WELL SHALL EXCEED 15 FOOT IN DIAMETER NO ABSORPTION TRENCH TO EXCEED 100 FEET IN LENGTH.

NOTE: ALL PIPE FROM HOUSE TO SEPTIC TANK MUST BE CAST IRON OR SCHEDULE 40 PVC OR ABS

PERMIT VOID AFTER TWO YEARS

NOTE: INSTALL STAND PIPE ON SEPTIC TANK AND DRY WELL. STAND PIPES MUST BE 6 INCHES IN DIAMETER. CAST IRON, CONCRETE OR TERRA COTTA OR PVC OR ABS ACCEPTED. IF TOP OF SEPTIC TANK IS DEEPER THAN 3 FEET, MANHOLE TO GRADE REQUIRED

NOTE: DISTRIBUTION BOXES MUST HAVE BAFFLES

***INSTALLER IS RESPONSIBLE FOR OBTAINING FINAL APROVAL ON THIS PERMIT**

*CALL 461-9933 FOR INSPECTION OF SEPTIC SYSTEMS.

P 45027

125
4
50.6

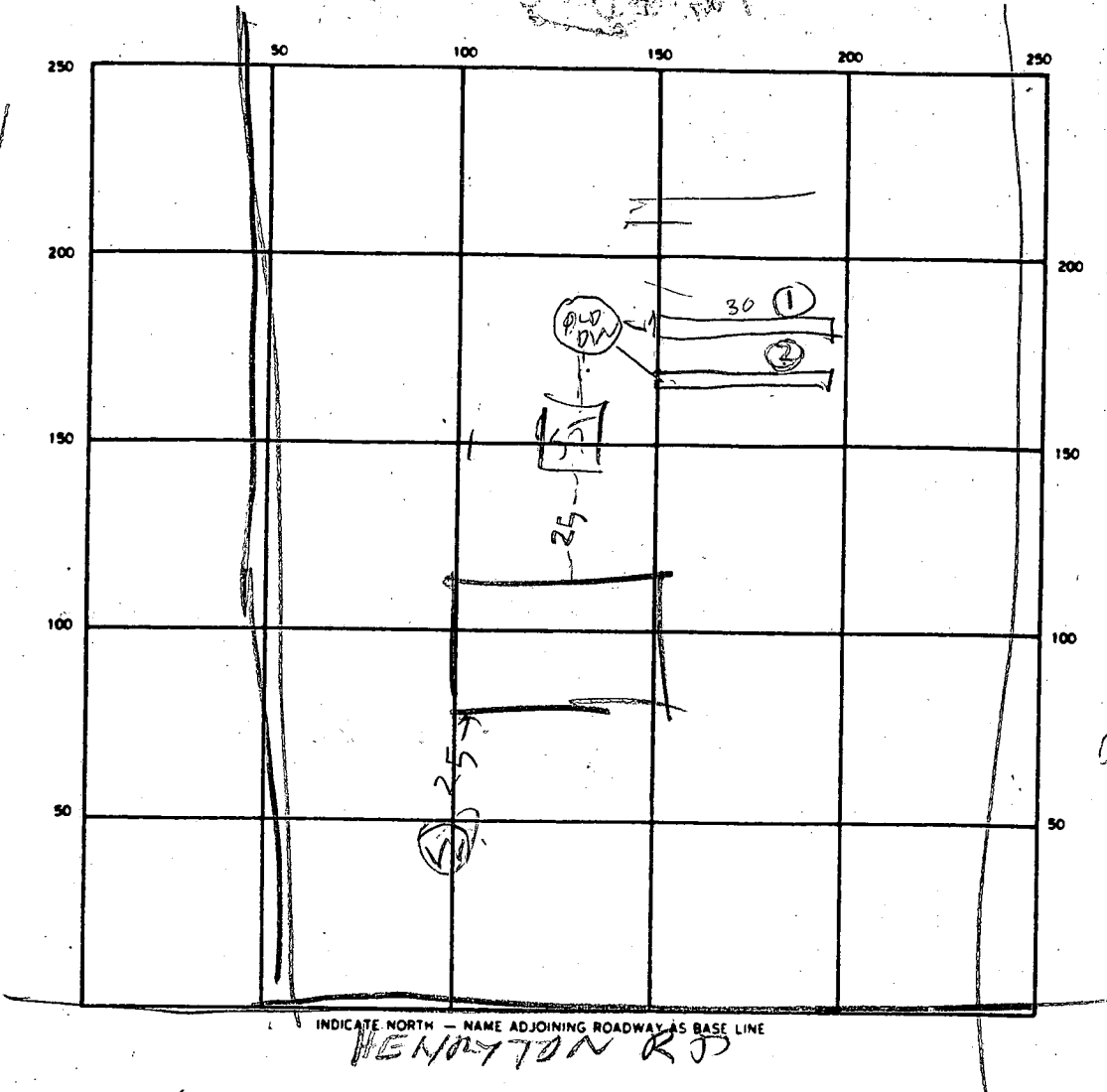
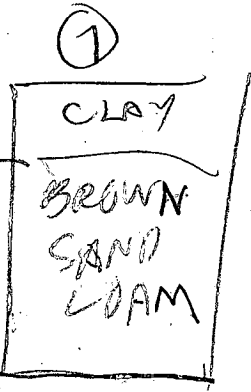

80
7
420

41
29
10

SEPTIC TANK LEVEL N/A CLEANOUTS _____ 41

DISTRIBUTION BOX LEVEL _____

DRAIN FIELD/TILE FIELD DEPTH 10/10 FT. TRENCH WIDTH 2/2 FT. INLET DEPTH 24/25 FT.

EFFECTIVE GRAVEL DEPTH 6/65 FT. TOTAL LENGTH 41/30 FT.

NUMBER OF TRENCHES 2 ONE SIDEWALL/BOTTOM AREA 246/195 SQ. FT.

DRYWELL INSIDE DIAMETER _____ FT. EFFECTIVE DEPTH BELOW INLET _____ FT.

ABSORBENT AREA _____ SQ. FT.

65
80
1950

REMARKS 9/28/89 SOIL GOOD TRENCH #1 ALMOST FINISHED
9/28/89 TRENCH #1 OK TRENCH #2 ALMOST FINISHED, FINISH DIGGING TRENCH #2 & COVER DIG IT ABOUT 15 FT LONGER R/L

DATE SYSTEM APPROVED 9/29/89 INSPECTOR Raymond Hodge

PERMIT

SEWAGE DISPOSAL SYSTEM

MARYLAND STATE DEPARTMENT OF HEALTH

HOWARD COUNTY

ELLICOTT CITY

DISTRICT 3

DATE 7/25/70

INDEXED

Septic tank & Bell IS PERMITTED TO INSTALL X ALTER

ADDRESS S. Delfield Rd., Griggs Hill, Md. PHONE 262-0800

A SEWAGE DISPOSAL SYSTEM LOCATED AT _____

SUBDIVISION Barrios ROAD 908 Henryton Road LOT 3

PROPERTY OWNER Jack Matthews, Trust Kelvin Russell

ADDRESS _____

SPECIFICATIONS - 4 bedrooms

DRAIN FIELD _____ DEPTH _____ FEET. BOTTOM AREA _____ SQ. FT.

SEEPAGE PITS _____ ABSORBENT SIDE-WALL AREA _____ SQ. FT.

SEPTIC TANK CAPACITY 1,200 GALLONS

FOR GARBAGE GRINDER, INCREASE DISPOSAL AREA 225 & TANK CAPACITY 50%.

OTHER Dry well - 100 sq. ft. absorbent sidewall area per bedroom to begin below
the first 4 ft. of original soil. Maximum depth permitted for dry well is 11 ft. below
original grade. Locate dry well 66 ft. from left side line and 155 ft. from right side
center as seen from Henryton Road.

NOTE: ALL PIPE FROM HOUSE TO SEPTIC TANK MUST BE CAST IRON.

PERMIT VOID AFTER THREE YEARS.

PLANS APPROVED BY Robert V. Tokys DATE 9/30/70

FILL SEPTIC TANK AND DISTRIBUTION BOX WITH WATER BEFORE CALLING FOR AN INSPECTION. COVER NO WORK UNTIL INSPECTED AND APPROVED.

NEITHER THE HOWARD COUNTY COMMISSIONERS NOR THE HEALTH DEPARTMENT IS RESPONSIBLE FOR THE SUCCESSFUL OPERATION OF ANY SYSTEM.

BLOG. PERMIT SIGNED
AND RETURNED 5/2/76
Serial # 49142
Post.

A-1578

1929

1929

ILLINOIS STATE DEPARTMENT OF HEALTH

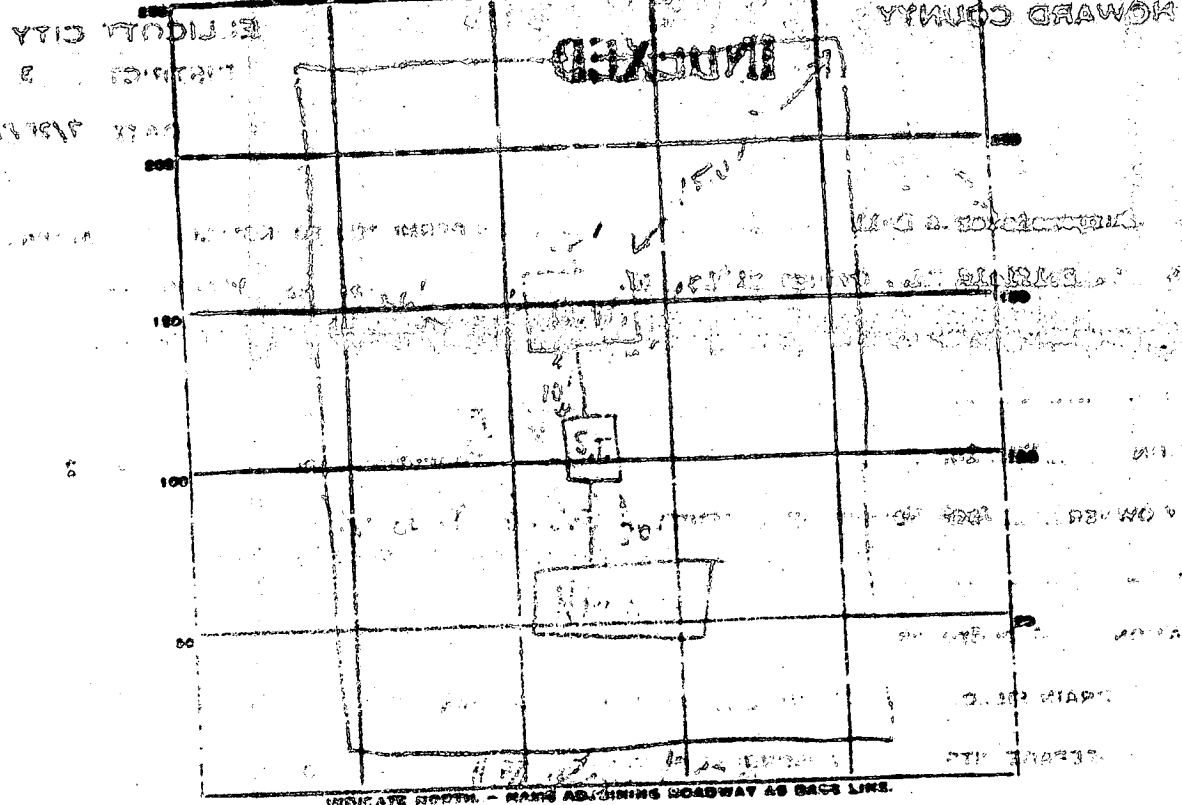

PERMIT CARD

Signed

SEPTIC TANK LEVEL

CLEANOUTS

DISTRIBUTION BOX LEVEL

TILE FIELD DEPTH

FT.

TRENCH WIDTH

FT.

GRAVEL DEPTH

FT.

TOTAL LENGTH

FT.

NUMBER OF TRENCHES

TOTAL BOTTOM AREA

SEEPAGE PITS INSIDE DIAMETER

FT.

DEPTH BELOW INLET

FT.

ABSORBENT AREA

SQ. FT.

REMARKS

DATE SYSTEM APPROVED

9/22/21

INSPECTOR

Charles H. ...

APPLICATION

SEWAGE DISPOSAL TESTING

A 15500
P _____

MARYLAND STATE DEPARTMENT OF HEALTH

HOWARD COUNTY

ELLICOTT CITY

Septic Tank - 1400 gal
 Dry Well - *300 sq. ft. absorbent sidewall area, to begin below the first 5 ft. of original soil. Maximum depth permitted for dry well is 11 ft. below original grade. Locate dry well 66 ft. from left side line and 155 ft. from right rear corner as seen from Hampton Rd.*
 DISTRICT 3
 DATE 9/22/70

TO: THE COUNTY HEALTH OFFICER
ELLICOTT CITY, MARYLAND

I, HEREBY, APPLY FOR THE NECESSARY TESTS IN ORDER TO CONSTRUCT (OR RECONSTRUCT) A SEWAGE DISPOSAL SYSTEM.

PROPERTY OWNER Everett L. Rensburg Property - Jack Wickerford, Owner
 ADDRESS Hampton Road, Harriottsville, Md 21104 PHONE 328-2696

PROPERTY LOCATION:

SUBDIVISION None LOT NO. 2
 ROAD AND DESCRIPTION Hampton Road

OCCUPANT _____ PHONE _____

PERSON TO CONSTRUCT SYSTEM _____

ADDRESS _____ PHONE _____

SIZE OF LOT 40,000 sq. ft. TYPE BLOC. af

IF NOT SINGLE RESIDENCE DESCRIBE _____ (Single Family Dwllg.)

SIGNATURE OF APPLICANT /s/ Everett L. Rensburg

APPROVED BY [Signature] FOR Dry Well DATE 9/30/70
(KIND OF SYSTEM)

REJECTED BY _____ FOR _____ DATE _____
(KIND OF SYSTEM)

HOLD PENDING FURTHER TESTS _____ DATE _____

REASONS FOR REJECTION OR HOLDING _____

THIS IS NOT A PERMIT

