

2/2/89
Norm.

PERMIT

SEWAGE DISPOSAL SYSTEM

MARYLAND STATE DEPARTMENT OF HEALTH

HOWARD COUNTY
BUREAU OF ENVIRONMENTAL HEALTH
461-9933

INDEXED

01-165216

P 44111

A REPAIR

DISTRICT _____

DATE 4/24/89

DATE SYSTEM APPROVED 2/2/89

INSPECTOR RH

Jack Fuock

IS PERMITTED TO INSTALL ALTER _____

ADDRESS _____ PHONE 988-9270

SUBDIVISION _____ ROAD 6461 Euclid Avenue LOT _____

PROPERTY OWNER Falter

ADDRESS 6461 Euclid Avenue
Elkridge, Maryland 21227

IF GARBAGE GRINDER IS USED INCREASE SEPTIC TANK CAPACITY BY 50% AND ABSORPTION AREA BY 22%.

GARBAGE GRINDER? YES _____ NO _____

SEPTIC TANK CAPACITY 100 GALLONS NUMBER OF BEDROOMS 3

REPAIR - CALL FOR INSPECTION WHEN GROUND IS OPENED UP SO SANITARIAN CAN RECOMMEND REPAIR.

Replace Rusty steel
Tank 2/2/89 RH

PLANS APPROVED BY C. Williams DATE 2/02/89

COVER NO WORK UNTIL INSPECTED AND APPROVED

NEITHER THE HOWARD COUNTY COUNCIL NOR THE HEALTH DEPARTMENT IS RESPONSIBLE FOR THE SUCCESSFUL OPERATION OF ANY SYSTEM.

NOTE: CLEANOUT REQUIRED EVERY 70 FEET OF SEWER LINE AND/OR AT 90° SWEEPS IN LINES FROM HOUSE TO DRAIN FIELDS

NOTE: ALL PARTS OF SEPTIC SYSTEMS (I.E. TANK, DISTRIBUTION BOX, TRENCHES) TO BE 100 FEET FROM WELL (UNLESS OTHERWISE SPECIFICALLY AUTHORIZED)

NOTE: IF DEEP TRENCHES ARE USED CALL FOR INSPECTION BEFORE AND AFTER PLACING GRAVEL IN TRENCHES

NOTE: NO DRY WELL SHALL EXCEED 15 FOOT IN DIAMETER NO ABSORPTION TRENCH TO EXCEED 100 FEET IN LENGTH.

NOTE: ALL PIPE FROM HOUSE TO SEPTIC TANK MUST BE CAST IRON OR SCHEDULE 40 PVC OR ABS

PERMIT VOID AFTER TWO YEARS

NOTE: INSTALL STAND PIPE ON SEPTIC TANK AND DRY WELL. STAND PIPES MUST BE 6 INCHES IN DIAMETER. CAST IRON, CONCRETE OR TERRA COTTA OR PVC OR ABS ACCEPTED. IF TOP OF SEPTIC TANK IS DEEPER THAN 3 FEET, MANHOLE TO GRADE REQUIRED

NOTE: DISTRIBUTION BOXES MUST HAVE BAFFLES

***INSTALLER IS RESPONSIBLE FOR OBTAINING FINAL APROVAL ON THIS PERMIT**

*CALL 461-9933 FOR INSPECTION OF SEPTIC SYSTEMS.

P 44111

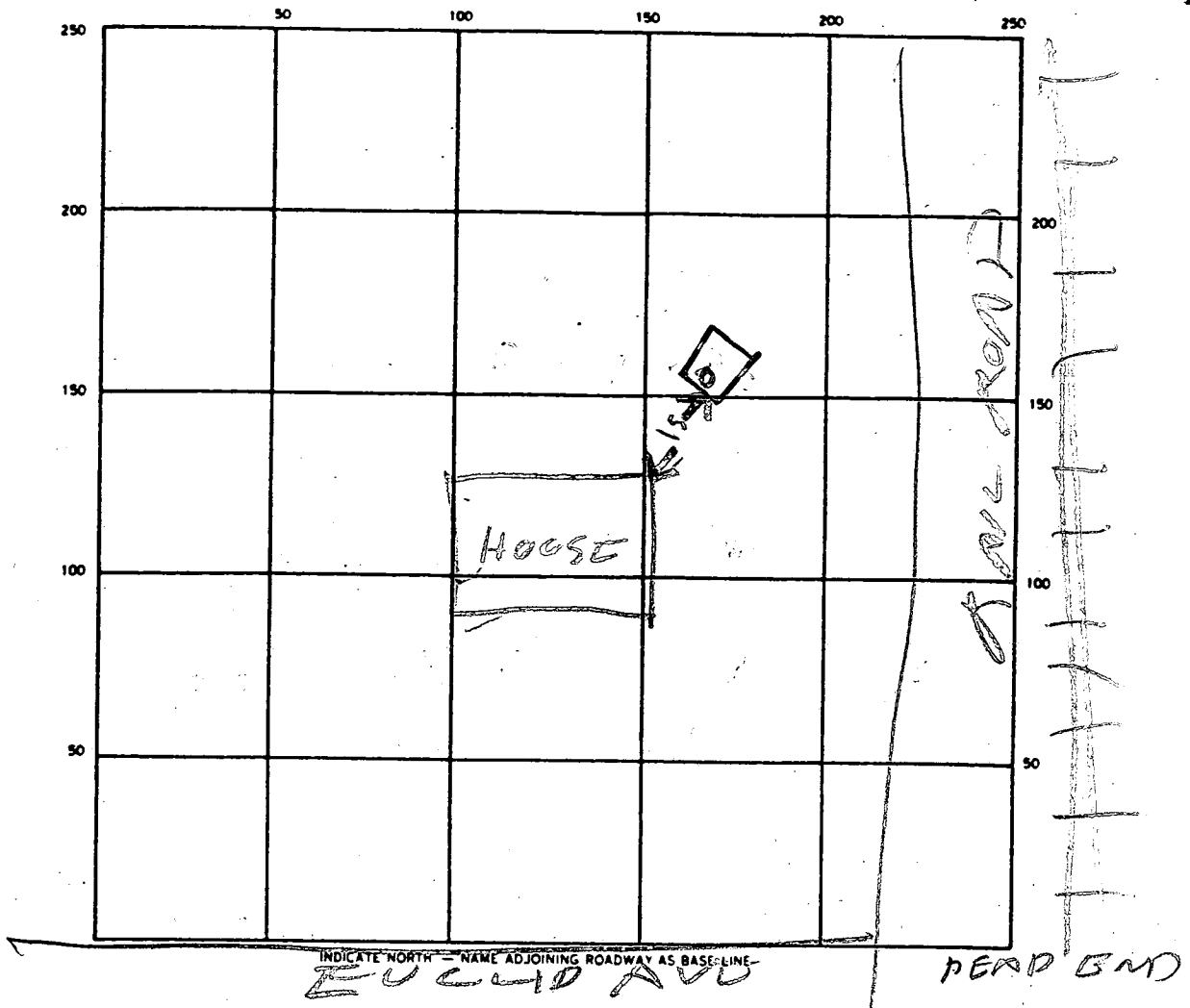

SEPTIC TANK LEVEL 1000 CLEANOUTS ST OK
 DISTRIBUTION BOX LEVEL _____
 DRAIN FIELD/TILE FIELD DEPTH _____ FT. TRENCH WIDTH _____ FT. INLET DEPTH _____ FT.
 EFFECTIVE GRAVEL DEPTH _____ FT. TOTAL LENGTH _____ FT.
 NUMBER OF TRENCHES _____ ONE SIDEWALL/BOTTOM AREA _____ SQ FT.
 DRYWELL INSIDE DIAMETER _____ FT. EFFECTIVE DEPTH BELOW INLET _____ FT.
 ABSORBENT AREA _____ SQ FT.

REMARKS 2/2/89 - NEW CONCRETE TANK
INSTALLED TO REPLACE RUSTED STEEL
TANK OLD DRAIN FIELD TO BE USED
ON CITY WATER, BUT PUBLIC SEWER NOT
AVAILABLE

DATE SYSTEM APPROVED 2/2/89 INSPECTOR Raymond Hodges

February 6, 2004

MEMORANDUM

TO: File

FROM: Mark Rifkin
Well and Septic Program

RE: 6461 Euclid Avenue
Harwood Park, Lots 219-222

T/C with potential buyer who wants to build addition or rehab ex. house (b. 1945); per GIS, public sewer stops 185' short of her property line (likely due to downslope position of property).

I advised her we didn't know any detail of system other than tank replacement in 1989; ex. drainfield unknown and absence of repair record in 40 years indicates system actively failing, repair installed w/o permit and/or system in water table; in order to sign BP (with or w/o bedroom addition) perc required, and soils map and topo indicate Beltsville and Chillum soils in vicinity (clay and shallow water); in combination with lot size and likely soil conditions, repair would not be routine, and may result in requirements to install "expensive" (drip disposal??) system or even a holding tank

I also suggested she look into privately-funded extension of sewer in Euclid Ave, although this would be expensive (\$50K?), likely problematic due to pump/mechanical requirements and may not receive support of three other neighbors also not served by sewer who could help defray costs

I informed her easement possible to access sewer in Loudon Ave, but this would involve other properties with legal easement recordation requirements and poor potential of success

MR

Click here for a plain text ADA compliant screen.

	Maryland Department of Assessments and Taxation HOWARD COUNTY Real Property Data Search	Go Back View Map New Search Ground Rent
---	---	--

STR

Account Identifier: District - 01 Account Number - 165216

Owner Information

Owner Name:	FALTER MILDRED M L/E	Use:	RESIDENTIAL
		Principal Residence:	YES
Mailing Address:	6461 EUCLID AVE ELKRIDGE MD 21075-5629	Deed Reference:	1) / 5994/ 64 2)

Location & Structure Information

Premises Address 6461 EUCLID AVE ELKRIDGE 21075	Zoning R12	Legal Description LOTS 219 THRU 222 6461 EUCLID AVE HARWOOD PARK
--	----------------------	--

Map	Grid	Parcel	Sub District	Subdivision	Section	Block	Lot	Group	Plat No: Plat Ref:
38	13	873					219	82	

Special Tax Areas	Town Ad Valorem Tax Class	A/V, METRO FIRE TAX
--------------------------	----------------------------------	---------------------

Primary Structure Built 1945	Enclosed Area 816 SF	Property Land Area 17,400.00 SF	County Use
--	--------------------------------	---	-------------------

Stories 1	Basement NO	Type STANDARD UNIT	Exterior FRAME
---------------------	-----------------------	------------------------------	--------------------------

Value Information

	Base Value	Value			Phase-in Assessments		
		As Of	As Of	As Of	As Of	As Of	As Of
		01/01/2003	07/01/2003	07/01/2004			
Land:	63,150	80,150					
Improvements:	31,990	35,210					
Total:	95,140	115,360	101,880	108,620			
Preferential Land:	0	0	0	0			

Transfer Information

Seller: FALTER MILDRED M	Date: 02/15/2002	Price: \$0
Type: NOT ARMS-LENGTH	Deed1: / 5994/ 64	Deed2:
Seller:	Date:	Price:
Type:	Deed1:	Deed2:
Seller:	Date:	Price:
Type:	Deed1:	Deed2:

Exemption Information

Partial Exempt Assessments	Class	07/01/2003	07/01/2004
County	000	0	0
State	000	0	0
Municipal	000	0	0

Tax Exempt: NO	Special Tax Recapture: HOMEOWNERS TAX CREDIT
Exempt Class:	



Maryland Department of Assessments and Taxation
HOWARD COUNTY
Real Property Data Search

[Go Back](#)
[View Map](#)
[New Search](#)

District - 01 Account Number - 165216

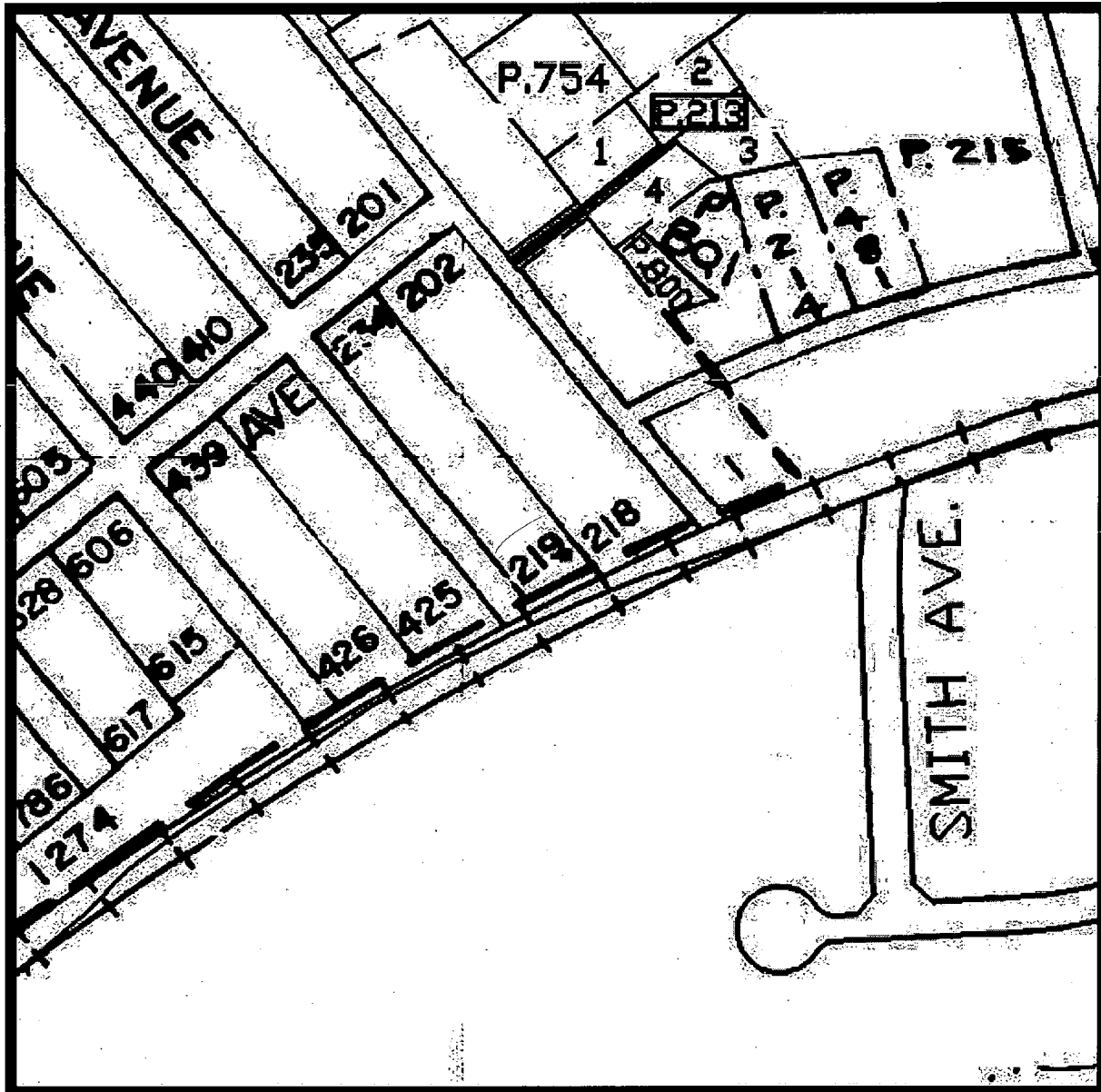

Property maps provided courtesy of the Maryland Department of Planning ©2001 - 2002.
For more information on electronic mapping applications, visit the Maryland Department of Planning web site at
www.mdp.state.md.us/webcom/index.html

Help Me	Map Reset	Zoom Fit	Find Location	Remove Pin	Layer Control	Image Control	Theme Map	Local Print	Print Layout	Email Map	Map Exit

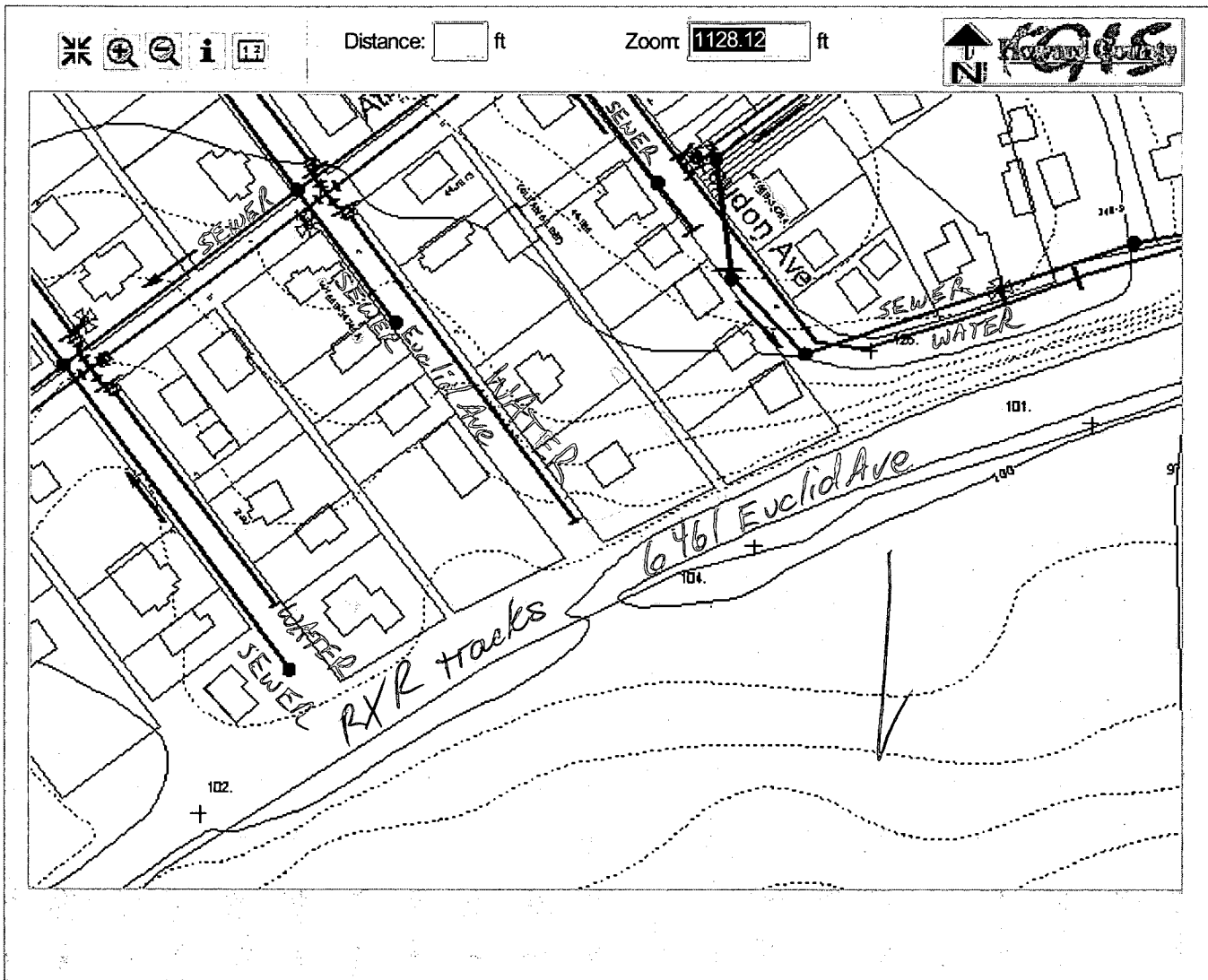

Disclaimer: Howard County, Maryland assumes no responsibility for the accuracy of this map or the information contained herein or derived therefrom. The buyer and/or user assumes all risks and liabilities whatsoever resulting from or arising out of the use of this map. There are no oral agreements or warranties relating to this sale and/or use of this map.

Friday, February 06 2004 | 5:22:15 PM | @974

Map Legends

	County Line		Property Line
	House Driveway		Contour Lines
		400	Contour Label
			Spot Elev.
		401	

Sanitary Sewer

	Pipe		Manhole		Plug
--	------	--	---------	--	------

Water Lines

	Pipe		Valve		Division Valve		Cross		Tee		Fire Hydrant		Reducer		Plug
--	------	--	-------	--	----------------	--	-------	--	-----	--	--------------	--	---------	--	------

Contacts: John Bussiere (x3044) Virginia Peterman (x3659) Yut Phasukyued (x3093) Robert Slivinsky (x3094)

37

