

3:00 PM  
1/12/95  
2/13/95  
a.m. SWPT

# PERMIT

## SEWAGE DISPOSAL SYSTEM

DEPARTMENT OF HEALTH AND MENTAL HYGIENE

04-353706

Need House  
Connections  
done  
2/13/95 P 50429

A 43379

DISTRICT 3rd

DATE 12/05/94

HOWARD COUNTY HEALTH DEPARTMENT

BUREAU OF ENVIRONMENTAL HEALTH

~~XXXXXX~~ 313-2640

DATE SYSTEM APPROVED 2/13/95

INSPECTOR DKS

### INDEXED

Masonry Contractors, Inc.

IS PERMITTED TO INSTALL  ALTER

ADDRESS 4219 Hanover pike, Manchester, Maryland 21102

PHONE 410-239-8330

SUBDIVISION Cabin Branch Farm

LOT 3

ROAD 3208 Starting Gate Court

PROPERTY OWNER

Martin II, Inc.

Gerald Anderson

ADDRESS

SEPTIC TANK CAPACITY 1250 GALLONS

NUMBER OF BEDROOMS 4

240 SQUARE FEET PER BEDROOM

LINEAR FEET OF TRENCH REQUIRED 320

### BUILDING PERMIT SIGNED AND RETURNED

5-8-03 BOD 141736-DECK  
5-19-03 Amendment to DECK

TRENCHES - Trench to be 3 feet wide. Inlet 3 feet below original grade. Bottom maximum depth 5 feet below original grade. Effective area begins at 3 feet below original grade. 2 feet of stone below distribution pipe.

LOCATION - Place distribution box 145 feet from right (512.73') lot line and 150 feet from front (262.18') lot line as viewed from Starting Gate Court. Install trenches on contour toward right lot line.

NOTES - No trench to exceed 100 feet in length. Provide 6" - 8" diameter cleanout and cap to grade or above on septic tank. OK 1/13/95 DKS

PLANS APPROVED BY Ronald J. Pinkley

DATE 12/30/94

COVER NO WORK UNTIL INSPECTED AND APPROVED

NEITHER THE HOWARD COUNTY COUNCIL NOR THE HEALTH DEPARTMENT IS RESPONSIBLE FOR THE SUCCESSFUL OPERATION OF ANY SYSTEM

NOTE: CLEANOUT REQUIRED EVERY 70 FEET OF SEWER LINE AND/OR AT 90° SWEEPS IN LINES FROM HOUSE TO DRAIN FIELDS, 90° ELBOWS NOT ACCEPTABLE.

NOTE: ALL PARTS OF SEPTIC SYSTEMS (I.E. TANK, DISTRIBUTION BOX, TRENCHES) TO BE 100 FEET FROM WELL (UNLESS OTHERWISE SPECIFICALLY AUTHORIZED)

NOTE: IF DEEP TRENCH(ES) ARE USED CALL FOR INSPECTION BEFORE AND AFTER PLACING GRAVEL IN TRENCH(ES)

NOTE: NO DRY WELL SHALL EXCEED 15 FOOT IN DIAMETER NO ABSORPTION TRENCH TO EXCEED 100 FEET IN LENGTH

NOTE: ALL PIPE FROM HOUSE TO SEPTIC TANK MUST BE CAST IRON OR SCHEDULE 35/40 PVC OR ABS

PERMIT VOID AFTER TWO YEARS

NOTE: INSTALL STAND PIPE ON SEPTIC TANK AND DRY WELL STAND PIPES MUST BE 6 INCHES IN DIAMETER CAST IRON, CONCRETE OR TERRA COTTA OR PVA OR ABS ACCEPTED. IF TOP OF SEPTIC TANK IS DEEPER THAN 3 FEET, MANHOLE TO GRADE REQUIRED.

NOTE: DISTRIBUTION BOXES MUST HAVE BAFFLES

**\*INSTALLER IS RESPONSIBLE FOR OBTAINING FINAL APPROVAL ON THIS PERMIT**

A 43379

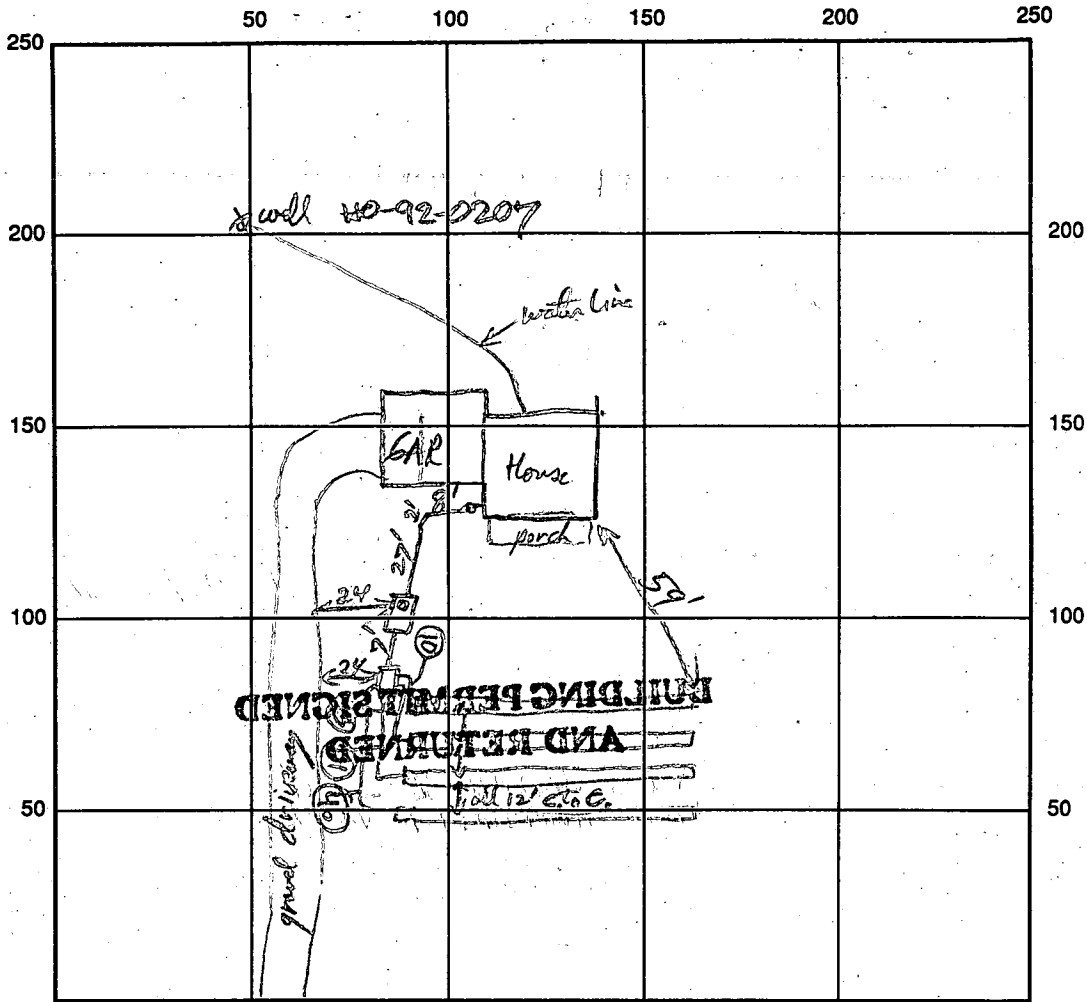

Starting gate INDICATE NORTH - NAME ADJOINING ROADWAY AS BASE LINE

SEPTIC TANK LEVEL 1250 gal CLEANOUTS ST + HSE  
 DISTRIBUTION BOX LEVEL ✓  
 DRAIN FIELD/TITLE DEPTH 5 FT. TRENCH WIDTH 3 FT. INLET DEPTH 3 FT.  
 EFFECTIVE GRAVEL DEPTH 21 FT. TOTAL LENGTH ~~80~~ 80/50 FT.  
 NUMBER OF TRENCHES 4 ONE SIDEWALL/BOTTOM AREA 960 SQ. FT.  
 DRYWALL INSIDE DIAMETER — FT. EFFECTIVE DEPTH BELOW INLET — FT.  
 ABSORBENT AREA — SQ. FT.

REMARKS: Trenches OK to cover. Needs House Connection yet. 11/12/94  
2/13/95 Final - house connection made. No WPI inspection -  
open area at well was full of snow. DKS

DATE SYSTEM APPROVED \_\_\_\_\_ INSPECTOR \_\_\_\_\_

# APPLICATION

PERCOLATION TESTING

A 43379

P \_\_\_\_\_

R \_\_\_\_\_

DISTRICT \_\_\_\_\_

DATE 12/19/88

HOWARD COUNTY HEALTH DEPARTMENT  
BUREAU OF ENVIRONMENTAL HEALTH  
P.O. BOX 476 ELLICOTT CITY, MARYLAND 21043  
TELEPHONE: 461-9933

TO: THE COUNTY HEALTH OFFICER  
ELLICOTT CITY, MARYLAND

I HEREBY APPLY FOR THE NECESSARY TEST IN ORDER TO CONSTRUCT (OR RECONSTRUCT) A SEWAGE DISPOSAL SYSTEM.

PROPERTY OWNER ~~Oakton Associates, Inc.~~ *Martin II, Inc*

ADDRESS 1200 18th Street, NW, Washington, DC 20036 PHONE (202) 457-8637  
*410-239-8330*

PROSPECTIVE BUYER Anchor Capital Group

ADDRESS 133 Defense Highway, Suite 206 PHONE (301) 261-8727  
Annapolis, MD 21401

PROPERTY LOCATION: \_\_\_\_\_

SUBDIVISION Cabin Branch Farm LOT NO. *574 88-5400*  
*H. 307 final*

ROAD AND DESCRIPTION Rte 94 (Ellicott Road) Approximately 2 miles North East  
from Damascus Road (*3208 Starting Gate Court*)

TAX MAP 13 PARCEL # 42

SIZE OF LOT 3 acres TYPE BLDG. Single Family  
(SINGLE FAMILY DWELLING OR COMMERCIAL)

THE SYSTEM INSTALLED UNDER THIS APPLICATION IS ACCEPTABLE ONLY UNTIL PUBLIC FACILITIES BECOME AVAILABLE. I FULLY UNDERSTAND THE FEE CONNECTED WITH THE FILING OF THIS PERC TEST APPLICATION IS NON-REFUNDABLE UNDER ANY CIRCUMSTANCES. I ALSO AGREE TO COMPLY WITH ALL M.O.S.H.A. REQUIREMENTS IN TESTING THIS LOT.

*James Hanna*  
(SIGNATURE OF APPLICANT)

APPROVED BY \_\_\_\_\_ FOR \_\_\_\_\_ DATE \_\_\_\_\_

REJECTED BY \_\_\_\_\_ FOR \_\_\_\_\_ DATE \_\_\_\_\_

HOLD PENDING FURTHER TESTS \_\_\_\_\_ DATE \_\_\_\_\_

REASONS FOR REJECTION OR HOLDING *4-24-87 PERC SATISFACTORY - held for PERC*

HD-216

# THIS IS NOT A PERMIT

A-43379  
LOT 4

SOIL PROFILE

8" AP  
Yellow Br. Silty Clay  
WMM  
20% Frap

4" Yellow Br. Silty Sand  
WMM  
25-30% Frap

11" Small frags of st. shale

12"

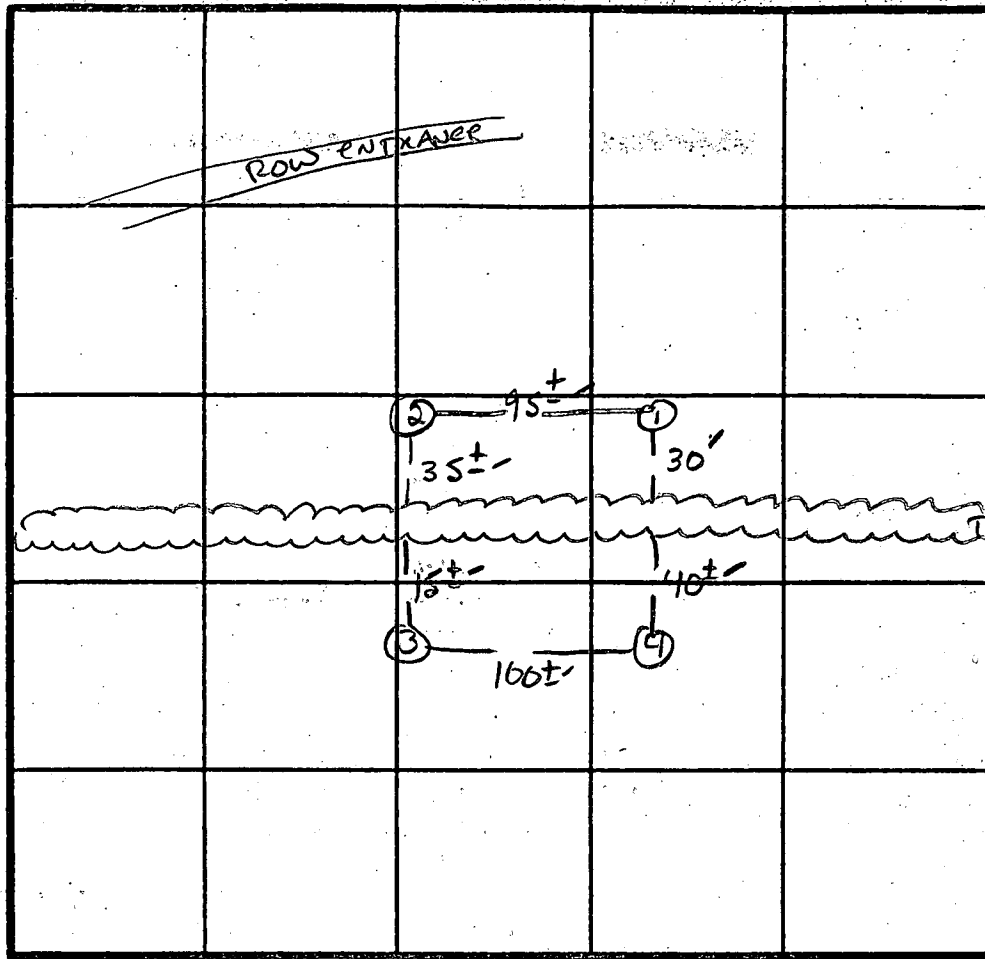

X Perc 12 MW  
#1 BR  
Inlet 30  
Bottom 4.5

INDICATE NORTH - NAME ADJOINING ROADWAY AS BASE LINE.

Rt 94

DATE	TEST NO.	DEPTH	PRE-WET		TEST - 1" DROP		TIME	
			START	STOP	START	STOP		
4/24/89	1 S	4.5'	2:01	2:03	2:03	2:07	4 MIN	
	1 V	13'	As profiled -					
	2 S	3.0'	2:08	2:22	2:22	2:48	26 MIN	
	2 M	7.5'	2:04	2:12	2:12	2:25	13 MIN	
	2 V	12.0'	Similar to Profile.					
	3 S	4'	Refusal - 20-30% Frap above					
	3 V	9'	Refusal - Same as #3					
	4 V	9'	Refusal - Same as #3					

REMARKS Holes Per stake and approx to point - shallow test only

TYPE OF SOIL m m m o r

TESTED BY S. Abel

ALSO PRESENT ROKR + OTHERS

B 1 03917

SEQUENCE NO. (DP USE ONLY)

STATE OF MARYLAND APPLICATION FOR PERMIT TO DRILL WELL

PERMIT NUMBER HD-92-0207

(THIS NUMBER IS TO BE PUNCHED IN COLS. 3-6 ON ALL CARDS)

please print or type

fill in this form completely

Date Received (APA)

09/03/92

OWNER INFORMATION

FRAWL DEVELOPERS

BOX 459

Mt Airy MD 21771

B 3

LOCATION OF WELL

HOWARD

CALVIN BRANCH FARM

SECTION 44 46 LOT 3 48 50

LISBON

MILES FROM TOWN (enter 0 if in town) 4 MI

DRILLER INFORMATION

Joseph L. Mayne 238

Joseph L. Mayne Well Drilling

5512 Ridge Rd. Mt. Airy MD 21771

Signature Joseph Mayne Date 9/2/92

B 4

DIRECTION OF WELL FROM TOWN (CIRCLE BOX)

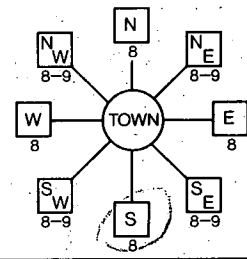

Starting Gate Court NEAR WHAT ROAD

ON WHICH SIDE OF ROAD (CIRCLE APPROPRIATE BOX) NORTH WEST EAST SOUTH

DISTANCE FROM ROAD 300 FT

B 2

WELL INFORMATION

APPROX. PUMPING RATE (GAL. PER MIN.) 5

AVERAGE DAILY QUANTITY NEEDED (GAL. PER DAY) 500

USE FOR WATER (CIRCLE APPROPRIATE BOX)

- HOME (SINGLE OR DOUBLE HOUSEHOLD UNIT ONLY)
FARMING (LIVESTOCK WATERING & AGRICULTURAL IRRIGATION)
INDUSTRIAL, COMMERCIAL, STATE AND FEDERAL GOV. OTHER (REQUIRES APPROPRIATION PERMIT)
PUBLIC OR PRIVATE WATER COMPANY (REQUIRES APPROPRIATION PERMIT AND STATE HEALTH DEPARTMENT APPROVAL)
TEST, OBSERVATION, MONITORING (MAY REQUIRE APPROPRIATION PERMIT)

NOT TO BE FILLED IN BY DRILLER HEALTH DEPARTMENT APPROVAL

Howard COUNTY NAME A43379 COUNTY NO.

STATE SIGNATURE DATE ISSUED 10/19/92 Mark E. Kiffin 4/19/93

NORTH GRID 532000 EAST GRID 0766000

APPROXIMATE DEPTH OF WELL 200 FEET

APPROXIMATE DIAMETER OF WELL 6 INCH

METHOD OF DRILLING (circle one)

- BORED (or Augered) JETTED Jetted & DRIVEN
AIR-ROTary AIR-PERcussion ROTARY (Hydraulic Rotary)
CABLE REVerse-ROTary Drive-POINT

REPLACEMENT OR DEEPEMED WELLS (CIRCLE APPROPRIATE BOX)

- THIS WELL WILL NOT REPLACE AN EXISTING WELL
THIS WELL WILL REPLACE A WELL THAT WILL BE ABANDONED AND SEALED
THIS WELL WILL REPLACE A WELL THAT WILL BE USED AS A STANDBY
THIS WELL WILL DEEPEN AN EXISTING WELL

PERMIT NUMBER OF WELL TO BE REPLACED OR DEEPEMED (IF AVAILABLE)

Not to be filled in by driller (OEP USE ONLY)

APPROX. PERMIT NUMBER GAP

FORCE MR PERMIT No. HD-92-0207

SPECIAL CONDITIONS

- SHOW MAJOR FEATURES OF BOX & LOCATE WELL WITH AN X
SOURCES OF DRILLING WATER
1. WELL

10/23/92 Grant ok - see yield sheet

WRITE THE BOX NUMBER FROM THE MAP HERE

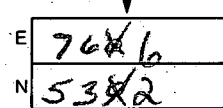

DRAW A SKETCH BELOW SHOWING LOCATION OF WELL IN RELATION TO NEARBY TOWNS AND ROADS AND GIVE DISTANCE FROM WELL TO NEAREST ROAD JUNCTION

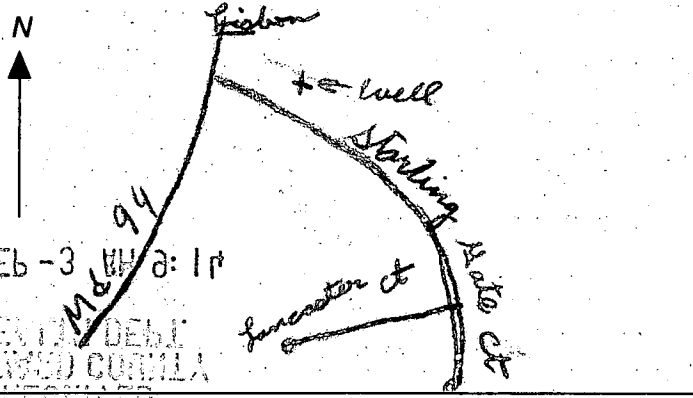

C1 6617 SEQUENCE NO. (DENV USE ONLY)  
 (THIS NUMBER IS TO BE PUNCHED IN COLS. 3-6 ON ALL CARDS)

STATE OF MARYLAND  
 WELL COMPLETION REPORT  
 FILL IN THIS FORM COMPLETELY  
 PLEASE PRINT OR TYPE

THIS REPORT MUST BE SUBMITTED WITHIN 45 DAYS AFTER WELL IS COMPLETED.  
 COUNTY NUMBER A 43379

ST/CO USE ONLY  
 DATE RECEIVED

DATE WELL COMPLETED  
10 23 90

Depth of Well  
385  
 (TO NEAREST FOOT)

PERMIT NO.  
 FROM "PERMIT TO DRILL WELL"  
H0-92-0207

OWNER Erall Developers  
 STREET OR RFD Starting Gate TOWN Woodbine  
 SUBDIVISION CAGAN BRANCH FARM SECTION \_\_\_\_\_ LOT 3

WELL LOG  
 Not required for driven wells  
 STATE THE KIND OF FORMATIONS PENETRATED, THEIR COLOR, DEPTH, THICKNESS AND IF WATER BEARING

DESCRIPTION (Use additional sheets if needed)	FEET		Check if water bearing
	FROM	TO	
Brown Shale	0	37	
Blue Rock	37	385	✓

GROUTING RECORD  
 WELL HAS BEEN GROUTED (Circle Appropriate Box)  YES  NO  
 TYPE OF GROUTING MATERIAL  
 CEMENT  BENTONITE CLAY   
 NO. OF BAGS 9 NO. OF POUNDS 946  
 GALLONS OF WATER 54  
 DEPTH OF GROUT SEAL (to nearest foot)  
 from 0 ft. to 35 ft.

CASING RECORD  
 casing types insert appropriate code below  
 ST STEEL  CO CONCRETE  
 PL PLASTIC  OT OTHER

MAIN CASING TYPE ST Nominal diameter top (main) casing (nearest inch) 6 Total depth of main casing (nearest foot) 42

OTHER CASING (if used) diameter inch \_\_\_\_\_ depth (feet) from \_\_\_\_\_ to \_\_\_\_\_

SCREEN RECORD  
 screen type or open hole insert appropriate code below  
 ST STEEL  BR BRASS  HO OPEN HOLE  
 PL PLASTIC  OT OTHER

DEPTH (nearest ft.)  
 EACH SCREEN DEPTH  
 1 H0 40 385  
 2 \_\_\_\_\_  
 3 \_\_\_\_\_  
 SLOT SIZE 1 \_\_\_\_\_ 2 \_\_\_\_\_ 3 \_\_\_\_\_  
 DIAMETER OF SCREEN \_\_\_\_\_ (NEAREST INCH)  
 from \_\_\_\_\_ to \_\_\_\_\_

CIRCLE APPROPRIATE LETTER  
 A A WELL WAS ABANDONED AND SEALED WHEN THIS WELL WAS COMPLETED  
 E ELECTRIC LOG OBTAINED  
 P TEST WELL CONVERTED TO PRODUCTION WELL

I HEREBY CERTIFY THAT THIS WELL HAS BEEN CONSTRUCTED IN ACCORDANCE WITH COMAR 26.04.04 "WELL CONSTRUCTION" AND IN CONFORMANCE WITH ALL CONDITIONS STATED IN THE ABOVE CAPTIONED PERMIT, AND THAT THE INFORMATION PRESENTED HEREIN IS ACCURATE AND COMPLETE TO THE BEST OF MY KNOWLEDGE.

DRILLERS IDENT. NO. 238  
 DRILLERS SIGNATURE Joseph Maynes  
 (MUST MATCH SIGNATURE ON APPLICATION)

SITE SUPERVISOR (sign. of driller or journeyman responsible for sitework if different from permittee)

GRAVEL PACK IF WELL DRILLED WAS FLOWING WELL INSERT F IN BOX 68

OEP USE ONLY (NOT TO BE FILLED IN BY DRILLER)  
 T (E.R.O.S.) \_\_\_\_\_ W Q \_\_\_\_\_  
 TELESCOPE CASING LOG INDICATOR OTHER DATA

PUMPING TEST  
 HOURS PUMPED (nearest hour) 6  
 PUMPING RATE (gal. per min. to nearest gal.) 1.3  
 METHOD USED TO MEASURE PUMPING RATE bucket  
 WATER LEVEL (distance from land surface)  
 BEFORE PUMPING 36  
 WHEN PUMPING 302  
 TYPE OF PUMP USED (for test)  
 A air  P piston  T turbine  
 C centrifugal  R rotary  O other (describe below)  
 J jet  S submersible

PUMP INSTALLED  
 DRILLER WILL INSTALL PUMP YES  NO   
 IF DRILLER INSTALLS PUMP, THIS SECTION MUST BE COMPLETED FOR ALL WELLS EXCEPT HOME USE  
 TYPE OF PUMP INSTALLED PLACE (A,C,J,P,R,S,T,O) IN BOX - SEE ABOVE:  
 CAPACITY: GALLONS PER MINUTE (to nearest gallon) \_\_\_\_\_  
 PUMP HORSE POWER \_\_\_\_\_  
 PUMP COLUMN LENGTH (nearest ft.) \_\_\_\_\_  
 CASING HEIGHT (circle appropriate box and enter casing height)  
 + above } LAND SURFACE  
 - below } 2 (nearest foot)

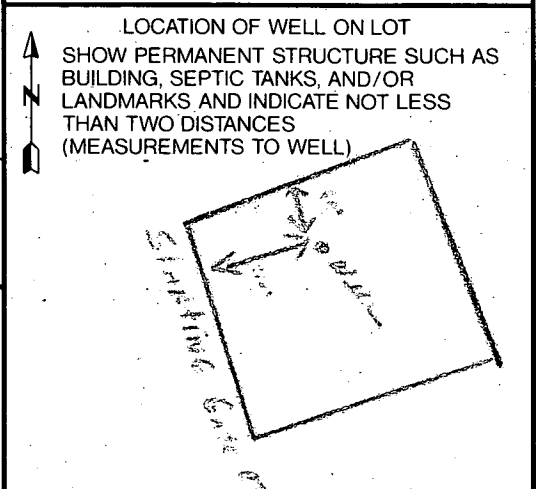

COUNTY

**Plumbing,  
Heating &  
Supplies, INC.**

40 JOHN STREET WESTMINSTER, MARYLAND 21157  
(410) 848-5300 FAX #(410) 876-6766 (410) 876-2622

March 15, 1995

Mr. and Mrs. Anderson  
3208 Starting Gate Court  
Woodbine, MD 21797

Re: Reverse Osmosis

Dear Mr. and Mrs. Anderson:

Plumbing, Heating & Supplies, Inc. will service and replace the cartridges in your Reverse Osmosis Filter, Model #LPROA2725055 for a period of one year from the above date.

If you have any questions, please contact me at this office.

Very truly yours,

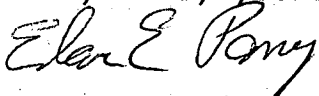

Edgar E. Parry,  
Contract Manager



---

## HOWARD COUNTY HEALTH DEPARTMENT

---

*Joyce M. Boyd, M.D., County Health Officer*

March 16, 1995

Martin II, Inc.  
4219 Hanover Pike  
Manchester, Maryland 21102

RE: Cabin Branch Farm. Lot #3  
3208 Starting Gate Court  
Well Permit #HO-92-0207

Dear Sirs:

This to advise you that the septic system was installed, inspected and approved on February 15, 1995.

The water sample recently submitted for testing was free of coliform and fecal coliform bacteria at the time of sampling and is bacteriologically safe for drinking.

The nitrate sample result was previously documented to be 11.9 ppm. A nitrate device has been installed to treat the excessive nitrate contamination. The nitrate treatment device appears to operating properly as evidenced by the water sample taken March 15, 1995.

COMAR 26.04.04.09 prohibits approval of any water supply with a nitrate-nitrogen contaminant level in excess of 10 parts per million. This department will grant a permanent deviation to that section of the regulation on condition that the nitrate removal system effectively maintains the nitrate-nitrogen contaminant level below the 10 parts per million requirement.

Furthermore, it will be necessary for you to comply with the following conditions:

1. The system must be properly operated and maintained continuously in accordance with the service contract for the life of the residence. You must supply this department with a copy of that contract.
2. It is recommended that a yearly nitrate analysis be performed.
3. If you decide to sell or rent your home in the future, you must make any potential buyer/tenant aware of the above condition.

LOT 3 CABIN BRANCH FARM

INV. OUT OF HSE - 570.08  
 INV. INTO TANK - 569.58  
 INV. OUT OF TANK - 569.25  
 INV INTO BOX - 569  
 INV. INTO TRENCH - 568.5

WELL - 580

MAINTAIN 20' BETWEEN  
 HSE & FIELDS

TWO TRENCHES OF EQUAL  
 DISTANCE TO BE DETERMINED

EXISTING GRADE @

TANK - 573  
 BOX - 571.50  
 TRENCH - 571.50

QUEST.  
 BILL COLEMAN  
 239 8330

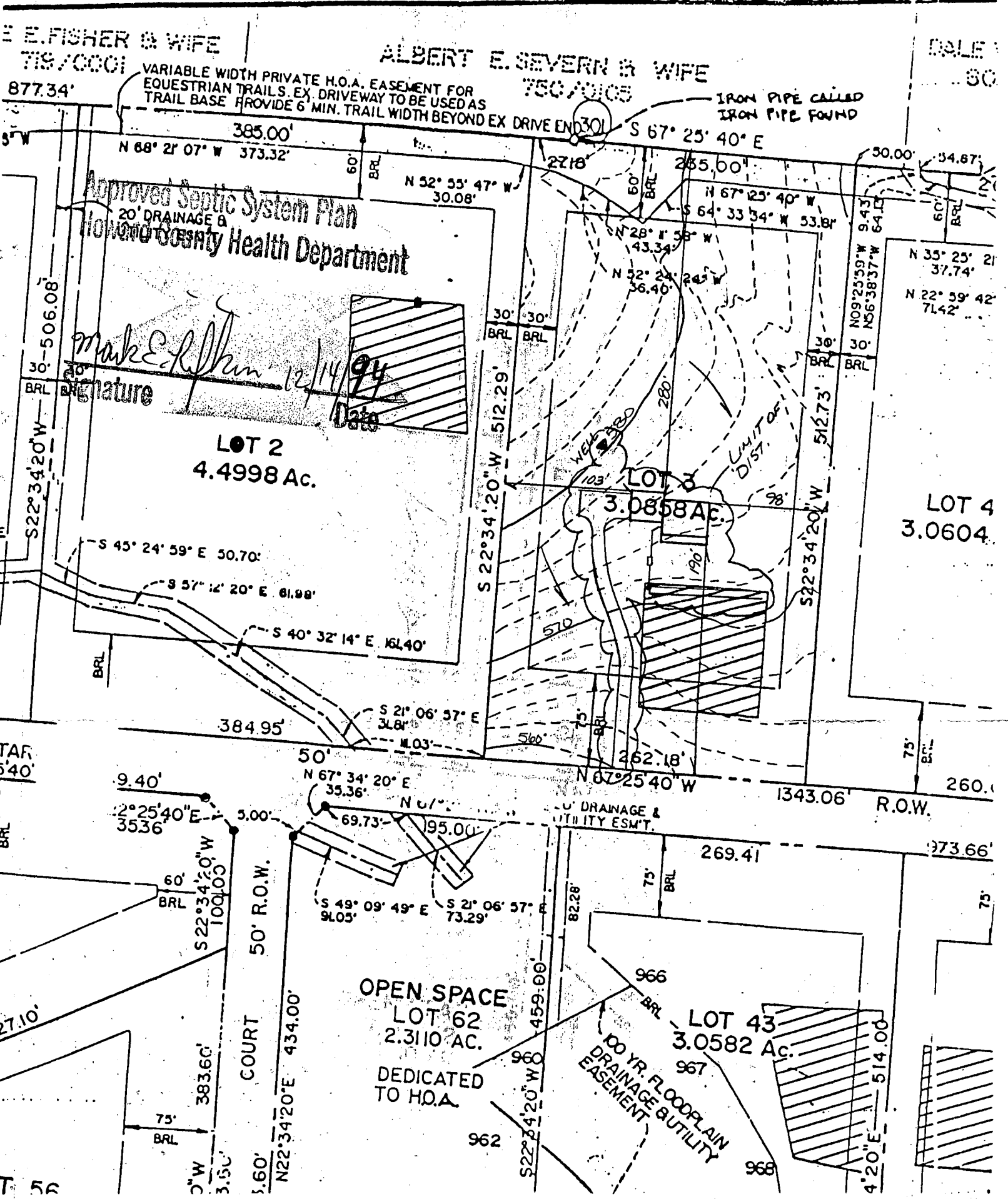
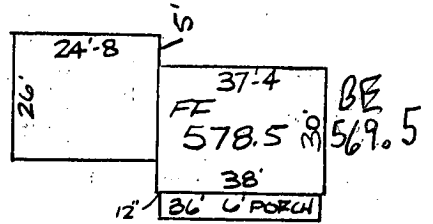



BP Amendment

KN

May 9, 2003

Dear Ms. Corbin,

~~BOO141736-A~~

I am submitting a modification to my building permit number 141736. I am changing the dimensions of the deck from 14' x 18' w/ stairs to 16' x 20' w/ stairs. Enclosed are four new plot plans and a check for \$25.00. All other parts of the permit submission remain the same.

Thank You

CABIN BRANCH, LOT 3

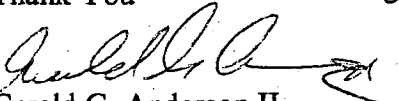
  
Gerald G. Anderson II  
3208 Starting Gate Ct.  
Woodbine, MD 21797  
410-489-4124 Home  
703-604-1507 Work

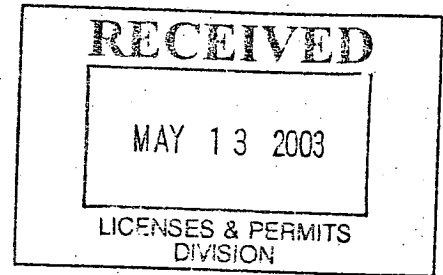

5-19-03 OK



2003 MAY 14 PM 4:16

CC: P + Z  
Walter  
Plans Review

CR # 23629  
CR # 2823

