

11/2/88 EMLEY AM  
12/5/88

TR # 04331621

# PERMIT

P 42789

SEWAGE DISPOSAL SYSTEM

A REPAIR

MARYLAND STATE DEPARTMENT OF HEALTH

DISTRICT 45

HOWARD COUNTY  
BUREAU OF ENVIRONMENTAL HEALTH  
461-9933

DATE 10/14/88

## INDEXED

DATE SYSTEM APPROVED 12-5-88

INSPECTOR S. Abel

Arnold Backhoe & Septic Services, Inc. IS PERMITTED TO INSTALL \_\_\_\_\_ ALTER X

ADDRESS P. O. Box 15, Woodbine, Maryland 21797 PHONE 795-7873

SUBDIVISION \_\_\_\_\_ ROAD 15000 Old Frederick Rd LOT \_\_\_\_\_

PROPERTY OWNER Ms. Mary Zepp

ADDRESS \_\_\_\_\_

IF GARBAGE GRINDER IS USED INCREASE SEPTIC TANK CAPACITY BY 50% AND ABSORPTION AREA BY 22%.

GARBAGE GRINDER? YES \_\_\_\_\_ NO X

SEPTIC TANK CAPACITY 1200 GALLONS NUMBER OF BEDROOMS 4

REPAIR - CALL FOR INSPECTION WHEN GROUND IS OPENED UP SO SANITARIAN CAN RECOMMEND REPAIR.

11/2/88 Inlet 3' BOTTOM 9' 6" STONE (NOTE: Inlet of 4 maximum)

SET 1250 TANK 180 BR 180 x 4 = 720 + 6 120 LF

2 TRENCHES 120 IF 6" STONE

144 IF 5" STONE

START SYST AT Pore Holes - ABANDON CESS POOL S. Abel

PLANS APPROVED BY C. Williams DATE 10/13/88

COVER NO WORK UNTIL INSPECTED AND APPROVED.

NEITHER THE HOWARD COUNTY COUNCIL NOR THE HEALTH DEPARTMENT IS RESPONSIBLE FOR THE SUCCESSFUL OPERATION OF ANY SYSTEM.

NOTE: CLEANOUT REQUIRED EVERY 70 FEET OF SEWER LINE AND/OR AT 90° SWEEPS IN LINES FROM HOUSE TO DRAIN FIELDS.

NOTE: ALL PARTS OF SEPTIC SYSTEMS (I.E., TANK, DISTRIBUTION BOX, TRENCHES) TO BE 100 FEET FROM WELL. (UNLESS OTHERWISE SPECIFICALLY AUTHORIZED)

NOTE: IF DEEP TRENCHES ARE USED CALL FOR INSPECTION BEFORE AND AFTER PLACING GRAVEL IN TRENCHES.

NOTE: NO DRY WELL SHALL EXCEED 15 FOOT IN DIAMETER. NO ABSORPTION TRENCH TO EXCEED 100 FEET IN LENGTH.

NOTE: ALL PIPE FROM HOUSE TO SEPTIC TANK MUST BE CAST IRON OR SCHEDULE 40 PVC OR ABS.

PERMIT VOID AFTER TWO YEARS.

NOTE: INSTALL STAND PIPE ON SEPTIC TANK AND DRY WELL. STAND PIPES MUST BE 6 INCHES IN DIAMETER. CAST IRON, CONCRETE OR TERRA COTTA OR PVC OR ABS ACCEPTED. IF TOP OF SEPTIC TANK IS DEEPER THAN 3 FEET, MANHOLE TO GRADE REQUIRED.

NOTE: DISTRIBUTION BOXES MUST HAVE BAFFLES.

**\*INSTALLER IS RESPONSIBLE FOR OBTAINING FINAL APROVAL ON THIS PERMIT**

\*CALL 461-9933 FOR INSPECTION OF SEPTIC SYSTEMS.

EH - 2-1186

12-20789

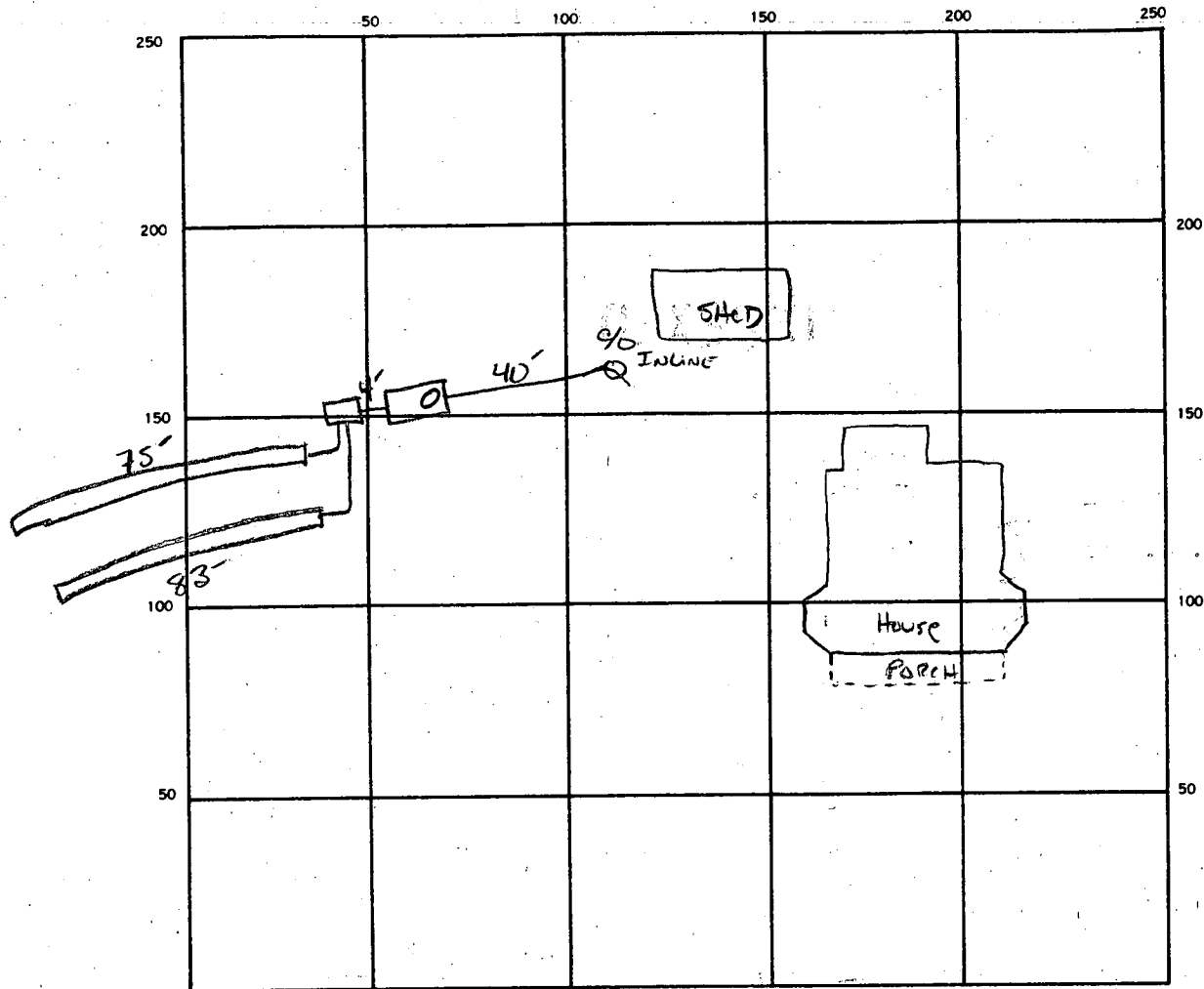

INDICATE NORTH. — NAME ADJOINING ROADWAY AS BASE LINE.  
 OLD FREDERICK Rd.

SEPTIC TANK. LEVEL ✓ 1250 GAL CLEANOUTS ✓ ST + INLINE

DISTRIBUTION BOX. LEVEL ✓

DRAIN FIELD/TILE FIELD. DEPTH 9 FT. TRENCH WIDTH 2 FT. INLET DEPTH 4-5 FT.

EFFECTIVE GRAVEL DEPTH 4.5-5 FT. TOTAL LENGTH RF 158 FT.

NUMBER OF TRENCHES 2 ONE SIDEWALL / BOTTOM AREA 750<sup>±</sup> SQ. FT.

DRYWELL INSIDE DIAMETER — FT. EFFECTIVE DEPTH BELOW INLET — FT.

ABSORBENT AREA 750<sup>±</sup> SQ. FT.

REMARKS \_\_\_\_\_  
 \_\_\_\_\_  
 \_\_\_\_\_  
 \_\_\_\_\_  
 \_\_\_\_\_

DATE SYSTEM APPROVED 12-5-88 INSPECTOR S. Abel

# APPLICATION

PERCOLATION TESTING

HOWARD COUNTY HEALTH DEPARTMENT  
BUREAU OF ENVIRONMENTAL HEALTH  
P.O. BOX 476 ELLICOTT CITY, MARYLAND 21043  
TELEPHONE: 461-9933

A Requis

P 42789

DISTRICT 4TH

DATE 10/14/88

TO: THE COUNTY HEALTH OFFICER  
ELLICOTT CITY, MARYLAND

I, HEREBY, APPLY FOR THE NECESSARY TEST IN ORDER TO CONSTRUCT (OR RECONSTRUCT) A SEWAGE DISPOSAL SYSTEM.

PROPERTY OWNER ZEPP, MARY

ADDRESS 15000 Old Frederick Rd PHONE \_\_\_\_\_

PROSPECTIVE BUYER \_\_\_\_\_

ADDRESS \_\_\_\_\_ PHONE \_\_\_\_\_

PROPERTY LOCATION:

SUBDIVISION \_\_\_\_\_ LOT NO. \_\_\_\_\_

ROAD AND DESCRIPTION \_\_\_\_\_

TAX MAP \_\_\_\_\_ PARCEL # \_\_\_\_\_

SIZE OF LOT \_\_\_\_\_ TYPE BLDG. EXISTING SFD  
(SINGLE FAMILY DWELLING OR COMMERCIAL)

THE SYSTEM INSTALLED UNDER THIS APPLICATION IS ACCEPTABLE ONLY UNTIL PUBLIC FACILITIES BECOME AVAILABLE. I FULLY UNDERSTAND THE FEE CONNECTED WITH THE FILING OF THIS PERC TEST APPLICATION IS NON-REFUNDABLE UNDER ANY CIRCUMSTANCES. I ALSO AGREE TO COMPLY WITH ALL M.O.S.H.A. REQUIREMENTS IN TESTING THIS LOT.

(SIGNATURE OF APPLICANT)

APPROVED BY \_\_\_\_\_ FOR \_\_\_\_\_ DATE \_\_\_\_\_

REJECTED BY \_\_\_\_\_ FOR \_\_\_\_\_ DATE \_\_\_\_\_

HOLD PENDING FURTHER TESTS \_\_\_\_\_ DATE \_\_\_\_\_

REASONS FOR REJECTION OR HOLDING \_\_\_\_\_

HD-216

# THIS IS NOT A PERMIT

① ②  
SOIL PROFILE

0  
5' 11" AP  
Yellow Red  
(Pinkish)  
silt loam  
c 10% Frag  
2.5'  
Layering  
or yellow B  
(Pinkish)  
Red B<sub>1</sub>  
silt loam  
10-25%  
Frag  
16'

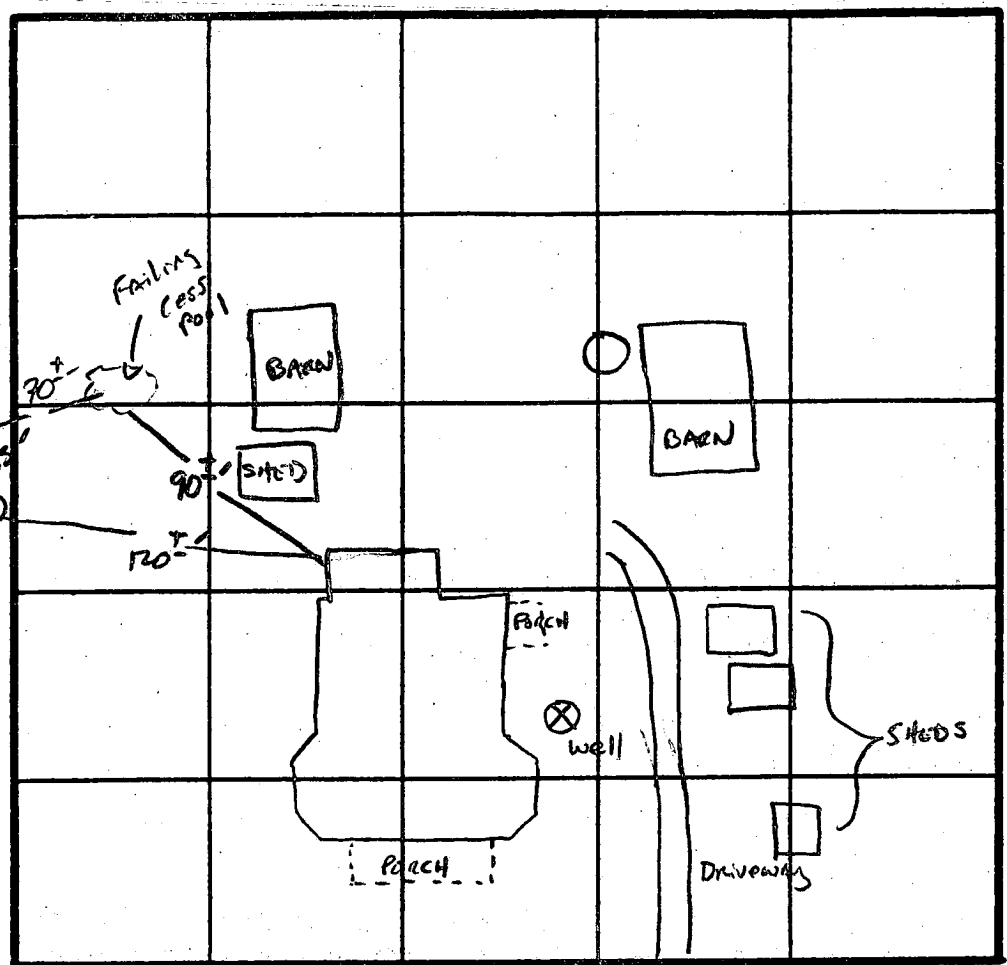

INDICATE NORTH - NAME ADJOINING ROADWAY AS BASE LINE.  
OLD Frederick Rd.

DATE	TEST NO.	DEPTH	PRE-WET		TEST - 1" DROP		TIME
			START	STOP	START	STOP	
11/2/88	1+2	As profiled					

REMARKS \_\_\_\_\_

TYPE OF SOIL Clendy

TESTED BY S. Mue ALSO PRESENT \_\_\_\_\_