

PUB. SEWER STATUS VERIFIED BY \_\_\_\_\_

ISSUE DATE: 01/30/06

P 523988

APPROVAL DATE: 2/1/06

A REPAIR

**PERMIT  
INDEXED**

Tax ID # 05-357799

**ON-SITE SEWAGE DISPOSAL SYSTEM  
HOWARD COUNTY HEALTH DEPARTMENT  
BUREAU OF ENVIRONMENTAL HEALTH**

Hatfields Equipment IS PERMITTED TO INSTALL  ALTER

ADDRESS: PO Box 519 Annapolis Junction, MD 20701 PHONE NUMBER: 301-854-6172

SUBDIVISION: Hemlock Hills LOT NUMBER: 21

ADDRESS: 12935 Byefield Road PROPERTY OWNER: Jean Lloyd

SEPTIC TANK CAPACITY (GALLONS): \_\_\_\_\_

PUMP CHAMBER CAPACITY (GALLONS): N/A

NUMBER OF BEDROOMS: 4

SQUARE FEET PER BEDROOM: 180

LINEAR FEET OF TRENCH REQUIRED: 86' or as much possible in 2 short trenches

*Inlet 4'  
Bottom 11'  
Trenches 2' wide*

TRENCHES:	Trench to be _____ feet wide. Inlet _____ feet below original grade. Bottom maximum depth _____ feet below original grade. Effective area begins at _____ feet below original grade. _____ feet of stone below distribution pipe.
LOCATION:	
PURPOSE:	Existing septic system has failed. Call for inspection when ground is opened so sanitarian can recommend repair.

PLANS APPROVED: \_\_\_\_\_ DATE: \_\_\_\_\_

- NOTE: PERMIT VOID AFTER 2 YEARS
- NOTE: CONTRACTOR RESPONSIBLE FOR SCHEDULING A PRE-CONSTRUCTION INSPECTION FOR ALL INSTALLATIONS
- NOTE: WATERTIGHT SEPTIC TANKS REQUIRED
- NOTE: ALL PARTS OF SEPTIC SYSTEM SHALL BE 100 FEET FROM ANY WATER WELL
- NOTE: MANHOLE RISERS REQUIRED ON ALL SEPTIC TANKS AND PUMP CHAMBERS

**NEITHER THE HOWARD COUNTY COUNCIL OR THE HEALTH DEPARTMENT IS RESPONSIBLE FOR THE SUCCESSFUL OPERATION OF ANY SYSTEM PERMITTEE RESPONSIBLE FOR OBTAINING FINAL APPROVAL ON THIS PERMIT CALL 410-313-2640 FOR INSPECTION OF SEPTIC SYSTEM.**

*Please add to scan file*

05 23488

NOT TO SCALE

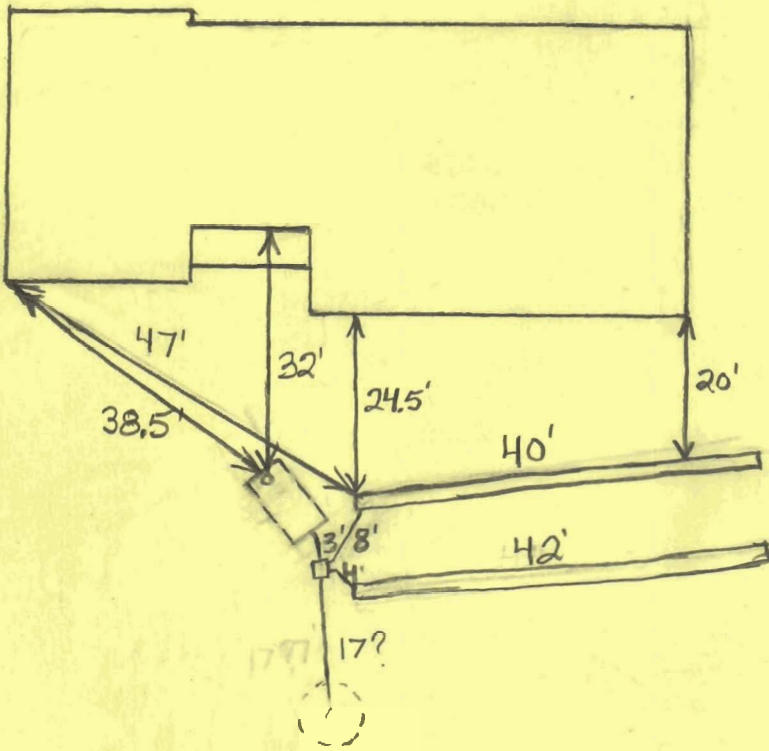

TRENCH/DRAINFIELD DATA		
WIDTH	INLET	BOTTOM
2'	3.5'	10.5'
NUMBER OF TRENCHES		2
TOTAL LENGTH		82'
ABSORPTION AREA		574
DISTRIBUTION BOX LEVEL		Levelers
DISTRIBUTION BOX BAFFLE		Yes
DISTRIBUTION BOX PORT		Yes

SEPTIC TANK DATA	
SEPTIC TANK 1 LEVEL	Yes
CAPACITY	Existing GAL
SEAM LOC	Midseam
TANK LID DEPTH	1-2
BAFFLES	New Rear Baffle
BAFFLE FILTER	No
MANHOLE LOC	Rear
6" PORT LOC	Front
WATERTIGHT TEST	No
SEPTIC TANK 2 LEVEL	N/A
CAPACITY	_____ GAL
SEAM LOC	_____
TANK LID DEPTH	_____
BAFFLES	_____
BAFFLE FILTER	_____
MANHOLE LOC	_____
6" PORT LOC	_____
WATERTIGHT TEST	_____

PRE-CONSTRUCTION 1/31/06 Install 2 short 40'-45' trenches on contour as close to the house as practical. Set a distribution box near the existing septic tank. O.K. to pump out and fill drywell with gravel. (BB)

INSTALLATION 2/1/06 Drywell pumped out and filled with gravel. Trenches installed. O.K. to cover everything. (BB)

FINAL INSPECTOR B. Baker

DATE OF APPROVAL 2/1/06