

TAX# 04325613

COMMERCIAL

PUB. SEWER STATUS VERIFIED BY _____

ISSUE DATE: _____

P _____

APPROVAL DATE: 5/16/02

A 42713

PERMIT

INDEXED

ON-SITE SEWAGE DISPOSAL SYSTEM HOWARD COUNTY HEALTH DEPARTMENT BUREAU OF ENVIRONMENTAL HEALTH

_____ IS PERMITTED TO INSTALL ALTER

ADDRESS: _____ PHONE NUMBER: _____

SUBDIVISION: _____ LOT NUMBER: _____

ADDRESS: 2960 Route 97 PROPERTY OWNER: Trusted Info Systems

SEPTIC TANK CAPACITY (GALLONS): _____

PUMP CHAMBER CAPACITY (GALLONS): _____

NUMBER OF BEDROOMS: _____

SQUARE FEET PER BEDROOM: _____

LINEAR FEET OF TRENCH REQUIRED: _____

TRENCHES:	Trench to be _____ feet wide. Inlet _____ feet below original grade. Bottom maximum depth _____ feet below original grade. Effective area begins at _____ feet below original grade. _____ feet of stone below distribution pipe.
LOCATION:	_____
PURPOSE:	THE REST OF THE FILE IS MISSING AS OF 12/31/2002

PLANS APPROVED: _____ DATE: _____

- NOTE: PERMIT VOID AFTER 2 YEARS
- NOTE: CONTRACTOR RESPONSIBLE FOR SCHEDULING A PRE-CONSTRUCTION INSPECTION FOR ALL INSTALLATIONS
- NOTE: WATERTIGHT SEPTIC TANKS REQUIRED
- NOTE: ALL PARTS OF SEPTIC SYSTEM SHALL BE 100 FEET FROM ANY WATER WELL
- NOTE: MANHOLE RISERS REQUIRED ON ALL SEPTIC TANKS AND PUMP CHAMBERS

NEITHER THE HOWARD COUNTY COUNCIL NOR THE HEALTH DEPARTMENT IS RESPONSIBLE FOR THE SUCCESSFUL OPERATION OF ANY SYSTEM PERMITTEE RESPONSIBLE FOR OBTAINING FINAL APPROVAL ON THIS PERMIT CALL 410-313-2640 FOR INSPECTION OF SEPTIC SYSTEM

442713

NOT TO SCALE

TRENCH/DRAINFIELD DATA		
WIDTH	INLET	BOTTOM
_____	_____	_____
NUMBER OF TRENCHES _____		
TOTAL LENGTH _____		
ABSORPTION AREA _____		
DISTRIBUTION BOX LEVEL _____		
DISTRIBUTION BOX BAFFLE _____		
DISTRIBUTION BOX PORT _____		

SEPTIC TANK DATA	
SEPTIC TANK 1 LEVEL _____	
CAPACITY _____	GAL
SEAM LOC _____	
TANK LID DEPTH _____	
BAFFLES _____	
BAFFLE FILTER _____	
MANHOLE LOC _____	
6" PORT LOC _____	
WATERTIGHT TEST _____	
SEPTIC TANK 2 LEVEL _____	
CAPACITY _____	GAL
SEAM LOC _____	
TANK LID DEPTH _____	
BAFFLES _____	
BAFFLE FILTER _____	
MANHOLE LOC _____	
6" PORT LOC _____	
WATERTIGHT TEST _____	

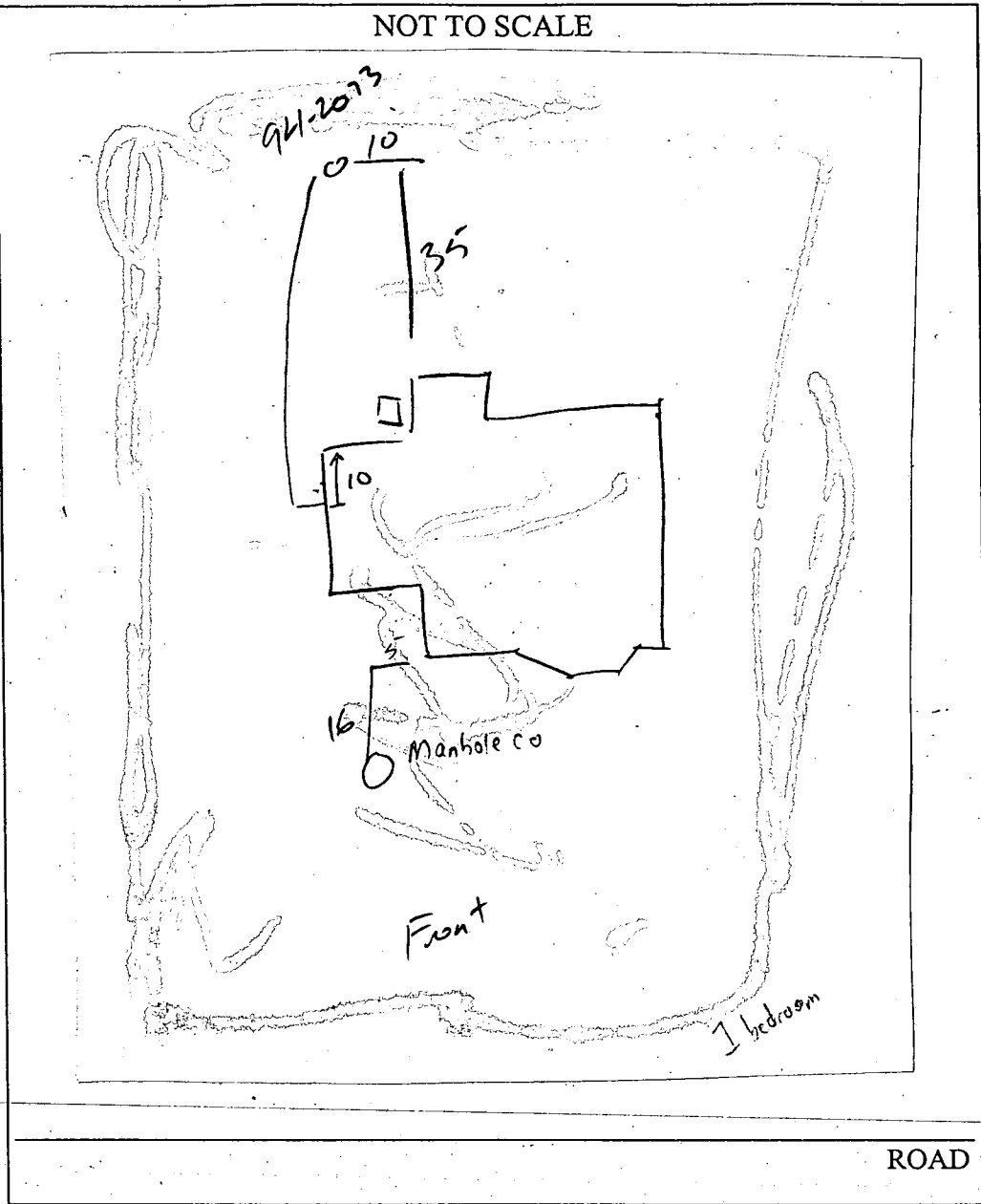

PRE-CONSTRUCTION _____

INSTALLATION _____

FINAL INSPECTOR _____ DATE OF APPROVAL _____

5/16/02

11:00 - 12:00

HOWARD COUNTY HEALTH DEPARTMENT
BUREAU OF ENVIRONMENTAL HEALTH
WATER AND SEWERAGE PROGRAM
TEL: (410)313-2640 FAX: (410)313-2648

Information Form for the Installation of the Well Pump, Pitless Adapter, and Supply Piping

NOTE: The installer is responsible for requesting an inspection prior to 9 am on the day of the desired inspection. No work is to be covered until approved by the Health Department. All installations must comply with the National Standard Plumbing Code (NSPC, as amended locally) and COMAR 26.04.04 (MD Well Construction Regulations). Submission of a complete form is required prior to Use and Occupancy approval.

Company Name: _____ Telephone #: _____
Address: _____

(Must circle one) Licensed Plumber Licensed Well Driller Licensed Well Pump Installer

License # and name of individual responsible for the field installation:

Name (Print): _____ License# _____

***A licensed individual must perform the actual installation. Apprentices must be under the direct supervision of a licensed journeyman or master plumber, pump installer or well driller. Licenses may be subjected to field verification.**

Name of Property Owner: _____ Telephone #: _____
Subdivision: _____ Lot #: _____ Well Tag #: HO 94 - 2073
Site Address: 2960 Route 97

Submersible Pump Data

Make: _____
Model #: _____
Pump Capacity _____ GPM
Well Yield: _____ GPM

Pitless Adapter

Make: _____
Model#: _____
Depth: _____ (36" min)
NSF approved: _____

Well Cap and Electric Conduit

Two piece watertight cap: _____
Screened, vented well cap: _____
Cap secured to casing: _____
Conduit min 18" B.G.: _____
Conduit secured to well cap: _____

Depth of well encountered at time of pump installation: _____ (feet)

If pump capacity exceeds well yield, a low water cut off switch is required by NSPC 1990 Section 17.8.4

Torque arrestors or Cable guards are required - Must circle one

Safety rope, if used, attached to inside of well casing with eye bolt _____

Piping to house

Type: _____
PSI: _____ (160 psi min)
Depth of supply line: _____ (36" min)

House Connection

PVC sleeved to undisturbed soil at wall penetration: _____
Approximate length of sleeve: _____
Sleeve caulked and sealed properly: _____

The water supply line is required to be at least ten feet from the septic tank, pump chamber, sewage piping, distribution box, drainfields, and sewage reserve area. If this cannot be accomplished, contact this office for approval prior to installation.

Signature of company representative responsible for installation _____ date _____

For Health Department Use Only - Not to be completed by Installer

Date Insp. Requested: 5/16/02 Date Insp. Approved: 5/16/02 SR/SRK
Inspection Data: Pitless adapter and water supply line at least 36" below grade _____
Two piece cap installed and attached to casing securely _____
Elec. conduit extends at least 18" below grade/attached to cap properly _____
Safety rope installed inside of well casing _____
Correct well tag attached properly and casing 8" above finished grade _____
Water supply line sleeved adequately at house connection _____
Adequate grout observed below pitless adapter _____