

4/16/88 ASA P

# PERMIT

SEWAGE DISPOSAL SYSTEM

MARYLAND STATE DEPARTMENT OF HEALTH

HOWARD COUNTY  
BUREAU OF ENVIRONMENTAL HEALTH  
461-9933

05-347386

P 41928

A REPAIR

DISTRICT \_\_\_\_\_

DATE 4/10/88

DATE SYSTEM APPROVED 4/6/88

INSPECTOR C. Williams

## INDEXED

Jack Fuock IS PERMITTED TO INSTALL \_\_\_\_\_ ALTER X

ADDRESS \_\_\_\_\_ PHONE 988-9270

SUBDIVISION \_\_\_\_\_ ROAD 7406 Cherry Tree Drive LOT \_\_\_\_\_

PROPERTY OWNER Leonard Mandozzi  
7406 Cherry Tree Drive

ADDRESS \_\_\_\_\_

IF GARBAGE GRINDER IS USED INCREASE SEPTIC TANK CAPACITY BY 50% AND ABSORPTION AREA BY 22%. 125  
5

GARBAGE GRINDER? YES \_\_\_\_\_ NO X NO TANK REPLACEMENT

SEPTIC TANK CAPACITY 1500 GALLONS NUMBER OF BEDROOMS 5 THIS PERMIT

CURRENTLY HOUSE HAS 3 BEDROOMS - will be adding 2 BEDROOMS.

REPAIR - CALL FOR INSPECTION WHEN GROUND IS OPENED UP SO SANITARIAN CAN RECOMMEND REPAIR.

ADD TRENCH OFF DW WITH SUFFICIENT

TEST TO ESTABLISH SUFFICIENT REPAIR AREA FOR 2 BR ADDITION. CW.

AREA FOR 5 BR. (625 SQ FT BETWEEN  
3 FT & 14 FT depth off old DW)

PLANS APPROVED BY C. Williams DATE 3/31/88

- COVER NO WORK UNTIL INSPECTED AND APPROVED.
- NEITHER THE HOWARD COUNTY COUNCIL NOR THE HEALTH DEPARTMENT IS RESPONSIBLE FOR THE SUCCESSFUL OPERATION OF ANY SYSTEM.
- NOTE: CLEANOUT REQUIRED EVERY 70 FEET OF SEWER LINE AND/OR AT 90° SWEEPS IN LINES FROM HOUSE TO DRAIN FIELDS.
- NOTE: ALL PARTS OF SEPTIC SYSTEMS (I.E., TANK, DISTRIBUTION BOX, TRENCHES) TO BE 100 FEET FROM WELL. (UNLESS OTHERWISE SPECIFICALLY AUTHORIZED)
- NOTE: IF DEEP TRENCH(IES) ARE USED CALL FOR INSPECTION BEFORE AND AFTER PLACING GRAVEL IN TRENCH(IES).
- NOTE: NO DRY WELL SHALL EXCEED 15 FOOT IN DIAMETER. NO ABSORPTION TRENCH TO EXCEED 100 FEET IN LENGTH.
- NOTE: ALL PIPE FROM HOUSE TO SEPTIC TANK MUST BE CAST IRON OR SCHEDULE 40 PVC OR ABS.
- PERMIT VOID AFTER TWO YEARS.
- NOTE: INSTALL STAND PIPE ON SEPTIC TANK AND DRY WELL. STAND PIPES MUST BE 6 INCHES IN DIAMETER. CAST IRON, CONCRETE OR TERRA COTTA OR PVC OR ABS ACCEPTED. IF TOP OF SEPTIC TANK IS DEEPER THAN 3 FEET, MANHOLE TO GRADE REQUIRED.
- NOTE: DISTRIBUTION BOXES MUST HAVE BAFFLES.

**\*INSTALLER IS RESPONSIBLE FOR OBTAINING FINAL APPROVAL ON THIS PERMIT**

\*CALL 461-9933 FOR INSPECTION OF SEPTIC SYSTEMS.

EH - 2-1186

P 41928

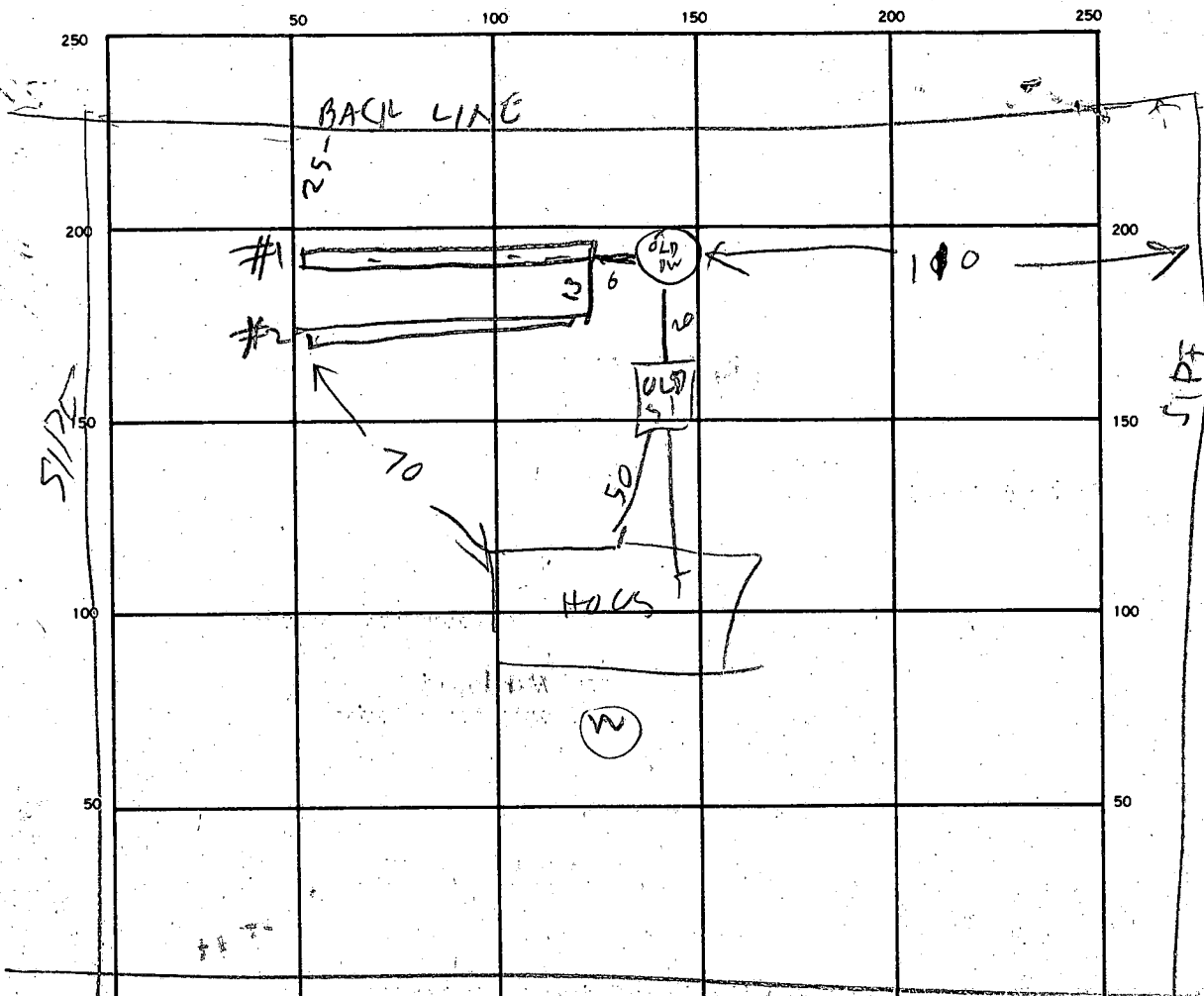

RECENT REPAIR JOB DONE ON BACK OF ADJOINING LOT

INDICATE NORTH - NAME ADJOINING ROADWAY AS BASE LINE  
CHERRY TREE DRIVE

SEPTIC TANK. LEVEL \_\_\_\_\_ CLEANOUTS \_\_\_\_\_

DISTRIBUTION BOX. LEVEL \_\_\_\_\_

DRAIN FIELD/TILE FIELD. DEPTH  $\frac{12}{11}$  FT. TRENCH WIDTH  $\frac{12}{2}$  FT. INLET DEPTH  $\frac{12}{4.5}$  FT.

EFFECTIVE GRAVEL DEPTH  $\frac{6}{6}$  FT. TOTAL LENGTH  $\frac{65}{65}$  FT.

NUMBER OF TRENCHES 2 ONE SIDEWALL/BOTTOM AREA 780 SQ. FT.

DRYWELL INSIDE DIAMETER \_\_\_\_\_ FT. EFFECTIVE DEPTH BELOW INLET \_\_\_\_\_ FT.

ABSORBENT AREA \_\_\_\_\_ SQ. FT.

130  
6  
780  
5  
125  
5  
5

REMARKS 4/6/88 PLENTY OF FUTURE REPAIR AREA EXISTING TANK IS TOO SMALL FOR SBR HOUSE. ANOTHER TANK TO BE ADDED LATER WHEN ADDITION MADE

DATE SYSTEM APPROVED 4/6/88 INSPECTOR CW...

12/11/59  
ck out  
Monday Morning

approved  
P 01813  
A 01652

# PERMIT

SEWAGE DISPOSAL SYSTEM

MARYLAND STATE DEPARTMENT OF HEALTH

HOWARD COUNTY

ELLICOTT CITY

DISTRICT 5

DATE 10/15/59

**INDEXED**

Tattrie & Levy Cons. Co.

IS PERMITTED TO INSTALL  ALTER

ADDRESS Simpsonville

PHONE Atlas 6-3241

A SEWAGE DISPOSAL SYSTEM LOCATED AT

SUBDIVISION Hopkins Meade

ROAD

~~Onkexentix~~

LOT 19, Sec. 3.

PROPERTY OWNER Nuhn

ADDRESS

SPECIFICATIONS

DRAIN FIELD DEPTH FEET, BOTTOM AREA SQ. FT.

SEEPAGE PITS  ABSORBENT SIDE-WALL AREA 324 SQ. FT. below top 3 ft. of clay

SEPTIC TANK CAPACITY 750 GALLONS

FOR GARBAGE GRINDER, INCREASE DISPOSAL AREA 22% & TANK CAPACITY 50%.

OTHER Place the dry well in back of the house about 50 - 75 ft.

System must be installed in area that passed perc. test.

PLANS APPROVED BY Raymond Hodges

DATE 7/15/59

FILL SEPTIC TANK AND DISTRIBUTION BOX WITH WATER BEFORE CALLING FOR AN INSPECTION. COVER NO WORK UNTIL INSPECTED AND APPROVED.

NEITHER THE HOWARD COUNTY COMMISSIONERS NOR THE HEALTH DEPARTMENT IS RESPONSIBLE FOR THE SUCCESSFUL OPERATION OF ANY SYSTEM.

A01652

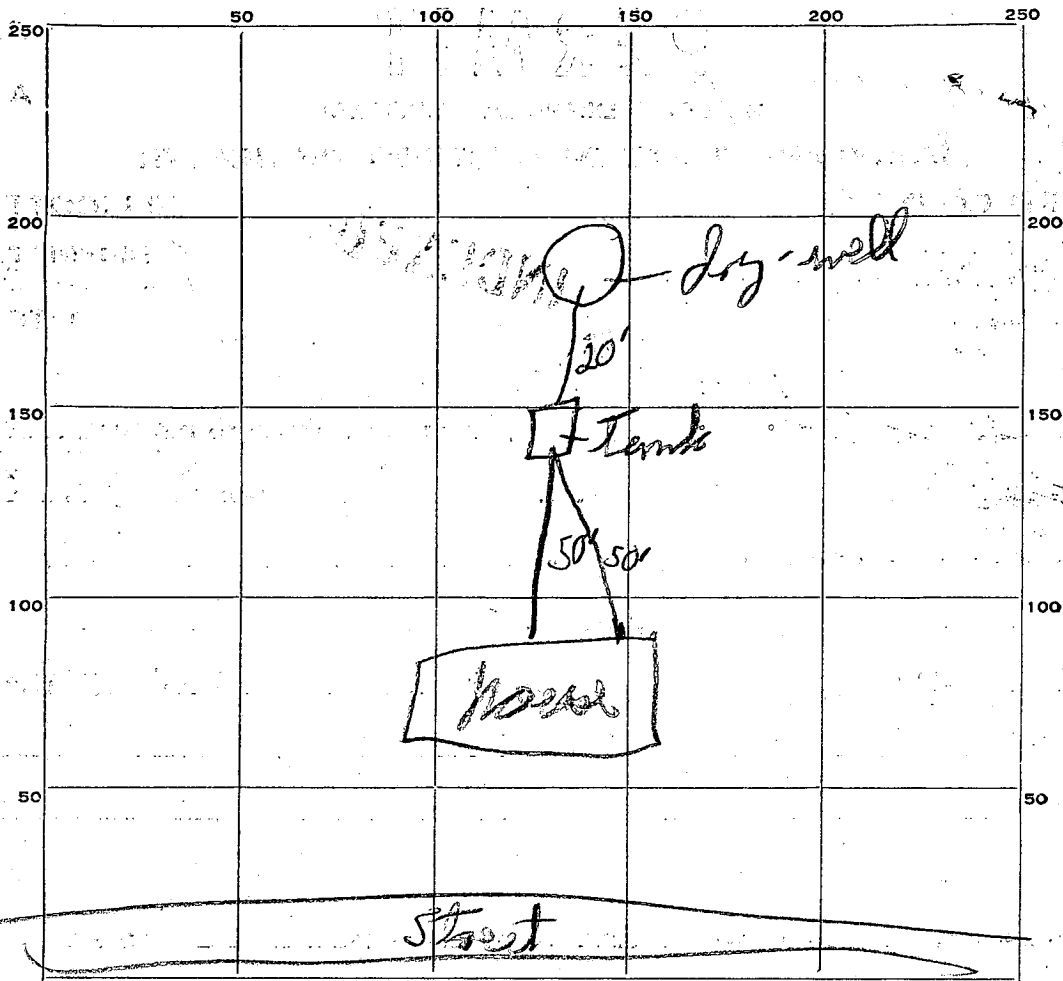

INDICATE NORTH. - NAME ADJOINING ROADWAY AS BASE LINE.

PERMIT CARD

SEPTIC TANK, LEVEL  CLEANOUTS

DISTRIBUTION BOX, LEVEL \_\_\_\_\_

TILE FIELD, DEPTH \_\_\_\_\_ FT. TRENCH WIDTH \_\_\_\_\_ FT.

GRAVEL DEPTH \_\_\_\_\_ IN. TOTAL LENGTH \_\_\_\_\_ FT.

NUMBER OF TRENCHES \_\_\_\_\_ TOTAL BOTTOM AREA \_\_\_\_\_

SEEPAGE PITS, INSIDE DIAMETER 10' FT. DEPTH BELOW INLET 12 FT.

ABSORBENT AREA 324+ SQ. FT.

REMARKS \_\_\_\_\_

\_\_\_\_\_

\_\_\_\_\_

\_\_\_\_\_

\_\_\_\_\_

DATE SYSTEM APPROVED 12/14/59 INSPECTOR D. W.

# APPLICATION

A 01652  
P 01813

SEWAGE DISPOSAL TESTING

MARYLAND STATE DEPARTMENT OF HEALTH

HOWARD COUNTY 750 Gallon Tank

ELLICOTT CITY

Dry Well - 324 sq ft sidewall area  
below Top 3" of Clay

DISTRICT 5

DATE 9/14/59

Builder - Jattre & Levy  
Atlas 6 - 3241

Place the dry well in back of the house  
about 50 - 75 ft

TO: THE COUNTY HEALTH OFFICER  
ELLICOTT CITY, MARYLAND

I, HEREBY, APPLY FOR THE NECESSARY TESTS IN ORDER TO CONSTRUCT (OR RECONSTRUCT) A SEWAGE DISPOSAL SYSTEM.

PROPERTY OWNER Juhn

ADDRESS \_\_\_\_\_

PHONE \_\_\_\_\_

PROPERTY LOCATION:

SUBDIVISION Hopkins Meade

LOT NO. 19 - Sec. 3

ROAD AND DESCRIPTION Doddle Mill Rd

OCCUPANT \_\_\_\_\_

PHONE \_\_\_\_\_

PERSON TO CONSTRUCT SYSTEM \_\_\_\_\_

ADDRESS \_\_\_\_\_

PHONE 3

SIZE OF LOT 1 acre

TYPE BLDG: \_\_\_\_\_

NUMBER OF BEDROOMS \_\_\_\_\_

IF NOT SINGLE RESIDENCE DESCRIBE \_\_\_\_\_

SIGNATURE OF APPLICANT Roy A. G. Jattre

APPROVED BY Raymond Hedges

FOR Dry Well

(KIND OF SYSTEM)

DATE 9/15/59

REJECTED BY \_\_\_\_\_

FOR \_\_\_\_\_

(KIND OF SYSTEM)

DATE \_\_\_\_\_

HOLD PENDING FURTHER TESTS \_\_\_\_\_

DATE \_\_\_\_\_

REASONS FOR REJECTION OR HOLDING \_\_\_\_\_

# THIS IS NOT A PERMIT

A01652

Lot #20

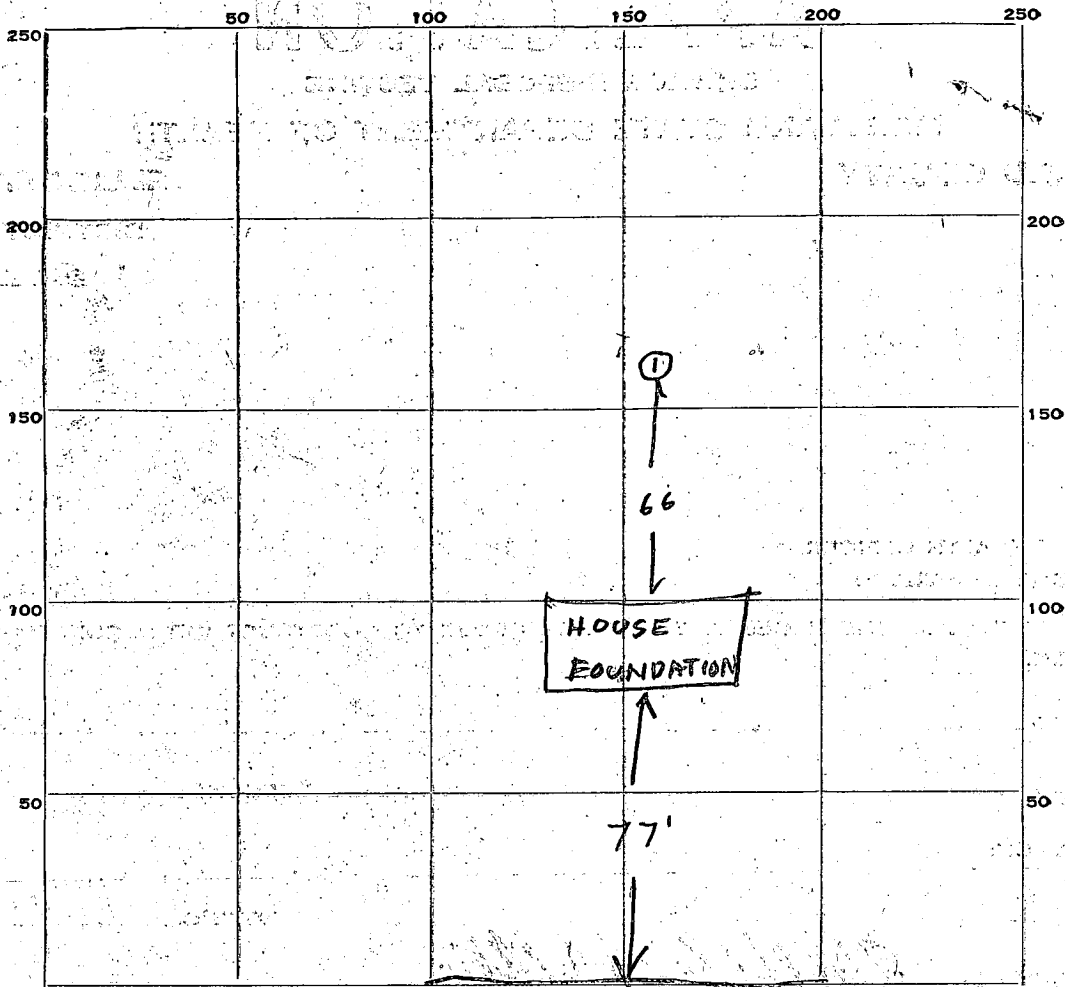

INDICATE NORTH. - NAME ADJOINING ROADWAY AS BASE LINE  
 DIAT RD TO OAK CREST LANE →

DATE	TEST NO.	DEPTH	PRE-WET		TEST - 1" DROP		TIME
			START	STOP	START	STOP	
9/15/59	1	11	9.49	9.53	9.53	10.03	10 min

SOIL AUGER FINDING Top 3' Bottom 8' clay sand mica  
 TESTED BY Raymond Hodges  
 REMARKS \_\_\_\_\_  
 ALSO PRESENT Rayl. G. Yattus LOT NO. 19 Sect 3