

4/26/88
11:10 o'clock

02-255278

PERMIT

SEWAGE DISPOSAL SYSTEM

MARYLAND STATE DEPARTMENT OF HEALTH

P 41927

A Repair

DISTRICT _____

DATE 4/10/88

DATE SYSTEM APPROVED 4/26/88

INSPECTOR C. Williams

HOWARD COUNTY
BUREAU OF ENVIRONMENTAL HEALTH
461-9933

INDEXED

Jack Fyock IS PERMITTED TO INSTALL _____ ALTER X

ADDRESS _____ PHONE 988-9270

SUBDIVISION _____ ROAD 4090 Old Columbia Pike LOT _____

PROPERTY OWNER _____ Ed Brush 24/18/1092
4090 Old Columbia Pike

ADDRESS _____

IF GARBAGE GRINDER IS USED INCREASE SEPTIC TANK CAPACITY BY 50% AND ABSORPTION AREA BY 22%.

GARBAGE GRINDER? YES _____ NO _____

SEPTIC TANK CAPACITY _____ GALLONS NUMBER OF BEDROOMS _____

REPAIR - CALL FOR INSPECTION WHEN GROUND IS OPENED UP SO SANITARIAN CAN RECOMMEND

REPAIR.

PLANS APPROVED BY C. Williams DATE 4/12/88

COVER NO WORK UNTIL INSPECTED AND APPROVED.

NEITHER THE HOWARD COUNTY COUNCIL NOR THE HEALTH DEPARTMENT IS RESPONSIBLE FOR THE SUCCESSFUL OPERATION OF ANY SYSTEM.

NOTE: CLEANOUT REQUIRED EVERY 70 FEET OF SEWER LINE AND/OR AT 90° SWEEPS IN LINES FROM HOUSE TO DRAIN FIELDS.

NOTE: ALL PARTS OF SEPTIC SYSTEMS (I.E., TANK, DISTRIBUTION BOX, TRENCHES) TO BE 100 FEET FROM WELL. (UNLESS OTHERWISE SPECIFICALLY AUTHORIZED)

NOTE: IF DEEP TRENCHES ARE USED CALL FOR INSPECTION BEFORE AND AFTER PLACING GRAVEL IN TRENCHES.

NOTE: NO DRY WELL SHALL EXCEED 15 FOOT IN DIAMETER. NO ABSORPTION TRENCH TO EXCEED 100 FEET IN LENGTH.

NOTE: ALL PIPE FROM HOUSE TO SEPTIC TANK MUST BE CAST IRON OR SCHEDULE 40 PVC OR ABS.

PERMIT VOID AFTER TWO YEARS.

NOTE: INSTALL STAND PIPE ON SEPTIC TANK AND DRY WELL. STAND PIPES MUST BE 6 INCHES IN DIAMETER. CAST IRON, CONCRETE OR TERRA COTTA OR PVC OR ABS ACCEPTED. IF TOP OF SEPTIC TANK IS DEEPER THAN 3 FEET, MANHOLE TO GRADE REQUIRED.

NOTE: DISTRIBUTION BOXES MUST HAVE BAFFLES.

***INSTALLER IS RESPONSIBLE FOR OBTAINING FINAL APROVAL ON THIS PERMIT**

*CALL 461-9933 FOR INSPECTION OF SEPTIC SYSTEMS.

EH - 2-1186

41927

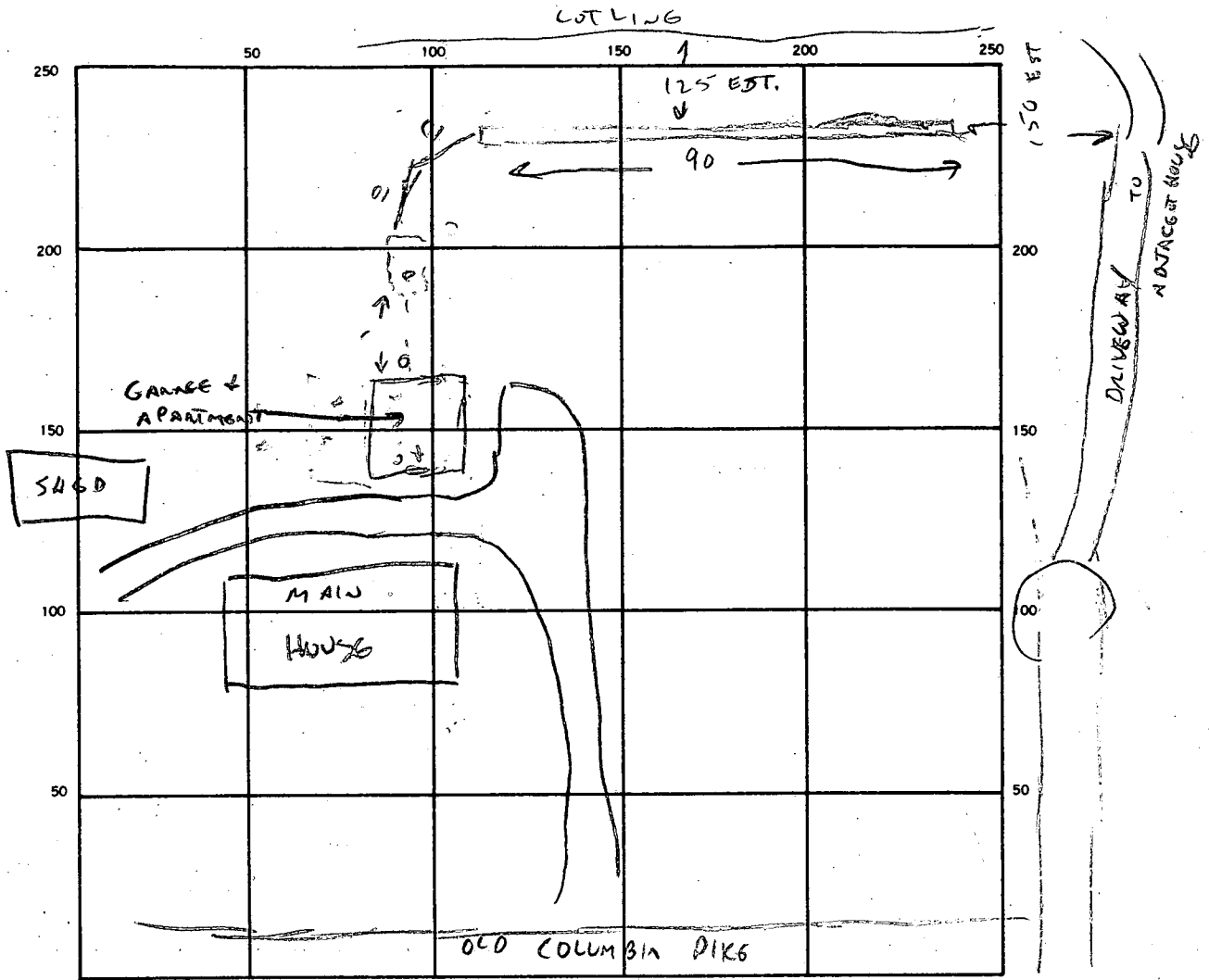

SEPTIC TANK LEVEL EXISTING CLEANOUTS ST. INLINE EXISTING

DISTRIBUTION BOX LEVEL _____

DRAIN FIELD/TILE FIELD. DEPTH 11 FT. TRENCH WIDTH 2 FT. INLET DEPTH 4 FT.

EFFECTIVE GRAVEL DEPTH 7 FT. TOTAL LENGTH 90 FT.

NUMBER OF TRENCHES 1 ONE SIDEWALL/BOTTOM AREA 630 SQ. FT.

DRYWELL INSIDE DIAMETER _____ FT. EFFECTIVE DEPTH BELOW INLET _____ FT.

ABSORBENT AREA 630 SQ. FT.

REMARKS PUBLIC SEWER - NOT ACCESSIBLE

OK TO INSTALL REPAIR TRENCH.

OK TO COVER 4/26/88 CW

DATE SYSTEM APPROVED 4/26/88 INSPECTOR C. Walker



ENGINEERING CONSULTING SERVICES, LTD.
 Geotechnical • Construction Materials • Environmental

February 12, 1998

Mr. Bert Nixon
 Howard County Health Department
 Bureau of Environmental Health
 3525 Ellicott Mills Drive, Unit H
 Ellicott City, Maryland 21043

*current
 owners name:
 Edward Brush*

*prior owner
 Warren Chestnut
 (check Joe Clark prep)
 ECS Project No. B1633A*

Reference: Proposed Assisted Living Facility, 4090 Old Columbia Pike, Ellicott City, Howard County, Maryland *Map 24 Grid 18 P. 1092*

Dear Mr. Nixon:

Engineering Consulting Services, Ltd. is currently performing an environmental investigation on the above-referenced site. As depicted on the enclosed Site Location Plan which also corresponds to (ADC Howard County map book page 11, grid 11-C and D), the project area is located on the northeastern corner of the intersection of Old Columbia Pike and Toll House Road, in the Ellicott City section of Howard County, Maryland. Based on the limits of the parcel, as depicted on an available survey, the project site is identified as 4090 Old Columbia Pike, and is currently occupied by a single family residence, owned by Mr. Edward Brush. The project site is located in the 21043 zip code area.

As part of our assessment, we are interested in obtaining any information your office may have pertaining to any existing under ground storage tanks and/or any known or documented incidents of surface spills associated with hazardous chemicals, pesticides or petroleum, or illegal dumping at the above-referenced site. In addition, we would also appreciate a review of your files pertaining to any known or documented incidents of UST leaks, surface spills associated with hazardous chemicals, pesticides or petroleum on adjacent or near by properties. Those properties we are interested all are located in Ellicott City (i.e. 21043) and are as follows.

PJ's Garage
 4214 Montgomery Road

Harry H. Witzke Funeral Home
 4112 Columbia Pike

*12/4/98
 Eco Dynamics now
 inquiring*