

5/16/88 ASAP

# PERMIT

SEWAGE DISPOSAL SYSTEM

MARYLAND STATE DEPARTMENT OF HEALTH

P 41922

A REPAIR

HOWARD COUNTY

BUREAU OF ENVIRONMENTAL HEALTH  
461-9933

05-379725

DISTRICT \_\_\_\_\_

DATE 4/10/88

DATE SYSTEM APPROVED 5/16/88

INSPECTOR RJL

## INDEXED

Jack Fyock

IS PERMITTED TO INSTALL \_\_\_\_\_ ALTER 20

ADDRESS \_\_\_\_\_ PHONE \_\_\_\_\_

SUBDIVISION \_\_\_\_\_ ROAD 13483 Brighton Dam LOT 9

PROPERTY OWNER Robert Semmell  
13483 Brighton Dam Road

ADDRESS \_\_\_\_\_

IF GARBAGE GRINDER IS USED INCREASE SEPTIC TANK CAPACITY BY 50% AND ABSORPTION AREA BY 22%.

GARBAGE GRINDER? YES \_\_\_\_\_ NO ✓

SEPTIC TANK CAPACITY N/A GALLONS NUMBER OF BEDROOMS 4

125 SQFT PER  
BEDROOM  
500 SQFT TOTAL

REPAIR - CALL FOR INSPECTION WHEN GROUND IS OPENED UP SO SANITARIAN CAN RECOMMEND REPAIR.

5/16/88 TRENCH OFF OLD DRYWELL 125 SQFT PER BEDROOM  
DEPTH 1 1/2 FT INLET 4 FT DEEP DEPTH 1 1/2 FT  
7 1/2 FT OF STONE 67 FT LONG

PLANS APPROVED BY C. Williams DATE 5/16/88

COVER NO WORK UNTIL INSPECTED AND APPROVED.

NEITHER THE HOWARD COUNTY COUNCIL NOR THE HEALTH DEPARTMENT IS RESPONSIBLE FOR THE SUCCESSFUL OPERATION OF ANY SYSTEM.

NOTE: CLEANOUT REQUIRED EVERY 70 FEET OF SEWER LINE AND/OR AT 90° SWEEPS IN LINES FROM HOUSE TO DRAIN FIELDS.

NOTE: ALL PARTS OF SEPTIC SYSTEMS (I.E., TANK, DISTRIBUTION BOX, TRENCHES) TO BE 100 FEET FROM WELL. (UNLESS OTHERWISE SPECIFICALLY AUTHORIZED)

NOTE: IF DEEP TRENCH(IES) ARE USED CALL FOR INSPECTION BEFORE AND AFTER PLACING GRAVEL IN TRENCH(IES).

NOTE: NO DRY WELL SHALL EXCEED 15 FOOT IN DIAMETER. NO ABSORPTION TRENCH TO EXCEED 100 FEET IN LENGTH.

NOTE: ALL PIPE FROM HOUSE TO SEPTIC TANK MUST BE CAST IRON OR SCHEDULE 40 PVC OR ABS.

PERMIT VOID AFTER TWO YEARS.

NOTE: INSTALL STAND PIPE ON SEPTIC TANK AND DRY WELL. STAND PIPES MUST BE 6 INCHES IN DIAMETER. CAST IRON, CONCRETE OR TERRA COTTA OR PVC OR ABS ACCEPTED. IF TOP OF SEPTIC TANK IS DEEPER THAN 3 FEET, MANHOLE TO GRADE REQUIRED.

NOTE: DISTRIBUTION BOXES MUST HAVE BAFFLES.

**\*INSTALLER IS RESPONSIBLE FOR OBTAINING FINAL APROVAL ON THIS PERMIT**

\*CALL 461-9933 FOR INSPECTION OF SEPTIC SYSTEMS.

EH - 2-1186

P 41922

VISUAL HOLE  
④

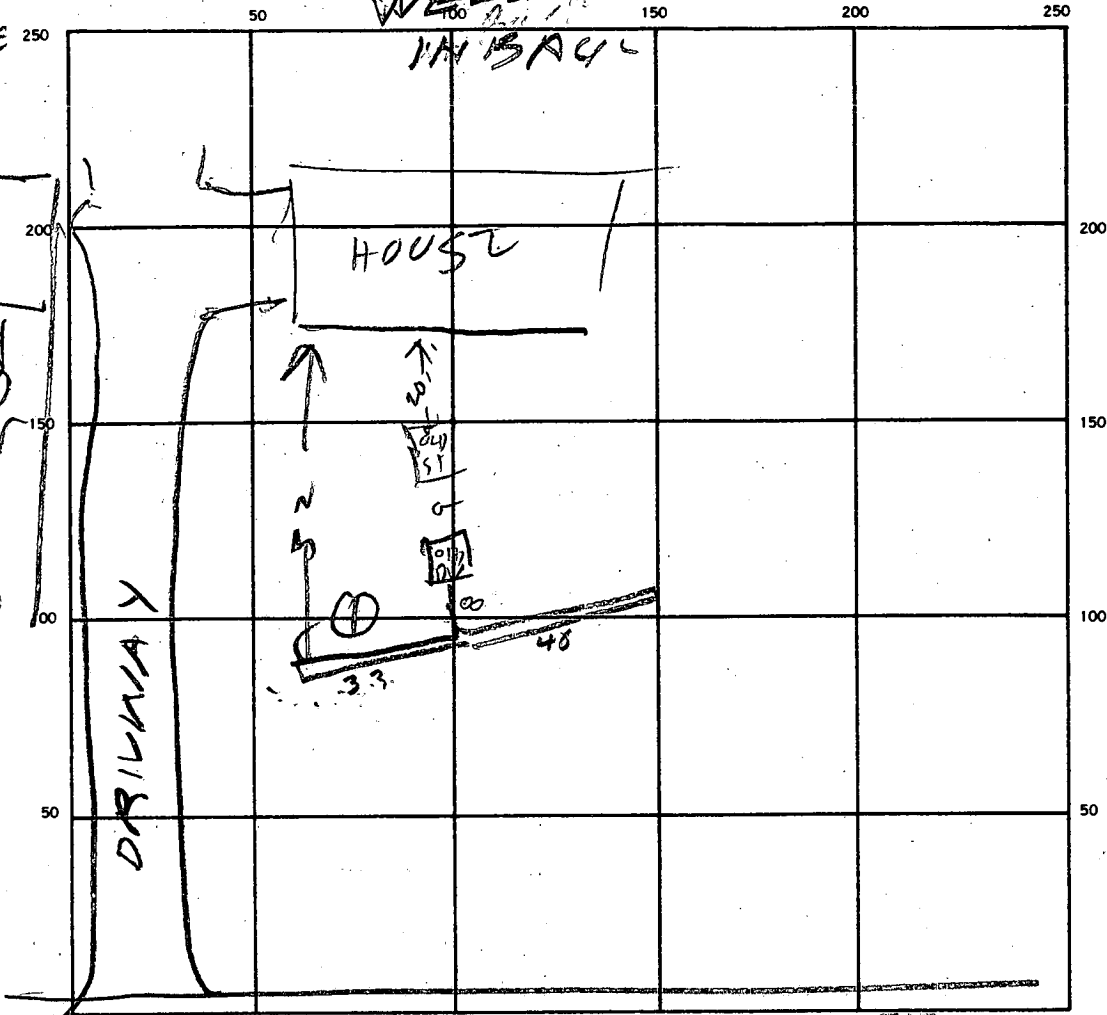
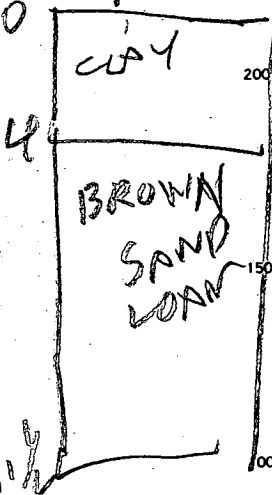

INDICATE NORTH NAME ADJOINING ROADWAY AS BASE LINE  
BR 16 W TOWN DRAM RD

ST DL  
OK OIL

SEPTIC TANK LEVEL \_\_\_\_\_

CLEANOUTS \_\_\_\_\_

DISTRIBUTION BOX LEVEL \_\_\_\_\_

DRAIN FIELD/TILE FIELD DEPTH 11.5 FT. TRENCH WIDTH 2 FT. INLET DEPTH 4 FT.

EFFECTIVE GRAVEL DEPTH 7.5 FT. TOTAL LENGTH 73 FT. EXISTANCE / REQUIRED

NUMBER OF TRENCHES 1 ONE SIDEWALL/BOTTOM AREA 547 SQ. FT. 500

DRYWELL INSIDE DIAMETER \_\_\_\_\_ FT. EFFECTIVE DEPTH BELOW INLET \_\_\_\_\_ FT.

ABSORBENT AREA \_\_\_\_\_ SQ. FT.

REMARKS 5/16/88 - ADD ANOTHER LOAD OF STONE & COVER TRENCH. SOIL VERY POROUS. SEE VISUAL HOLE  
5/16/88 - ADDITIONAL STONE ADD'D

DATE SYSTEM APPROVED 5/16/88

INSPECTOR Raymond Hodge