

4/22/88
10:14 AM
11/30/88 12:00-1:00
12/27/88

PERMIT

SEWAGE DISPOSAL SYSTEM

MARYLAND STATE DEPARTMENT OF HEALTH

HOWARD COUNTY
BUREAU OF ENVIRONMENTAL HEALTH
461-9933

05-341795
INDEXED

P 41858

A Repair

DISTRICT _____

DATE 6/03/88

DATE SYSTEM APPROVED 12/27/98

INSPECTOR RH

DAVE HOFFMAN 831-7257

Vision Builders

IS PERMITTED TO INSTALL _____ ALTER

ADDRESS 9110 Q Red Branch Road, Columbia, Maryland 21045 PHONE 730-4653

SUBDIVISION _____ ROAD 8425 Murphy Road LOT _____

PROPERTY OWNER Vision Builders/Mr. Joseph Gonzales
8425 Murphy Road

ADDRESS _____

IF GARBAGE GRINDER IS USED INCREASE SEPTIC TANK CAPACITY BY 50% AND ABSORPTION AREA BY 22%.

GARBAGE GRINDER? YES _____ NO _____

SEPTIC TANK CAPACITY _____ GALLONS NUMBER OF BEDROOMS _____

REPAIR - CALL FOR INSPECTION WHEN GROUND IS OPENED UP SO SANITARIAN CAN RECOMMEND REPAIR.

6-22-88 Inlet 3" Bottom 8" Require 300' of sidewall if existing syst. All
TRENCHES IF Drywell + Dry well is dry 200' Required, Replace PIPE FROM
HOUSE TO TANK. SAU

11/30/88 NO SYSTEM COMPLAINT ON SITE. INSTALL 474' of SYSTEM CW.

PLANS APPROVED BY C. Williams DATE 6/03/88

COVER NO WORK UNTIL INSPECTED AND APPROVED.

NEITHER THE HOWARD COUNTY COUNCIL NOR THE HEALTH DEPARTMENT IS RESPONSIBLE FOR THE SUCCESSFUL OPERATION OF ANY SYSTEM.

NOTE: CLEANOUT REQUIRED EVERY 70 FEET OF SEWER LINE AND/OR AT 90° SWEEPS IN LINES FROM HOUSE TO DRAIN FIELDS.

NOTE: ALL PARTS OF SEPTIC SYSTEMS (I.E., TANK, DISTRIBUTION BOX, TRENCHES) TO BE 100 FEET FROM WELL (UNLESS OTHERWISE SPECIFICALLY AUTHORIZED)

NOTE: IF DEEP TRENCHES ARE USED CALL FOR INSPECTION BEFORE AND AFTER PLACING GRAVEL IN TRENCHES.

NOTE: NO DRY WELL SHALL EXCEED 15 FOOT IN DIAMETER. NO ABSORPTION TRENCH TO EXCEED 100 FEET IN LENGTH.

NOTE: ALL PIPE FROM HOUSE TO SEPTIC TANK MUST BE CAST IRON OR SCHEDULE 40 PVC OR ABS.

PERMIT VOID AFTER TWO YEARS.

NOTE: INSTALL STAND PIPE ON SEPTIC TANK AND DRY WELL. STAND PIPES MUST BE 6 INCHES IN DIAMETER. CAST IRON, CONCRETE OR TERRA COTTA OR PVC OR ABS ACCEPTED. IF TOP OF SEPTIC TANK IS DEEPER THAN 3 FEET, MANHOLE TO GRADE REQUIRED.

NOTE: DISTRIBUTION BOXES MUST HAVE BAFFLES.

BLDG. PERMIT SIGNED
AND RETURNED 6-16-88

*INSTALLER IS RESPONSIBLE FOR OBTAINING FINAL APROVAL ON THIS PERMIT SAU

*CALL 461-9933 FOR INSPECTION OF SEPTIC SYSTEMS.

EH - 2-1186

BP 18418

APPLICATION

PERCOLATION TESTING

A Repair

P 41859

HOWARD COUNTY HEALTH DEPARTMENT
BUREAU OF ENVIRONMENTAL HEALTH
P.O. BOX 476 ELLICOTT CITY, MARYLAND 21043
TELEPHONE: 461-9933

05-346185

DISTRICT 5TH

DATE 5/27/88

INDEXED

TO: THE COUNTY HEALTH OFFICER
ELLICOTT CITY, MARYLAND

I HEREBY APPLY FOR THE NECESSARY TEST IN ORDER TO CONSTRUCT (OR RECONSTRUCT) A SEWAGE DISPOSAL SYSTEM.

PROPERTY OWNER Alda Cisse

ADDRESS 6765 Milk Hollow Rd Highland PHONE 854-0282

PROSPECTIVE BUYER None (per test for installation of swimming pool)

ADDRESS _____ PHONE _____

PROPERTY LOCATION:

SUBDIVISION Cisse Farm LOT NO. _____

ROAD AND DESCRIPTION Milk Hollow Rd - near Deer Valley Rd

TAX MAP _____ PARCEL # _____

SIZE OF LOT _____ TYPE BLDG. Single family
(SINGLE FAMILY DWELLING OR COMMERCIAL)

THE SYSTEM INSTALLED UNDER THIS APPLICATION IS ACCEPTABLE ONLY UNTIL PUBLIC FACILITIES BECOME AVAILABLE. I FULLY UNDERSTAND THE FEE CONNECTED WITH THE FILING OF THIS PERC TEST APPLICATION IS NON-REFUNDABLE UNDER ANY CIRCUMSTANCES. I ALSO AGREE TO COMPLY WITH ALL M.O.S.H.A. REQUIREMENTS IN TESTING THIS LOT.

Blenda Wright Inwood Bldg Supply
(SIGNATURE OF APPLICANT)

APPROVED BY _____ FOR _____ DATE _____

REJECTED BY _____ FOR _____ DATE _____

HOLD PENDING FURTHER TESTS _____ DATE _____

REASONS FOR REJECTION OR HOLDING 6-9-88 Per. satisfactory AS Repair area - Pool

may be built as planned. See...

BLDG. PERMIT SIGNED AND RETURNED 6/9/88
Serial # 18493-Per

HD-216

P 41859

THIS IS NOT A PERMIT

SOIL PROFILE

0'
4' OM A1-3
Yell. Bd
Silty clay
c10%
FRAGS

30'
Yell. Bd
Silt loam
Highly
micaceous
15-20%
FRAGS

13'

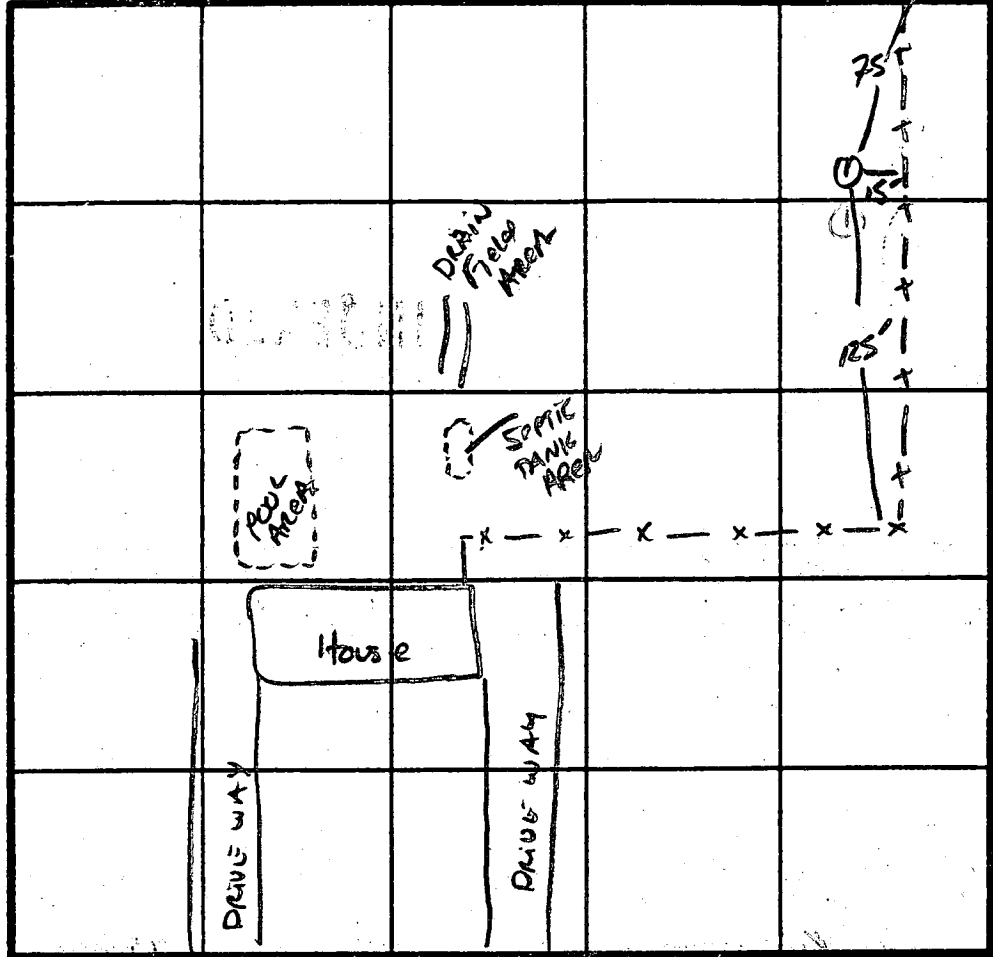

INDICATE NORTH - NAME ADJOINING ROADWAY AS BASE LINE.

Mink Hollow Rd.

DATE	TEST NO.	DEPTH	PRE-WET		TEST - 1" DROP		TIME
			START	STOP	START	STOP	
6/4/88	IV	13"	DRY -	Glendy Ln.	UNIFORM	below 3'	
			see profile	X Perc	3-	SMIN ESTIMATE	

REMARKS _____

TYPE OF SOIL Glendy Ln.

TESTED BY _____ ALSO PRESENT _____

APR 2 9 17 AM '88
HEALTH DEPT. CITY, MD.
HOWARD COUNTY
RECEIVED

6-9-88

NO EVIDENCE OF SEPTIC FAILURE. RENE OIK
EST. X RENE 3-SM IN
>10000 \$ TO REPAIR IN
S-116

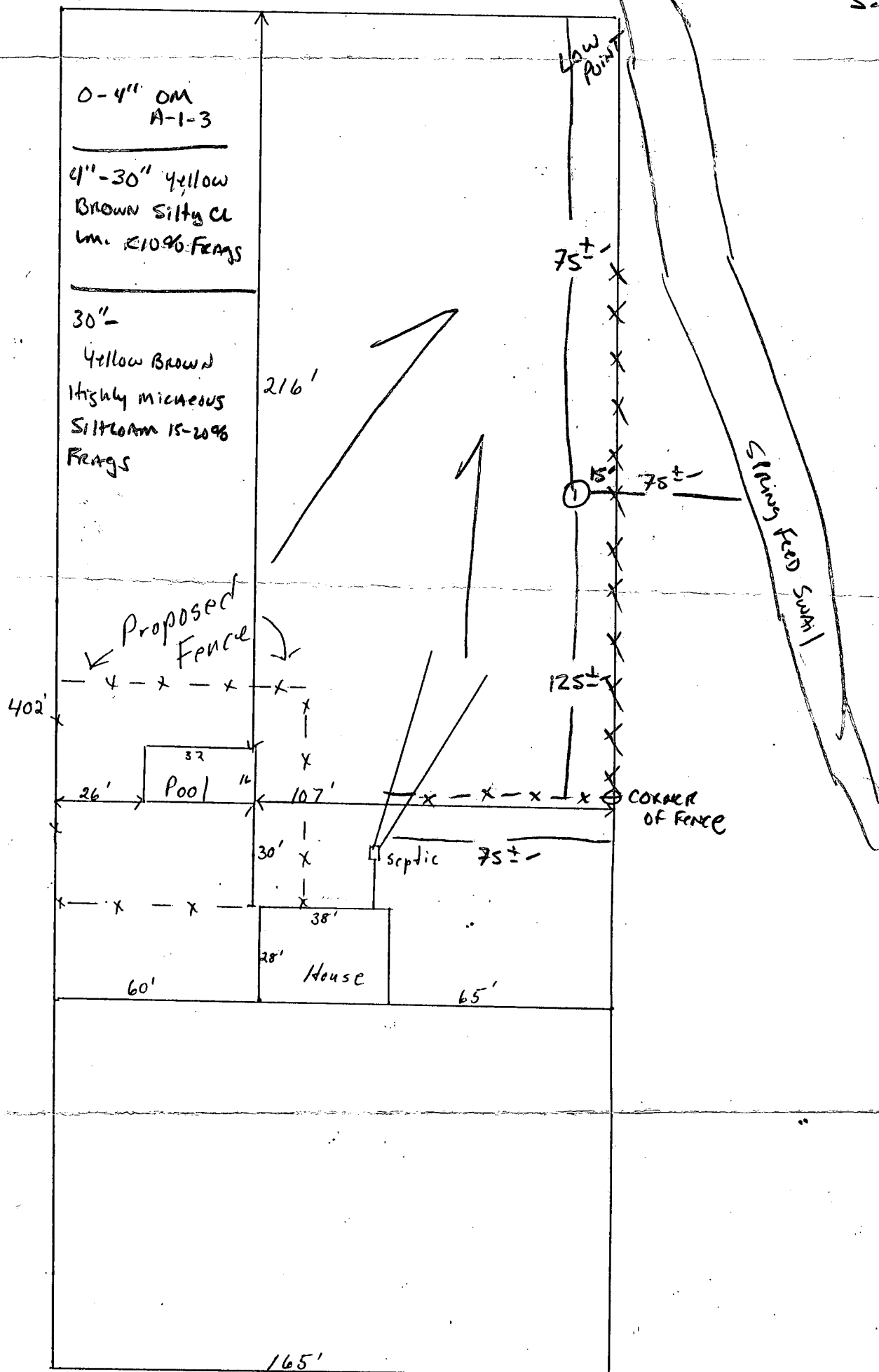

Alda Cissell
6765 Mint Hollow Rd
Highland, Md 20777

THURSDAY
10:30AM

REPAIR TEST NEEDED
OWNER ALONG

5/19/88 CW

BLDG. PERMIT SIGNED
AND RETURNED

