

4/16/87  
2 PM  
11/17/87  
7 AM

11/18/87  
2 PM

11/19/87  
11 AM + CAROL

TAX# 04318218

# PERMIT

SEWAGE DISPOSAL SYSTEM

MARYLAND STATE DEPARTMENT OF HEALTH\*

P 40361

A repair

DISTRICT \_\_\_\_\_

**HOWARD COUNTY**  
BUREAU OF ENVIRONMENTAL HEALTH  
461-9933

DATE 10/28/87

DATE SYSTEM APPROVED RH

INSPECTOR 11/19/87

INDEXED

Paul Schissler IS PERMITTED TO INSTALL \_\_\_\_\_ ALTER X

ADDRESS \_\_\_\_\_ PHONE 875-4197

SUBDIVISION \_\_\_\_\_ ROAD 13700 Forsythe Road LOT \_\_\_\_\_

PROPERTY OWNER Walter Johnson  
13700 Forsythe Road

ADDRESS \_\_\_\_\_

IF GARBAGE GRINDER IS USED INCREASE SEPTIC TANK CAPACITY BY 50% AND ABSORPTION AREA BY 22%.

GARBAGE GRINDER? YES \_\_\_\_\_ NO X

SEPTIC TANK CAPACITY Min. 1000 GALLONS NUMBER OF BEDROOMS 3

REPAIR - CALL FOR INSPECTION WHEN GROUND IS OPENED UP SO SANITARIAN CAN RECOMMEND REPAIR.

OPEN -> Pump + Fill w/ clean soil existing cess pool. Keep new syst. as high as possible on sideslope behind. ROAD SHED. INSTALL @ 100 phi BR INLET - 4.5 FT BOTTOM - 9 FT FE OF STONE - 4.5'

PLANS APPROVED BY C. Williams DATE 10/28/87

COVER NO WORK UNTIL INSPECTED AND APPROVED.

NEITHER THE HOWARD COUNTY COUNCIL NOR THE HEALTH DEPARTMENT IS RESPONSIBLE FOR THE SUCCESSFUL OPERATION OF ANY SYSTEM.

NOTE: CLEANOUT REQUIRED EVERY 70 FEET OF SEWER LINE AND/OR AT 90° SWEEPS IN LINES FROM HOUSE TO DRAIN FIELDS.

NOTE: ALL PARTS OF SEPTIC SYSTEMS (I.E., TANK, DISTRIBUTION BOX, TRENCHES) TO BE 100 FEET FROM WELL. (UNLESS OTHERWISE SPECIFICALLY AUTHORIZED)

NOTE: IF DEEP TRENCH(ES) ARE USED CALL FOR INSPECTION BEFORE AND AFTER PLACING GRAVEL IN TRENCH(ES).

NOTE: NO DRY WELL SHALL EXCEED 15 FOOT IN DIAMETER. NO ABSORPTION TRENCH TO EXCEED 100 FEET IN LENGTH.

NOTE: ALL PIPE FROM HOUSE TO SEPTIC TANK MUST BE CAST IRON OR SCHEDULE 40 PVC OR ABS.

PERMIT VOID AFTER TWO YEARS.

NOTE: INSTALL STAND PIPE ON SEPTIC TANK AND DRY WELL. STAND PIPES MUST BE 6 INCHES IN DIAMETER. CAST IRON, CONCRETE OR TERRA COTTA OR PVC OR ABS ACCEPTED. IF TOP OF SEPTIC TANK IS DEEPER THAN 3 FEET, MANHOLE TO GRADE REQUIRED.

NOTE: DISTRIBUTION BOXES MUST HAVE BAFFLES.

**\*INSTALLER IS RESPONSIBLE FOR OBTAINING FINAL APPROVAL ON THIS PERMIT**

\*CALL 461-9933 FOR INSPECTION OF SEPTIC SYSTEMS.

EH - 2-1186

040361

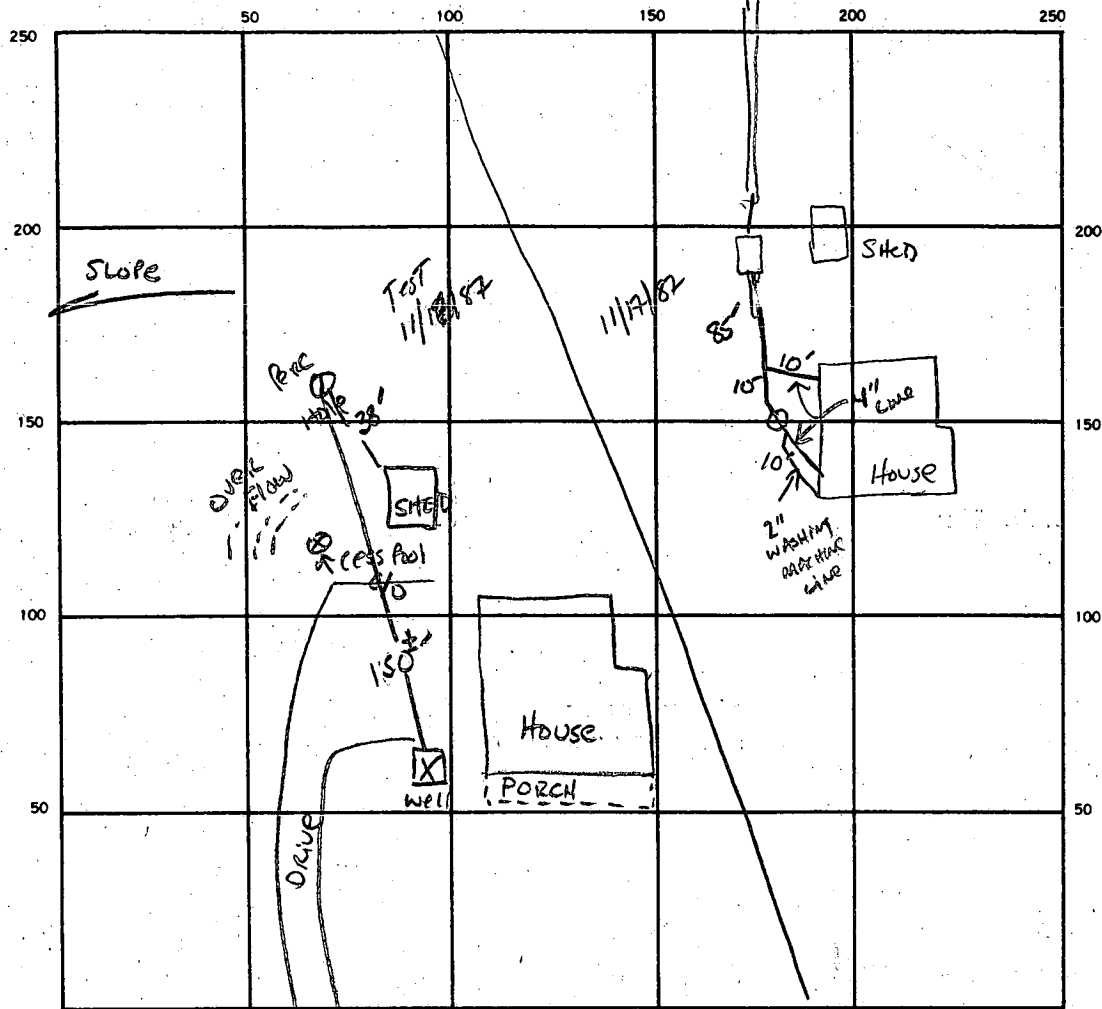

INDICATE NORTH. — NAME ADJOINING ROADWAY AS BASE LINE.

Forsythe Rd.

SEPTIC TANK LEVEL 1/1500 GAL

CLEANOUTS IN LINE X 1 ST  
OK

DISTRIBUTION BOX LEVEL \_\_\_\_\_

DRAIN FIELD/TILE FIELD. DEPTH 9.5 FT. TRENCH WIDTH 2 FT. INLET DEPTH 4.5 FT.

EFFECTIVE GRAVEL DEPTH 4.5 FT. TOTAL LENGTH 90/10 FT.

NUMBER OF TRENCHES 1 ONE SIDEWALL/BOTTOM AREA 495 SQ. FT.

DRYWELL INSIDE DIAMETER \_\_\_\_\_ FT. EFFECTIVE DEPTH BELOW INLET \_\_\_\_\_ FT.

ABSORBENT AREA \_\_\_\_\_ SQ. FT.

REMARKS 11/18/87 OK TO COVER FROM END OF DRIVEWAY BACK TO HOUSE; LEAVE AREA OPEN AT TANK  
TO SEE HOOD-UP - CONTINUE WORK. SA 11/19/87 TRENCH PARTLY DUG &  
SOME STONE ADDED 11/19/87<sup>130</sup> - JOB FINISHED  
11/20/87 - 2 LOADS PUMPED OUT OF CESS POOL BY JACK FLYCK + 2 TRUCK LOADS  
OF FILL INSTALLED. SAW - Per Tile.

DATE SYSTEM APPROVED 11/19/87

INSPECTOR Raymond Hodger

0  
10" AP  
Yell Br  
silt CLM.  
10-15%  
FRAGS  
4.5"  
Yell br w/  
Pink CASIS  
silt LOAM  
30% lg  
FRAGS  
13"

160  
3  
480  
  
108  
4.5 | 4800  
1080

110  
45  
550  
480