

LAYOUT _____ INSP 4 _____

INSP 2 _____ INSP 5 _____

INSP 3 _____ INSP 6 _____

ISSUE DATE: _____

APPROVAL DATE: _____

PERMIT INDEXED

P _____

A 40744 _____

ON-SITE SEWAGE DISPOSAL SYSTEM HOWARD COUNTY HEALTH DEPARTMENT BUREAU OF ENVIRONMENTAL HEALTH

_____ IS PERMITTED TO INSTALL ALTER

ADDRESS: _____ PHONE NUMBER: _____

SUBDIVISION: _____ LOT NUMBER: _____

ADDRESS: 15885 Meadow Walk PROPERTY OWNER: Pam Wright

SEPTIC TANK CAPACITY (GALLONS): _____ OUTLET BAFFLE FILTER REQUIRED

PUMP CHAMBER CAPACITY (GALLONS): _____ COMPARTMENTED TANK REQUIRED

NUMBER OF BEDROOMS: _____

SQUARE FEET PER BEDROOM: _____

LINEAR FEET OF TRENCH REQUIRED: _____

TRENCHES:	Trench to be _____ feet wide. Inlet _____ feet below original grade. Bottom maximum depth _____ feet below original grade. Effective area begins at _____ feet below original grade. _____ feet of stone below distribution pipe.
LOCATION:	_____
NOTES:	_____

PLANS APPROVED: _____ DATE: _____

NOTE: PERMIT VOID AFTER 2 YEARS

NOTE: CONTRACTOR RESPONSIBLE FOR SCHEDULING A PRE-CONSTRUCTION INSPECTION FOR ALL INSTALLATIONS

NOTE: WATERTIGHT SEPTIC TANKS REQUIRED

NOTE: ALL PARTS OF SEPTIC SYSTEM SHALL BE 100 FEET FROM ANY WATER WELL

NOTE: MANHOLE RISERS REQUIRED ON ALL SEPTIC TANKS AND PUMP CHAMBERS UNLESS SPECIFICALLY AUTHORIZED

**NEITHER THE HOWARD COUNTY COUNCIL NOR THE HEALTH DEPARTMENT IS
RESPONSIBLE FOR THE SUCCESSFUL OPERATION OF ANY SYSTEM
PERMITTEE RESPONSIBLE FOR OBTAINING FINAL APPROVAL ON THIS PERMIT
CALL 410-313-2640 FOR INSPECTION OF SEPTIC SYSTEM**

A 40744

INDEXED

OWNER: Pam Wright

DATE REQUESTED: 8-20-97 @ 10:00

ADDRESS: 15885 Meadow Walk
Woodbine

DRILLER: G. F. Easterday

WELL TAG #

Tax Map 13, p. 199

COUNTY # (NO RECORD FOUND) ^{NOT IN} FILE

PROPOSAL: request inspection for replacement well - existing hand dug possibly to be abandoned (per driller)

LOCATION DIAGRAM

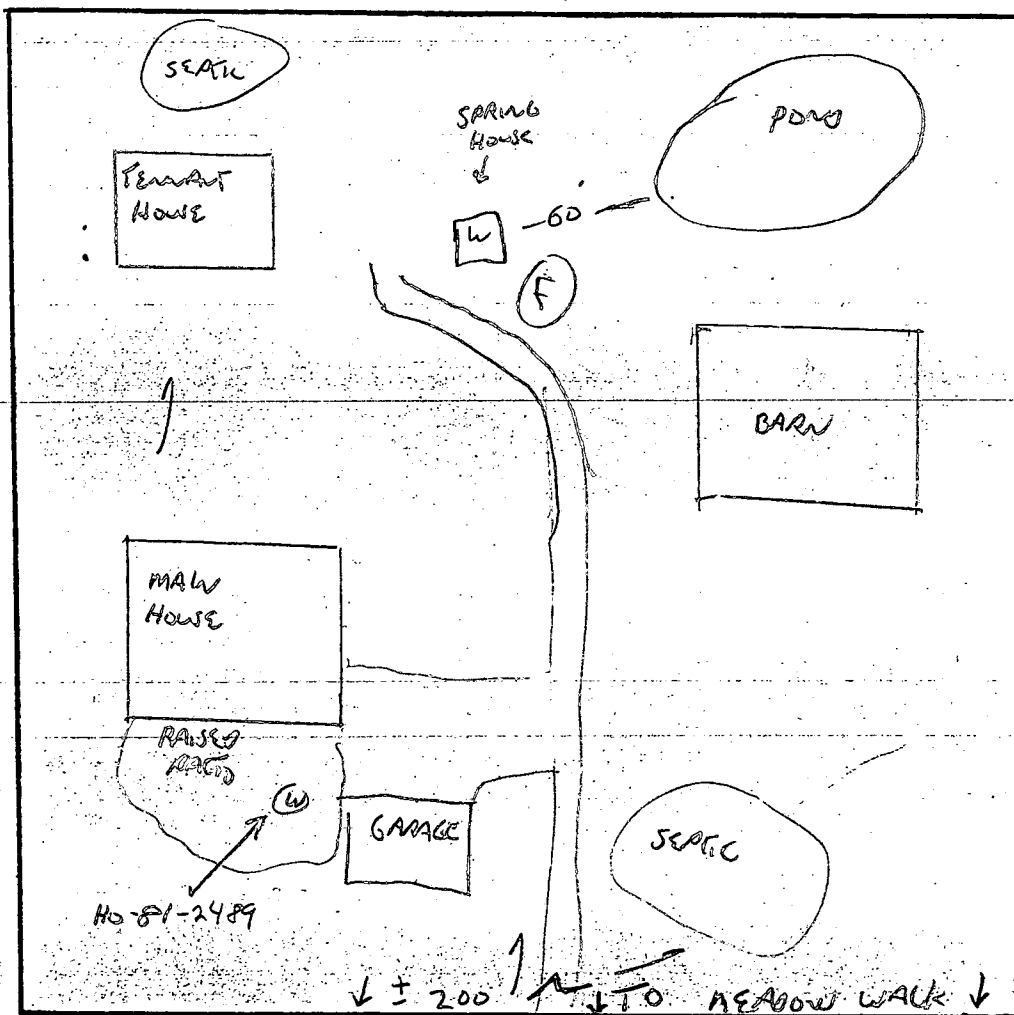

F = PROBABLE LOCATION FOR REPLACEMENT WELL, IF REQUESTED. NO DECISION MADE ON SITE SUITABILITY AT THIS TIME. *ef*

COMMENTS: 8/20/97 SITE Insp. v/ GEORGE EASTERDAY, MR. WRIGHT, SHALLOW WELL IN SPRING HOUSE IS COLLAPSING (SERVES TENANT HOUSE). WELL SERVING MAIN HOUSE HAS GOOD YIELD. THE PRESENT PROPOSAL IS TO CONNECT GOOD WELL TO TENANT HOUSE. NO REPLACEMENT REQUEST AT THIS TIME.

DATE: 8/20/97

INSPECTOR: *ef*

A-40744

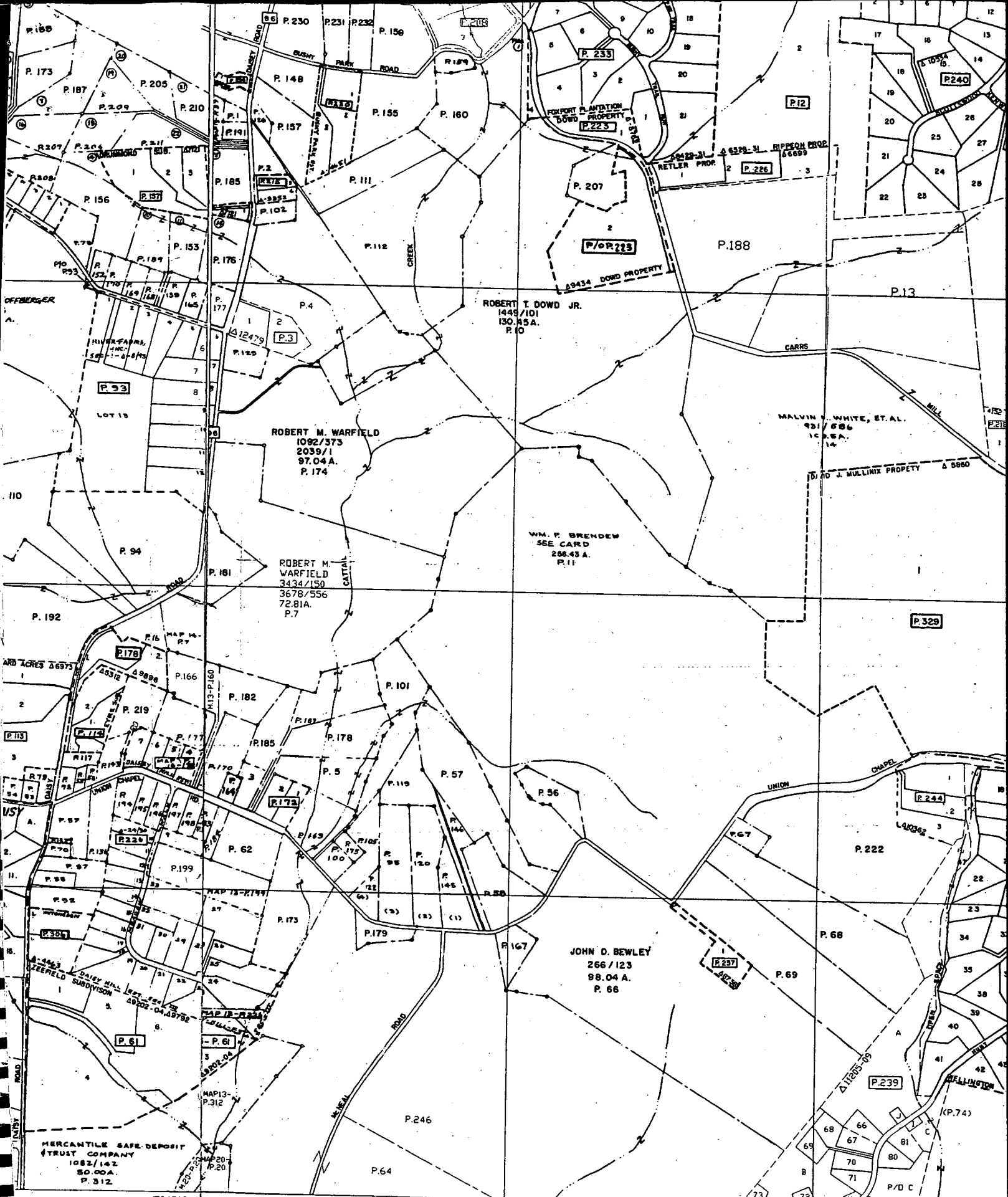

1794510m 94510mN
394539.5mE

COPYRIGHT - 1992 BY THE STATE OF MARYLAND
ALL RIGHTS RESERVED.

THESE MAPS ARE PROTECTED BY COPYRIGHT. THEY MAY NOT BE COPIED OR REPRODUCED IN ANY FORM INCLUDING ELECTRONIC MEANS SUCH AS: DIGITIZING, SCANNING, VECTORIZING, OR IMAGE PROCESSING, OR BY ANY SYSTEM NOW KNOWN OR TO BE INVENTED WITHOUT PERMISSION IN WRITING FROM THE MARYLAND OFFICE OF PLANNING.

