

04 - 322-770

PERMIT

SEWAGE DISPOSAL SYSTEM

MARYLAND STATE DEPARTMENT OF HEALTH

P 40487

A 40486

DISTRICT 5th

HOWARD COUNTY
BUREAU OF ENVIRONMENTAL HEALTH
461-9933

DATE 11/17/87

DATE SYSTEM APPROVED 11/10/87

INDEXED

INSPECTOR S. Abel

Jack Fyock IS PERMITTED TO INSTALL ALTER

ADDRESS _____ PHONE 988-9270

SUBDIVISION Molnar Property ROAD 14347 Burntwoods Road LOT _____

PROPERTY OWNER Nancy A. Molnar

ADDRESS _____

IF GARBAGE GRINDER IS USED INCREASE SEPTIC TANK CAPACITY BY 50% AND ABSORPTION AREA BY 22%.

GARBAGE GRINDER? YES _____ NO

SEPTIC TANK CAPACITY 1000 GALLONS NUMBER OF BEDROOMS 3

TRENCHES - 400 sq. ft. total sidewall are required. Trench to be 2 feet wide. Inlet 4 feet below original grade. Bottom maximum depth 9 feet below original grade. Effective area begins at 4 feet below original grade. 5 feet of stone below distribution pipe.

LOCATION - Place the trench 20 feet from the front of the existing barn and at the right corner as seen when facing the barn from the entrance. Run the trench on contour toward the left. Trench to be minimum 80 feet long. (Install 100 gal. septic tank to replace the portable toilets.

NOTE - No trench to exceed 100 feet in length. Provide 6" - 8" diameter cleanout and cap to grade or above on septic tank.

PLANS APPROVED BY S. Abel DATE 11/13/87

COVER NO WORK UNTIL INSPECTED AND APPROVED.

NEITHER THE HOWARD COUNTY COUNCIL NOR THE HEALTH DEPARTMENT IS RESPONSIBLE FOR THE SUCCESSFUL OPERATION OF ANY SYSTEM.

NOTE: CLEANOUT REQUIRED EVERY 70 FEET OF SEWER LINE AND/OR AT 90° SWEEPS IN LINES FROM HOUSE TO DRAIN FIELDS.

NOTE: ALL PARTS OF SEPTIC SYSTEMS (I.E. TANK, DISTRIBUTION BOX, TRENCHES) TO BE 100 FEET FROM WELL. (UNLESS OTHERWISE SPECIFICALLY AUTHORIZED)

NOTE: IF DEEP TRENCH(ES) ARE USED CALL FOR INSPECTION BEFORE AND AFTER PLACING GRAVEL IN TRENCH(ES).

NOTE: NO DRY WELL SHALL EXCEED 15 FOOT IN DIAMETER. NO ABSORPTION TRENCH TO EXCEED 100 FEET IN LENGTH.

NOTE: ALL PIPE FROM HOUSE TO SEPTIC TANK MUST BE CAST IRON OR SCHEDULE 40 PVC OR ABS.

PERMIT VOID AFTER TWO YEARS.

NOTE: INSTALL STAND PIPE ON SEPTIC TANK AND DRY WELL. STAND PIPES MUST BE 6 INCHES IN DIAMETER. CAST IRON, CONCRETE OR TERRA COTTA OR PVC OR ABS ACCEPTED. IF TOP OF SEPTIC TANK IS DEEPER THAN 3 FEET, MANHOLE TO GRADE REQUIRED.

NOTE: DISTRIBUTION BOXES MUST HAVE BAFFLES.

***INSTALLER IS RESPONSIBLE FOR OBTAINING FINAL APPROVAL ON THIS PERMIT**

*CALL 461-9933 FOR INSPECTION OF SEPTIC SYSTEMS.

EH - 2-1186

A 40486

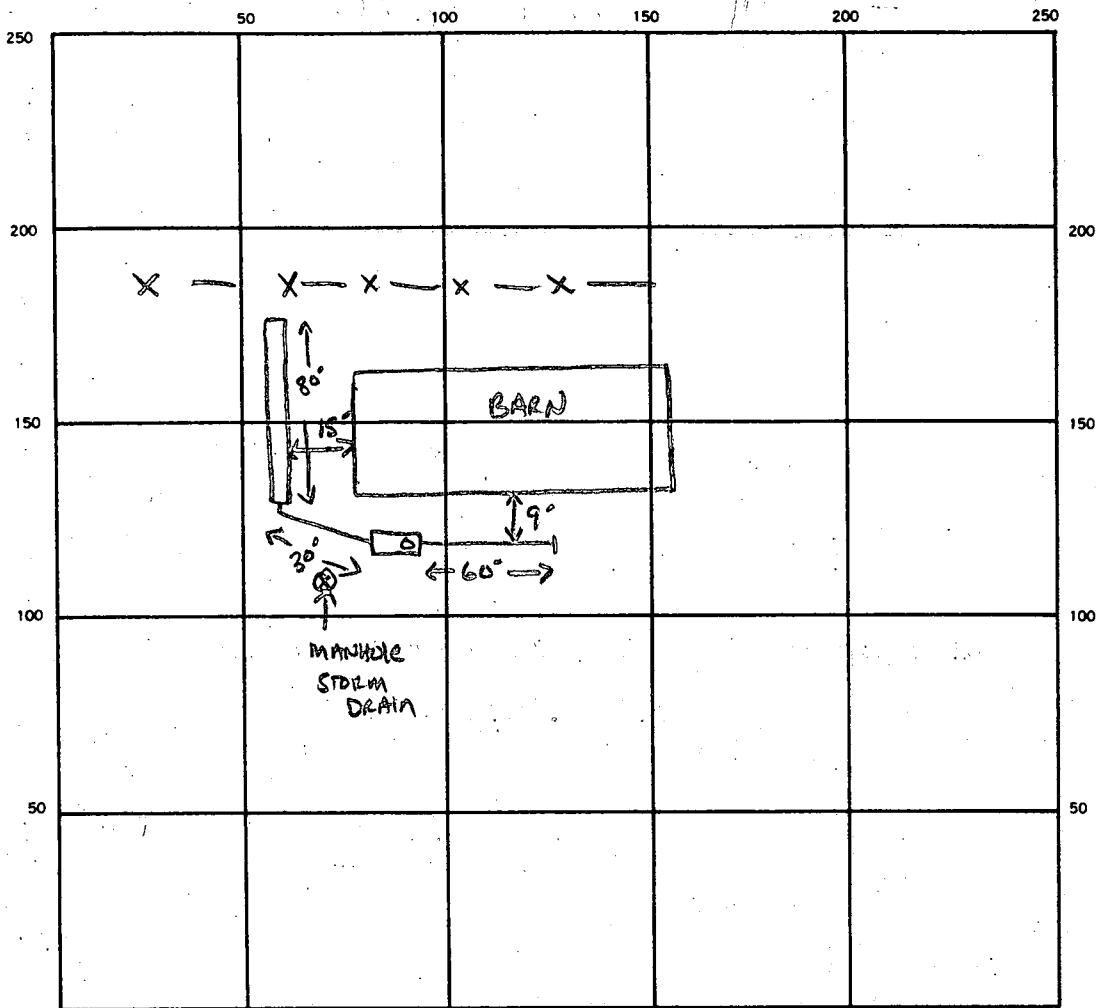

INDICATE NORTH. — NAME ADJOINING ROADWAY AS BASE LINE.

BURNPWOODS Rd.

SEPTIC TANK. LEVEL 1000 GAL. CLEANOUTS

DISTRIBUTION BOX. LEVEL N/A

DRAIN FIELD/TILE FIELD. DEPTH 9 FT. TRENCH WIDTH 2 FT. INLET DEPTH 3.5 FT.

EFFECTIVE GRAVEL DEPTH 5.5 FT. TOTAL LENGTH 80' FT.

NUMBER OF TRENCHES 1 ONE SIDEWALL/BOTTOM AREA 440 SQ. FT.

DRYWELL INSIDE DIAMETER — FT. EFFECTIVE DEPTH BELOW INLET — FT.

ABSORBENT AREA 440 SQ. FT.

REMARKS _____

DATE SYSTEM APPROVED 11/16/87 INSPECTOR S. Abel

PERMIT

SEWAGE DISPOSAL SYSTEM

MARYLAND STATE DEPARTMENT OF HEALTH

P _____

A _____

DISTRICT _____

DATE _____

HOWARD COUNTY

BUREAU OF ENVIRONMENTAL HEALTH

461-9933

DATE SYSTEM APPROVED 11/16/87

INSPECTOR S. Abel

JACK FYOCK IS PERMITTED TO INSTALL ALTER _____

ADDRESS _____ PHONE 988 9270

SUBDIVISION _____ ROAD _____ LOT _____

PROPERTY OWNER NANCY MOLNAR 854-6625

ADDRESS 14347 BURNTWOODS Rd.

IF GARBAGE GRINDER IS USED INCREASE SEPTIC TANK CAPACITY BY 50% AND ABSORPTION AREA BY 22%.

GARBAGE GRINDER? YES _____ NO A

SEPTIC TANK CAPACITY 1000 GALLONS NUMBER OF BEDROOMS N/A

INSTALL TRENCH INLET 4' BOTTOM 9' STONE 5' DLF 80'
TOTAL SIDEWALL 400 ϕ . PLACE 20' FROM BARN ENTRANCE AND
AT THE RIGHT CORNER OF THE BARN RUN TRENCH ACROSS
FRONT OF BARN. SA

PLANS APPROVED BY _____ DATE _____

COVER NO WORK UNTIL INSPECTED AND APPROVED.

NEITHER THE HOWARD COUNTY COUNCIL NOR THE HEALTH DEPARTMENT IS RESPONSIBLE FOR THE SUCCESSFUL OPERATION OF ANY SYSTEM.

NOTE: CLEANOUT REQUIRED EVERY 70 FEET OF SEWER LINE AND/OR AT 90° SWEEPS IN LINES FROM HOUSE TO DRAIN FIELDS.

NOTE: ALL PARTS OF SEPTIC SYSTEMS (I.E., TANK, DISTRIBUTION BOX, TRENCHES) TO BE 100 FEET FROM WELL. (UNLESS OTHERWISE SPECIFICALLY AUTHORIZED)

NOTE: IF DEEP TRENCH(ES) ARE USED CALL FOR INSPECTION BEFORE AND AFTER PLACING GRAVEL IN TRENCH(ES).

NOTE: NO DRY WELL SHALL EXCEED 15 FOOT IN DIAMETER. NO ABSORPTION TRENCH TO EXCEED 100 FEET IN LENGTH.

NOTE: ALL PIPE FROM HOUSE TO SEPTIC TANK MUST BE CAST IRON OR SCHEDULE 40 PVC OR ABS.

PERMIT VOID AFTER TWO YEARS.

NOTE: INSTALL STAND PIPE ON SEPTIC TANK AND DRY WELL. STAND PIPES MUST BE 6 INCHES IN DIAMETER. CAST IRON, CONCRETE OR TERRA COTTA OR PVC OR ABS ACCEPTED. IF TOP OF SEPTIC TANK IS DEEPER THAN 3 FEET, MANHOLE TO GRADE REQUIRED.

NOTE: DISTRIBUTION BOXES MUST HAVE BAFFLES.

***INSTALLER IS RESPONSIBLE FOR OBTAINING FINAL APPROVAL ON THIS PERMIT**

*CALL 461-9933 FOR INSPECTION OF SEPTIC SYSTEMS.

EH - 2-1186

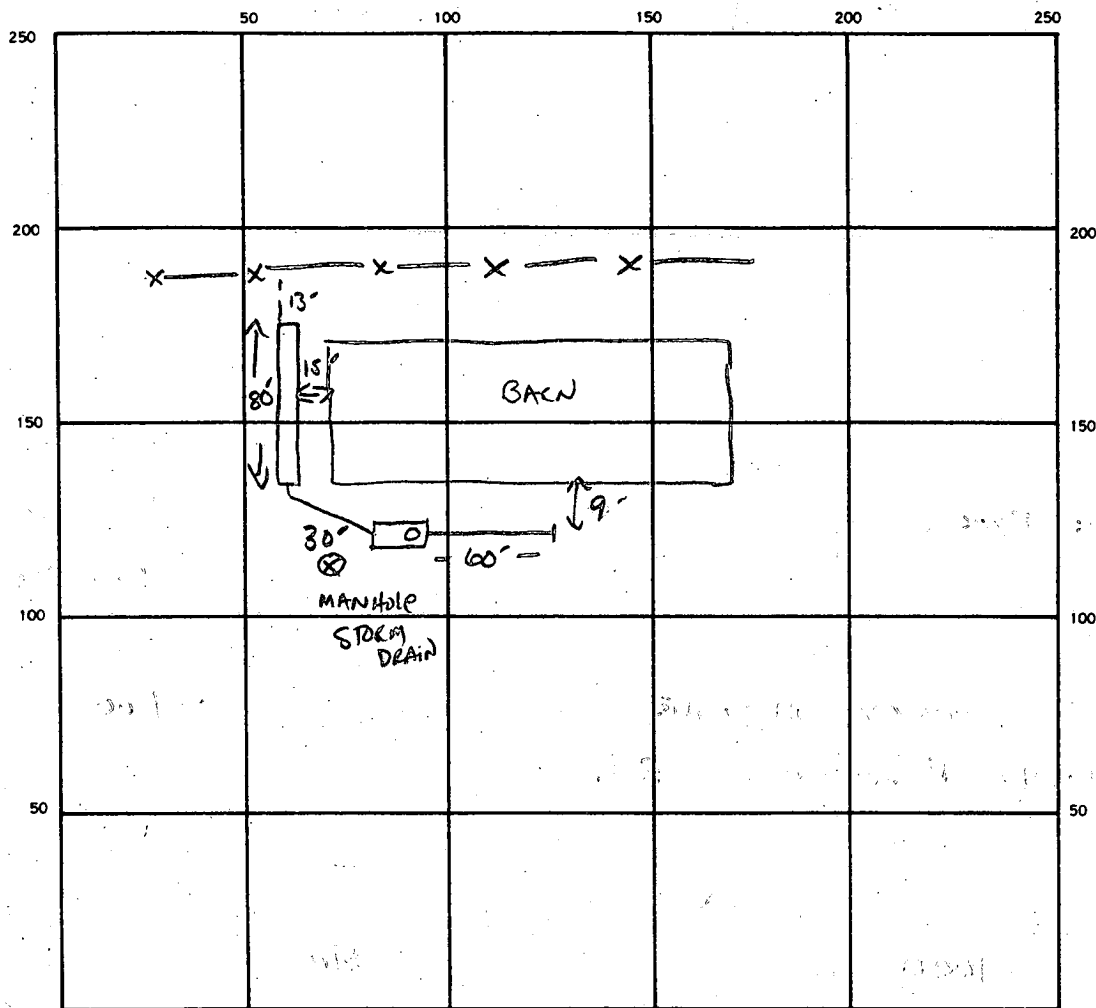

INDICATE NORTH. — NAME ADJOINING ROADWAY AS BASE LINE

BURNWOODS Rd.

SEPTIC TANK. LEVEL 1000 GAL. ✓ CLEANOUTS ✓

DISTRIBUTION BOX. LEVEL N/A

DRAIN FIELD TILE FIELD. DEPTH 9 FT. TRENCH WIDTH 2 FT. INLET DEPTH 3.5 FT.

EFFECTIVE GRAVEL DEPTH 5.5 FT. TOTAL LENGTH 80' FT.

NUMBER OF TRENCHES 1 ONE SIDEWALL/BOTTOM AREA 440 SQ. FT.

DRYWELL INSIDE DIAMETER FT. EFFECTIVE DEPTH BELOW INLET FT.

ABSORBENT AREA 440 SQ. FT.

REMARKS 11/16/87 OK TO ADD STONE. S.M.

DATE SYSTEM APPROVED 11/16/87 INSPECTOR S. Abel

APPLICATION

PERCOLATION TESTING

A 40486

P _____

HOWARD COUNTY HEALTH DEPARTMENT
BUREAU OF ENVIRONMENTAL HEALTH
P.O. BOX 476 ELLICOTT CITY, MARYLAND 21043
TELEPHONE: 461-9933

DISTRICT 5TH

DATE 11/17/87

TO: THE COUNTY HEALTH OFFICER
ELLICOTT CITY, MARYLAND

I HEREBY APPLY FOR THE NECESSARY TEST IN ORDER TO CONSTRUCT (OR RECONSTRUCT) A SEWAGE DISPOSAL SYSTEM.

PROPERTY OWNER Nancy A. Molnar

ADDRESS 14347 BURNWOODS Rd. Glenwood, Md. 21738 PHONE 854-6625

PROSPECTIVE BUYER _____

ADDRESS _____ PHONE _____

PROPERTY LOCATION:

SUBDIVISION _____ LOT NO. _____

ROAD AND DESCRIPTION N/A

TAX MAP _____ PARCEL # _____

SIZE OF LOT _____ TYPE BLDG BARN w/ 2 PILES + 2 SINKS
(SINGLE FAMILY DWELLING OR COMMERCIAL)

THE SYSTEM INSTALLED UNDER THIS APPLICATION IS ACCEPTABLE ONLY UNTIL PUBLIC FACILITIES BECOME AVAILABLE. I FULLY UNDERSTAND THE FEE CONNECTED WITH THE FILING OF THIS PERC TEST APPLICATION IS NON-REFUNDABLE UNDER ANY CIRCUMSTANCES. I ALSO AGREE TO COMPLY WITH ALL M.O.S.H.A. REQUIREMENTS IN TESTING THIS LOT.

Nancy A. Molnar
(SIGNATURE OF APPLICANT)

APPROVED BY _____ FOR _____ DATE _____

REJECTED BY _____ FOR _____ DATE _____

HOLD PENDING FURTHER TESTS _____ DATE _____

REASONS FOR REJECTION OR HOLDING 11/13/87 Rec Satisfactory; S.M.

HD-216

THIS IS NOT A PERMIT

①
SOIL PROFILE

0
6"
4.5-5.0
13"

AP HX
SILTY
Brown
SILTY CLAY
LOAMY
CLAY FRAGS

Yellow Bc
Silt loam
Slightly
MICACEOUS
10-20%
FRAGS

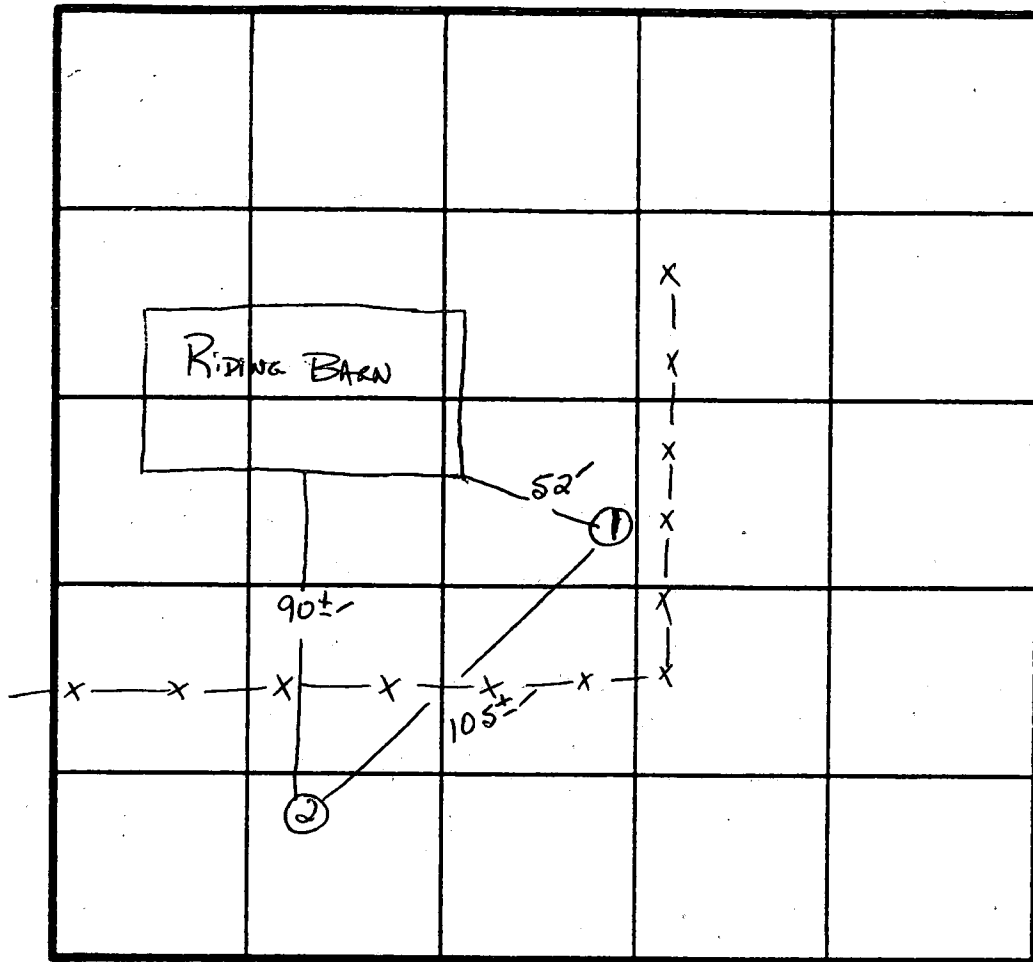

INDICATE NORTH - NAME ADJOINING ROADWAY AS BASE LINE.

160 \$/BR
Inlet 4'
Bottom 9'

BK for A
BARN
EST. (2 SINKS
2 boilers)

APPROX. WATER
USE
200 gal for
SINKS + 400 gal
for boilers.

DATE	TEST NO.	DEPTH	PRE-WET		TEST - 1" DROP		TIME
			START	STOP	START	STOP	
11/13/87	V	UNIFORM SOIL below 4.5-5.0'			EST. PERC 2-5 MIN.		
	2 S	3.5'	2:14	2:15	2:15	2:17	2 MIN
	V	13' UNIFORM SOIL below 3.0'					

600 GAL
TOTAL
400 \$ of
sidewalk
Required
1 (one)
80' TRENCH

1000 GAL
TANK

REMARKS _____

TYPE OF SOIL Chestnut loam

TESTED BY S. Abel ALSO PRESENT JAK / SKIP