

Tax ID - 03-311848

9/15/87  
1Pm

# PERMIT

P 39824  
A 12914

SEWAGE DISPOSAL SYSTEM

MARYLAND STATE DEPARTMENT OF HEALTH DISTRICT 3rd

HOWARD COUNTY  
BUREAU OF ENVIRONMENTAL HEALTH  
461-9933

## INDEXED

DATE 8/06/87  
DATE SYSTEM APPROVED 9/15/87  
INSPECTOR R. Hooges

John Sakai & Associates IS PERMITTED TO INSTALL  ALTER

ADDRESS P. O. Box 10653, Rockville, Maryland 20850 PHONE \_\_\_\_\_

SUBDIVISION Woodmark ROAD 12124 Mt. Albert Road LOT 54, Blk C, Sec. 1

PROPERTY OWNER Greg Kahlert

ADDRESS \_\_\_\_\_

IF GARBAGE GRINDER IS USED INCREASE SEPTIC TANK CAPACITY BY 50% AND ABSORPTION AREA BY 22%. ⊙

GARBAGE GRINDER? YES \_\_\_\_\_ NO

SEPTIC TANK CAPACITY 1250 GALLONS NUMBER OF BEDROOMS 4

TRENCHES - 194 sq. ft. per bedroom. Trench to be 3 feet wide. Inlet 3 1/2 feet below original grade. Bottom maximum depth 5 1/2 feet below original grade. Effective area begins at 3 1/2 feet below original grade. 2 feet of stone below distribution pipe.

LOCATION - SHALLOW SYSTEM ONLY. Beginning from right front lot corner, place 1st trench 150 feet down the right line and 120 feet off the line as seen when facing property from Mount Albert Road. Run trenches along contour toward right and front lot lines. NOTE: MAINTAIN MINIMUM 100 FEET FROM WELL TO SEPTIC.

NOTE - No trench to exceed 100 feet in length. Provide 6" - 8" diameter cleanout and cap to grade or above on septic tank AK/CW

PLANS APPROVED BY B. Nixon DATE 4/27/87

COVER NO WORK UNTIL INSPECTED AND APPROVED.

NEITHER THE HOWARD COUNTY COUNCIL NOR THE HEALTH DEPARTMENT IS RESPONSIBLE FOR THE SUCCESSFUL OPERATION OF ANY SYSTEM.

NOTE: CLEANOUT REQUIRED EVERY 70 FEET OF SEWER LINE AND/OR AT 90° SWEEPS IN LINES FROM HOUSE TO DRAIN FIELDS.

NOTE: ALL PARTS OF SEPTIC SYSTEMS (I.E., TANK, DISTRIBUTION BOX, TRENCHES) TO BE 100 FEET FROM WELL. (UNLESS OTHERWISE SPECIFICALLY AUTHORIZED)

NOTE: IF DEEP TRENCH(ES) ARE USED CALL FOR INSPECTION BEFORE AND AFTER PLACING GRAVEL IN TRENCH(ES).

NOTE: NO DRY WELL SHALL EXCEED 15 FOOT IN DIAMETER. NO ABSORPTION TRENCH TO EXCEED 100 FEET IN LENGTH.

NOTE: ALL PIPE FROM HOUSE TO SEPTIC TANK MUST BE CAST IRON OR SCHEDULE 40 PVC OR ABS.

PERMIT VOID AFTER TWO YEARS.

NOTE: INSTALL STAND PIPE ON SEPTIC TANK AND DRY WELL. STAND PIPES MUST BE 6 INCHES IN DIAMETER. CAST IRON, CONCRETE OR TERRA COTTA OR PVC OR ABS ACCEPTED. IF TOP OF SEPTIC TANK IS DEEPER THAN 3 FEET, MANHOLE TO GRADE REQUIRED.

NOTE: DISTRIBUTION BOXES MUST HAVE BAFFLES.

**\*INSTALLER IS RESPONSIBLE FOR OBTAINING FINAL APPROVAL ON THIS PERMIT**

\*CALL 461-9933 FOR INSPECTION OF SEPTIC SYSTEMS.

EH - 2-1186

A  
39824

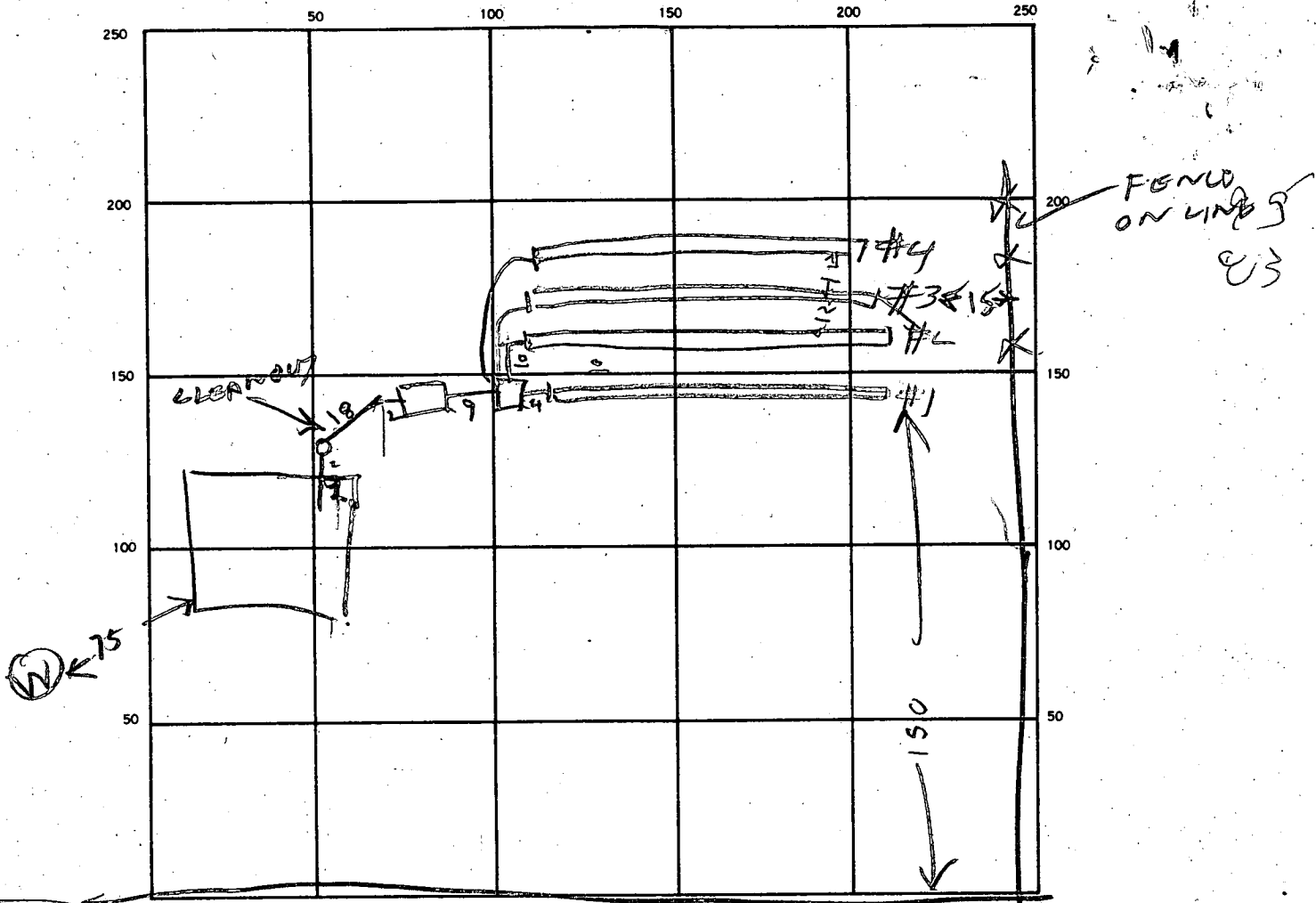

INDICATE NORTH - NAME ADJOINING ROADWAY AS BASE LINE.  
 MT ALBERT RD

ST HOUSE SEVERAL'

SEPTIC TANK LEVEL 1250

CLEANOUTS OK

DISTRIBUTION BOX LEVEL OK

DRAIN FIELD/TILE FIELD. DEPTH 6 5/8 FT. TRENCH WIDTH 3 FT. INLET DEPTH 4 FT.

EFFECTIVE GRAVEL DEPTH 2 2/2 FT. TOTAL LENGTH 96 FT. INSTALLED / REQUIRED

NUMBER OF TRENCHES 4 ONE SIDEWALL/BOTTOM AREA 1192 SQ. FT. 776

DRYWELL INSIDE DIAMETER \_\_\_\_\_ FT. EFFECTIVE DEPTH BELOW INLET \_\_\_\_\_ FT.

ABSORBENT AREA \_\_\_\_\_ SQ. FT.

REMARKS 9/15/87 LOCATION OK TRENCHES OK EXTRA AREA. RD

DATE SYSTEM APPROVED 9/15/87

INSPECTOR B. Hodyan

# APPLICATION

A 12914

SEWAGE DISPOSAL TESTING

P \_\_\_\_\_

MARYLAND STATE DEPARTMENT OF HEALTH

HOWARD COUNTY

ELLICOTT CITY

Septic Tank - 3 bedroom - 750 gal. 1000  
4 " - 1000 gal. 1250

DISTRICT 3

DATE 7/21/67

Dry Well - 100 sq ft absorbent sidewall area per bedroom to begin below ~~3 1/2 ft~~ 3 ft. Inlet pipe 3 ft below orig. grade. Max depth permitted for Dry Well below orig. grade is ~~6 1/2~~ 6 ft.

Place Dry Well 160 ft from front lot line and 125 ft from right sideline as seen when facing lot from Mt. Albert Rd.

TO: THE COUNTY HEALTH OFFICER  
ELLICOTT CITY, MARYLAND

I, HEREBY, APPLY FOR THE NECESSARY TESTS IN ORDER TO CONSTRUCT (OR RECONSTRUCT) A SEWAGE DISPOSAL SYSTEM.

PROPERTY OWNER Woodmark, Inc. Greg Kahlert

ADDRESS 231 Chatham Rd., Ellicott City, Md. PHONE HO 5-1345

PROPERTY LOCATION:

SUBDIVISION Woodmark, Inc. LOT NO. 54, Blk. C, Sec. 2

ROAD AND DESCRIPTION Road #111 12124 Mt. Albert Rd.

OCCUPANT \_\_\_\_\_ PHONE \_\_\_\_\_

PERSON TO CONSTRUCT SYSTEM \_\_\_\_\_

ADDRESS \_\_\_\_\_ PHONE \_\_\_\_\_

SIZE OF LOT 322' x 280' x 322' x 280' TYPE BLDG. 3 or 4  
NUMBER OF BEDROOMS

IF NOT SINGLE RESIDENCE DESCRIBE \_\_\_\_\_ BLDG. \_\_\_\_\_ SIGNED \_\_\_\_\_  
AND RETURNED 5-14-82

SIGNATURE OF APPLICANT /s/ Mark A. Wakefield OP#11605

APPROVED BY [Signature] FOR Dry Well DATE 5-7-68  
(KIND OF SYSTEM)

REJECTED BY \_\_\_\_\_ FOR \_\_\_\_\_ DATE \_\_\_\_\_  
(KIND OF SYSTEM)

HOLD PENDING FURTHER TESTS \_\_\_\_\_ DATE \_\_\_\_\_

REASONS FOR REJECTION OR HOLDING INSTALL SYSTEM 150' FROM FRONT LOT LINE

# THIS IS NOT A PERMIT

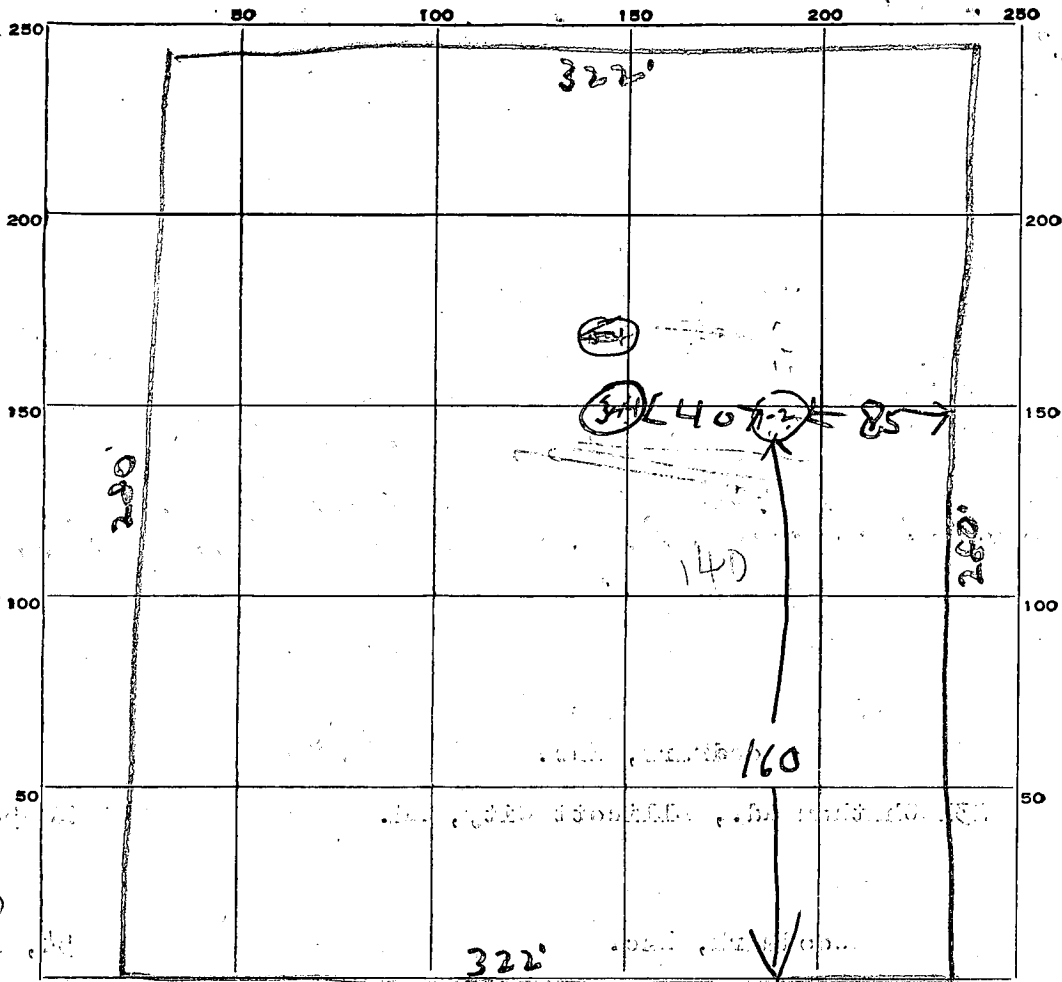

85  
40/5  
175

INDICATE NORTH - NAME ADJOINING ROADWAY AS BASE LINE.

Road A

DATE	TEST NO.	DEPTH	PRE-WET		TEST - 1" DROP		TIME
			START	STOP	START	STOP	
7/12/57	1	4 ft	11 22	11 24	11 24	11 29	5 min
	2	10 ft	11 23	11 24	11 24	11 28	4 min
	3	4 ft	11 24	11 27	11 27	11 33	6 min
	4	10 ft	11 24	11 26	11 26	11 32	6 min

SOIL AUGER FINDING \_\_\_\_\_

TESTED BY DM. + GHK

REMARKS \_\_\_\_\_

54c

JAMES R. IRVINE  
 CUSTOM RESIDENTIAL CONTRACTING  
 506 TIPPIN COURT  
 THURMONT, MD 21788  
 (301) 271-7515 - M.H.I.C. #25379

*9/6/87*  
*2/29/88*  
*1/9/89*  
*8/00*  
*Jan R. Irvine*  
 74  
 71  
 22  
 SEPTIC PLAN

I CERTIFY THE BELOW MEASUREMENTS AND ELEV. ARE ACTUAL & CORRECT.

LOT #54  
 WOODMARK DEV.  
 KAHLERT PROPERTY

SCALE 1" = 50'

*194*  
*176*  
*78*

PLEASE NOTE ADDITIONAL ELEVATIONS

EXISTING GRADE 445.0 AT  
 TRENCH.

INLET AT TRENCH 441.5

INLET OUT OF TANK 441.7  
 BRL

INLET OUT OF HOUSE  
 MAX DEPTH TO BE 442.8

*Please retain for  
 your files  
 S. Alue*

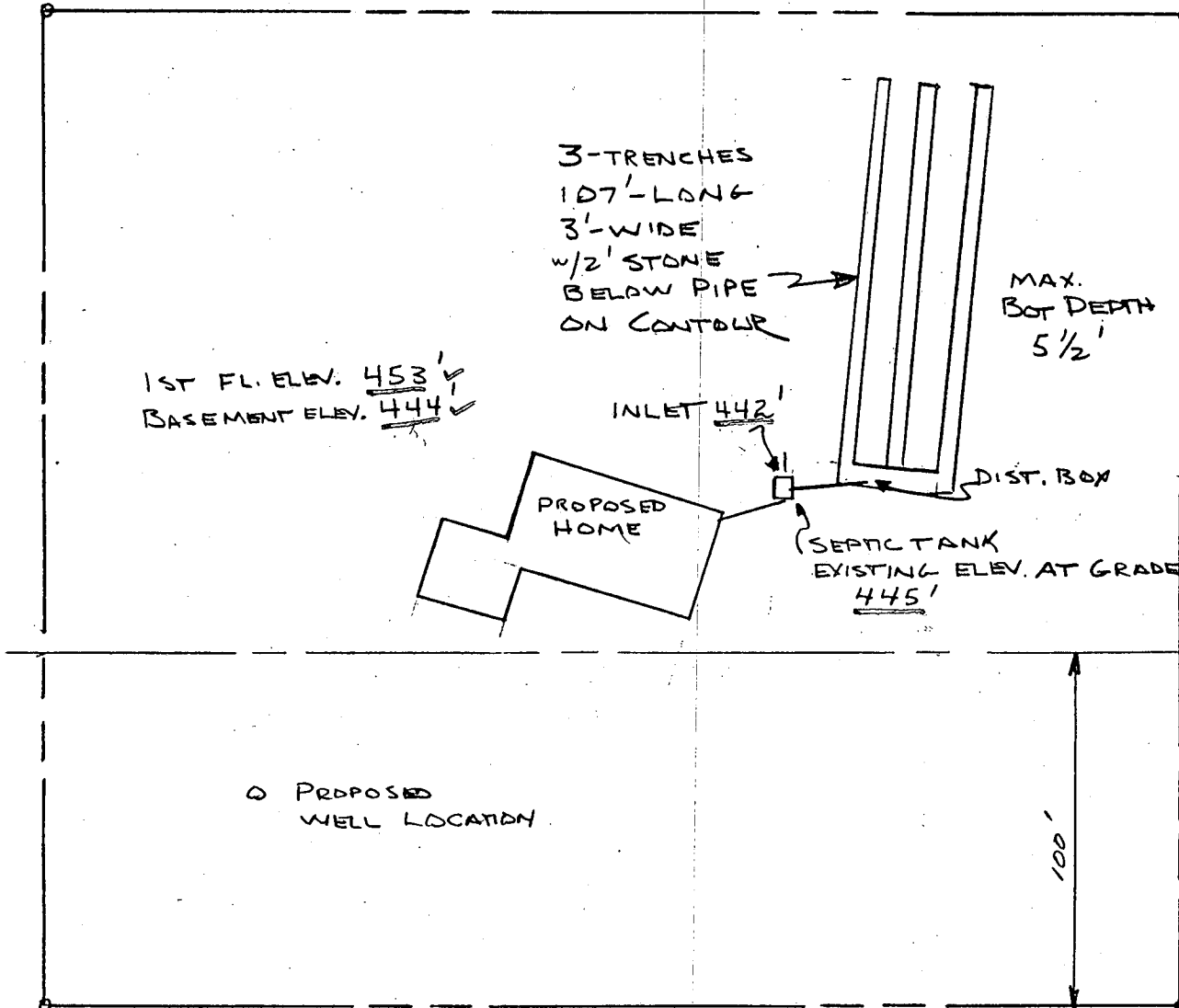

MT. ALBERT RD.

BLDG. PERMIT SIGNED  
 AND RETURNED 5/8/87

*5/4/87*  
*elimination of*  
*S. Alue*

JAMES R. IRVINE  
CUSTOM RESIDENTIAL CONTRACTING  
505 TIPPIN COURT  
TERRACOTT, MD 21738  
(301) 271-7915 • M.H.L.C. #25979

*Just done*

REVISED SEPTIC PLAN  
LOT # 54  
WOODMARK DEVL.  
KAHLERT PROPERTY  
SCALE 1" = 50'  
BUILDING PERMIT  
# 11605

I CERTIFY THE BELOW MEASUREMENTS ARE ACTUAL & CORRECT

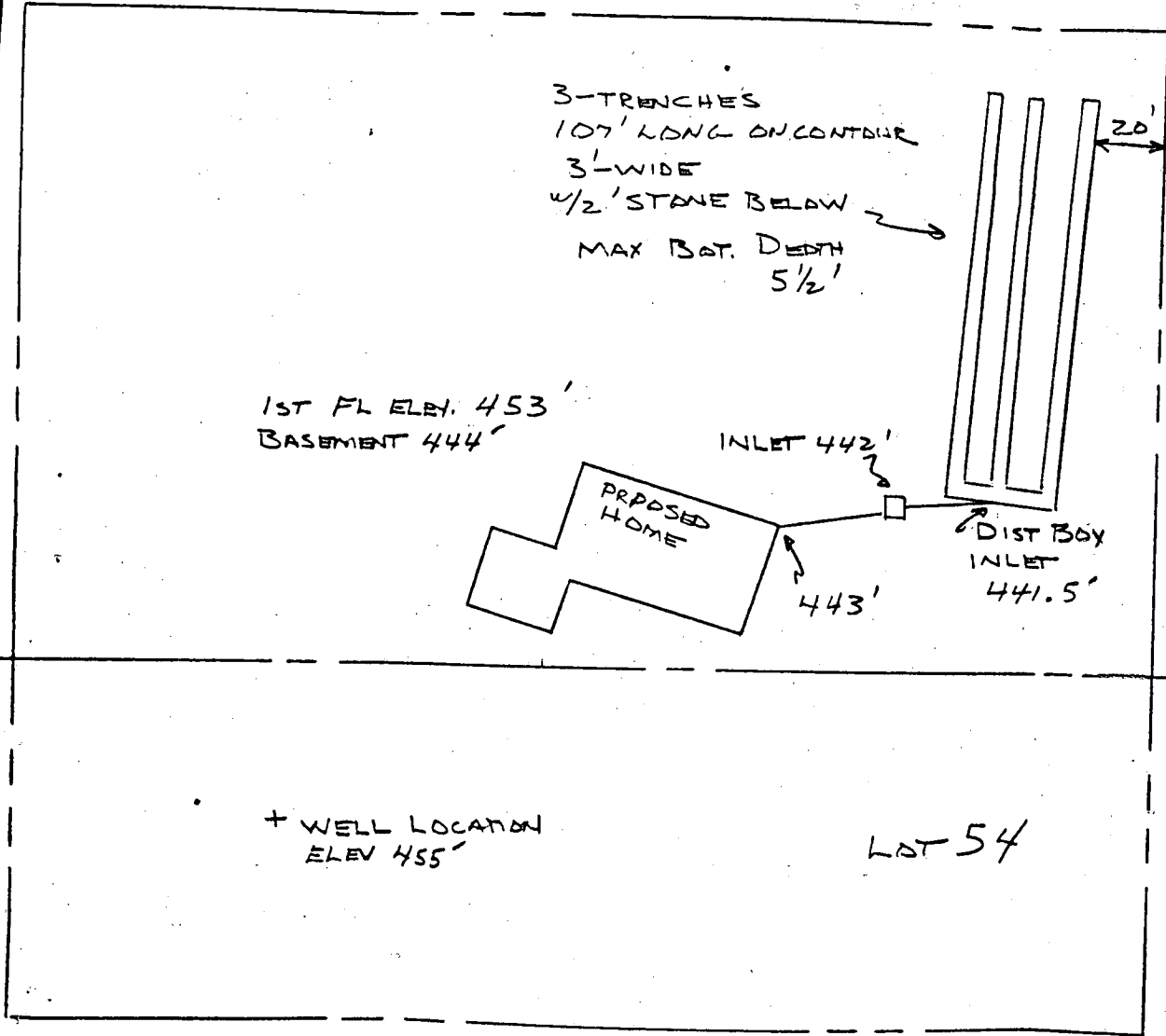

6/22/87  
Amendment  
of 806  
House move 25'  
elev. remain same

MT ALBERT RD

B 7 8212

SEQUENCE NO. (OEP USE ONLY)

STATE OF MARYLAND PERMIT TO DRILL WELL

please print or type

OEP PERMIT NUMBER

NO-81-2052

fill in this form completely

(THIS NUMBER IS TO BE PUNCHED IN COLS. 3-6 ON ALL CARDS)

Date Received

Empty date grid

OWNER INFORMATION

Mahient W. Greg

1915 Westchester Ave

Baltimore MD 21228

B 3

LOCATION OF WELL

Howard

Woodmark

SECTION 1 LOT 54 BLK C

Baltimore City

MILES FROM TOWN (enter 0 if in town) 2 MI

DRILLER INFORMATION

Joseph L. Mayne 238

Joseph L. Mayne Well Drilling

5512 Ridge Rd. Mt. Airy Md 21771

Joseph L. Mayne 4/4/87

B 4

DIRECTION OF WELL FROM TOWN (CIRCLE BOX)

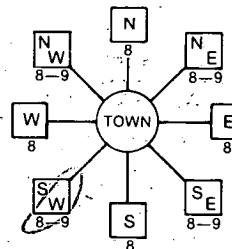

Mount Albert Rd.

ON WHICH SIDE OF ROAD (CIRCLE APPROPRIATE BOX)

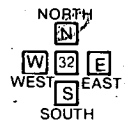

DISTANCE FROM ROAD 65 FT

WELL INFORMATION

APPROX. PUMPING RATE (GAL. PER MIN.) 5

AVERAGE DAILY QUANTITY NEEDED (GAL. PER DAY) 500

USE FOR WATER (CIRCLE APPROPRIATE BOX)

- Home (single or double household unit only)
Farming (livestock watering & agricultural irrigation)
Industrial, commercial, state and federal gov. other (requires appropriation permit)
Public or private water company (requires appropriation permit and state health department approval)
Test, observation, monitoring (may require appropriation permit)

NOT TO BE FILLED IN BY DRILLER HEALTH DEPARTMENT APPROVAL

Howard A-12914

OEP SIGNATURE DATE ISSUED

042787 B Nylon 10/27/87

NORTH GRID 522000 EAST GRID 0817000

APPROXIMATE DEPTH OF WELL 300 FEET

APPROXIMATE DIAMETER OF WELL 6 INCH

METHOD OF DRILLING (circle one)

- Bored (or Augered) Jetted Jetted & Driven
Air-Rotary Air-Percussion Rotary (Hydraulic Rotary)
Cable Reverse-Rotary Drive-Point
other

REPLACEMENT OR DEEPEMED WELLS (CIRCLE APPROPRIATE BOX)

- This well will not replace an existing well
This well will replace a well that will be abandoned and sealed
This well will replace a well that will be used as a standby
This well will deepen an existing well
Permit number of well to be replaced or deepened (if available)

SHOW MAJOR FEATURES OF BOX & LOCATE WELL WITH AN X

- SOURCES OF DRILLING WATER
1. Well
2.
3.

WRITE THE BOX NUMBER FROM THE MAP HERE

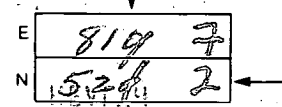

Location of 38' casing 1' above 32' open 12' bars 5/13/87

DRAW A SKETCH BELOW SHOWING LOCATION OF WELL IN RELATION TO NEARBY TOWNS AND ROADS AND GIVE DISTANCE FROM WELL TO NEAREST ROAD JUNCTION

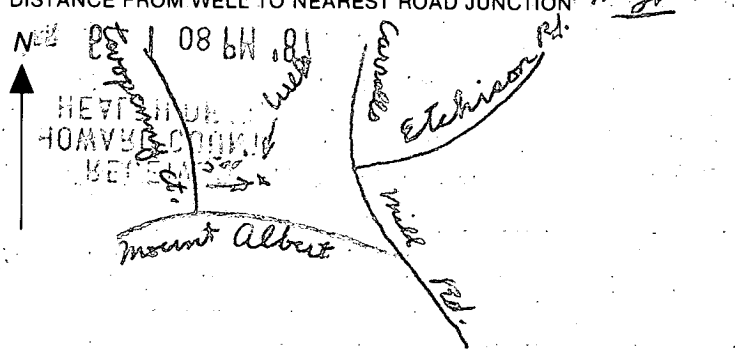

Not to be filled in by driller (OEP USE ONLY)

APPROP. PERMIT NUMBER GAP

FORCE PERMIT NO. NO-81-2052

SPECIAL CONDITIONS

**C1** 2404 SEQUENCE NO. (OEP USE ONLY)  
 (THIS NUMBER IS TO BE PUNCHED IN COLS. 3-6 ON ALL CARDS)

**STATE OF MARYLAND WELL COMPLETION REPORT**  
 FILL IN THIS FORM COMPLETELY PLEASE PRINT OR TYPE

THIS REPORT MUST BE SUBMITTED WITHIN 45 DAYS AFTER WELL IS COMPLETED.  
 COUNTY NUMBER **A-12914**

DATE Received          
 DATE WELL COMPLETED **05/13/89** Depth of Well **180** (TO NEAREST FOOT)  
 PERMIT NO. FROM "PERMIT TO DRILL WELL" **HO-81-2052**

OWNER **KAHLERT** first name **GRIG**  
 STREET OR RFD **MOUNT ALBERT CT.** TOWN **ELLICOTT CITY**  
 SUBDIVISION **WOODMARK** SECTION **1** BLK **C** LOT **54**

**WELL LOG**  
 Not required for driven wells

STATE THE KIND OF FORMATIONS PENETRATED, THEIR COLOR, DEPTH, THICKNESS AND IF WATER BEARING

DESCRIPTION (Use additional sheets if needed)	FEET		Check if water bearing
	FROM	TO	
SAND	0	32	
GRAY MICHA ROCK	32	180	

**GROUTING RECORD**  
 WELL HAS BEEN GROUTED (Circle Appropriate Box) **Y** **N**  
 TYPE OF GROUTING MATERIAL  
 CEMENT **CM** BENTONITE CLAY **BC**  
 NO. OF BAGS **12** NO. OF POUNDS **1128**  
 GALLONS OF WATER **72**  
 DEPTH OF GROUT SEAL (to nearest foot)  
 from **0** ft. to **32** ft.  
 (enter 0 if from surface)

**CASING RECORD**  
 casing types insert appropriate code below  
**ST** **CO**  
 STEEL CONCRETE  
**PL** **OT**  
 PLASTIC OTHER  
 MAIN CASING TYPE **ST** Nominal diameter top (main) casing (nearest inch) **6** Total depth of main casing (nearest foot) **38**

**OTHER CASING (if used)**  
 diameter inch depth (feet) from to

**SCREEN RECORD**  
 screen type or open hole insert appropriate code below  
**ST** **BR** **HO**  
 STEEL BRASS OPEN HOLE  
**PL** **OT**  
 PLASTIC OTHER

**C2**  
 DEPTH (nearest ft.)  
 EACH SCREEN  
 1 **10** **36** **180**  
 2  
 3  
 SLOT SIZE 1 2 3  
 DIAMETER OF SCREEN (NEAREST INCH)  
 from to

**A** CIRCLE APPROPRIATE LETTER A WELL WAS ABANDONED AND SEALED WHEN THIS WELL WAS COMPLETED  
**E** ELECTRIC LOG OBTAINED  
**P** TEST WELL CONVERTED TO PRODUCTION WELL

I HEREBY CERTIFY THAT THIS WELL HAS BEEN CONSTRUCTED IN ACCORDANCE WITH COMAR 10.17.13 "WELL CONSTRUCTION" AND IN CONFORMANCE WITH ALL CONDITIONS STATED IN THE ABOVE CAPTIONED PERMIT, AND THAT THE INFORMATION PRESENTED HEREIN IS ACCURATE AND COMPLETE TO THE BEST OF MY KNOWLEDGE.

DRILLERS IDENT. NO. **238**  
 DRILLERS SIGNATURE *Joseph P. Mays*

SITE SUPERVISOR (sign. of driller or journeyman responsible for sitework if different from permittee)

GRAVEL PACK IF WELL DRILLED WAS FLOWING WELL INSERT F IN BOX 68

OEP USE ONLY (NOT TO BE FILLED IN BY DRILLER)  
 T (E.R.O.S.) WQ  
 TELESCOPE CASING LOG INDICATOR OTHER DATA

**C3**  
**PUMPING TEST**  
 HOURS PUMPED (nearest hour) **9**  
 PUMPING RATE (gal. per min. to nearest gal.) **12**  
 METHOD USED TO MEASURE PUMPING RATE **bucket**  
 WATER LEVEL (distance from land surface)  
 BEFORE PUMPING **48**  
 WHEN PUMPING **52**  
 TYPE OF PUMP USED (for test)  
**A** air **P** piston **T** turbine  
**C** centrifugal **R** rotary **O** other (describe below)  
**J** jet **S** submersible

**PUMP INSTALLED**  
 DRILLER WILL INSTALL PUMP YES **NO**  
 IF DRILLER INSTALLS PUMP, THIS SECTION MUST BE COMPLETED FOR ALL WELLS EXCEPT HOME USE  
 TYPE OF PUMP INSTALLED PLACE (A,C,J,P,R,S,T,O) IN BOX - SEE ABOVE:  
 CAPACITY: GALLONS PER MINUTE (to nearest gallon)  
 PUMP HORSE POWER  
 PUMP COLUMN LENGTH (nearest ft.)  
 CASING HEIGHT (circle appropriate box and enter casing height)  
 + above } LAND SURFACE (nearest foot)  
 - below }

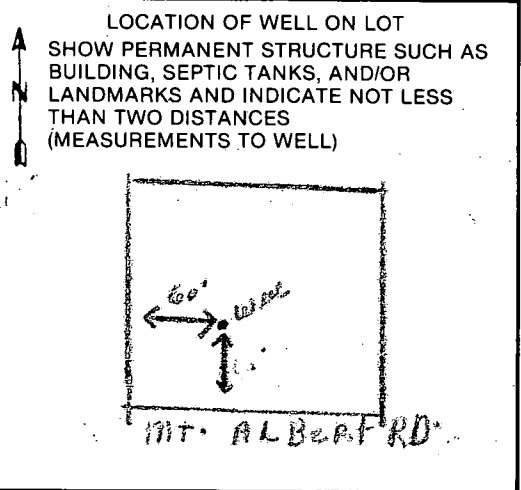

ON JOB AS PER CODE.

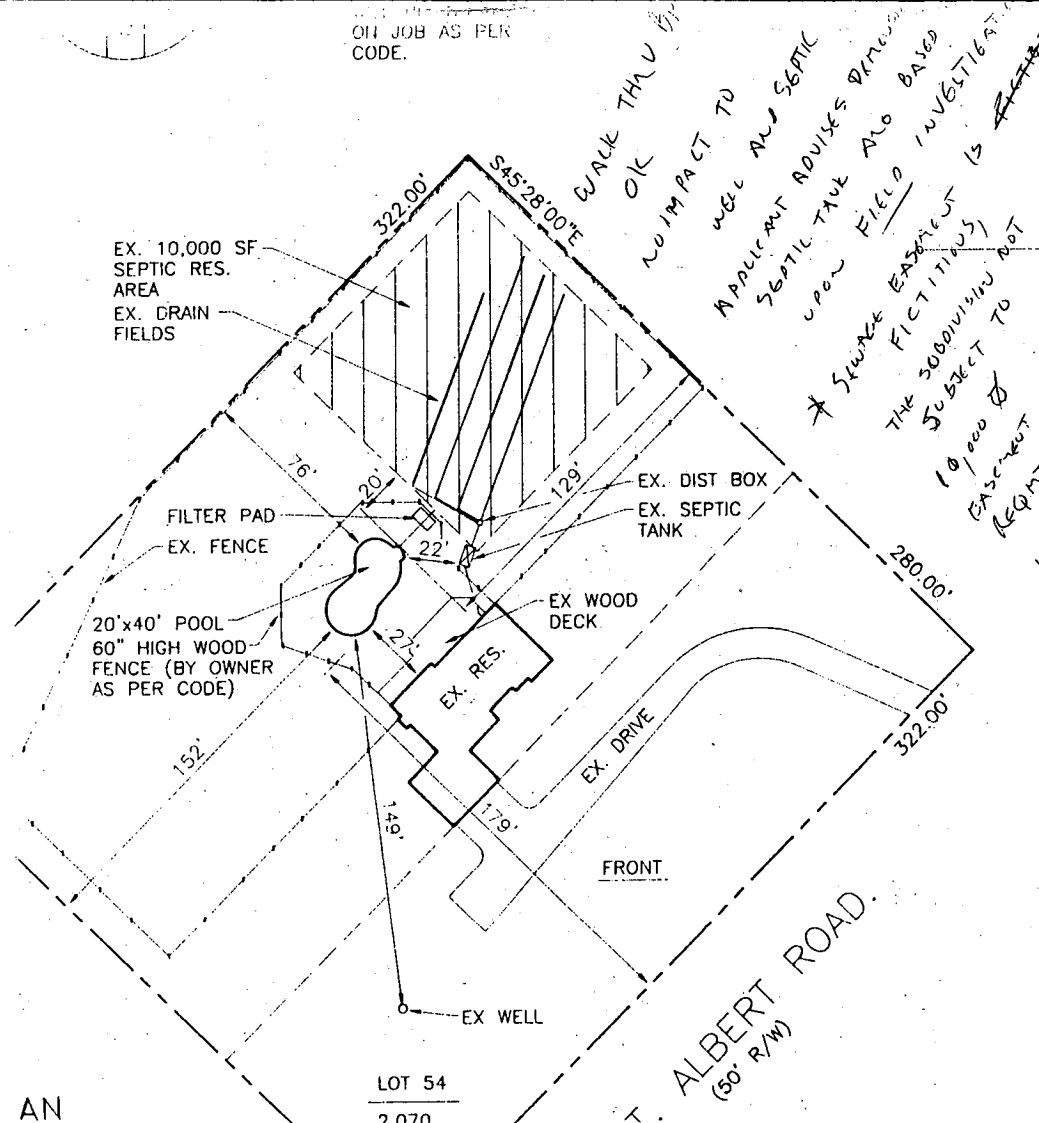

WALK THRU OK  
 NO IMPACT TO WELL AND SEPTIC  
 APPLICANT ADVISES DISTURBANCE  
 SEPTIC TAKE ALSO BASED  
 UPON FIELD INVESTIGATION  
 \* SOURCE EASEMENT  
 FICTITIOUS  
 SUBJECT TO  
 10,000 SF  
 EASEMENT  
 REQMT.  
 11/1/95  
 (Wilson)

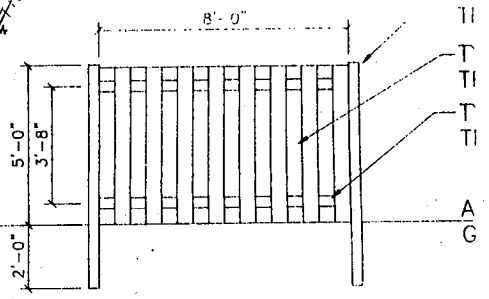

ELEVATION

5' HIGH BOARD ON BOARD FENCE  
NO SCALE

AN

LOT 54  
2.070

ALBERT ROAD  
(50' R/W)