

05-346215

# PERMIT

P 39522

A REPAIR

SEWAGE DISPOSAL SYSTEM

MARYLAND STATE DEPARTMENT OF HEALTH

DISTRICT \_\_\_\_\_

HOWARD COUNTY

DATE 6/30/87

BUREAU OF ENVIRONMENTAL HEALTH  
461-9933

## INDEXED

DATE SYSTEM APPROVED 5/22/87

INSPECTOR (Signature)

Jack Fyock

IS PERMITTED TO INSTALL \_\_\_\_\_ ALTER

ADDRESS \_\_\_\_\_ PHONE 988-9270

SUBDIVISION \_\_\_\_\_ ROAD 1/605 Hunting Lane LOT \_\_\_\_\_

PROPERTY OWNER Schroeder

ADDRESS \_\_\_\_\_

IF GARBAGE GRINDER IS USED INCREASE SEPTIC TANK CAPACITY BY 50% AND ABSORPTION AREA BY 22%.

GARBAGE GRINDER? YES \_\_\_\_\_ NO \_\_\_\_\_

SEPTIC TANK CAPACITY \_\_\_\_\_ GALLONS NUMBER OF BEDROOMS \_\_\_\_\_

REPAIR - CALL FOR INSPECTION WHEN GROUND IS OPENED UP SO SANITARIAN CAN RECOMMEND REPAIR:

*orange red clay / clay loam to 4' (some areas shallower  
some to 5') to mostly orange / brown / grey silty loam  
w/ 10% med frag weathered material.*

PLANS APPROVED BY C. Williams DATE 5/05/87

COVER NO WORK UNTIL INSPECTED AND APPROVED.

NEITHER THE HOWARD COUNTY COUNCIL NOR THE HEALTH DEPARTMENT IS RESPONSIBLE FOR THE SUCCESSFUL OPERATION OF ANY SYSTEM.

NOTE: CLEANOUT REQUIRED EVERY 70 FEET OF SEWER LINE AND/OR AT 90° SWEEPS IN LINES FROM HOUSE TO DRAIN FIELDS.

NOTE: ALL PARTS OF SEPTIC SYSTEMS (I.E., TANK, DISTRIBUTION BOX, TRENCHES) TO BE 100 FEET FROM WELL. (UNLESS OTHERWISE SPECIFICALLY AUTHORIZED)

NOTE: IF DEEP TRENCH(ES) ARE USED CALL FOR INSPECTION BEFORE AND AFTER PLACING GRAVEL IN TRENCH(ES).

NOTE: NO DRY WELL SHALL EXCEED 15 FOOT IN DIAMETER. NO ABSORPTION TRENCH TO EXCEED 100 FEET IN LENGTH.

NOTE: ALL PIPE FROM HOUSE TO SEPTIC TANK MUST BE CAST IRON OR SCHEDULE 40 PVC OR ABS.

PERMIT VOID AFTER TWO YEARS.

NOTE: INSTALL STAND PIPE ON SEPTIC TANK AND DRY WELL. STAND PIPES MUST BE 6 INCHES IN DIAMETER. CAST IRON, CONCRETE OR TERRA COTTA OR PVC OR ABS ACCEPTED. IF TOP OF SEPTIC TANK IS DEEPER THAN 3 FEET, MANHOLE TO GRADE REQUIRED.

NOTE: DISTRIBUTION BOXES MUST HAVE BAFFLES.

**\*INSTALLER IS RESPONSIBLE FOR OBTAINING FINAL APROVAL ON THIS PERMIT**

\*CALL 461-9933 FOR INSPECTION OF SEPTIC SYSTEMS.

EH - 2-1186

P 39522

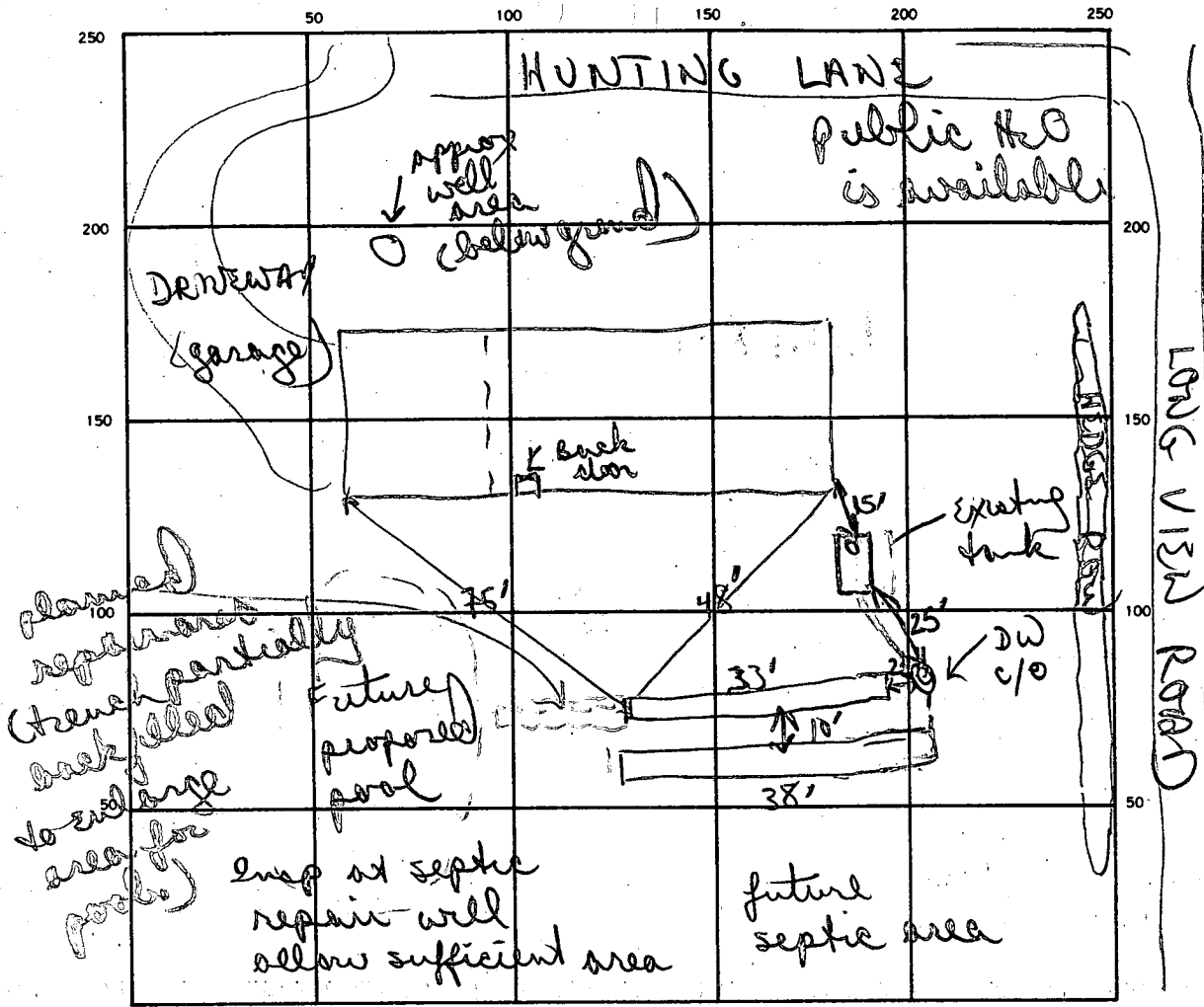

INDICATE NORTH. — NAME ADJOINING ROADWAY AS BASE LINE.

SEPTIC TANK. LEVEL existing CLEANOUTS existing on S.T. New D.W. c/o

DISTRIBUTION BOX. LEVEL \_\_\_\_\_

DRAIN FIELD/TILE FIELD. DEPTH 10 10 TRENCH WIDTH 2 FT. INLET DEPTH 4 FT.

EFFECTIVE GRAVEL DEPTH 6 6 FT. TOTAL LENGTH 33 38 FT.

NUMBER OF TRENCHES 2 ONE SIDEWALL/BOTTOM AREA 19.8 + 22.8 SQ. FT.

DRYWELL INSIDE DIAMETER \_\_\_\_\_ FT. EFFECTIVE DEPTH BELOW INLET 7-8 FT.

ABSORBENT AREA 426 SQ. FT.

REMARKS 5/22/87 OK to go 4-10 w/ repair area using 2 short trenches to allow for possible pool area. OK to finish adding stone pipe paper to both trenches OK to cover all work.

DATE SYSTEM APPROVED 5/22/87 INSPECTOR B Nijon