

4/29/87

AM

Tax ID

PERMIT

P 39403

A REPAIR

SEWAGE DISPOSAL SYSTEM

MARYLAND STATE DEPARTMENT OF HEALTH

DISTRICT _____

HOWARD COUNTY

DATE 5/27/87

BUREAU OF ENVIRONMENTAL HEALTH
461-9933

INDEXED

DATE SYSTEM APPROVED 4/30/87

INSPECTOR S. Alue

Jack Fyock

IS PERMITTED TO INSTALL X ALTER _____

ADDRESS _____ PHONE 988-9270

SUBDIVISION _____ ROAD 6553 Montgomery Rd LOT _____

PROPERTY OWNER C. O'Neill

ADDRESS _____

IF GARBAGE GRINDER IS USED INCREASE SEPTIC TANK CAPACITY BY 50% AND ABSORPTION AREA BY 22%.

GARBAGE GRINDER? YES _____ NO ✓

4 BED ROOMS

SEPTIC TANK CAPACITY 1250 GALLONS NUMBER OF BEDROOMS _____

REPAIR - CALL FOR INSPECTION WHEN GROUND IS OPENED UP SO SANITARIAN CAN RECOMMEND REPAIR.

TRENCH 92 FT LONG 6 FT WIDE
6 FT DEEP 1 1/2 FT STONE RUN TRENCH
OFF NEW 1500 GALL SEPTIC TANK
TOWARD THE REAR, ONLY ONE INSPECTION
OF TRENCH REQUIRED BH.

PLANS APPROVED BY C. Williams DATE 4/28/87

COVER NO WORK UNTIL INSPECTED AND APPROVED.

NEITHER THE HOWARD COUNTY COUNCIL NOR THE HEALTH DEPARTMENT IS RESPONSIBLE FOR THE SUCCESSFUL OPERATION OF ANY SYSTEM.

NOTE: CLEANOUT REQUIRED EVERY 70 FEET OF SEWER LINE AND/OR AT 90° SWEEPS IN LINES FROM HOUSE TO DRAIN FIELDS.

NOTE: ALL PARTS OF SEPTIC SYSTEMS (I.E., TANK, DISTRIBUTION BOX, TRENCHES) TO BE 100 FEET FROM WELL. (UNLESS OTHERWISE SPECIFICALLY AUTHORIZED)

NOTE: IF DEEP TRENCH(ES) ARE USED CALL FOR INSPECTION BEFORE AND AFTER PLACING GRAVEL IN TRENCH(ES).

NOTE: NO DRY WELL SHALL EXCEED 15 FOOT IN DIAMETER. NO ABSORPTION TRENCH TO EXCEED 100 FEET IN LENGTH.

NOTE: ALL PIPE FROM HOUSE TO SEPTIC TANK MUST BE CAST IRON OR SCHEDULE 40 PVC OR ABS.

PERMIT VOID AFTER TWO YEARS.

NOTE: INSTALL STAND PIPE ON SEPTIC TANK AND DRY WELL. STAND PIPES MUST BE 6 INCHES IN DIAMETER. CAST IRON, CONCRETE OR TERRA COTTA OR PVC OR ABS ACCEPTED. IF TOP OF SEPTIC TANK IS DEEPER THAN 3 FEET, MANHOLE TO GRADE REQUIRED.

NOTE: DISTRIBUTION BOXES MUST HAVE BAFFLES.

***INSTALLER IS RESPONSIBLE FOR OBTAINING FINAL APROVAL ON THIS PERMIT**

*CALL 461-9933 FOR INSPECTION OF SEPTIC SYSTEMS.

EH - 2-1186

39403

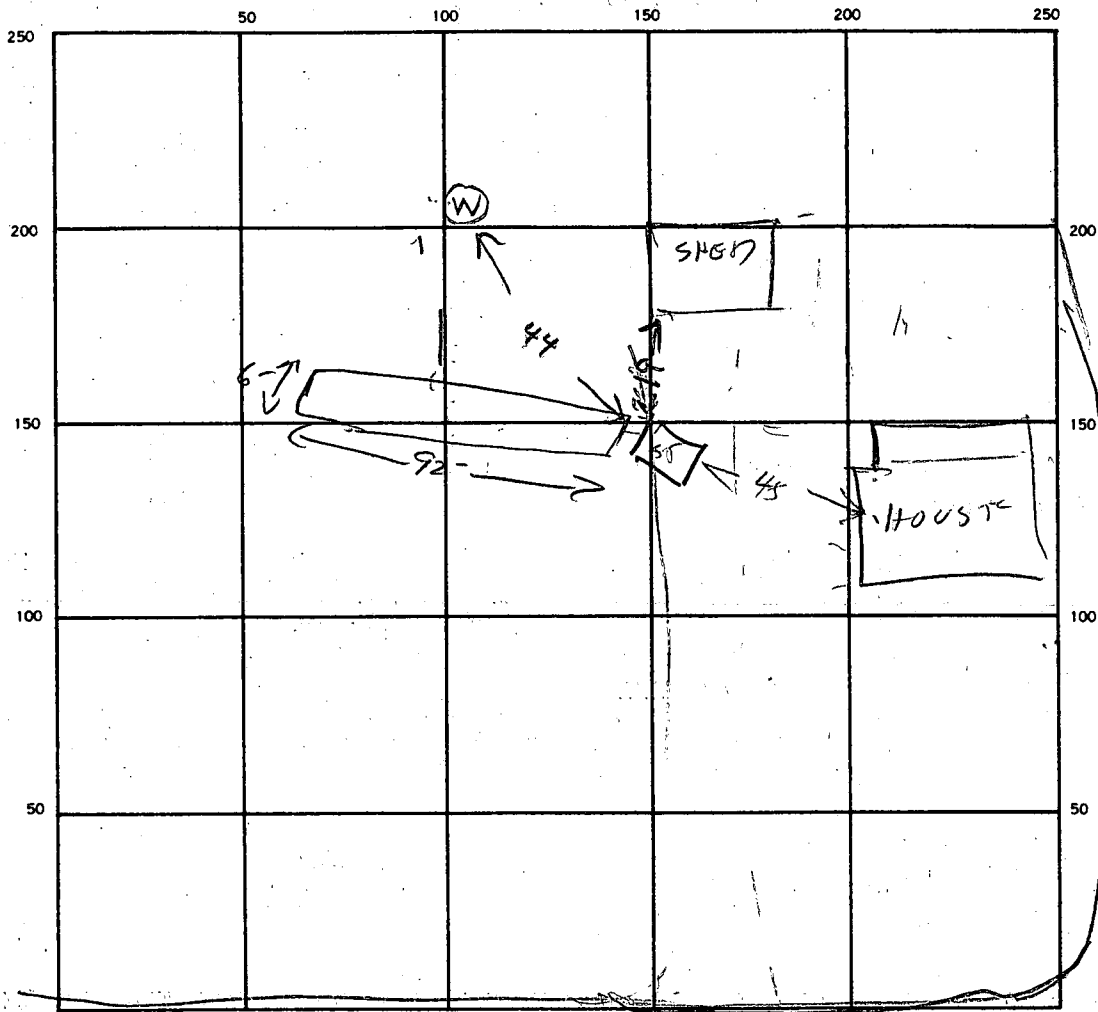

INDICATE NORTH. — NAME ADJOINING ROADWAY AS BASE LINE.
MONT GOMERY RD

SEPTIC TANK. LEVEL 1500 CLEANOUTS

DISTRIBUTION BOX. LEVEL _____

DRAIN FIELD/TILE FIELD. DEPTH 6 FT. TRENCH WIDTH 6 FT. INLET DEPTH 4.5 FT.

EFFECTIVE GRAVEL DEPTH 1.5 FT. TOTAL LENGTH 92 FT.

NUMBER OF TRENCHES 1 ONE SIDEWALL/BOTTOM AREA 552 SQ. FT.

DRYWELL INSIDE DIAMETER _____ FT. EFFECTIVE DEPTH BELOW INLET _____ FT.

ABSORBENT AREA 552 SQ. FT.

REMARKS 4/29/87 CITY WATER TANK SET VISUAL HOLD DUG

WATER ON FRONT OF LOT SO MEDIUM DEPTH TRENCH INSTALLED R/L

DATE SYSTEM APPROVED 7-30-87

INSPECTOR S. Abel