

5/22/87
9:30 AM

05-341124

PERMIT

P 39116

A REPAIR

SEWAGE DISPOSAL SYSTEM

MARYLAND STATE DEPARTMENT OF HEALTH DISTRICT _____

HOWARD COUNTY

BUREAU OF ENVIRONMENTAL HEALTH

461-9933

DATE 4/13/87

DATE SYSTEM APPROVED 5/28/87

INDEXED

INSPECTOR Stamps

Marshall Bittner General Contracting IS PERMITTED TO INSTALL ALTER _____

ADDRESS 1819 East Street, Baltimore, MD 21227 PHONE 242-7839

SUBDIVISION _____ ROAD 6598 Mink Hollow Rd LOT _____

PROPERTY OWNER Heacock

ADDRESS _____

IF GARBAGE GRINDER IS USED INCREASE SEPTIC TANK CAPACITY BY 50% AND ABSORPTION AREA BY 22%.

GARBAGE GRINDER? YES _____ NO _____

SEPTIC TANK CAPACITY _____ GALLONS NUMBER OF BEDROOMS _____

REPAIR - CALL FOR INSPECTION WHEN GROUND IS OPENED UP SO SANITARIAN CAN RECOMMEND REPAIR.

ADD TRENCHES MINIMUM EFFECTIVE SIDEWALL AREA 360 SQFT TOTAL

INLET 5' BOTTOM 10' ~~TANK~~ 5' GRAVEL BELOW PIPE.

* REPAIR REQUIRES TO ACCOMMODATE APPROVED ADDITION TO HOUSE. 5/28/87 CW

PLANS APPROVED BY C. Williams DATE 4/13/87

COVER NO WORK UNTIL INSPECTED AND APPROVED.

NEITHER THE HOWARD COUNTY COUNCIL NOR THE HEALTH DEPARTMENT IS RESPONSIBLE FOR THE SUCCESSFUL OPERATION OF ANY SYSTEM.

NOTE: CLEANOUT REQUIRED EVERY 70 FEET OF SEWER LINE AND/OR AT 90° SWEEPS IN LINES FROM HOUSE TO DRAIN FIELDS.

NOTE: ALL PARTS OF SEPTIC SYSTEMS (I.E., TANK, DISTRIBUTION BOX, TRENCHES) TO BE 100 FEET FROM WELL. (UNLESS OTHERWISE SPECIFICALLY AUTHORIZED)

NOTE: IF DEEP TRENCH(ES) ARE USED CALL FOR INSPECTION BEFORE AND AFTER PLACING GRAVEL IN TRENCH(ES).

NOTE: NO DRY WELL SHALL EXCEED 15 FOOT IN DIAMETER. NO ABSORPTION TRENCH TO EXCEED 100 FEET IN LENGTH.

NOTE: ALL PIPE FROM HOUSE TO SEPTIC TANK MUST BE CAST IRON OR SCHEDULE 40 PVC OR ABS.

PERMIT VOID AFTER TWO YEARS.

NOTE: INSTALL STAND PIPE ON SEPTIC TANK AND DRY WELL. STAND PIPES MUST BE 6 INCHES IN DIAMETER. CAST IRON, CONCRETE OR TERRA COTTA OR PVC OR ABS ACCEPTED. IF TOP OF SEPTIC TANK IS DEEPER THAN 3 FEET, MANHOLE TO GRADE REQUIRED.

NOTE: DISTRIBUTION BOXES MUST HAVE BAFFLES.

***INSTALLER IS RESPONSIBLE FOR OBTAINING FINAL APROVAL ON THIS PERMIT**

*CALL 461-9933 FOR INSPECTION OF SEPTIC SYSTEMS.

EH - 2-1186

P-39116

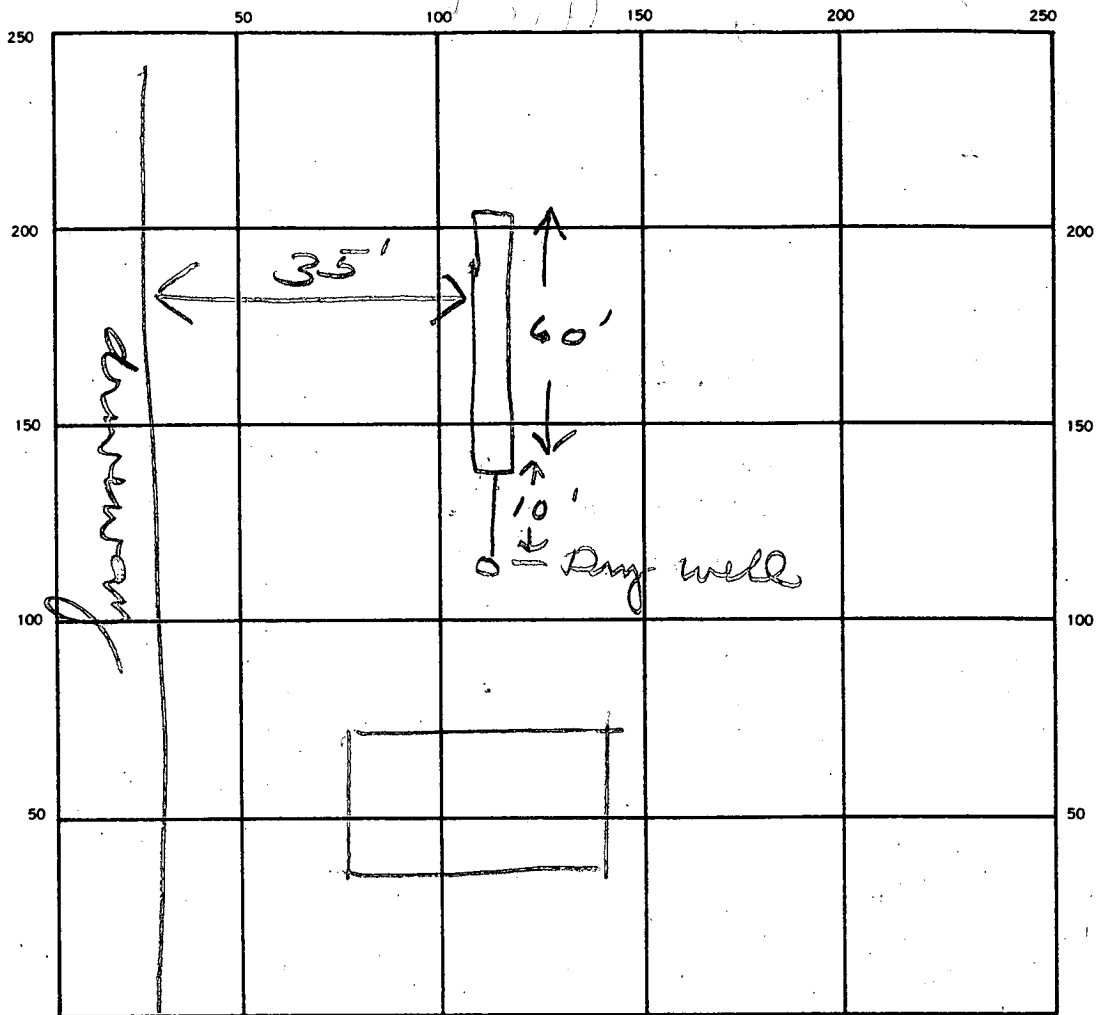

INDICATE NORTH — NAME ADJOINING ROADWAY AS BASE LINE.

Mark Hollow

SEPTIC TANK. LEVEL _____ CLEANOUTS _____

DISTRIBUTION BOX. LEVEL _____

DRAIN FIELD/TILE FIELD. DEPTH 10 FT. TRENCH WIDTH 2 FT. INLET DEPTH 5 FT.

EFFECTIVE GRAVEL DEPTH 5 FT. TOTAL LENGTH 60 FT.

NUMBER OF TRENCHES 1 ONE SIDEWALL/BOTTOM AREA 300 SQ. FT.

DRYWELL INSIDE DIAMETER _____ FT. EFFECTIVE DEPTH BELOW INLET _____ FT.

ABSORBENT AREA _____ SQ. FT.

REMARKS 5/28/87 OK to cover all work *[Signature]*

DATE SYSTEM APPROVED 5/28/87 INSPECTOR *Stayer*