

12/23/99
2:37pm
1/27/00 C.O.
4/12/00
2:00 pump check

PERMIT

SEWAGE DISPOSAL SYSTEM

DEPARTMENT OF HEALTH AND MENTAL HYGIENE

P 512781

A 39725

DISTRICT _____

DATE 10/27/99

HOWARD COUNTY HEALTH DEPARTMENT
BUREAU OF ENVIRONMENTAL HEALTH
~~XXXXXX~~ 410-313-2640

INDEXED

DATE SYSTEM APPROVED 4/12/00

INSPECTOR DBS

Fogle's Septic Clean, Inc. IS PERMITTED TO INSTALL ALTER

ADDRESS 580 Obrecht Road, Sykesville, MD 21784 PHONE 410-795-5670

SUBDIVISION Hawksfield LOT 22 ROAD 3101 Old Oak Drive

PROPERTY OWNER Wayne Greenfield Albert Myers

ADDRESS _____

SEPTIC TANK CAPACITY 1250 GALLONS

PUMPED SEPTIC SYSTEM PROPOSED

NUMBER OF BEDROOMS 4

INSTALL: 1-1250 Gallon Top Seamed Pump Chamber
NOTES: - Septic pump detail to be provided by installer prior to issuance of septic permit.
- Pum performance test is necessary prior to Health Department approval of pumped septic system.

180 SQUARE FEET PER BEDROOM

LINEAR FEET OF TRENCH REQUIRED 240

TRENCHES Trench to be 3 feet wide. Inlet 3.5 feet below original grade. Bottom maximum depth 5.0 feet below original grade. Effective area begins at 3.5 feet below original grade. 1.5 feet of stone below distribution pipe.

LOCATION - Place the distribution box 90 feet from the left rear (182.00') lot line and 75 feet from the right rear (240.34') lot line. Install trenches on contour in both directions from distribution box.

NOTES - No trench to exceed 100 feet in length. Provide 6" - 8". Provide 6" - 8" diameter cleanout and cap to grade or above on septic tank. 10/6/99 O.K. (DBS)

PLANS APPROVED BY Ronald J. Pinkley DATE 9-08-1999

COVER NO WORK UNTIL INSPECTED AND APPROVED

NEITHER THE HOWARD COUNTY COUNCIL NOR THE HEALTH DEPARTMENT IS RESPONSIBLE FOR THE SUCCESSFUL OPERATION OF ANY SYSTEM

NOTE: CLEANOUT REQUIRED EVERY 70 FEET OF SEWER LINE AND/OR AT 90° SWEEPS IN LINES FROM HOUSE TO DRAIN FIELDS. 90° ELBOWS NOT ACCEPTABLE.

NOTE: ALL PARTS OF SEPTIC SYSTEMS (I.E. TANK, DISTRIBUTION BOX, TRENCHES) TO BE 100 FEET FROM WELL (UNLESS OTHERWISE SPECIFICALLY AUTHORIZED)

NOTE: IF DEEP TRENCH(ES) ARE USED CALL FOR INSPECTION BEFORE AND AFTER PLACING GRAVEL IN TRENCH(ES)

NOTE: NO DRY WELL SHALL EXCEED 15 FOOT IN DIAMETER NO ABSORPTION TRENCH TO EXCEED 100 FEET IN LENGTH

NOTE: ALL PIPE FROM HOUSE TO SEPTIC TANK MUST BE CAST IRON OR SCHEDULE 35/40 PVC OR ABS

PERMIT VOID AFTER TWO YEARS

NOTE: INSTALL STAND PIPE ON SEPTIC TANK AND DRY WELL STAND PIPES MUST BE 6 INCHES IN DIAMETER CAST IRON, CONCRETE OR TERRA COTTA OR PVA OR ABS ACCEPTED. IF TOP OF SEPTIC TANK IS DEEPER THAN 3 FEET, MANHOLE TO GRADE REQUIRED.

NOTE: DISTRIBUTION BOXES MUST HAVE BAFFLES

***INSTALLER IS RESPONSIBLE FOR OBTAINING FINAL APPROVAL ON THIS PERMIT**

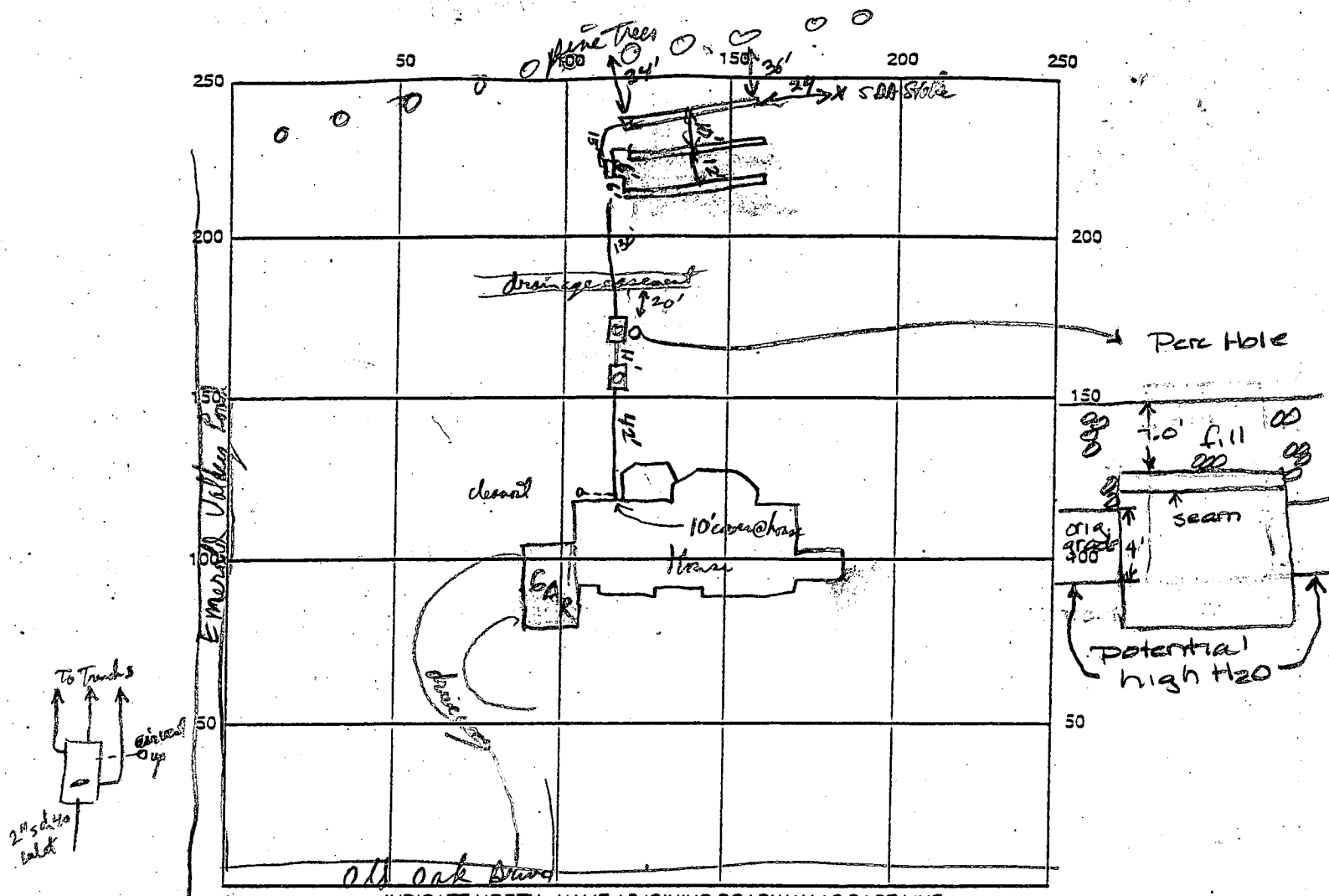

INDICATE NORTH - NAME ADJOINING ROADWAY AS BASE LINE

pump Chamber 1500 gal top seam single chambered
 SEPTIC TANK LEVEL 1500 gal " " " " CLEANOUTS HSE, Manhole riser on both PC & S.T. *cleanout on tank lids*
 DISTRIBUTION BOX LEVEL used auto levelers in dist box plus 2" vent pipe out of side port in dist box
 DRAIN FIELD/TILE DEPTH _____ FT. TRENCH WIDTH _____ FT. INLET DEPTH _____ FT.
 EFFECTIVE GRAVEL DEPTH _____ FT. TOTAL LENGTH 80/80/80 FT. = 240
 NUMBER OF TRENCHES 3 ONE SIDEWALL/BOTTOM AREA _____ SQ. FT.
 DRYWALL INSIDE DIAMETER N/A FT. EFFECTIVE DEPTH BELOW INLET N/A FT.
 ABSORBENT AREA N/A SQ. FT.

REMARKS: 5' or under regular Manhole riser's OK, if 6' need riser or holder in Manhole riser.
House construction OK, OK to cover tanks & the cover lines when work complete - Use both Tar & hydrolic cement
on risers to Make water tight. Very dark grey or 2" red mottles in soil to 6" above tank lids = seasonally High water table
Reason for water tightness & confined space safety requirements above. RPP 12/23/99
Drain field system installed & covered except for dist. box. Piping from PC also covered. S.T. lids have deep access. Manholes
at New S.T. site. RPP 12/28/99
 DATE SYSTEM APPROVED 4/2/00 INSPECTOR [Signature]
4/2/00 FINAL INSP - Pump check OK. DCD
1/28/00 Perc hole dug tank seam not in H2O, only the bottom of the tank OK to cover AU

8-23-99

Lot 22
HAWKSFIELD
ESTATES

ATTN BRIAN
BAKER

PRIVATE USE IN COMMON
LOTS 17 THROUGH 22
well is in original location
per Andy Greenfield House
8/9/8/99

Boo 11 98/4
Approved Septic System Plan
Howard County Health Department

Total linear feet of trench
required 240 feet

Width of trench(es) 3.0 feet

Depth of trench(es) 5.0 feet

Depth of stone required below
distribution pipe 1.5 feet

Ronald Walker
Signature Date 8/24/99

The protective steel
around the S.H.C. will be
determined at the time of installation

Emerald
VALLEY

20' DRAINAGE &
UTILITY EASEMENT

15" R.C.P.

Inv. of S.H.C.
489.2
(1.2' clearance)

1500 GAL SEPTIC
INV IN 493.3
INV OUT 493.0

PUMP TANK
INV IN 487.6

EX GRD 4930
RISO PIPE INV: 490.9
SP EX. S.D. PIPE 492.17

INV 494.1
FF 499.34
B 489.67

GAR.

OAK
(PUBLIC ROAD)

DRIVE

OLD



APPLICATION

PERCOLATION TESTING

A 39725
P _____

HOWARD COUNTY HEALTH DEPARTMENT
BUREAU OF ENVIRONMENTAL HEALTH
P.O. BOX 476 ELLICOTT CITY, MARYLAND 21043
TELEPHONE 461-9933

*8/13/87
received
pending plat
(RA)*

DISTRICT _____
DATE 7/15/89

TO: THE COUNTY HEALTH OFFICER
ELLICOTT CITY, MARYLAND

I HEREBY APPLY FOR THE NECESSARY TEST IN ORDER TO CONSTRUCT (OR RECONSTRUCT) A SEWAGE DISPOSAL SYSTEM.

PROPERTY OWNER RONALD S. LANEVE WAYNE GREENFIELD

ADDRESS 11799 TRIADELPHIA ROAD PHONE 301-531-6161
ELLICOTT CITY, MARYLAND 21043

PROSPECTIVE BUYER _____
ADDRESS _____ PHONE _____

PROPERTY LOCATION:

SUBDIVISION _____ LOT NO. 36
22 Preliminary

ROAD AND DESCRIPTION SOUTH OF MARYLAND ROUTE 144 AND SOUTHEAST OF
TRIADELPHIA ROAD (3101 Old Oak Drive)

TAX MAP 16923 PARCEL # 40

~~PERMIT SIGNATURE~~
~~RETURNED 8-24-89~~
Serial # B10119814

SIZE OF LOT 3 ACRES TYPE BLDG. SFD - 4 Bm
(SINGLE FAMILY DWELLING OR COMMERCIAL)

THE SYSTEM INSTALLED UNDER THIS APPLICATION IS ACCEPTABLE ONLY UNTIL PUBLIC FACILITIES BECOME AVAILABLE. I FULLY UNDERSTAND THE FEE CONNECTED WITH THE FILING OF THIS PERC TEST APPLICATION IS NON-REFUNDABLE UNDER ANY CIRCUMSTANCES. I ALSO AGREE TO COMPLY WITH ALL M.O.S.H.A. REQUIREMENTS IN TESTING THIS LOT.

(SIGNATURE OF APPLICANT)

APPROVED BY _____ FOR _____ DATE _____

REJECTED BY _____ FOR _____ DATE _____

HOLD PENDING FURTHER TESTS _____ DATE _____

REASONS FOR REJECTION OR HOLDING for field located holes & sub-e plat

THIS IS NOT A PERMIT

(RUN TRENCHES)
B → D

A + D
SOIL PROFILE

0
brown/tan
white hard
sandstone
shut frags
w/ clay silt
lean
4'
to grey/white
powdery
silty mica
lean w/
5% small
scattered
12" frags

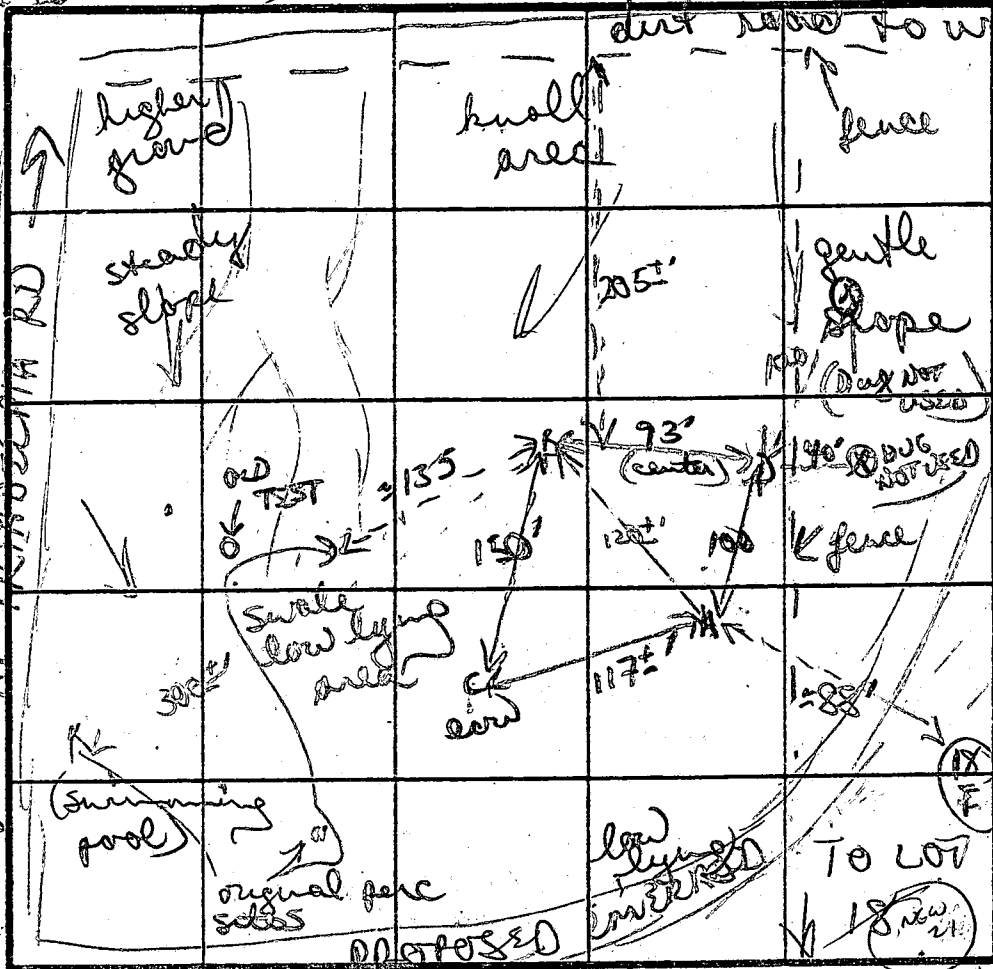

brown/tan
clay/clay
lean 4-5'
to brown/
light silty
lean w/
patches
orange clay
silt

TO LOT 13B
19

7 PERC
0 min
180 lb/cu

hard/chunky
orange/brown
clay 3'
clay/silt
lean 5'
to tan/white
silty mica
lean w/
few small
scattered frags
B → D

DATE	TEST NO.	DEPTH	PRE-WET		TEST - 1" DROP		TIME	
			START	STOP	START	STOP		
8/13/87	A	4' S	1025	1026	1026	1028	2M 30A	
		12' D	both (see profile)					
	B	3 1/2' S	1031	1032	1032	1034	2M 10A	
		7' M	1034	1035	1035	1037	2M 10A	
		13' D	both (see profile)					
	C	4 1/2' S	231	244	244	308	24M 10A	
		13 1/2' D	both (see profile)					
	D	4' S	232	234	234	236	2M 10A	
		13' D	both (see profile)					

Inlet 3.5'
Bottom 5.0'

REMARKS: Perc field adjusted out of existing pool area + to area not sure of lot orientation

TYPE OF SOIL: mostly tan/light silty mica lean below 3-4' clays

TESTED BY: B Dupin

ALSO PRESENT: Harsch

C1. 06786

SEQUENCE NO. (MDE USE ONLY) 7/22/99 OK AM

STATE OF MARYLAND WELL COMPLETION REPORT

THIS REPORT MUST BE SUBMITTED WITHIN 45 DAYS AFTER WELL IS COMPLETED.

COUNTY NUMBER A39725

ST/CO USE ONLY DATE Received 07 22 99

DATE WELL COMPLETED 07 08 99

Depth of Well 22 230 26 (TO NEAREST FOOT)

PERMIT NO. FROM "PERMIT TO DRILL WELL" HO-94-2290

OWNER: Nip Data Corp, STREET OR RFD: Old Oak Dr, TOWN: W Friendship, SUBDIVISION: Hawksfield, SECTION: , LOT: 22

WELL LOG table with columns: DESCRIPTION, FEET (FROM, TO), check if water bearing. Includes entries like Soft Br. Mica, Hard Blue Sandstone, etc.

GROUTING RECORD: WELL HAS BEEN GROUTED (Y), TYPE OF GROUTING MATERIAL: CEMENT (CM), BENTONITE CLAY (BC), NO. OF BAGS: 22, NO. OF POUNDS: 2158

CASING RECORD: MAIN CASING TYPE: ST (STEEL), Nominal diameter: 6, Total depth: 70

OTHER CASING (if used): PL 4 diameter inch, depth (feet) from 190 to 230

SCREEN RECORD: screen type or open hole: PL (PLASTIC)

PUMPING TEST: HOURS PUMPED: 3, PUMPING RATE: 12, MEASURE PUMPING RATE: Submersible

PUMP INSTALLED: DRILLER WILL INSTALL PUMP: YES (NO), TYPE OF PUMP INSTALLED: S (submersible)

NUMBER OF UNSUCCESSFUL WELLS: 1

WELL HYDROFRACTURED: YES (Y)

CIRCLE APPROPRIATE LETTER: A, E, P

DRILLERS LIC. NO. 1: MW D 296, Ronald Kyker

LIC. NO. 2: MW D 334, Dana Kyker

SITE SUPERVISOR (sign. of driller or journeyman responsible for sitework if different from permittee)

DEPTH (nearest ft.): PL 190 220, SLOT SIZE 1: 0.010 3

GRAVEL PACK IF WELL DRILLED: WAS FLOWING WELL, INSERT F IN BOX 68

MDE USE ONLY (NOT TO BE FILLED IN BY DRILLER): TELESCOPE CASING, LOG INDICATOR

LOCATION OF WELL ON LOT: SHOW PERMANENT STRUCTURE SUCH AS BUILDING, SEPTIC TANKS, AND /OR LANDMARKS AND INDICATE NOT LESS THAN TWO DISTANCES (MEASUREMENTS TO WELL). Includes drawing of Old Oak Road and Emerald Valley Rd.

B 1 **8671** SEQUENCE NO. (MDE USE ONLY)
 (THIS NUMBER IS TO BE PUNCHED IN COLS. 3-6 ON ALL CARDS)

STATE OF MARYLAND
 PERMIT TO DRILL WELL
 please print or type

STATE PERMIT NUMBER
40-94-2290
 fill in this form completely

Date Received (APA) **052899**
 OWNER INFORMATION
DIGI-DATA HOLDINGS
 15 Last Name Owner First Name 34
9881 BEDFORD LANE PERKY
 38 Street or RFD 65
COLUMBIA MD 21046
 57 town 70 State 72 Zip 76

B 3 LOCATION OF WELL
HOWARD COUNTY
HAWKSHIELD ESTATES
 23 SUBDIVISION 42
 SECTION **1** LOT **22**
 44 46 48 50
WEST FRIENDSHIP
 52 NEAREST TOWN 71
 MILES FROM TOWN (enter 0 if in town) **2** MI
 73 76 77 78

DRILLER INFORMATION
 CIRCLE: MSD/MGD/MWD
Ronald Kyles License No. **2916**
 Driller's Name 77 License No. 80
Westminster Rotary Well Drilling
 Firm Name
PO BOX 86, Westminster, MD 21158
 Address
Ronald Kyles Date **5/15/99**
 Signature Date

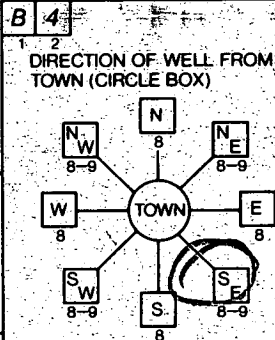

Emerald Valley Rd
 11 NEAR WHAT ROAD 30
 ON WHICH SIDE OF ROAD (CIRCLE APPROPRIATE BOX)
 NORTH
 WEST EAST
 SOUTH
 34 **500** 37 DISTANCE FROM ROAD
 ENTER FT OR MI **FT**
 38 39
 TAX MAP: **16** BLK: **20** PARCEL: **288**

B 2 WELL INFORMATION
 APPROX. PUMPING RATE (GAL. PER MIN.) **5**
 AVERAGE DAILY QUANTITY NEEDED (GAL. PER DAY) **450**
 14 20

USE FOR WATER (CIRCLE APPROPRIATE BOX)
 HOME (SINGLE OR DOUBLE HOUSEHOLD UNIT ONLY)
 FARMING (LIVESTOCK WATERING & AGRICULTURAL IRRIGATION)
 INDUSTRIAL, COMMERCIAL, STATE AND FEDERAL GOV. OTHER (REQUIRES APPROPRIATION PERMIT)
 PUBLIC OR PRIVATE WATER COMPANY (REQUIRES APPROPRIATION PERMIT AND STATE HEALTH DEPARTMENT APPROVAL)
 TEST, OBSERVATION, MONITORING (MAY REQUIRE APPROPRIATION PERMIT)

NOT TO BE FILLED IN BY DRILLER HEALTH DEPARTMENT APPROVAL
Howard Co COUNTY NAME
A 39725 COUNTY NO.
 STATE SIGNATURE _____ INSERT S
 DATE ISSUED **06/16/99** **A McMeel** **6/16/00**
 43 48 CO SIGNATURE EXP. DATE
 NORTH GRID **520000** EAST GRID **820000**
 50 55 57 63

APPROXIMATE DEPTH OF WELL **250** FEET
 24 28

APPROXIMATE DIAMETER OF WELL **6** INCH
 NEAREST INCH

METHOD OF DRILLING (circle one)
 BORED (or Augered) JETTED Jetted & DRIVEN
 AIR-ROTARY AIR-PERCussion ROTARY (Hydraulic Rotary)
 CABLE REVERSE-ROTARY DRIVE-POINT
 other _____

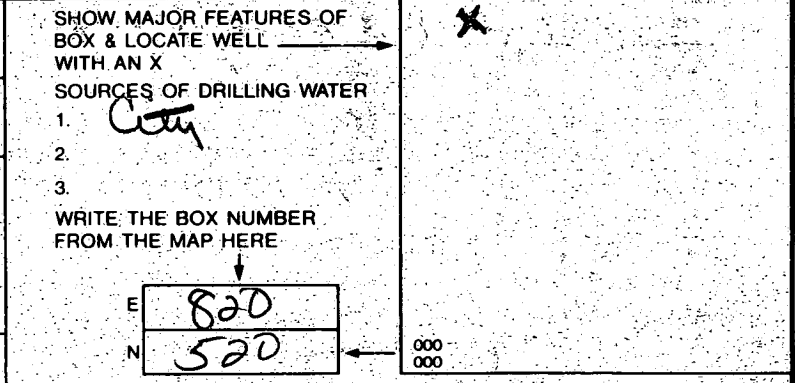

REPLACEMENT OR DEEPEMED WELLS (CIRCLE APPROPRIATE BOX)
 THIS WELL WILL NOT REPLACE AN EXISTING WELL
 THIS WELL WILL REPLACE A WELL THAT WILL BE ABANDONED AND SEALED
 THIS WELL WILL REPLACE A WELL THAT WILL BE USED AS A STANDBY-CONTACT LOCAL APPROVING AUTHORITY FOR POLICY ON STANDBY WELLS
 THIS WELL WILL DEEPEM AN EXISTING WELL
 PERMIT NUMBER OF WELL TO BE REPLACED OR DEEPEMED (IF AVAILABLE) 41 _____ 52

Not to be filled in by driller (MDE OR COUNTY USE ONLY)
 APPROX. PERMIT NUMBER: _____ GAP _____
 54 63
 FORCE **AM** WRITE INITIALS IN BOX PERMIT No. **40-94-2290**
 67 68 70 71 72 73 74 75 76 77 78 79

