

PUB. SEWER STATUS VERIFIED BY _____

ISSUE DATE: 10/24/07

P 527877

APPROVAL DATE: 11/16/07

PERMIT

Logged Into Permit Manager
Tax ID # 05-399432

A REPAIR 35533

ON-SITE SEWAGE DISPOSAL SYSTEM HOWARD COUNTY HEALTH DEPARTMENT BUREAU OF ENVIRONMENTAL HEALTH

Covey Construction Co, Inc IS PERMITTED TO INSTALL ALTER

ADDRESS: Po Box 254, Woodstock MD 21063 PHONE NUMBER: 410-750-0398

SUBDIVISION: Buckskin Woods LOT NUMBER: 9

ADDRESS: 4230 Buckskin Lake Drive PROPERTY OWNER: Sherrod Schulze

SEPTIC TANK CAPACITY (GALLONS): 1500 existing

PUMP CHAMBER CAPACITY (GALLONS):

NUMBER OF BEDROOMS: 4 (From original Permit)

SQUARE FEET PER BEDROOM: 187.5

LINEAR FEET OF TRENCH REQUIRED: 130' new trench

TRENCHES:	Trench to be 3 feet wide. Inlet 4 feet below original grade. Bottom maximum depth 8 feet below original grade. Effective area begins at 6 feet below original grade. 4 feet of stone below distribution pipe.
LOCATION:	Install 2 x 65' new trenches; one between old trenches and one downhill from old lower trench. Utilize old upper trench. Maintain 12' centers from old trenches to new trenches
PURPOSE:	Existing septic system has failed. Call for inspection when ground is opened so sanitarian can recommend repair.

PLANS APPROVED: Robert Bricker ^{veb} DATE: 11/14/2007

- NOTE: PERMIT VOID AFTER 2 YEARS
- NOTE: CONTRACTOR RESPONSIBLE FOR SCHEDULING A PRE-CONSTRUCTION INSPECTION FOR ALL INSTALLATIONS
- NOTE: WATERTIGHT SEPTIC TANKS REQUIRED
- NOTE: ALL PARTS OF SEPTIC SYSTEM SHALL BE 100 FEET FROM ANY WATER WELL
- NOTE: MANHOLE RISERS REQUIRED ON ALL SEPTIC TANKS AND PUMP CHAMBERS

NEITHER THE HOWARD COUNTY COUNCIL OR THE HEALTH DEPARTMENT IS RESPONSIBLE FOR THE SUCCESSFUL OPERATION OF ANY SYSTEM PERMITTEE RESPONSIBLE FOR OBTAINING FINAL APPROVAL ON THIS PERMIT CALL 410-313-2640 FOR INSPECTION OF SEPTIC SYSTEM

A35533

H0-81-1397

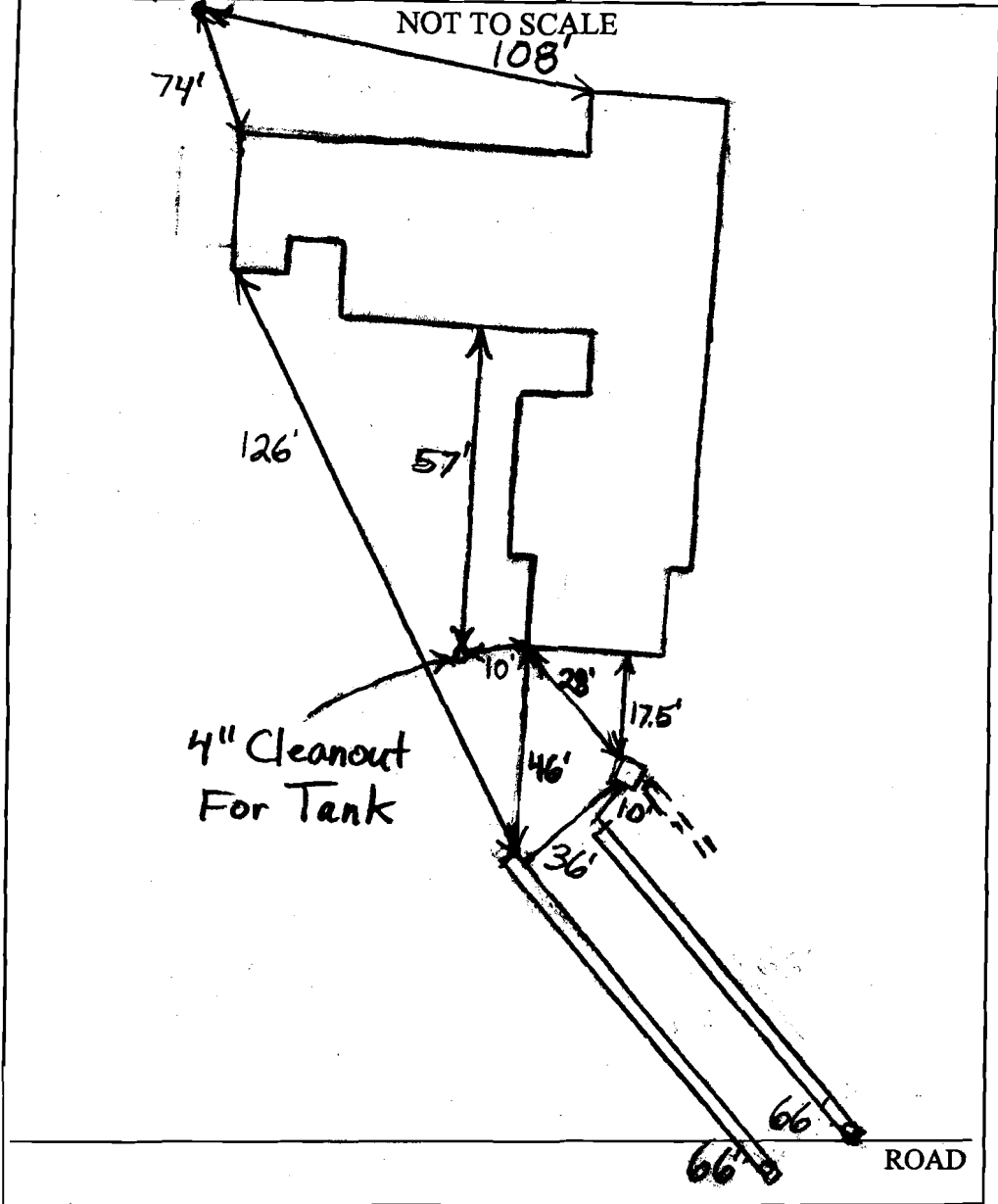

TRENCH/DRAINFIELD DATA		
WIDTH	INLET	BOTTOM
3'	4'	8'
NUMBER OF TRENCHES		2
TOTAL LENGTH		132'
ABSORPTION AREA		396 + Sidewalk
DISTRIBUTION BOX LEVEL		Yes
DISTRIBUTION BOX BAFFLE		Yes
DISTRIBUTION BOX PORT		No

SEPTIC TANK DATA	
SEPTIC TANK 1 LEVEL _____	
CAPACITY	_____ GAL
SEAM LOC	_____
TANK LID DEPTH	_____
BAFFLES	_____
BAFFLE FILTER	_____
MANHOLE LOC	_____
6" PORT LOC	_____
WATERTIGHT TEST	_____
SEPTIC TANK 2 LEVEL _____	
CAPACITY	_____ GAL
SEAM LOC	_____
TANK LID DEPTH	_____
BAFFLES	_____
BAFFLE FILTER	_____
MANHOLE LOC	_____
6" PORT LOC	_____
WATERTIGHT TEST	_____

PRE-CONSTRUCTION 11/15/07 Layout done by Robert Bricker. (RB)

INSTALLATION 11/16/07 Two new trenches installed. Top existing trench kept in use. (RB)

FINAL INSPECTOR B. Baker

DATE OF APPROVAL 11/16/07

SEPTIC SPECIFICATIONS WORKSHEET

Subdivision Buckskin Woods * P527877
 Street Name 4230 Buckskin Lake Dr. Lot Number 9
 Average Percolation Rate(min./in.) 12 min Application Rate (GPD/sq. ft.) 0.8
 Number of Bedrooms 4 (from original Permit) 10/20/06 Design Flow (BRx150) 600
 Square Footage (of House) 3300' Septic Tank Capacity (gal.) 1500
 Sidewall Credit / % Reduction 2' 1.62 Total Length of Trench (ft.) 155'

*All Septic/Pump tanks must be top seamed unless otherwise approved by this agency.

*All Septic tanks must be compartmented unless otherwise approved by this agency.

Baffle Filter Required? Yes No

TRENCH DIMENSIONS: Trench to 3 feet wide. Inlet at feet below original grade. Bottom maximum depth 8 feet below original grade. Effective area begins at 6 feet below original grade. feet of stone below the distribution pipe.

PUMP SYSTEM PROPOSED? YES NO

Pump system details: gallon pump chamber

Note 1: Septic pump detail to be provided by installer prior to issuance of septic permit.

Note 2: Pump performance test required prior to Health Department approval of pumped septic system.

LOCATION: ① Install 2 x 65' trenches; 1 between old trenches, # 2nd at 12' below (downhill) lower old trench.
② Use old upper trench (2' x 65', 4' sidewall)

ADDITIONAL NOTES: Maintain gravity flow from ex. Distribution Box

Reviewed by: Robert Bricker RB 11/14/07

Date: