

**THIS REPORT
MUST BE SUBMITTED
WITHIN 30 DAYS
AFTER COMPLETION
OF THE WELL**

WELL COMPLETION REPORT

WELL DESCRIPTION

WELL LOG
State the kind of formations penetrated, their color, their depth, their thickness, and if water-bearing

CASING AND SCREEN RECORD
State the kind and size and position of casing, liner, shoe, screen, and other accessories (if no casing used, give diameter of well).

FEET from ___ to ___		DIAM. (inches)	FEET from ___ to ___
4 38 Sand & gravel			
12 Shale Rock 5-1 gray granite Rock		6" o.d. Well casing	42
WELL 105'			

Permit Number 70-66-W-121
Owner Harman Dugan
Address Highland
Subdivision Greenwood
Section 4 Lot 4

PUMPING TEST
Hours Pumped _____
Type of Pump Used CR
Pumping Rate _____
Gallons per Minute 3

WATER LEVEL
Distance from land surface to water:
Before Pumping 38 Ft.
When Pumping _____ Ft.

APPEARANCE OF WATER
Clear Cloudy _____
Taste _____
Odor none

Height of Casing Above Land
Surface 2 Ft.

PUMP INSTALLED
Type _____
Capacity _____
Gallons per Minute _____
Gallons per Hour _____
Pump Column Length _____ Ft.

LOCATION OF WELL ON LOT
Show permanent structures such as building(s), septic tank, and/or other landmarks and indicate not less than 2 distances (measurements) to well.

NORTH
↑

Date Well _____
Was Completed 10/16/15
Well Driller _____
Signature E. Brown

HOWARD COUNTY
MARYLAND STATE DEPARTMENT OF HEALTH
8 Church Road
ELLICOTT CITY, MARYLAND

WELL COMPLETION REPORT

This report must be submitted within 10 days after completion of the well.

This is to certify that the well which has been completed on the below property has been constructed and disinfected in compliance with the regulations and specifications of the State Board of Health.

The following construction and performance characteristics were noted:

1. Type, diameter and length of casing 6" O.D. Well casing 42 ft.
2. Total depth of well 105 ft.
3. Type, diameter and length of strainer none. Size of screen openings _____
4. Method of sealing top and bottom of screen _____
5. Method of grouting Cement. Quantity, cement used 94 lbs.
Gals. Water 5.
6. Standing water level (depth below ground surface when not pumping) 38 ft.
7. Yield of well in gallons per minute 3; elevation of water surface when pumped at the designated rate _____.
8. Number of hours pump operated at stipulated rate during pumping test 2.
9. Record of any other pumping performance none.
10. Log of materials encountered during drilling 4 ft. Clay 38 ft. Sand
+ gravel 12 ft. Shale Rock 51 ft. gray granite Rock
11. Physical appearance of water at end of final pumping test clear
12. Variation in vertical alignment (how much the well casing varies from a truly plumb line) throughout its depth _____
13. Disinfected by 1 ounces of quart % Chlorine (Brand name clorox)

Property Owner Norman Dustin Address Highland Md.
Location of Property Greenwood Farms Sub. Lot 4

Health Department Number _____ Dept. of Water Resources Permit No. Ho-66-W-121

Date: 10/16/65, 19 _____. Ed. Brown
Signature of Well Driller

INSTRUCTIONS: This form is to be completed in duplicate and certified by the well driller upon completion of each drilled well. One copy will be forwarded to the property owner by the Health Department along with the final approval of the well.

APPLICATION MUST BE SUBMITTED AND PERMIT RECEIVED BEFORE DRILLING IS STARTED.

APPLICATION FOR PERMIT TO DRILL WELL

No. 457

Owner NORMAN DUSTIN
Street or R. F. D. _____
Post Office Highland

Driller ED BROWN License Number 288
Street or R. F. D. _____
Post Office R. 3 Mt. Airy
Date 10/14/65

Quantity of Water to be Produced 3 G.P.M.
Total Quantity Needed For Use 300 G.P.D.
Use for Water HOME
Approximate Depth of Well (feet) 100
Method of Drilling to be used Rotary

Location of Well
Subdivision GREENWOOD FARMS
Section _____ Lot 4
County HOWARD
Nearest Town Highland
Distance from Town 2 1/2 Miles
Direction from Town SOUTH

Is this a Replacement Well? Yes - No
If YES, indicate date abandoned well is to be sealed: _____
and by whom: _____

Description of Location of Well
(This information should be definite enough to permit locating well on a county map).
Near what road Rt. 216
On which side of road South West
(North, East, South, West)

PERMIT TO DRILL WELL
(Not To Be Filled In By Driller)

Well Permit No. Ho-66-W-121

Samples of Cuttings Required by Department: Yes No
Owner Requires Permit to Appropriate Water: Yes No
Owner Has Permit to Appropriate Water: Yes No

Appropriation Permit No. _____

The applicant is herewith granted a permit to drill this well subject to the conditions stipulated.

Paul W. McKee 10-11-65
Director Date

THIS PERMIT IS NOT TRANSFERABLE
WITHOUT WRITTEN PERMISSION FROM THE DEPARTMENT
Special conditions that must be observed:

Health Department Approval of Application
Howard County Department of Health

or State Department of Health
Approved by Kenneth E. Lettner
Title Sanitarian
Date 10/10/65

Distance from road South from Green Dell
Draw a sketch below showing location of well in relation to nearby towns, roads and streams with north in the direction of the arrow, and give distance from well to nearest road junction or stream crossing shown on the sketch.

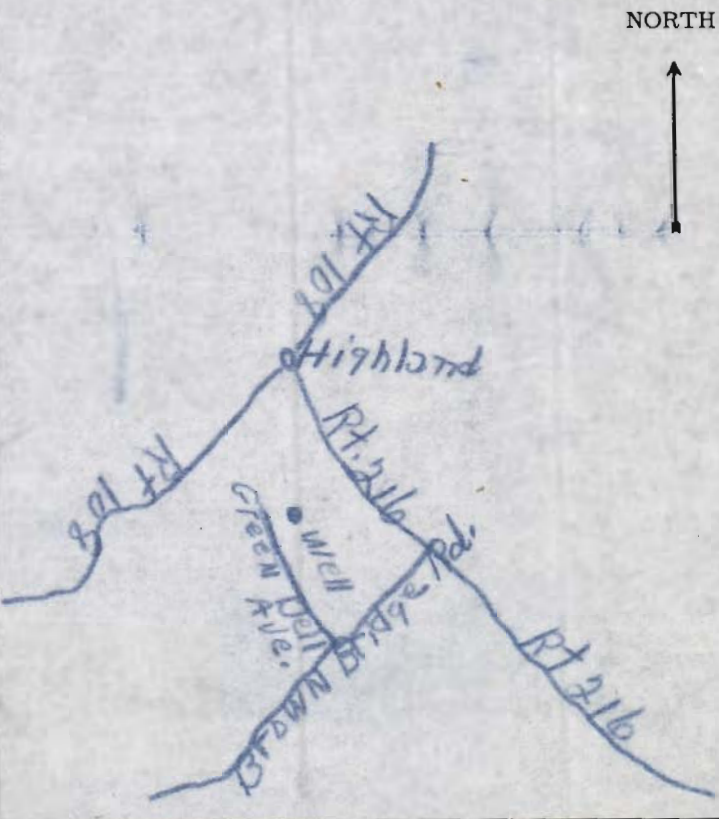



SEE A05074
FOR WELL FILE
HO-66-W-121

HOWARD COUNTY HEALTH DEPARTMENT

Joyce M. Boyd, M.D., County Health Officer

January 3, 1992

Reply to:

Mr. Martin Wasserman
7604 Brown Bridge Road
Fulton, Maryland 20759

13200 TAINOGLAND
EC. 21093

RE: Percolation Testing
Greenwood Farms - Lot 4, Sec. 1
Brown Bridge Road At Greenwood Dr.

Dear Mr. Wasserman:

The above referenced property first passed the percolation test on May 1, 1962 and was declared a buildable lot. A percolation re-evaluation conducted November 4, 1991 sustains this approval.

The property is considered eligible for issuance of a building permit pending submittal of an approvable site plan and establishment of an acceptable water supply.

In this case, "establishment of an acceptable water supply", includes determining whether or not a well currently exists on this property, and if so, then determining its appropriate disposition. Our records show that a well construction permit (HO-66-W-121) was issued for this property on October 6, 1965; and that a well was drilled on October 16, 1965.

No precise location records are on file. As lots 3 and 4 have been under common ownership for some time, it seems plausible that this well was actually drilled on lot 3 and serves the house on that lot. If this can be confirmed, then we can adjust our records and proceed with lot 4 as a vacant lot eligible for a routine new well permit application. If it cannot be confirmed that the well in question is on lot 3, then an effort must be made to confirm whether or not there is a well on lot 4. For a well of this age the well casing would be steel, and would likely be buried 1 inch to 3 feet below the ground surface. A metal detector or ultrasonic device would seem to be the most appropriate means to search for the well. Should the well be determined to actually be on lot 4, then an evaluation of its construction would be in order to determine if it could be put into service.

Mr. Martin Wasserman

- 2 -

January 2, 1991

If you have any questions relative to this matter, please call me at 461-9933.

Very truly yours,

Craig Williams MR

Craig Williams, Program Director
Water and Sewerage Program

CW:jr

cc: Garth Davis, Agent
Boyd Petit - Prospective Buyer
File

LOT 3 & 4 WERE UNDER
CORP FINED OWNERSHIP.
THIS WELL MAY BE
ON LOT 3

IF APPLICANT DEMONSTRATES
THAT A THOROUGH SEARCH
OF THE PROPERTY
REVEALS NO WELL ON
THIS LOT,
THEN ATTACH THIS
WELL REPORT TO
FILE FOR
GREENWOOD FARMS LOT 3
P30391

LEE ORGANIZATION, INC.
REAL ESTATE DEVELOPMENT CONSULTANTS
REAL ESTATE BROKERS & MANAGERS

P.O. Box 755
Columbia, Maryland 21045
(410) 995-6118
(410) 880-6311 (Facsimile)
(410) 339-2640# (Beeper)

20 January 1992

COPY

Howard County
Bureau of Environmental Health
3525-H Ellicott Mills Drive
Ellicott City, MD 21043

Attn: Mr. Williams

Re: Lot 4, Greenwood Farms
Martin P. Wasserman- Owner
Boyd Petit - Purchaser

Dear Mr. Williams:

This letter will confirm that during the month of September a ground search was conducted on Lot#4, Greenwood Farms, for evidence of a buried metal detector. This search was conducted at my direction, in my presence, both visually and by metal detector. The search was negative.

Very truly yours,

GARTH V. DAVIS

CC: MARTIN P. WASSERMAN
BOYD PETIT
FILE

FAX-OUT	TO: C. WILLIAMS	FROM: G DAVIS	DATE: 2/11/92
	FAX #: 4615770	FAX: 406311	PHONE #: 9956112
			PAGES INCLUDING THIS PAGE: 1
			TIPS: 2485