

C1 73866

SEQUENCE NO. (MDE USE ONLY)

STATE OF MARYLAND WELL COMPLETION REPORT

THIS REPORT MUST BE SUBMITTED WITHIN 45 DAYS AFTER WELL IS COMPLETED.

(THIS NUMBER IS TO BE PUNCHED IN COLS. 3-6 ON ALL CARDS)

COUNTY NUMBER 13

ST/CO USE ONLY DATE RECEIVED

DATE WELL COMPLETED

Depth of Well

PERMIT NO. FROM "PERMIT TO DRILL WELL"

OWNER Sharon R T/E Mark J. WELL SITE ADDRESS Church Lane Rd. TOWN Ellicott City

WELL LOG table with columns: DESCRIPTION, FEET (FROM, TO), check if water bearing. Includes handwritten entries: Brown S.H, weathered Rock, Schist, Red Rock, Grey Schist, Installed 1.25x400, HD PE u-Renal closed loop.

GROUTING RECORD. WELL HAS BEEN GROUTED (Y). TYPE OF GROUTING MATERIAL: CEMENT (CM), BENTONITE CLAY (BC). NO. OF BAGS 14, NO. OF POUNDS 266. DEPTH OF GROUT SEAL 0' to 400'.

CASING RECORD. MAIN CASING TYPE: PL. Nominal diameter 6", Total depth 56".

OTHER CASING (if used) table with columns: diameter, depth (feet).

SCREEN RECORD. screen type or open hole: HO (OPEN HOLE).

NUMBER OF UNSUCCESSFUL WELLS: 0. WELL HYDROFRACTURED: Y.

CIRCLE APPROPRIATE LETTER: A (WELL ABANDONED), E (ELECTRIC LOG OBTAINED), P (TEST WELL CONVERTED).

I HEREBY CERTIFY THAT THIS WELL HAS BEEN CONSTRUCTED IN ACCORDANCE WITH COMAR 26.04.04 "WELL CONSTRUCTION" AND IN CONFORMANCE WITH ALL CONDITIONS STATED IN THE ABOVE CAPTIONED PERMIT...

DRILLERS LIC. NO. MW D 587. DRILLERS SIGNATURE. LIC. NO. BW D 083.

SITE SUPERVISOR (sgn. of driller or journeyman responsible for sitework if different from permittee)

DEPTH (nearest ft.) table with columns: 1-21, 23-26, 30-32, 38-41, 45-47, 51. SLOT SIZE 1, 2, 3. DIAMETER OF SCREEN (NEAREST INCH) 56, 60.

MDE USE ONLY (NOT TO BE FILLED IN BY DRILLER). TELESCOPE CASING, LOG INDICATOR, OTHER DATA.

PUMPING TEST. HOURS PUMPED (nearest hour) N/A. PUMPING RATE (gal. per min.) N/A. TYPE OF PUMP USED: C (centrifugal).

PUMP INSTALLED. DRILLER INSTALLED PUMP: YES. TYPE OF PUMP INSTALLED: N/A. CAPACITY: GALLONS PER MINUTE N/A. PUMP HORSE POWER N/A. PUMP COLUMN LENGTH N/A. CASING HEIGHT: -3 (nearest foot).

LATITUDE 39.294245, LONGITUDE 76.797214 (DEFAULT COORD. WGS 84)

Pursuant to §10-624 of the State Govt. Article of the Maryland Code personal info. requested on this form is used in processing this form pursuant to COMAR 26.04.04. Failure to provide the info. may result in this form not being processed.

B 1	SEQUENCE NO. (MDE USE ONLY) <u>93753</u>	STATE OF MARYLAND APPLICATION FOR PERMIT TO DRILL WELL 590229 please type	STATE PERMIT NUMBER <u>HO - 25 - 0060</u> 70 fill in this form completely 79
------------	---	--	--

1 2 3 6
Date Received (APA) 10/1/25

8 MM DD YY **13**
OWNER INFORMATION
Mayr Sharon R T/E Mark J
15 Last Name **Owner** First Name **34**
8227 Church Lane Rd.
36 Street or RFD **55**
Ellicott City Md. 21043
57 Town **70** State **72** Zip **76**

B 3 LOCATION OF WELL

Howard
8 COUNTY **21**
8203/Lot 6 20,386 Sq 8227 BLE 32
23 SUBDIVISION **42**
SECTION 44 **46** **LOT** 6 **48** **50**
Ellicott City
52 NEAREST TOWN **71**

DRILLER INFORMATION
Stephen Delos **MW D 587**
Driller's Name **76** License No. **81**
Connelly & Associates, Inc.
Firm Name
1513 N. No Drive Frederick, Md. 21704
Address
Stephen Delos **10-3-25**
Signature **Date**

B 4 SOURCES OF DRILLING WATER

8227 Church Lane Rd.
11 STREET ADDRESS **30**
ON WHICH SIDE OF ROAD (CIRCLE APPROPRIATE BOX)
 NORTH
 WEST
 EAST
 SOUTH
34 115 **37**
DISTANCE FROM ROAD **FT**
ENTER FT OR MI **38** **39**
TAX MAP 0018 **BLK:** **PARCEL** 0178

B 2 WELL INFORMATION

1 2 APPROX. PUMPING RATE (GAL. PER MIN.) N/A **8** **12**
AVERAGE DAILY QUANTITY NEEDED (GAL. PER DAY) N/A **14** **20**

USE FOR WATER (CIRCLE APPROPRIATE BOX)

DOMESTIC POTABLE SUPPLY & RESIDENTIAL IRRIGATION

FARMING (LIVESTOCK WATERING & AGRICULTURAL IRRIGATION)

INDUSTRIAL, COMMERCIAL, DEWATERING

PUBLIC WATER SUPPLY WELL

TEST, OBSERVATION, MONITORING

OPEN LOOP GEOTHERMAL

CLOSED LOOP GEOTHERMAL

NOT TO BE FILLED IN BY DRILLER HEALTH DEPARTMENT APPROVAL

Howard County **13**
COUNTY NAME **COUNTY NO.**
STATE SIGNATURE **INSERT S** **41**
DATE ISSUED 10/20/2025 **43** **MM DD YY** **48** **CO SIGNATURE** 10/20/2025 **EXP. DATE**
DO NOT NOTIFY DOG: 11/4/25 (M)

APPROXIMATE DEPTH OF WELL 400 **FEET** **24** **28**

APPROXIMATE DIAMETER OF WELL 6 **NEAREST INCH**

PROPOSED LOCATION OF WELL ON LOT SHOW PERMANENT STRUCTURES SUCH AS BUILDINGS, SEPTIC SYSTEM, ROADS AND/OR LANDMARKS AND INDICATE NOT LESS THAN TWO DISTANCE MEASUREMENTS TO WELL

METHOD OF DRILLING (circle one)

BORED (or Augered) **JETTED** **Jetted & DRIVEN**

30 AIR-ROTary **AIR-PERCussion** **ROTARY (Hydraulic Rotary)**

37 CABLE **REVerse-ROTary** **DRive-POINT**

other _____

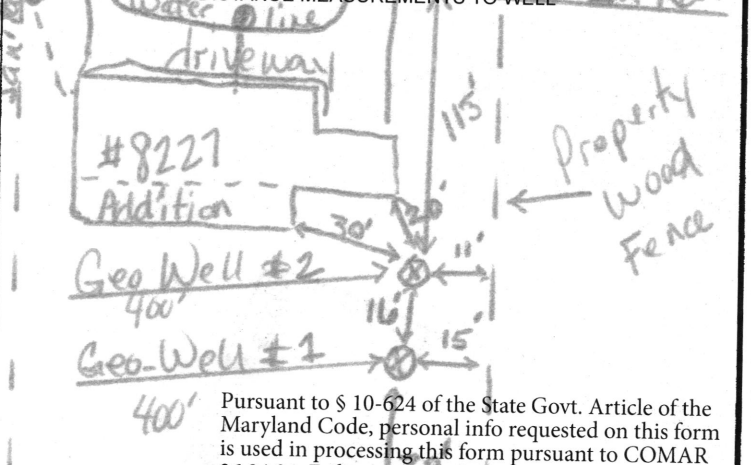

REPLACEMENT OR DEEPEINED WELLS (CIRCLE APPROPRIATE BOX)

THIS WELL WILL NOT REPLACE AN EXISTING WELL

THIS WELL WILL REPLACE A WELL THAT WILL BE ABANDONED AND SEALED

39 THIS WELL WILL REPLACE A WELL THAT WILL BE USED AS A STANDBY-CONTACT LOCAL APPROVING AUTHORITY FOR POLICY ON STANDBY WELLS

THIS WELL WILL DEEPEIN AN EXISTING WELL

PERMIT NUMBER OF WELL TO BE REPLACED OR DEEPEINED (IF AVAILABLE) **41** _____ **52**

Pursuant to § 10-624 of the State Govt. Article of the Maryland Code, personal info requested on this form is used in processing this form pursuant to COMAR 26.04.04. Failure to provide the info may result in this form not being processed. You have the right to inspect, amend, or correct this form. The Maryland Department of the Environment is subject to the Maryland Public Information Act. This form may be made available on the Internet via MDE's website and is subject to inspection or copying, in whole or in part, by the public and other governmental agencies, if not protected by federal or State Law.

Not to be filled in by driller (MDE OR COUNTY USE ONLY)

APPROP. PERMIT NUMBER _____ **G** _____

PERMIT No. HO - 25 - 0060
70 71 72 73 74 75 76 77 78 79

SPECIAL CONDITIONS Please Notify office of Drilling & Grout. Approx P/L

NOTE APPROVING AUTHORITIES SHOULD USE SEPARATE SHEET IF NEEDED



pics taken on 11/4/25 during grant insp - construction activities not called in by driller (P)



WARNING!!!

This email originated from someone outside of Howard County
DO NOT CLICK LINKS OR OPEN ATTACHMENTS
unless you recognize the sender and know for sure that the content is safe

Afternoon All,

Would like to get a grout inspection for tomorrow morning November 4th around 9:30 am if possible. The address is 8227 Church Ln Rd. Ellicott city, Md 21043. Geothermal wells (2) @ 400' each.

Thanks,

Rob Mohler
Connelly & Associates, Inc.
Geothermal Divison
cell: 240-367-0461



Driller did not notify HD about drilling activities. HD not onsite for inspections of well/bore construction.

Driller emailed construction details which are on page 4 of this email.

Cc: steve@connellyandassociates.com; 'Sam Connelly' <sam@connellyandassociates.com>

Subject: RE: Grout Inspection for Mayr Res.

Good Afternoon,

Received, thank you for the notification. You're on our schedule for an inspection tomorrow morning.

Also, since we weren't onsite during drilling operations can you address the following: What was the depth to bedrock, amount of bedrock, & water fractures if any?

Best,

Shepsura Page, LEH Specialist
Well & Septic Program
Howard County Health Department
8930 Stanford Blvd.
Columbia, MD 21045
410-313-1789 (Office)
410-313-2648 (Fax)
www.hchealth.org
spage@howardcountymd.gov

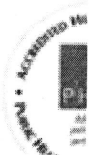
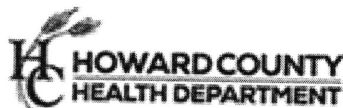

twitter.com/HoCoHealth



facebook.com/HoCoHealth



instagram.com/hocohealth

CONFIDENTIALITY NOTICE

This message and the accompanying documents are intended only for the use of the individual or entity to which they are addressed and may contain information that is privileged, confidential, or exempt from disclosure under applicable law. If the reader of this email is not the intended recipient, you are hereby notified that you are strictly prohibited from reading, disseminating, distributing, or copying this communication. If you have received this email in error, please notify the sender immediately and destroy the original transmission.

From: robm@connellyandassociates.com <robm@connellyandassociates.com>

Sent: Monday, November 3, 2025 3:59 PM

To: Wolf, Kevin <KWolf@howardcountymd.gov>; Rappaport, Ryan <RRappaport@howardcountymd.gov>; Martin, Sharhonda <smmartin@howardcountymd.gov>; Burns, Matthew <mburns@howardcountymd.gov>; Page, Shepsura <spage@howardcountymd.gov>; Taylor, Aleetta <ataylor@howardcountymd.gov>

Cc: steve@connellyandassociates.com; 'Sam Connelly' <sam@connellyandassociates.com>

Subject: Grout Inspection for Mayr Res.

From: Page, Shepsura <spage@howardcountymd.gov>

Sent: Monday, November 3, 2025 4:09 PM

To: robm@connellyandassociates.com; Wolf, Kevin <KWolf@howardcountymd.gov>; Rappaport, Ryan <RRappaport@howardcountymd.gov>; Martin, Sharhonda <smmartin@howardcountymd.gov>; Burns, Matthew <mburns@howardcountymd.gov>; Taylor, Aleetta <ataylor@howardcountymd.gov>

Cc: steve@connellyandassociates.com; 'Sam Connelly' <sam@connellyandassociates.com>

Subject: RE: Grout Inspection for Mayr Res.

Forgot to ask, what dates did drilling occur?

Best,

Shepsura Page, LEH Specialist
Well & Septic Program
Howard County Health Department
8930 Stanford Blvd.
Columbia, MD 21045
410-313-1789 (Office)
410-313-2648 (Fax)
www.hchealth.org
spage@howardcountymd.gov



twitter.com/HoCoHealth



facebook.com/HoCoHealth



instagram.com/hocohealth

CONFIDENTIALITY NOTICE

This message and the accompanying documents are intended only for the use of the individual or entity to which they are addressed and may contain information that is privileged, confidential, or exempt from disclosure under applicable law. If the reader of this email is not the intended recipient, you are hereby notified that you are strictly prohibited from reading, disseminating, distributing, or copying this communication. If you have received this email in error, please notify the sender immediately and destroy the original transmission.

From: Page, Shepsura

Sent: Monday, November 3, 2025 4:07 PM

To: robm@connellyandassociates.com; Wolf, Kevin <KWolf@howardcountymd.gov>; Rappaport, Ryan <RRappaport@howardcountymd.gov>; Martin, Sharhonda <smmartin@howardcountymd.gov>; Burns, Matthew <mburns@howardcountymd.gov>; Taylor, Aleetta <ataylor@howardcountymd.gov>

Pg 3

Rappaport, Ryan

From: robm@connellyandassociates.com
Sent: Monday, November 3, 2025 5:54 PM
To: Page, Shepsura; Wolf, Kevin; Rappaport, Ryan; Martin, Sharhonda; Burns, Matthew; Taylor, Aleetta
Cc: steve@connellyandassociates.com; 'Sam Connelly'
Subject: RE: Grout Inspection for Mayr Res.

WARNING!!!

This email originated from someone outside of Howard County
DO NOT CLICK LINKS OR OPEN ATTACHMENTS
unless you recognize the sender and know for sure that the content is safe

Evening all,

Mayr Res. -

#1 Well Location (10-29-2025)

- *(80' PVC Casing)
- *0-60' Brown Silt
- *60'-70' Weathered Rock
- *70'-400' Bed Rock, Grey Schist
- *H2O @ 160'
- *Installed 1.25 x 400' HDPE U-Bend Closed Loop

#2 Well location (10-29-2025)

- *(80' PVC Casing)
- *0-60' Brown Silt
- *60'-70' Weathered Rock
- *70'-400' Bed Rock, Grey Schist
- *H2O @ 375'
- * Installed 1.25 x 400' HDPE U-Bend Closed Loop (11-3-2025)

Thanks,

Rob Mohler

Connelly & Associates, Inc.
Geothermal Division
cell: 240-367-0461



pg 4

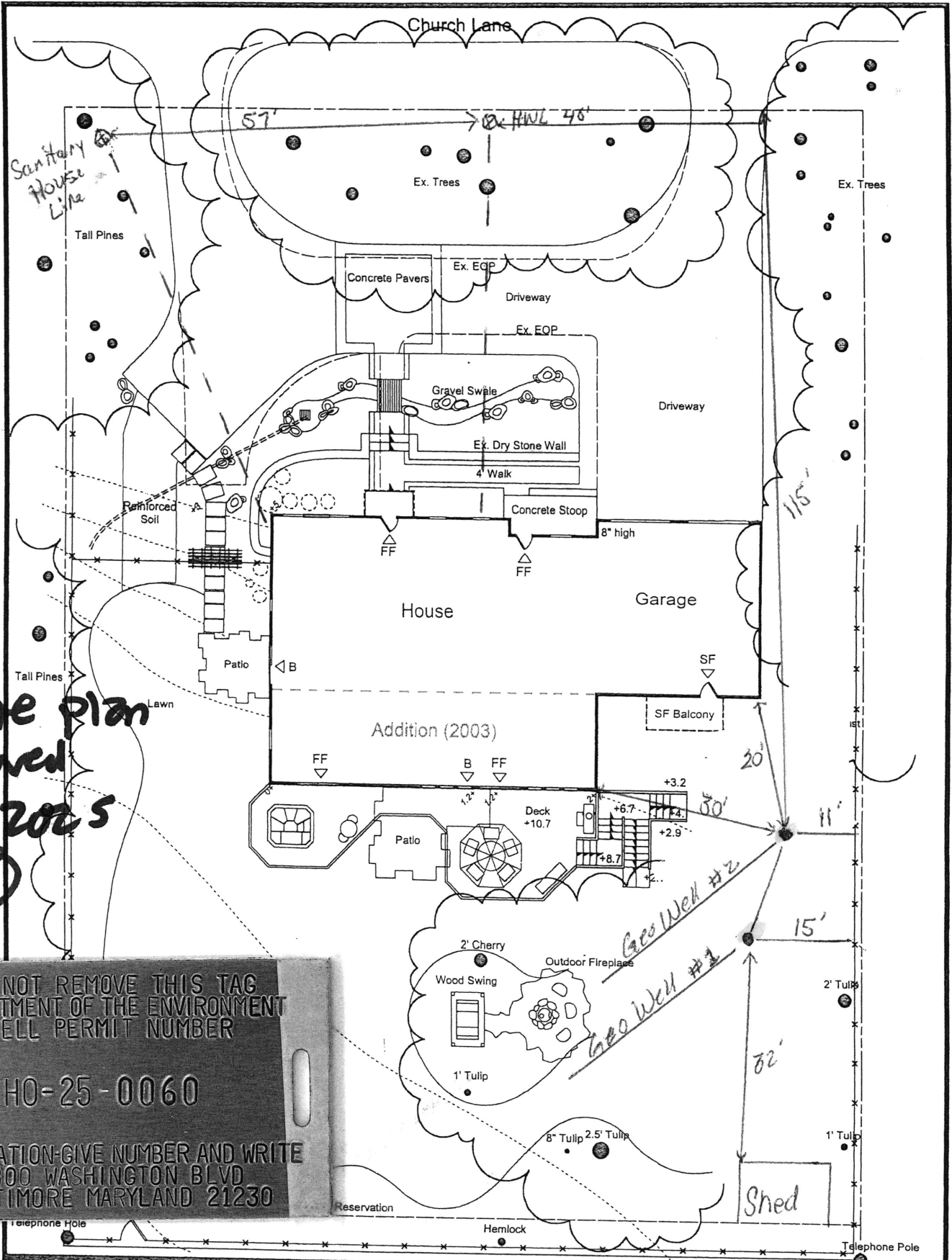

Well Site Plan
 Approved
 10/20/2025
 (SP)

DO NOT REMOVE THIS TAG
 DEPARTMENT OF THE ENVIRONMENT
 WELL PERMIT NUMBER
 HO-25-0060
 INFORMATION-GIVE NUMBER AND WRITE
 1800 WASHINGTON BLVD
 BALTIMORE MARYLAND 21230

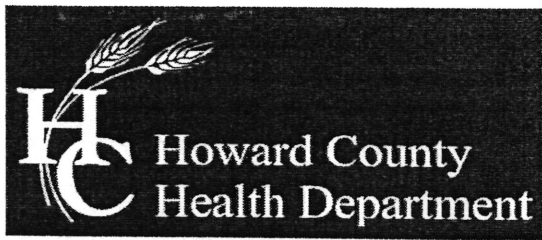

Bureau of Environmental Health

8930 Stanford Boulevard, Columbia, MD 21045

Main: 410-313-2640 | Fax: 410-313-2648

TDD 410-313-2323 | Toll Free 1-866-313-6300

www.hchealth.org

Facebook: www.facebook.com/hocohealth

Twitter: HowardCoHealthDep

Dr. Maura J. Rossman, M.D., Health Officer

TO ALL INTERESTED PARTIES

When submitting a well permit application for a proposed well for new construction, please indicate one of the following:

Well Site Location:

8003/206 BLESZ Mayr Ave. 6 Church Lane Rd.
Subdivision/Property Name Lot # Road Name

The well site has been staked by Connelly Geotermal/Stephen DeLoak
(professional land surveyor or company employing professional land surveyors)
on 10-7-2025 (date) and does not require a site inspection.

The well driller, builder or property owner will call the Health Department to schedule a time to meet in the field to verify the proposed well site location.

This sheet, along with two copies of an acceptable well site plan, must be attached to the green well permit application.

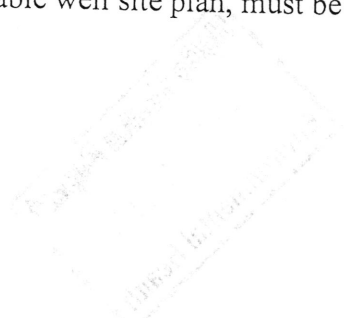

FILE INQUIRY NOTES

DATE	RESULTS OF REVIEW FOR FILE
10/17/2025	Notified well driller well site plan meets setback requirements.
	Onsite later in day, verified geo-well setback per plan.
	Stake meets all setback requirements. (SP)
	Plans Approved. (SP)

Mayr Res. 8227 Church Lane Rd. Clarksville, Md. 21043 Geothermal Closed Loop

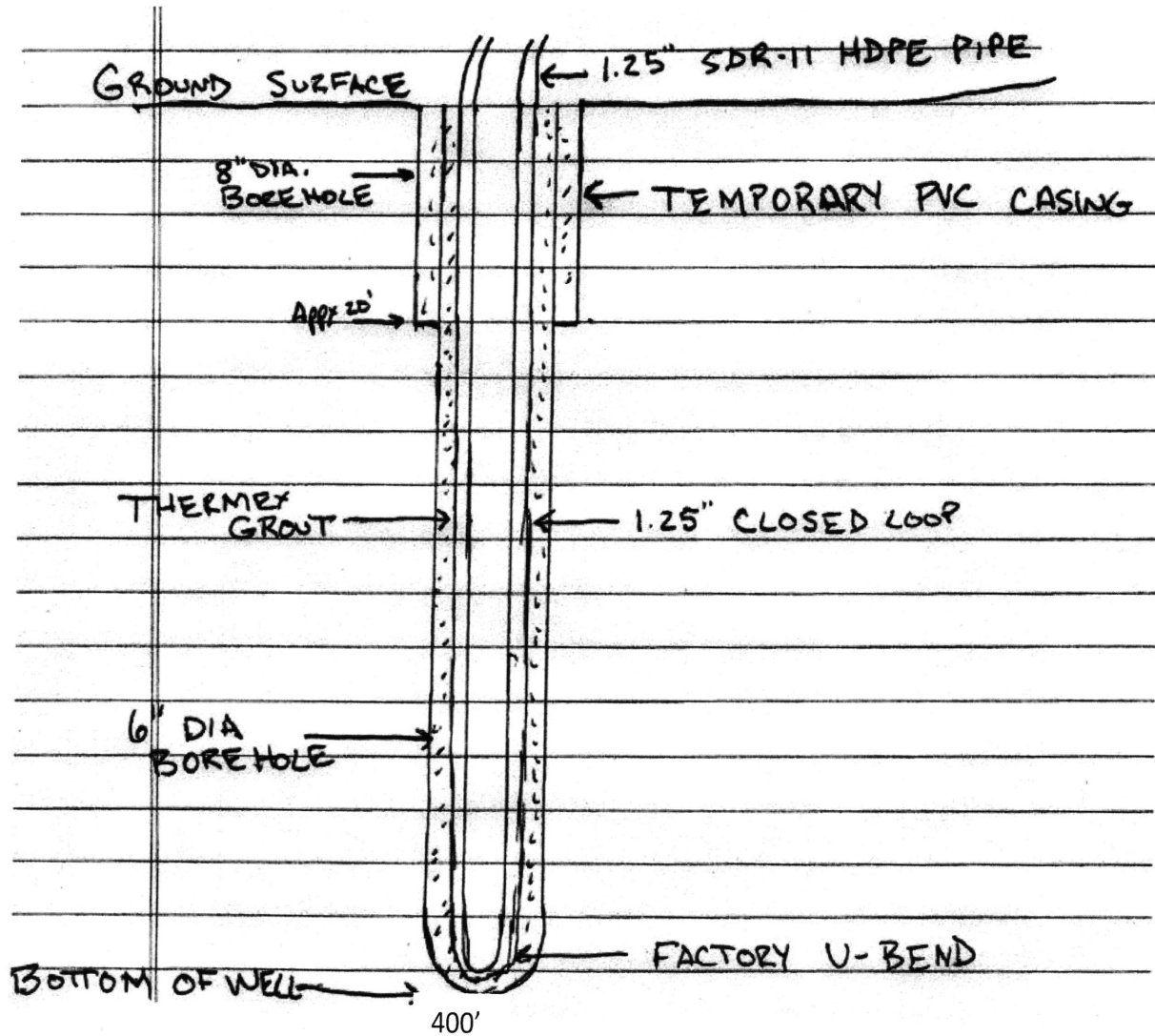

Grout information for this property is as follows:

Well Grout DF grout mixture of 50 lb. grout to 19 gallons water, placed in the well using the tremie method, from bottom to top.