

Approved 6/27/24

-H.O.

Record Detail * (This section is required.)

Permit Type Permit Number Opened Date

Description of Work
 SFD/Alterations for: On upper level, reconfigure existing bedrooms and baths and reconfigure existing windows and doors per new layout; build new entrance stoop at new main entrance door location on right side of building. On lower level, reconfigure openings at existing garage. APPROX 628 SQFT

[check spelling](#)

Online BP,
 DB history with
 property. JB 6/26/24

Address * (This section is required.)

Search Reset Clear Get Parcel & Owner

Street # 14084 Street Name BARBARA Street Type CIR

Unit Type --Select-- Unit # X Coordinate -77.00182 Y Coordinate 39.32367

City COOKSVILLE State MD Zip Code 21723 Primary Yes

Parcel * (This section is required.)

Search Reset Clear Get Address & Owner

GIS ID *	Parcel	Parcel Area	Land Value	Improved Value	Exemption Value	Plan Area
908633	203	1.13	0	353200	0	RURAL

Legal Description
 LOT 6 []14084 BARBARA CIR []WOODBINE

[check spelling](#)

Block	Lot	Census Tract	Council Dist	Inspection Dist	Supervisor Dist	Map #	DAP Zone
	6	605601	5				

Plan Area State Tax Id 1404314964 Subdivision Name VILLA MONTICELLO SECTIO

Section Area Tax Map 8

Grid Zoning District RC-DEO ADC Map 4692-K9

SDP No. Final Plan No. WP File No.

Record Plat No. 67 WS Contract No. FDP No. Primary Yes

Owner Occupied Year Built 1974 Historic District Yes No

Historic District Registry No. Stat Area 4-03 Flood Plain Yes No

Building No

Owner (This section is not required.)

Search Reset Clear

Name FISHEI

Address Line 1 14084 BARBARA CIR

Address Line 2

Address Line 3

Mail City COOKSVILLE

Mail State MD

Mail Zip Code 21723

Phone 410-408-5779

Primary Yes

E-mail

Existing Utilities
Gas & Electric ▼

Existing Heating System
Electric & Natural Gas ▼

Existing Sprinkler System
None ▼

Type of New Fireplace
--Select-- ▼

Expiration Date
12/23/2024 

Submit Cancel

PERMIT

APPROVAL DATE: 11/13/02

A REPAIR

KN INDEXED

ON-SITE SEWAGE DISPOSAL SYSTEM HOWARD COUNTY HEALTH DEPARTMENT BUREAU OF ENVIRONMENTAL HEALTH

04-314969

Jenkins Brothers

IS PERMITTED TO INSTALL ALTER

ADDRESS: 7670 Smith's Private Rd, 21784

PHONE NUMBER: 410-461-9282

SUBDIVISION: Villa Monticello

LOT NUMBER: 6

ADDRESS: 14084 Barbara Circle

PROPERTY OWNER: William Fisher

SEPTIC TANK CAPACITY (GALLONS):

Σx 1000 gal, MIDSEAM (Bot

PUMP CHAMBER CAPACITY (GALLONS):

Ex. Dry Well kept as extra storage

NUMBER OF BEDROOMS:

3

SQUARE FEET PER BEDROOM:

150

LINEAR FEET OF TRENCH REQUIRED:

80'-OK

TRENCHES:	Trench to be <u>2</u> feet wide. Inlet <u>4</u> feet below original grade. Bottom maximum depth <u>10</u> feet below original grade. Effective area begins at <u>4</u> feet below original grade. <u>6</u> feet of stone below distribution pipe.
LOCATION:	
PURPOSE:	Existing septic system has failed. Call for inspection when ground is opened so sanitarian can recommend repair.

PLANS APPROVED: RN

DATE: 11/12

NOTE: PERMIT VOID AFTER 2 YEARS

NOTE: CONTRACTOR RESPONSIBLE FOR SCHEDULING A PRE-CONSTRUCTION INSPECTION FOR ALL INSTALLATIONS

NOTE: WATERTIGHT SEPTIC TANKS REQUIRED

NOTE: ALL PARTS OF SEPTIC SYSTEM SHALL BE 100 FEET FROM ANY WATER WELL

NOTE: MANHOLE RISERS REQUIRED ON ALL SEPTIC TANKS AND PUMP CHAMBERS

NEITHER THE HOWARD COUNTY COUNCIL NOR THE HEALTH DEPARTMENT IS RESPONSIBLE FOR THE SUCCESSFUL OPERATION OF ANY SYSTEM PERMITTEE RESPONSIBLE FOR OBTAINING FINAL APPROVAL ON THIS PERMIT CALL 410-313-2640 FOR INSPECTION OF SEPTIC SYSTEM

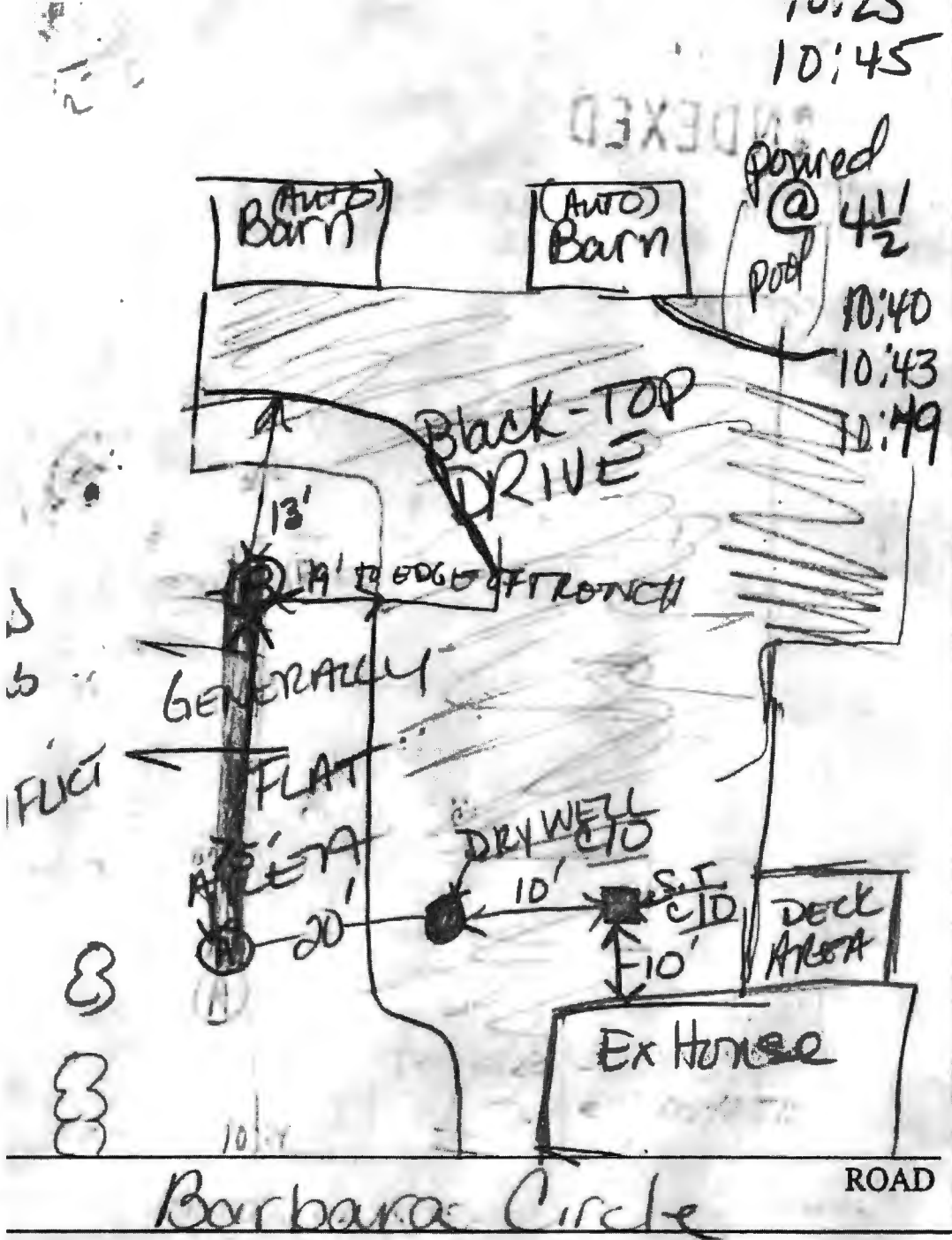

NUMBER OF TRENCHES
 TOTAL LENGTH 80'
 ABSORPTION AREA 480
 DISTRIBUTION BOX LEVEL
 DISTRIBUTION BOX BAFFL
 DISTRIBUTION BOX PORT

SEPTIC TANK DATA
 SEPTIC TANK 1 LEVEL 10
 CAPACITY ✓
 SEAM LOC M.I.
 TANK LID DEPTH
 BAFFLES replac
 BAFFLE FILTER ✓
 MANHOLE LOC
 6" PORT LOC No
 WATERTIGHT TES
 SEPTIC TANK 2 LEVEL 0
 CAPACITY
 SEAM LOC
 TANK LID DEPTH
 BAFFLES
 BAFFLE FILTER
 MANHOLE LOC
 6" PORT LOC
 WATERTIGHT TES

INSTRUCTION

LATION 11/12/02 Perc hole ^(A) dug to 16' deep s; loam from 3-16 Trace Rx
 n, Lt. brown. Heavy loam above 4'. Baffle inlet to be
 placed in S.T. Drywell will be used as stor
 prior to trench treatment. Septic Tank and dry
 not accessible under driveway although should h
 ve been black topped over. Install 1 deep trench / side
 m. 11/13/02 elevation drop from drywell of 5' to 19'
 line @ 4" over 10' distance. Both baffles replaced

11/21/73

11-2077
1981
A 1000

PERMIT

SEWAGE DISPOSAL SYSTEM

MARYLAND STATE DEPARTMENT OF HEALTH

HOWARD COUNTY

ELLICOTT CITY

INDEXED

DISTRICT 100

DATE 12/20/73

William Hopkins IS PERMITTED TO INSTALL 2 ALTER

ADDRESS Jennings Chapel Road, Woodbine, Maryland PHONE 442-4771

A SEWAGE DISPOSAL SYSTEM LOCATED AT _____

SUBDIVISION _____

PROPERTY OWNER William Fisher

ADDRESS 7903 Kewmough Road, Baltimore, Md. 21222 PHONE: 834-2875

SPECIFICATIONS 3 bedrooms

DRAIN FIELD _____ DEPTH _____ FEET, BOTTOM AREA _____ SQ. FT.

SEEPAGE PITS _____ ABSORBENT SIDE-WALL AREA _____ SQ. FT.

SEPTIC TANK CAPACITY 1000 GALLONS

FOR GARBAGE GRINDER, INCREASE DISPOSAL AREA 25% & TANK CAPACITY 50%.

OTHER: DRY WELL - 300 sq. ft., absorbent sidewall area below the floor 20 ft. of
the surrounding ground. Maximum depth permitted for dry well is 21 ft. below origi-
nal grade. Place the dry well either 100 or 140 ft. from Manassas Drive lot
line and about 110 ft. from Barbara Circle lot line.

NOTE: ALL PIPE FROM HOUSE TO DRY WELL MUST BE CAST IRON.
PERMIT VOID AFTER THREE YEARS.

NOTE: INSTALL STAND PIPE ON SEPTIC TANK AND DRY WELL.

PLANS APPROVED BY Donald V. Monaghan DATE 8/24/66 & 6/23/73

FILL SEPTIC TANK AND DISTRIBUTION BOX WITH WATER BEFORE CALLING FOR AN INSPECTION. COVER NO WORK UNTIL INSPECTED AND APPROVED.

NEITHER THE HOWARD COUNTY COMMISSIONERS NOR THE HEALTH DEPARTMENT IS RESPONSIBLE FOR THE SUCCESSFUL OPERATION OF ANY SYSTEM.

8/8/83

Permit OK

BLDG. PERMIT SIGNED
AND RETURNED 8/8/83
Serial # 53762
Prof.

11/21/73

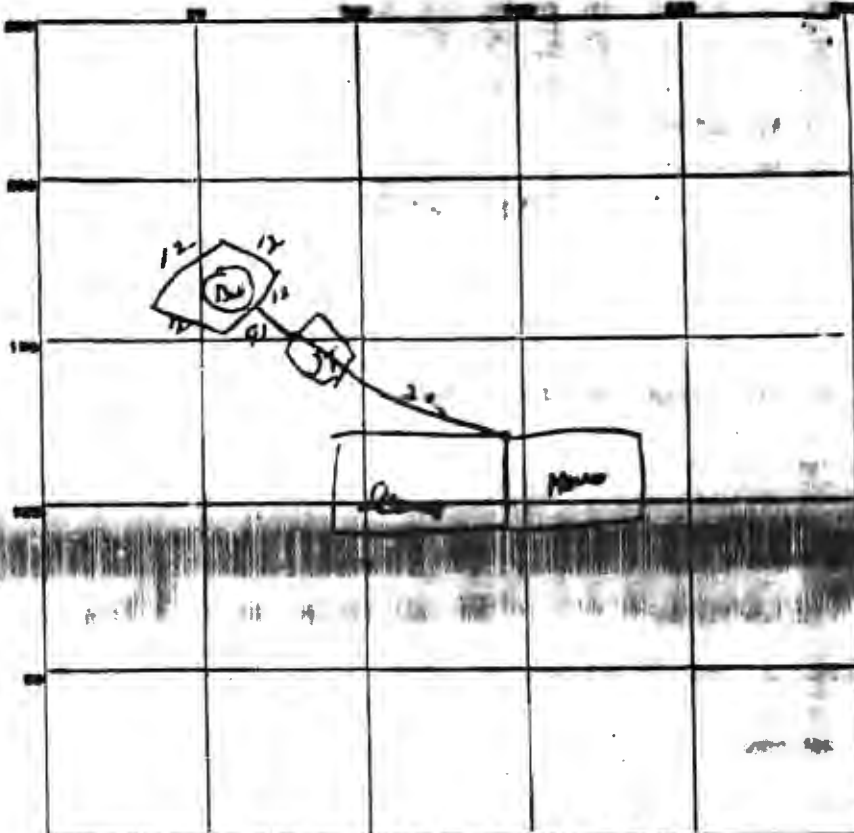

INDICATE NORTH. - NAME ADJOINING ROADWAY AS EDGE LINE.

Barbours land

PERMIT CARD OK

SEPTIC TANK, LEVEL OK

CLEANOUTS OK

DISTRIBUTION BOX, LEVEL _____

TILE FIELD, DEPTH _____ FT. TRENCH WIDTH _____ FT.

GRAVEL DEPTH _____ IN. TOTAL LENGTH _____ FT.

NUMBER OF TRENCHES _____ TOTAL SURFACE AREA _____

SEEPAGE PITS, INSIDE DIAMETER Perimeter 48 FT. DEPTH BELOW INLET 7+ FT.

ABSORBENT AREA 336+ SQ. FT.

REMARKS 11/1/77 appears there is not enough fill in line from house to tank. - DLM

DATE SYSTEM APPROVED 1/31/77

INSPECTOR DLM

6/13/73
2:30 - 3:30
take

APPLICATION

A 12121

SEWAGE DISPOSAL TESTING

P _____

MARYLAND STATE DEPARTMENT OF HEALTH

HOWARD COUNTY

ELLICOTT CITY

Septic Tank - 500 gal

DISTRICT 4

Dry Well - 300 sq ft absorbent subsoil area below ~~water~~ DATE 8/22/65
the depth 31 1/2 ft of non absorbent ground.

Place Dry Well either 100 or 140 ft from Monticello Drive lot line and about 110 ft from Barbara Circle lot line. Max depth permitted for all is 11 ft below original grade.

TO: THE COUNTY HEALTH OFFICER
ELLICOTT CITY, MARYLAND

DISPOSAL SYSTEM

PROPERTY OWNER

Dominic & Leticia Monticello

ADDRESS Cooksville, Maryland

PHONE RU 9-4420

PROPERTY LOCATION:

SUBDIVISION Villa Monticello

LOT NO. 6, Sec. 2

ROAD AND DESCRIPTION

Corner of Monticello Dr. & Barbara Circle

OCCUPANT

PHONE

PERSON TO CONSTRUCT SYSTEM

ADDRESS

PHONE

SIZE OF LOT

1.13 acres

TYPE BLDG.

3
NUMBER OF RESIDERS

IF NOT SINGLE RESIDENCE DESCRIBE

SIGNATURE OF APPLICANT

Dominic Monticello

APPROVED BY

Donald W. Macgibbon FOR Dry Well

DATE 8/24/66

REJECTED BY

FOR

DATE

HOLD PENDING FURTHER TESTS

DATE

REASONS FOR REJECTION OR HOLDING

THIS IS NOT A PERMIT

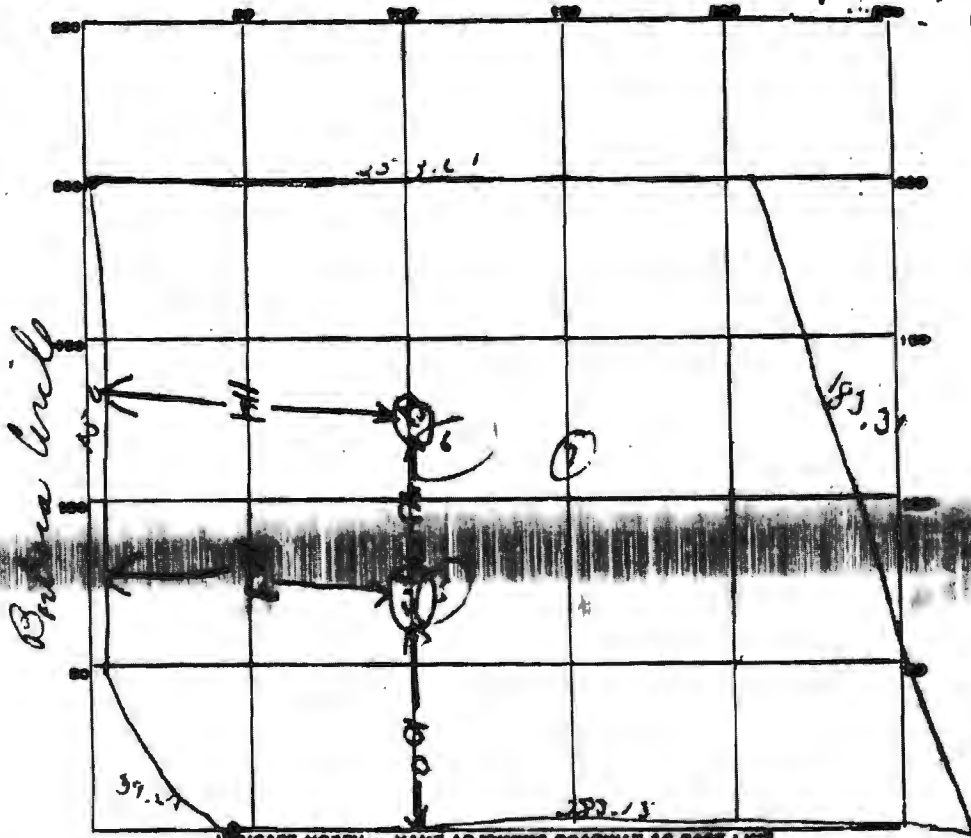

Monticello Drive

DATE	TEST NO.	DEPTH	PRE-WET		TEST - 1" DROP		TIME	
			START	STOP	START	STOP		
9/1/6	1	9 ft	9 22	9 23	9 22	9 21	9 min	
	2	4 ft	9 20	9 24	9 24	9 20	6 min	
	3	6 ft	9 24	9 26	9 26	9 32	6 min	
	4	2 ft	9 24	9 27	9 27	9 31	4 min	
	5	1 1/2'						
	6	1 1/2'	} all ok.					
	7	1 1/2'						

SOIL AUGER FINDING _____

TESTED BY DM

REMARKS Auger Aluminum Soil

BRUSH CANS

190

50' DIA.

5/8/83
TOP FLOOR



BRUSH CANS

- NOTES
- ⊙ POOL LOCAT
 - ⊙ PAVED FLOOR
 - ⊙ DIET HALL

4' LOWE
SEAT

