

CB220647

PERMIT NUMBER: B 22004278

DATE ACCEPTED:

RESIDENTIAL BUILDING PERMIT APPLICATION					
HOWARD COUNTY DEPARTMENT OF INSPECTIONS, LICENSES, AND PERMITS 3430 COURT HOUSE DRIVE, ELLICOTT CITY, MD 21043 - PHONE: (410) 313-2455 OPTION #4					
BUILDING SITE ADDRESS REQUIRED					
Street Address: 1346 Driver Rd				Unit:	
City: Harriotsville		State: MD		Zip Code: 21104	
Subdivision/Village/Complex Name:				SDP/WP/BA #:	
Lot:	Tax Map:	Parcel:	Grading Permit #:		
DESCRIPTION OF WORK REQUIRED					
Existing Use: Deck		Proposed Use: Deck		Estimated Cost: \$ 19,000	
Trade Work to Be Completed (Separate Permits Required): <input type="checkbox"/> Mechanical (HVACR) <input type="checkbox"/> Electrical <input type="checkbox"/> Plumbing <input checked="" type="checkbox"/> None					
"As built" Replace the old deck with the composite deck 16 x 10 joist with steps.					
PROPERTY OWNER INFORMATION REQUIRED					
Owner(s) Name(s) (As it appears on tax records): Hung Nho Dinh				Primary Residence: <input checked="" type="checkbox"/> Yes <input type="checkbox"/> No	
Owner's Street Address: 1346 Driver Rd					
City: Harriotsville		State: MD		Zip Code: 21104	
Phone: 410-802-2907		Email: victory2381@gmail.com			
APPLICANT NAME REQUIRED - INDIVIDUAL WHO SIGNS THIS APPLICATION					
Business Name:				Contact Name: Hung Nho Dinh	
Street Address: 1346 Driver Rd					
City: Harriotsville		State: MD		Zip Code: 21104	
Phone: 410-802-2907		Email: victory2381@gmail.com			
CONTRACTOR INFORMATION REQUIRED					
Business Name: All Services Group LLC					
Licensee's Name: Tornik Avdoyan		License #: MHIC 111127			
Street Address: 309 Bentley Park Ln					
City: Reisterstown		State: MD		Zip Code: 21136	
Phone: 443-803-1133 410-645-0207		Email: allservicegroupllc@gmail.com			
ARCHITECT/ENGINEER INFORMATION INDIVIDUAL WHO SIGNED PLANS, IF APPLICABLE					
Business Name:				Name:	
Street Address:					
City:		State:		Zip Code:	
Phone:		Email:			
BUILDING CHARACTERISTICS REQUIRED					
Primary Structure: <input checked="" type="checkbox"/> SF Dwelling <input type="checkbox"/> SF Townhouse <input type="checkbox"/> SF Duplex <input type="checkbox"/> Mobile Home <input type="checkbox"/> Multi-Family Dwelling (MF*)				Condo: <input type="checkbox"/> Yes <input checked="" type="checkbox"/> No	
Utilities: <input checked="" type="checkbox"/> Electric <input checked="" type="checkbox"/> Gas		Water Supply: <input type="checkbox"/> Public <input checked="" type="checkbox"/> Private (Well)		Sewage Disposal: <input type="checkbox"/> Public <input checked="" type="checkbox"/> Private (Septic)	
Heating System: <input type="checkbox"/> Electric <input type="checkbox"/> Natural Gas <input type="checkbox"/> Propane <input type="checkbox"/> Other: Oil				Roadside Tree Project: <input checked="" type="checkbox"/> No <input type="checkbox"/> Yes: #	
Sprinkler System: <input type="checkbox"/> NFPA 13 <input type="checkbox"/> NFPA 13R <input type="checkbox"/> NFPA 13D <input type="checkbox"/> None				Fire Alarm System: <input checked="" type="checkbox"/> Yes <input type="checkbox"/> No <input type="checkbox"/> Voice Evac	
ADDITIONAL RESIDENTIAL INFORMATION (PLEASE SELECT/COMPLETE ALL THAT APPLY)					
Model Name & Options:					
# of Bedrooms (SF): 4		# of efficiency units (MF*):		# of 3 BR (MF*):	
# Rooms: 9		# Full Baths: 3		# Half Baths: 0	
# Fireplaces: 2					
Garage/Carport Info: <input checked="" type="checkbox"/> Attached Garage <input type="checkbox"/> Detached Garage <input type="checkbox"/> Integral Garage <input type="checkbox"/> Carport <input type="checkbox"/> None					
Basement/Foundation Info: <input type="checkbox"/> Slab on Grade <input type="checkbox"/> Post & Pier <input type="checkbox"/> Unfinished Basement <input checked="" type="checkbox"/> Finished Basement: <input checked="" type="checkbox"/> Full or <input type="checkbox"/> Partial					
1 st Fl Width:		1 st Fl Depth:		2 nd Fl Depth:	
Energy Method: <input type="checkbox"/> Prescriptive <input type="checkbox"/> Performance <input type="checkbox"/> UA Alternative <input type="checkbox"/> ERI		Gross Area:		Occupiable Area: 3563 sq ft	
AGREEMENT/ DISCALIMER REQUIRED					
THE UNDERSIGNED HEREBY CERTIFIES AND AGREES AS FOLLOWS: (1) THAT HE/SHE IS AUTHORIZED TO MAKE THIS APPLICATION, (2) THAT THE INFORMATION IS CORRECT, (3) THAT HE/SHE WILL COMPLY WITH ALL REGULATIONS OF HOWARD COUNTY WHICH ARE APPLICABLE THERETO, (4) THAT HE/SHE WILL PERFORM NO WORK ON THE ABOVE REFERENCED PROPERTY NOT SPECIFICALLY DESCRIBED IN THIS APPLICATION, (5) THAT HE/SHE GRANTS COUNTY OFFICIALS THE RIGHT TO ENTER ONTO THIS PROPERTY FOR THE PURPOSE OF INSPECTING THE WORK PERMITTED AND POSTING NOTICES.					
APPLICANT'S ORIGINAL SIGNATURE:				DATE SIGNED: 11/16/2022	
FOR OFFICE USE ONLY					
CHECKS PAYABLE TO: DIRECTOR OF FINANCE OF HOWARD COUNTY					
AGENCIES REQUIRED/APPROVALS:					
<input checked="" type="checkbox"/> PR	<input checked="" type="checkbox"/> DPZ	<input checked="" type="checkbox"/> DED	<input checked="" type="checkbox"/> Health	<input type="checkbox"/> SHA	<input type="checkbox"/> CID
SUBMITTAL FEES: 155 ⁰⁰		PAYMENT: Will pay online		ACCEPTED BY:	

WALL

10ft x 16ft

JC

60 in

29.0⁰⁰ in

#1346

SI E E A M I V



N88°27'07"E
155.99'

5' UTILITY ESM

N01°32'53"W
298.50'

S02°50'16"W
276.22'

SUGAR MAPLE DRIVE

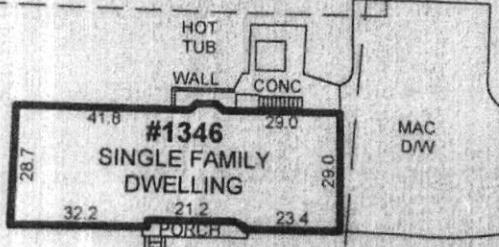
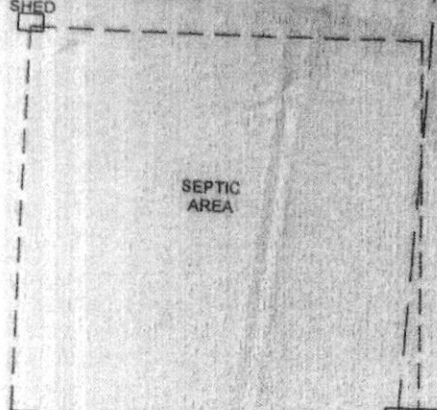

UTILITY BOX

75' BRL

40' BRL

LOT 11
43,033 sf

S88°27'07"W
109.94'

DRIVER ROAD

R=25.00'
A=37.36'

2 copies
2 copies

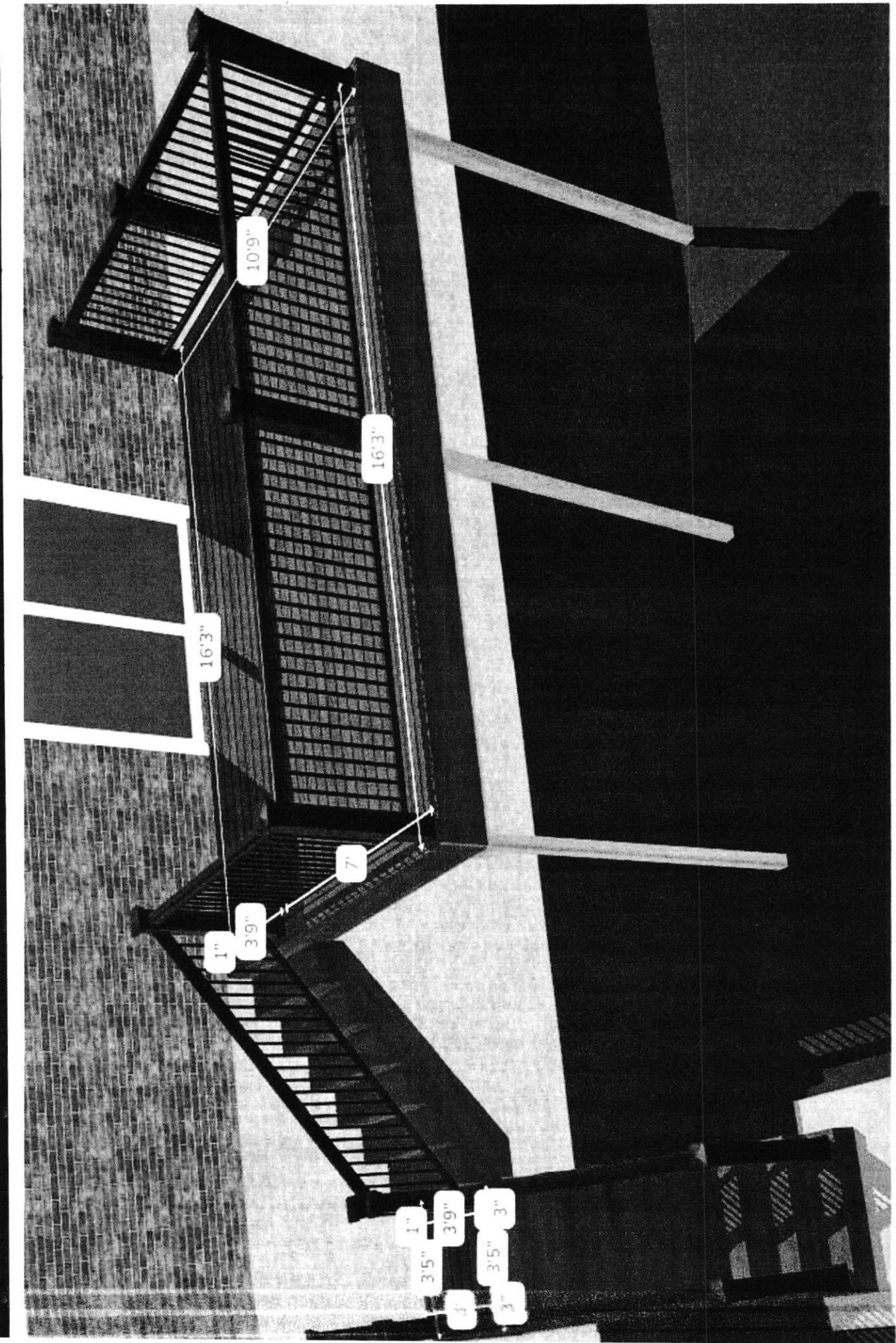

10'9"

16'3"

16'3"

7"

3'9"

1"

3'5"

1"

3'9"

3"

3'5"

3"

**COMPLETE THIS FORM WHEN DROPPING OFF ANY
CORRESPONDENCE AND/OR PLANS TO THE HOWARD COUNTY
DEPARTMENT OF INSPECTIONS, LICENSES AND PERMITS COUNTER:**

Date: 11/28/2022 ONLINE SUBMITTAL PAPER SUBMITTAL

To: Health Department Silvast Zackary
(Reviewer/Requestor's Name) (Division)

From: Tule 443-578-9763
(Your Name, Company Name) (Phone Number)

Subject: Project name Deck Buildings
Project site address 1346 Driver Rd, Marriottsville, MD 21104
Permit # B 220004278 SDP # _____
Other information pertinent to this project _____

Please check the attachments below that you are submitting with this transmittal:

- Letter of response to address plan review comment letter
- Revised plans and/or revised details: When submitting for a complete re-review, **duplicate sets shall be submitted.**
- Letter Summarizing Changes
- Energy conservation calculations
- Copies of plot plan (be specific).
 - Health Department Request DPZ/ DED Request Applicant's Request
- Two sets of single-family model plans to be placed on permanent file: Model name and/or # _____
- Other _____

Contact Person Information: (Required)

TULE Telephone No: 443-578-9763
Please Print Name E-Mail Address: victory2381@gmail.com

PLEASE ASSURE ALL DOCUMENTS AND/OR REVISIONS ARE APPROPRIATELY SIGNED AND SEALED, IF NECESSARY, BY A LICENSED ARCHITECT OR ENGINEER. PLEASE BE ADVISED THAT INSUFFICIENT INFORMATION MAY RESULT IN THE DELAY OF REVIEW BY THE PLANS EXAMINER. THE DEPARTMENT OF INSPECTIONS, LICENSES AND PERMITS WILL CONTACT YOU IF THERE IS A PROBLEM. IN ADDITION, ONCE THE BUILDING PERMIT IS APPROVED BY THE PLAN REVIEW DIVISION AND ALL OTHER REQUIRED SIGNATORY AGENCIES, AND THE BUILDING PERMIT IS READY FOR ISSUANCE, THE PERMIT DIVISION WILL NOTIFY THE APPROPRIATE CONTACT PERSON FOR PERMIT PICK UP. ALL PERMIT STATUS INQUIRIES SHALL BE DIRECTED TO THE PERMIT DIVISION AT 410-313-2455 OPTION #4 OR BY VISITING MYHOWARD.INFO. CODE RELATED QUESTIONS AND PLAN REVIEW INQUIRIES SHALL BE DIRECTED TO THE PLAN REVIEW DIVISION AT 410-313-2436. PLEASE ALLOW A MINIMUM OF FIVE (5) WORKING DAYS FOR ANY PLAN SUBMITTALS TO BE REVIEWED. THANK YOU.

Received by [Signature]
White-Plan Review / Yellow-Applicant / Pink-Permit Division
t:\Operations\Updated forms\HoCo TransmittalForm05.2022

RECEIVED
NOV 28 2022
LICENSES & PERMITS
DIVISION

N88°27'07"E
155.99'

5' UTILITY ESMT



PLAT 3335

N01°32'53"W
298.50'

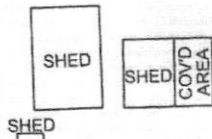

SEPTIC AREA

S02°50'16"W
276.22'

SUGAR MAPLE DRIVE

(12' from house)



#1346
SINGLE FAMILY DWELLING

MAC D/W

75' BRL

** Wall (50' from house)*

LOT 11
43,033 sf

S88°27'07"W
109.94'

DRIVER ROAD

R=25.00'
A=37.36'

REVISED
Date: 11/28/22

Comments: B22004278

*Revised to show well
& septic locations*

LOCATION DRAWING OF:

**#1346 DRIVER ROAD
LOT 11 BLOCK A
SECTION THREE
DRIVER PROPERTY
PLAT No. 3335**

HOWARD COUNTY, MARYLAND

SCALE: 1"=50' DATE: 03-26-2021

DRAWN BY: AP

FILE #: 212906-760

LEGEND:

- X- FENCE
- B/E - BASEMENT ENTRANCE
- B/W - BAY WINDOW
- BR - BRICK
- BRL - BLDG RESTRICTION LINE
- BSMT - BASEMENT
- C/S - CONCRETE STOOP
- CONC - CONCRETE
- D/W - DRIVEWAY
- Ex. - EXISTING
- FR - FRAME
- MAC - MACADAM
- G - GATE
- O/H - OVERHANG
- PUE - PUBLIC UTILITY ESMT.
- PIE - PUBLIC IMPROVEMENT ESMT.

COLOR KEY:

- (RED) - RECORD INFORMATION
- (BLUE) - IMPROVEMENTS
- (GREEN) - ESMTS & RESTRICTION LINES

A Land Surveying Company



DULEY

and
Associates, Inc.

Serving D.C. and MD.



14604 Elm Street, Upper Marlboro, MD 20772

Phone: 301-888-1111

Fax: 301-888-1114

Email: orders@duley.biz

On the web: www.duley.biz

SURVEYOR'S CERTIFICATE

**1346 Driver Rd
CB220697
Building Inspector Rodney Marshall
11/4/22**

New deck built without permit and inspections.



SITE INSPECTION SHEET

OWNER: Hung Tho Dinh PHONE #: _____
ADDRESS: 1342 Driver Rd CONTRACTOR: _____
WELL TAG #: H0-73 1507
SUBDIVISION: _____ LOT: 11 COUNTY #: _____
PROPOSAL: Deck has been built, SDA examined septic tank manhole

LOCATION DIAGRAM

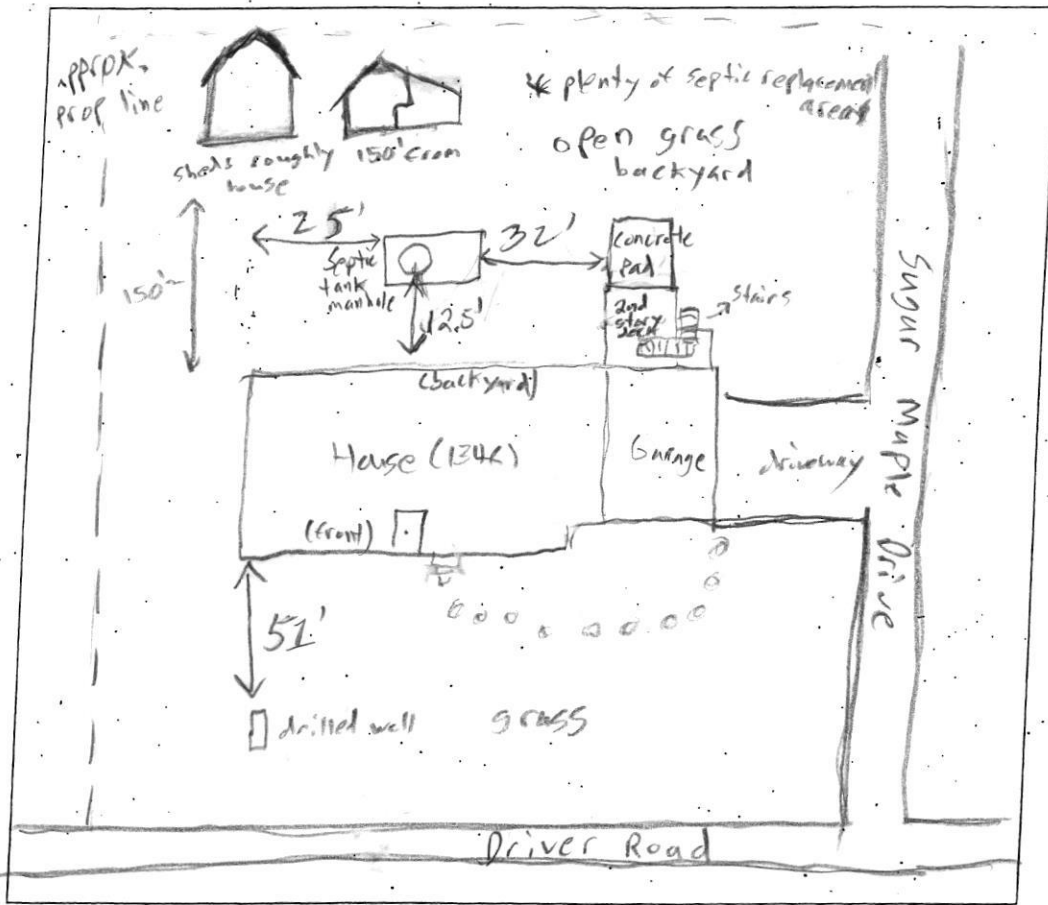

COMMENTS: Found tank manhole but tank was not exposed. Any future building permit may want to establish SDA. No signs of hydraulic failure in backyard.

DATE: 12/5/22 INSPECTOR: Melanie Eschenbaugh YH SLP

Silvast, Zackary

From: Silvast, Zackary
Sent: Tuesday, November 22, 2022 10:18 AM
To: victory2381@gmail.com; allservicegroupllc@gmail.com
Cc: Williams, Jeffrey; Eshenbaugh, Melanie
Subject: regarding building permit (B22004278) for 1346 Driver Road

To Whom It May Concern,

We cannot approve the building permit (B22004278) at this time. We are requesting that an updated plot plan be submitted to DILP showing the exact locations of the existing well & septic system. Please let us know when this has been completed. Thank you.

- ZS

Zack Silvast (LEHS)

Plan Review Supervisor - Water & Sewer Division

410-313-1777

Environmental Health Bureau
Howard County Health Department



HOWARD COUNTY DEPARTMENT OF INSPECTIONS, LICENSES AND PERMITS
7125 Riverwood Drive, Suite D2 ■ Columbia, Maryland 21046 ■ 410-313-1823

Robert J. Frances, P.E., Director

FAX 410-313-1861
TDD 410-313-2323

NOTICE OF VIOLATION

November 7, 2022

HUNG N DINH &
TU LE
1346 DRIVER RD
MARRIOTTSVILLE MD 21104

SUBJECT: **CB220697 - 1346 DRIVER RD
DECK BUILT WITHOUT REQUIRED
PERMITS AND INSPECTIONS**

Dear Property Owners:

It has been discovered that a deck was built without the required permits or inspections which is in violation of the Howard County Building Code, **2021** International Building Code, Sections 105 and 110.

You are hereby directed to obtain all required permits and inspections or remove the unauthorized structure. Please contact the License and Permit Division at **410-313-2455 Option #4**, for information on permit filing. A work without permit fee will be assessed in addition to all required permit fees for commencing work prior to obtaining permits.

*All violations, including obtaining the required permits and inspections or removal of the unauthorized structure, must be corrected in order to prevent any further enforcement action. The proper permits must be obtained by **December 5, 2022** in order to prevent any further enforcement action. Failure to correct the violations by the above date may result in legal action being taken against you, including the issuance of a civil citation with a minimum fine of \$250 a day for each day the violations are not corrected.*

If you have any questions regarding the above matter, contact Rodney Marshall, Building Inspector, Monday through Friday between 7:30 and 9:00 a.m. at 410-313-1812.

Sincerely,
INSPECTIONS AND ENFORCEMENT DIVISION

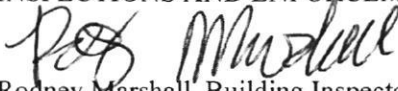
Rodney Marshall, Building Inspector
Romarshall@howardcountymd.gov

B26-Working Without Permits, Created 12/06, Rev. 6/08, 5/10, 10/10, 7/12, 6/10/15
c Inspector File
Tom Huskins
Tickler File
Legal File