

**COMPLETE THIS FORM WHEN DROPPING OFF ANY
CORRESPONDENCE AND/OR PLANS TO THE HOWARD COUNTY
DEPARTMENT OF INSPECTIONS, LICENSES AND PERMITS COUNTER:**

Date: June 10th, 2021 **Health**

To: Don Swinder **Attention Permits Department:**
(Person's Name and Division)

From: ANTHONY SANDLIN
RUSS REMODELING GROUP LLC (443) 539 6915
(Your Name, Company Name and Telephone Number)

Subject: Project name DETACHED GARAGE CONSTRUCTION
Project site address 2891 ORDWAY DRIVE, ELLICOTT CITY
Permit # B21001757 SDP # _____
Other information pertinent to this project _____

Please check the attachments below that you are submitting with this transmittal:

- Letter of response to address plan review comment letter
- Revised plans and/or revised details: When submitting for a complete re-review, duplicate sets shall be submitted.
- Letter Summarizing Changes
- Energy conservation calculations
- Copies of _____ (be specific).
_____ Health Department Request _____ DPZ/ DED Request _____ Applicant's Request
- Two sets of single family dwelling model plans to be placed on permanent file: Model name and/or # _____
- Other _____

Contact Person Information: (Required)

ANTHONY SANDLIN Telephone No: 443 539 6915
Please Print Name E-Mail Address: anthony.sandlin@remodelwithross.com

PLEASE ASSURE ALL DOCUMENTS AND/OR REVISIONS ARE APPROPRIATELY SIGNED AND SEALED, IF NECESSARY, BY A LICENSED ARCHITECT OR ENGINEER. PLEASE BE ADVISED THAT INSUFFICIENT INFORMATION MAY RESULT IN THE DELAY OF REVIEW BY THE PLANS EXAMINER. THE DEPARTMENT OF INSPECTIONS, LICENSES AND PERMITS WILL CONTACT YOU IF THERE IS A PROBLEM. IN ADDITION, ONCE THE BUILDING PERMIT IS APPROVED BY THE PLAN REVIEW DIVISION AND ALL OTHER REQUIRED SIGNATORY AGENCIES, AND THE BUILDING PERMIT IS READY FOR ISSUANCE, THE PERMIT DIVISION WILL NOTIFY THE APPROPRIATE CONTACT PERSON FOR PERMIT PICK UP. ALL PERMIT STATUS INQUIRIES SHALL BE DIRECTED TO THE PERMIT DIVISION AT 410-313-2455. CODE RELATED QUESTIONS AND PLAN REVIEW INQUIRIES SHALL BE DIRECTED TO THE PLAN REVIEW DIVISION AT 410-313-2436. PLEASE ALLOW A MINIMUM OF FIVE (5) WORKING DAYS FOR ANY PLAN SUBMITTALS TO BE REVIEWED. THANK YOU.

Received by _____

HOUSE DETAIL
SCALE: 1"=30'

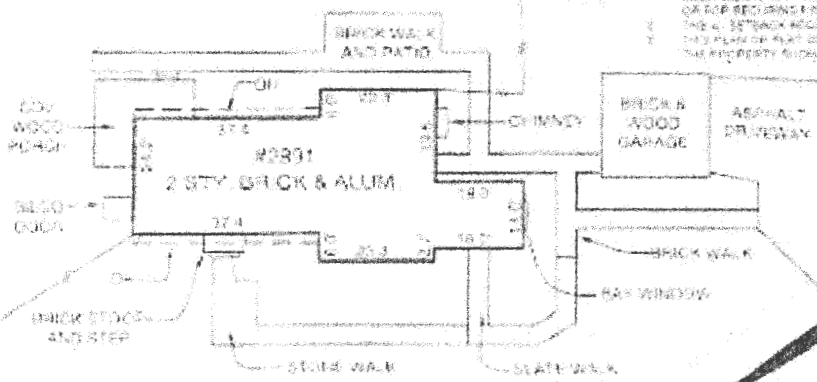

NOTES
THIS PLAN IS INTENDED TO BE USED ONLY IN CONNECTION WITH THE CONSTRUCTION OF THE PROJECT BY THE CLIENT OR A LICENSED SURVEYOR OR ENGINEER. THIS PLAN IS NOT TO BE USED FOR ANY OTHER PURPOSE OR FOR ANY OTHER STRUCTURE. THIS PLAN DOES NOT PROVIDE FOR THE ACCURATE IDENTIFICATION OF PROPERTY BOUNDARIES UNLESS SUCH IDENTIFICATION IS SPECIFICALLY INDICATED ON THE PLAN OR BY A SEPARATE SURVEY. THIS PLAN IS NOT INTENDED TO SHOW ALL MATTERS RELATED TO THE PROPERTY BOUNDARIES.

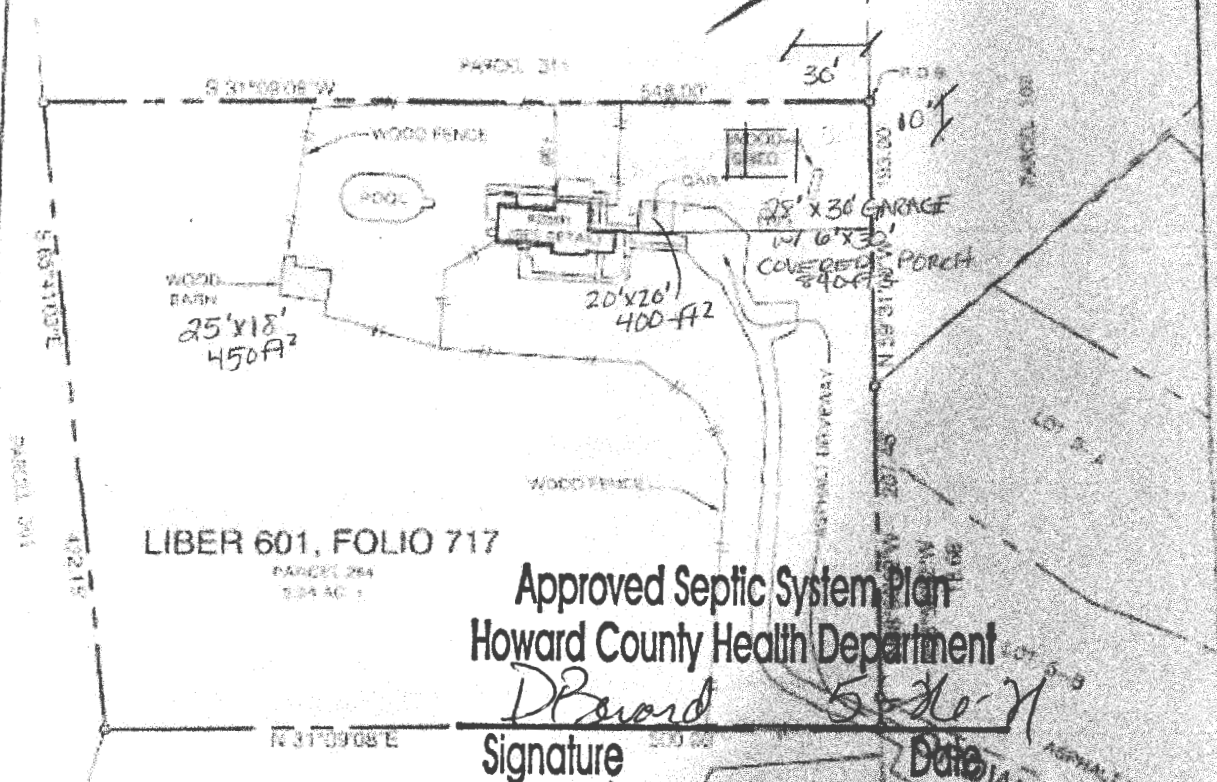

Approved Septic System Plan
Howard County Health Department
D. Beard
Signature *5-16-21*
Date

RECEIVED

JUN 10 2021

LICENSES & PERMITS
DIVISION

LOCATION DRAWING
2891 ORDWAY DRIVE
TAX MAP 16, PARCEL 284
LIBER 601, FOLIO 717
ELECTION DISTRICT NO. 3
HOWARD COUNTY, MARYLAND

WATER CONTAINED
HEREIN IS FOR
OFFICE USE ONLY.
A BOUNDARY SURVEY IS REQUIRED TO DETERMINE AN ACCURATE
LOCATION OF FENCE AND DRIVEWAY.

THIS LOT DOES NOT APPEAR TO BE WITHIN THE 100-YEAR
FLOOD PLAIN AS SHOWN ON THE F.E.M.A. FLOOD HAZARD
MAP 24037D-037D-D AS REVISED NOVEMBER 6, 2019.

CERTIFICATION
I HEREBY CERTIFY THAT THE INFORMATION CONTAINED
HEREIN IS TRUE AND CORRECT TO THE BEST OF MY KNOWLEDGE AND BELIEF.
MICHAEL D. ADCOCK
PROFESSIONAL LAND SURVEYOR
NO. 21251
MY EXPIRES 03/31/2025

Sill · Adcock & Associates · LLC
Engineers · Surveyors · Planners
3381 North Ridge Road, Suite 160
Billeville, Maryland 21043
Phone: 443.125.7682 Fax: 443.335.7885
Email: rask@saadco.com

REFERENCE	L. 601, F. 717
DATE	NOVEMBER 16, 2015
SCALE	1"=100'
FILE NO.	13-001-285

SCALE

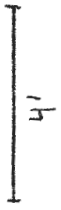

24 24
24 24

WIDTH: 28'

DEPTH: 30'

RIDGE HEIGHT: 14'7"

FLOOR AREA: 240 SF (EXCLUDING PORCH)

4" x 4" Post

1 1/2" W/ PLAN

UNFINISHED AREA

36" x 80" ENTRY DOOR

32" x 57" WINDOWS

10' x 7' GARAGE DOOR

RECEIVED

JUN 10 2021

LICENSES & PERMITS DIVISION

COVERED PORCH AREA

30'

11.75'

28'

6'

35'

