

Record Detail (This section is required.)

Permit Type Building/Commercial/Misc/Tent Permit Number B24001305 Opened Date 04/11/2024
 Description of Work MD SHEEP AND WOOL FESTIVAL/ ERECT (62) TEMPORARY TENTS FOR CRAFTS/AGRICULTURAL EXHIBITS FROM MAY 3, 2024 TO MAY 5, 2024 **SUBJECT TO FIELD INSPECTION**

[check spelling](#)

Address (This section is required.)

Online BP.
 g/l 4/15/24

Search Reset Clear Get Parcel & Owner

Street # 2210 Street Name FAIRGROUNDS Street Type RD
 Unit Type --Select-- Unit # X Coordinate -76.96466 Y Coordinate 39.31039
 City WEST FRIENDSHIP State MD Zip Code 21794 Primary Yes

Parcel (This section is required.)

Search Reset Clear Get Address & Owner

GIS ID	Parcel	Parcel Area	Land Value	Improved Value	Exemption Value	Plan Area
909709	10	21.9	2751000	7327900	4576900	RURAL

Legal Description IMPS21.896 A.[]2210 FAIRGROUNDS RD[]W FRIENDSHIP

[check spelling](#)

Block	Lot	Census Tract	Council Dist	Inspection Dist	Supervisor Dist	Map #	DAP Zone
		603000	5				
Plan Area		State Tax Id	Subdivision Name				
		1403301621					
Section		Area	Tax Map				
			15				
Grid		Zoning District	ADC Map				
		B-2	4813-E1				
SDP No.		Final Plan No.	WP File No.				
Record Plat No.		WS Contract No.	FDP No.	Primary Yes			
Owner Occupied		Year Built	Historic District				
<input type="radio"/> Yes <input checked="" type="radio"/> No		1967	<input type="radio"/> Yes <input checked="" type="radio"/> No				
Historic District Registry No.		Stat Area	Flood Plain				
		3-04	<input type="radio"/> Yes <input checked="" type="radio"/> No				
Building No							

Owner (This section is not required.)

Search Reset Clear

Name HOWARD COUNTY FAIR ASSOCIATION
 Address Line 1 2210 FAIRGROUNDS RD
 Address Line 2
 Address Line 3

Mail City WEST FRIENDSHIP Mail State MD Mail Zip Code 21794
 Phone 443-745-1970 Primary Yes
 E-mail info@howardcountyfairmd.com
 Cell Number 443-745-1970 Fax Number

Professionals (This section is not required.)

License #
 0
License Type
 Tenant
Primary
 Yes

Business Name
 MARYLAND SHEEP AND WOOL FESTIVAL
First Name Middle Name Last Name
 JAN WHITE
Address Line 1
 3610 BAKER RD
Address Line 2

City State ZIP Code
 WESTMINSTER MD 21157
Phone 1 Phone 2 Fax
 410-259-3023
E-mail
 CHESTNUTCREEKFARM@GMAIL.COM

Applicant (This section is not required.)

Search As Owner As Lic. Prof As Contact

Type
 Applicant
Relationship
 Applicant
Primary
 No

First Name MI Last Name
 Janice White
Full Name
 Janice White
Organization Name
 Maryland Sheep & Wool Festival
Street Address
 3610 Baker Road
Address Line 2

City State Zip Code
 Westminster MD 21157
Phone Cell Fax
 410-259-3023 410-259-3023
E-mail
 chestnutcreekfarm@gmail.com

Contact (This section is not required.)

Search As Owner As Lic. Prof As Contact

Type
 Contact
Relationship
 Applicant
Primary
 Yes

First Name MI Last Name
 JAN WHITE
Full Name
 JAN WHITE
Organization Name
 MARYLAND SHEEP AND WOOL FESTIVAL
Street Address
 3610 BAKER RD
Address Line 2

City State Zip Code
 WESTMINSTER MD 21157
Phone Cell Fax
 410-259-3023
E-mail
 CHESTNUTCREEKFARM@GMAIL.COM

Addtl Info

Est Construction Cost Housing Units Number of Buildings Public Owned
 125000 0 0 No

Construction Type
 --Select--

Commercial Tent Information

COMMERCIAL TENT INFORMATION

Capital Project-No Fee Capital Project Number Fee Exempt Fee Exempt Group Existing Use
 Yes No Yes No Howard County Fair Association Fairgrounds

Roadside Tree Permit Roadside Tree Project Permit # Number of Tents Expiration Date Installation Date Removal Date
 Yes No 62 10/12/2024 05/03/2024 05/06/2024

UTILITY INFORMATION

Utilities

Water Supply

Sewage Disposal

Electric

▼ Private

▼ Private

▼

Submit

Cancel

MARYLAND
SHEEP & WOOL
 FESTIVAL

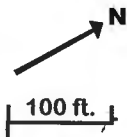

- Sheep:**
 - Barn 1
 - Barn 2
 - Barn 7-8
 - Barn 9
- Vendors:**
 - Barn 3
 - Barn 4
 - Barn 5
 - Barn 6
 - Main Exhibition Hall
 - Outside Locations
- Festival Gear:**
 - Bingo Hall
- Food:**
 - Festival Farm Makret
 - Home Arts Bldg
 - Outside Locations
 - Seating avail in Picnic Area

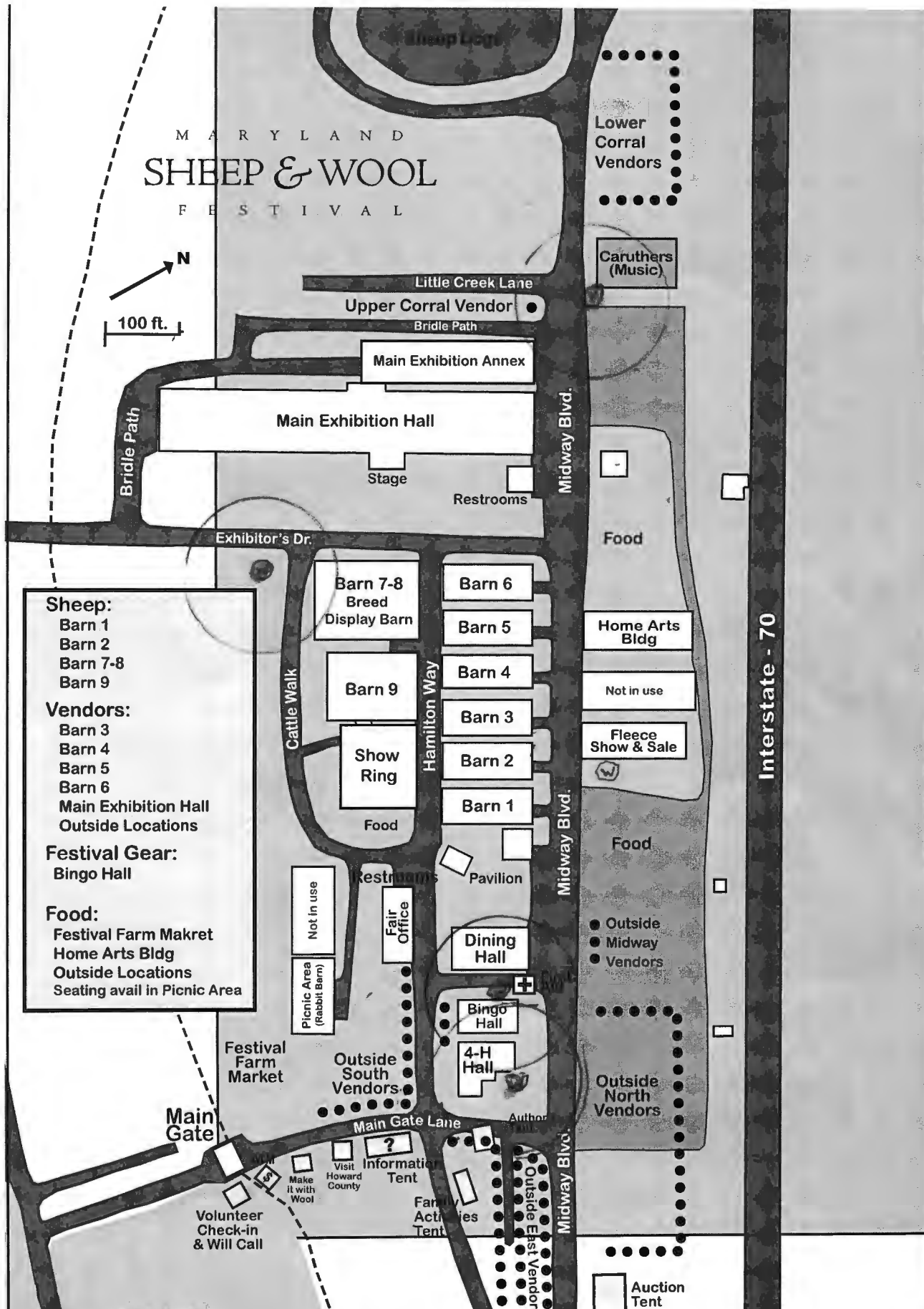



Length

Area



Select



Point

Line

Polygon

Clear



MD SHEEP + WOOL FESTIVAL

MAIN GATE / EAST /
SOUTH / NORTH /
MIDWAY

PARKING

20x10

MAIN GATE

FARMER'S MARKET

20x10

10x10

10x10

30x10

SOUTH FIELD

30x60

EAST FIELD

10x10

NORTH / MIDWAY FIELD

80x40

MIDWAY BLVD → WEST

FAIRGROUNDS RD.

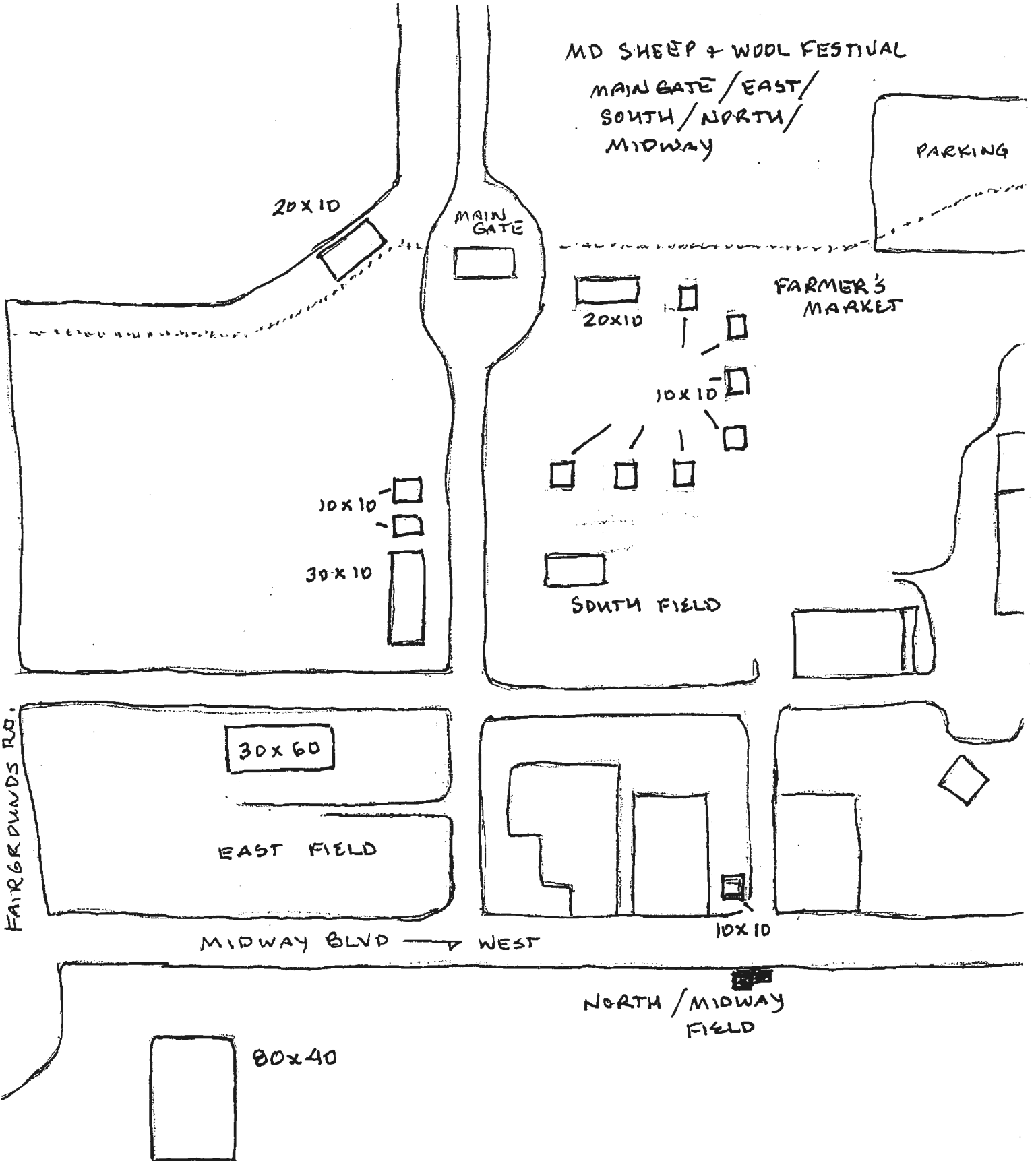

← WEST

RT 70

→ EAST

MD SHEEP + WOOL FESTIVAL
LOWER/UPPER CORRALS

33 x 65.

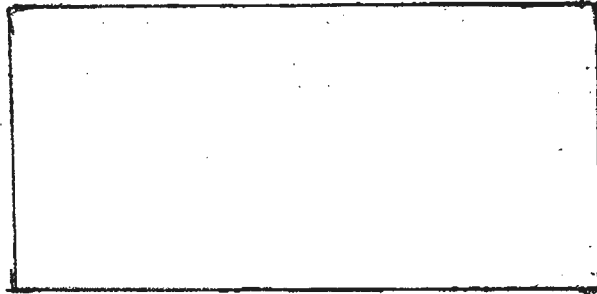

20 x 20

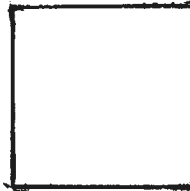

20 x 10



25 x 10
PARKING
SPACE
ONLY



ASPHALT
PARKING

← TO SHEEPDOG
DEMO

MIDWAY BLVD

→ EAST



MO SHEEP + WOOL FESTIVAL
MAIN EXHIBITION HALL
+ UPPER CORRAL

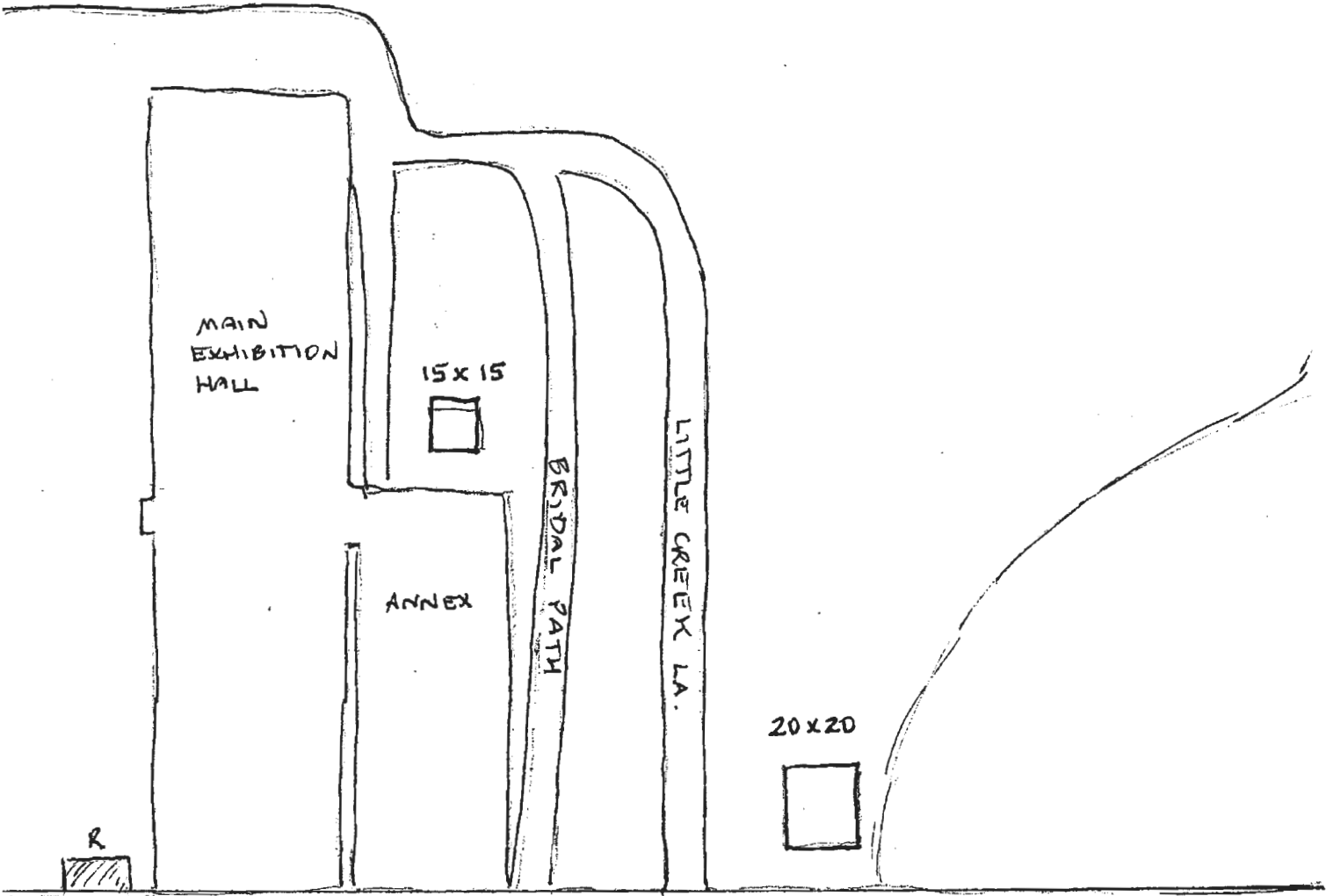

MID SHEEP & WOOL FESTIVAL
MIDWAY GAMES ACTIVITIES

~~WEST~~ RT. 10 ~~EAST~~

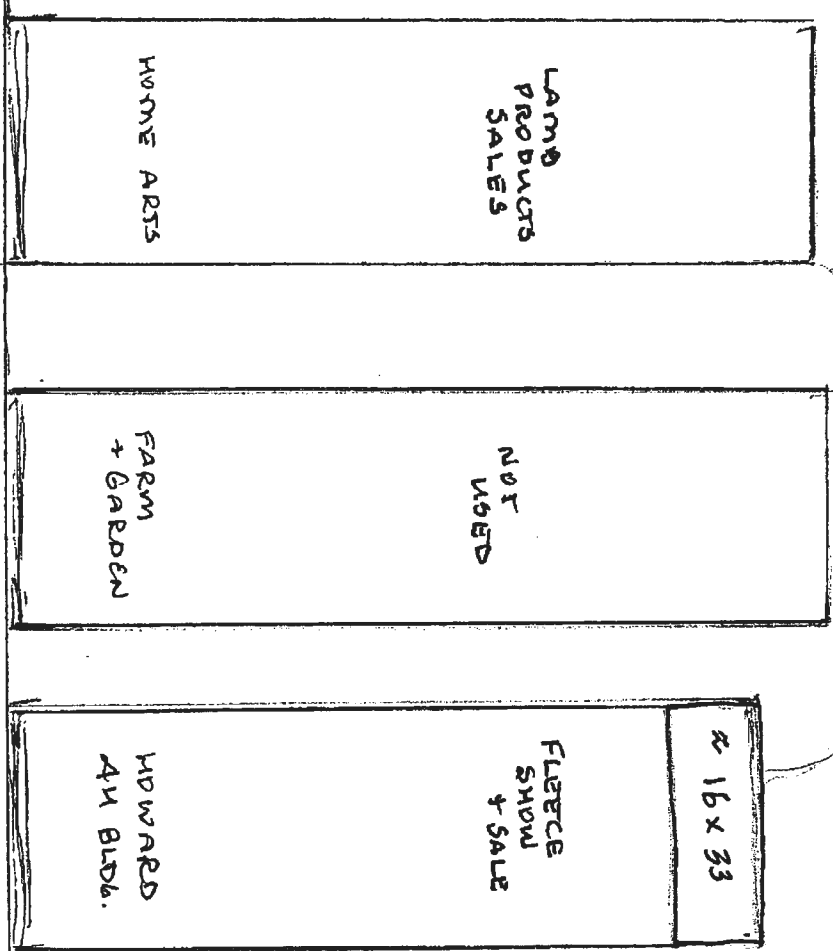

WEST MIDWAY EAST

TOWER

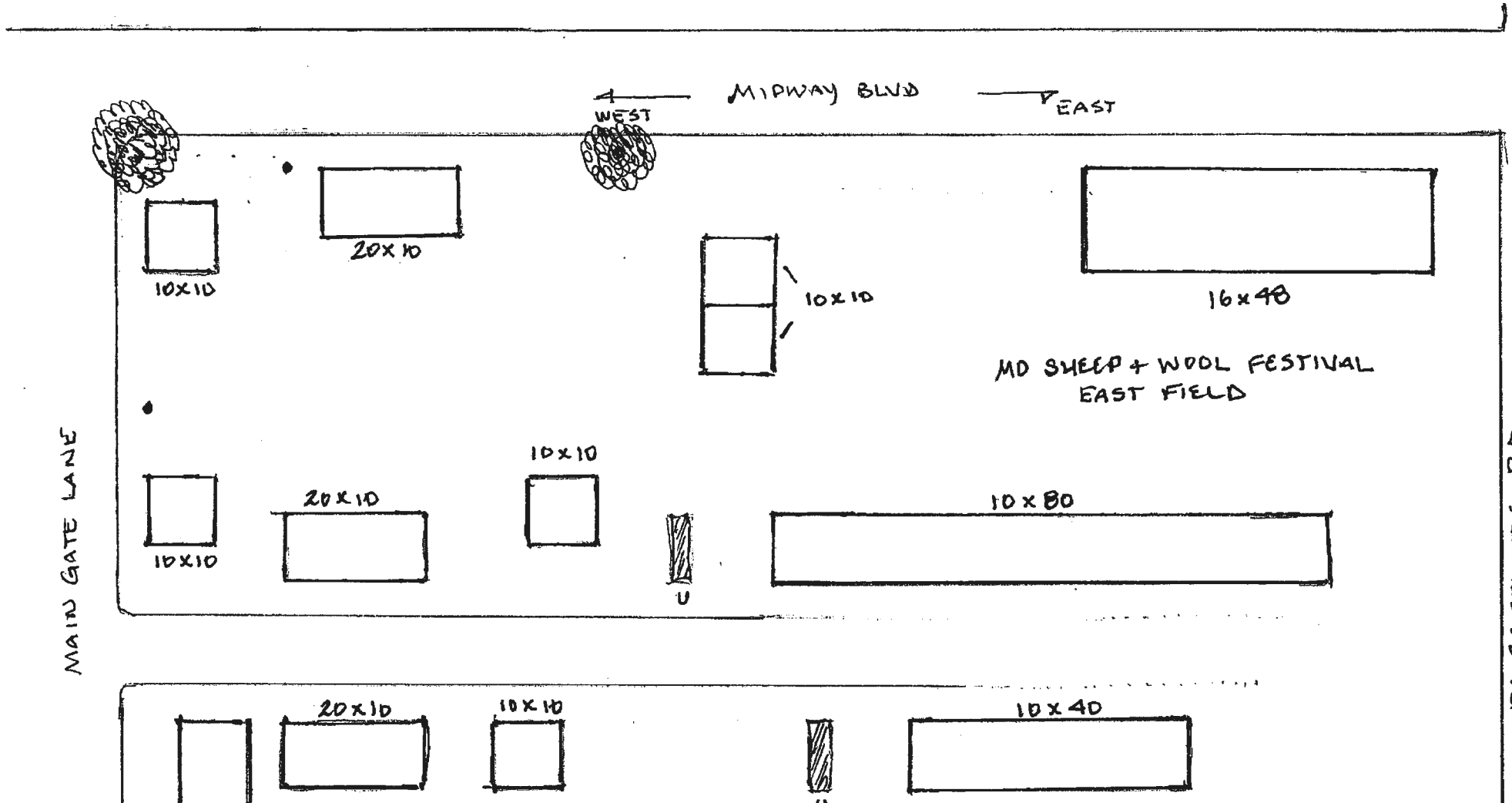

MAIN GATE LANE

MIDWAY BLVD

WEST

EAST



10x10



20x10



10x10



16x48

MD SHEEP + WOOL FESTIVAL
EAST FIELD



10x10



20x10



10x10



U



10x80

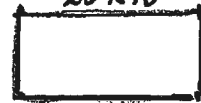

20x10



10x10



U



10x40

FAIRGROUNDS RD

2024 East Tent Footprint

2024 MSWF North Tent Footprint

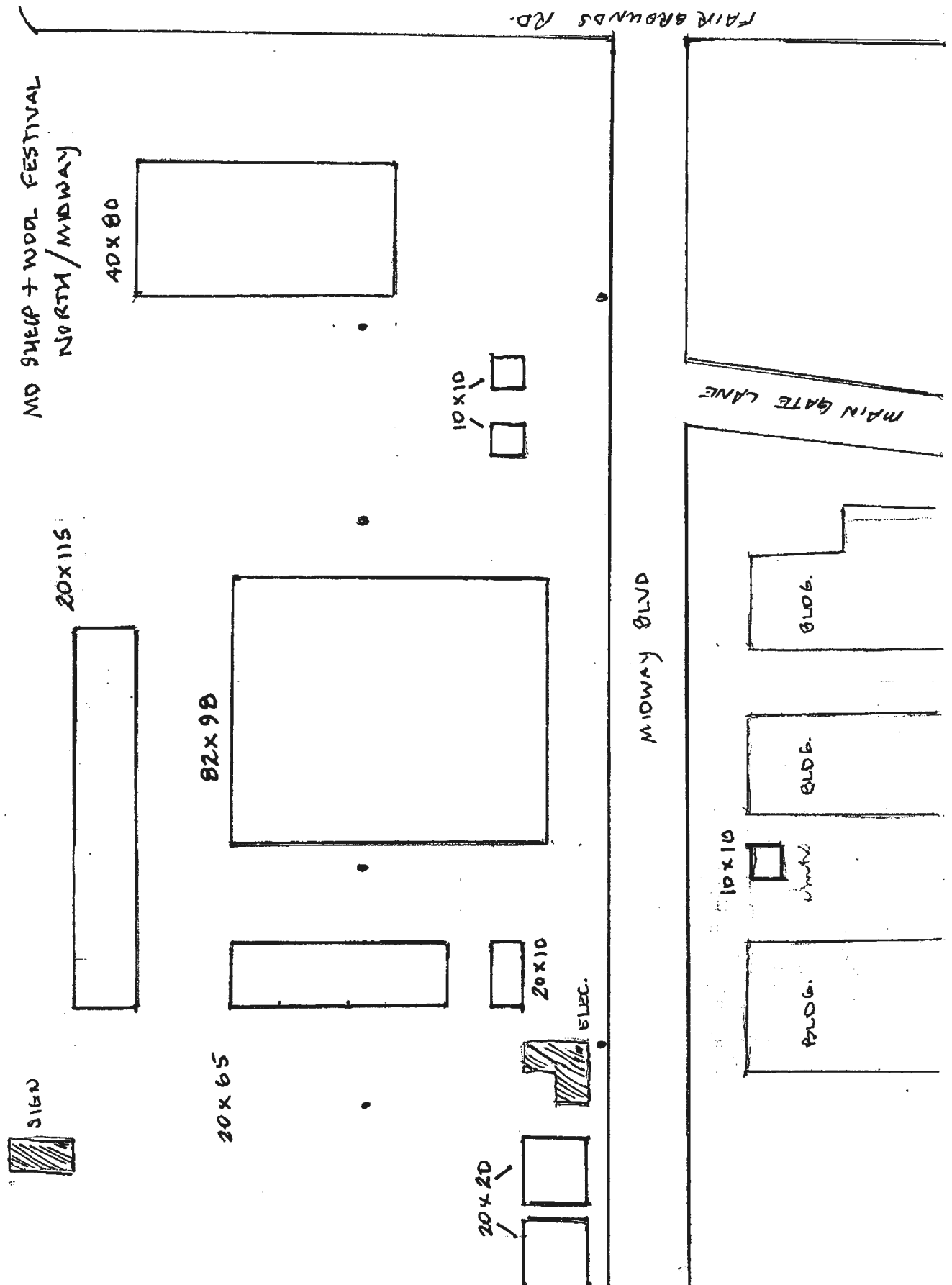
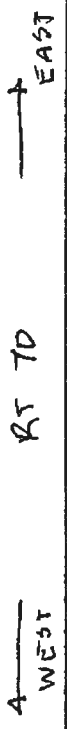

2024 MSWF South Tent Footprint

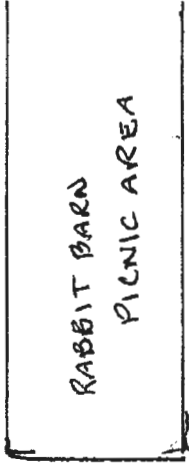

MO SHEEP + WOOL FESTIVAL SOUTH FIELD

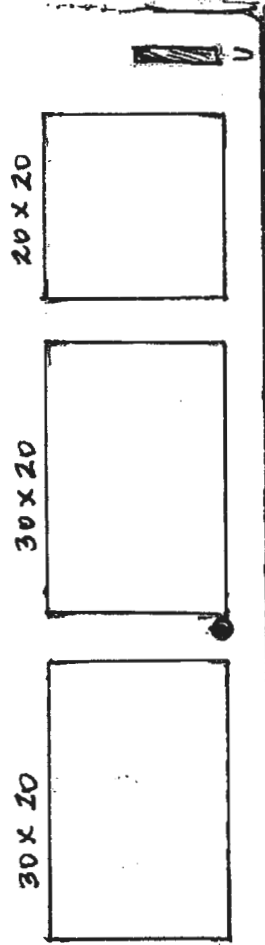
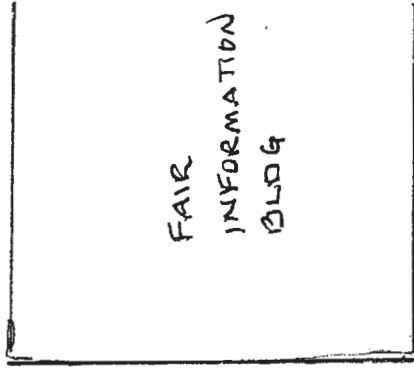

HAMILTON WAY WEST

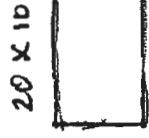
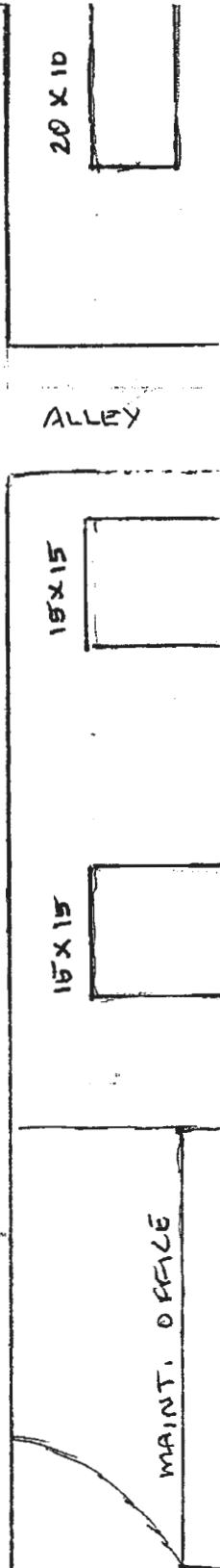

Oswald Jr, Woodin

From: Oswald Jr, Woodin
Sent: Monday, April 22, 2024 12:01 PM
To: 'Jeff White'
Subject: RE: B24001305_2210 Fairgrounds Road

Hi Mr. White,

The building permit has been approved.

Regards,

Hank

Hank Oswald
Licensed Environmental Health Specialist
Bureau of Environmental Health
Howard County Health Department
8930 Stanford Blvd. Columbia, MD 21045
(410) 313 - 1786
www.hchealth.org

DISCLAIMER: This e-mail is intended only for the individual to whom it is addressed. It may be used only in accordance with applicable laws. If you are not the intended recipient, you are strictly prohibited from reading, disseminating, distributing, or copying this message. If you received this e-mail by mistake, please notify the sender and destroy this e-mail

From: Jeff White <chestnutcreekfarm@gmail.com>
Sent: Monday, April 22, 2024 11:35 AM
To: Oswald Jr, Woodin <hoswald@howardcountymd.gov>
Subject: Re: B24001305_2210 Fairgrounds Road

[Note: This email originated from outside of the organization. Please only click on links or attachments if you know the sender.]

Ok, thanks!

On Mon, Apr 22, 2024, 11:28 AM Oswald Jr, Woodin <hoswald@howardcountymd.gov> wrote:

Hi Mr. White,

The county performed an upgrade to the system over the weekend, but it hasn't been completed yet. Therefore, I am not able to change the status at this time. I will keep checking back, and approve the BP as soon as I am able to.

Thanks,

Hank

Hank Oswald

Licensed Environmental Health Specialist

Bureau of Environmental Health

Howard County Health Department

8930 Stanford Blvd. Columbia, MD 21045

(410) 313 - 1786

www.hchealth.org

DISCLAIMER: This e-mail is intended only for the individual to whom it is addressed. It may be used only in accordance with applicable laws. If you are not the intended recipient, you are strictly prohibited from reading, disseminating, distributing, or copying this message. If you received this e-mail by mistake, please notify the sender and destroy this e-mail

From: Jeff White <chestnutcreekfarm@gmail.com>
Sent: Monday, April 22, 2024 9:50 AM
To: Oswald Jr, Woodin <hoswald@howardcountymd.gov>
Subject: Re: B24001305_2210 Fairgrounds Road

[Note: This email originated from outside of the organization. Please only click on links or attachments if you know the sender.]

Good morning Mr. Oswald -

I just looked online through the site and our permit is still showing as "in review" - will that be updated later today, and will I be able to download/print a copy of the permit to have onsite?

Thank you - Jan White

On Fri, Apr 19, 2024 at 11:28 AM Oswald Jr, Woodin <hoswald@howardcountymd.gov> wrote:

Hi Mr. White.

Thanks for the additional information. I will approve the building permit based on this email correspondence. Next year, please include a site plan that shows the tents, wells and septic tank locations. I believe the septic trenches are located closer to the road, so we won't need that detail shown on the plan.

Let me know if you have any questions.

Regards,

Hank

Hank Oswald

Licensed Environmental Health Specialist

Bureau of Environmental Health

Howard County Health Department

8930 Stanford Blvd. Columbia, MD 21045

(410) 313 - 1786

www.hchealth.org

DISCLAIMER: This e-mail is intended only for the individual to whom it is addressed. It may be used only in accordance with applicable laws. If you are not the intended recipient, you are strictly prohibited from reading, disseminating, distributing, or copying this message. If you received this e-mail by mistake, please notify the sender and destroy this e-mail

From: Jeff White <chestnutcreekfarm@gmail.com>
Sent: Friday, April 19, 2024 10:51 AM
To: Oswald Jr, Woodin <hoswald@howardcountymd.gov>
Subject: Re: B24001305_2210 Fairgrounds Road

[Note: This email originated from outside of the organization. Please only click on links or attachments if you know the sender.]

Good morning -

I just spoke to Dave Johnson, the Fairgrounds Manager at the Howard County Fairgrounds, and he assures me we are not placing any of our tents anywhere near a septic tank/septic system.

If there is any additional information you need, please do not hesitate to contact me.

Thank you!

On Thu, Apr 18, 2024 at 1:35 PM Oswald Jr, Woodin <hoswald@howardcountymd.gov> wrote:

Hi Janice,

Good afternoon. I am following up on our telephone conversation from yesterday. I printed off all layouts I saw under this building permit for the Fairgrounds, MD Sheep & Wool Festival 2024 (see attached). I need to know if there are any wells or septic tanks within the vicinity of the tents. Please take a look at each layout, and show any well or septic tank within the vicinity of the tent(s) or state no wells or septic tanks are within the vicinity of the tents.

I've attached an image from GIS that shows all wells on the property. There appears to be 6 wells altogether. The septic record shows several septic tanks on the property, but the record is too large to send. You may need to consult with the fairgrounds on where the tanks are located in proximity to the tents.

I also attached the site plan from last year's MD Sheep & Wool Festival 2023 (See attachment-B23001099_Site Plan). Is the tent layout for 2024, the same as 2023?

Should you have any questions, please don't hesitate to ask.

Regards,

Hank

Hank Oswald

Licensed Environmental Health Specialist

Bureau of Environmental Health

Howard County Health Department

8930 Stanford Blvd. Columbia, MD 21045

(410) 313 - 1786

www.hchealth.org

DISCLAIMER: This e-mail is intended only for the individual to whom it is addressed. It may be used only in accordance with applicable laws. If you are not the intended recipient, you are strictly prohibited from reading, disseminating, distributing, or copying this message. If you received this e-mail by mistake, please notify the sender and destroy this e-mail